

Brookings Bath Vanity Fully Assembled 49x22  
Sherwin Williams® White Base and Camilla II Top

**FULLY  
ASSEMBLED  
VANITY**

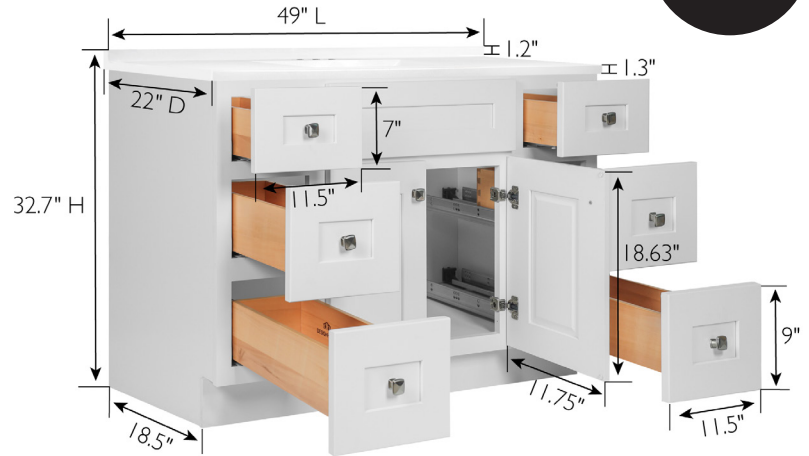

## SPECIFICATIONS

<b>MATERIAL CONSTRUCTION:</b>	Wood/Cultured Marble	<b>TOE KICK INSET WIDTH:</b>	4.5"
<b>ASSEMBLY REQUIRED:</b>	No	<b>BACK PANEL MATERIAL:</b>	Plywood
<b>ASSEMBLED DIMENSIONS:</b>	32.7" H x 49" L x 22" D	<b>BACK BRACE MATERIAL:</b>	Solid Wood
<b>ASSEMBLED WEIGHT:</b>	166.42 .lbs	<b>FAUCET TYPE:</b>	Lav Centerset
<b>TOOLS NEEDED FOR INSTALLATION:</b>	Phillips Screwdriver; Rubber Mallet, Wood Glue	<b>NUMBER OF MOUNTING HOLES:</b>	3
<b>CONSTRUCTION TYPE:</b>	Face Frame	<b>BOWL MATERIAL:</b>	Ceramic
<b>HINGE STYLE:</b>	Soft Close	<b>BACK SPLASH INCLUDED:</b>	Yes
<b>DOOR STYLE:</b>	2 Shaker Doors	<b>COLOR:</b>	White
<b>FACE FRAME MATERIAL:</b>	Solid Wood	<b>NUMBER OF BOWLS:</b>	1
<b>SIDES MATERIAL:</b>	Plywood	<b>BOWL DIMENSIONS:</b>	19.3" W x 12.5" D
<b>BOTTOM MATERIAL:</b>	Plywood	<b>BOWL SHAPE:</b>	Rectangle
		<b>SINK THICKNESS:</b>	1.18"
		<b>MOUNTING TYPE:</b>	Floor Mount
		<b>OVERFLOW HOLE:</b>	Yes
		<b>WARRANTY:</b>	1-Year limited warranty
		<b>TSCA TITLE IV COMPLIANT:</b>	Yes
		<b>LEGAL FOR SALE IN CALIFORNIA:</b>	Yes
		<b>PROP 65 HARMFUL MATERIAL:</b>	Formaldehyde



TYPE:  
JOB:  
ORDER CODE:  
APPROVALS: