

SHIMANO

CITICA

CI-200IHG

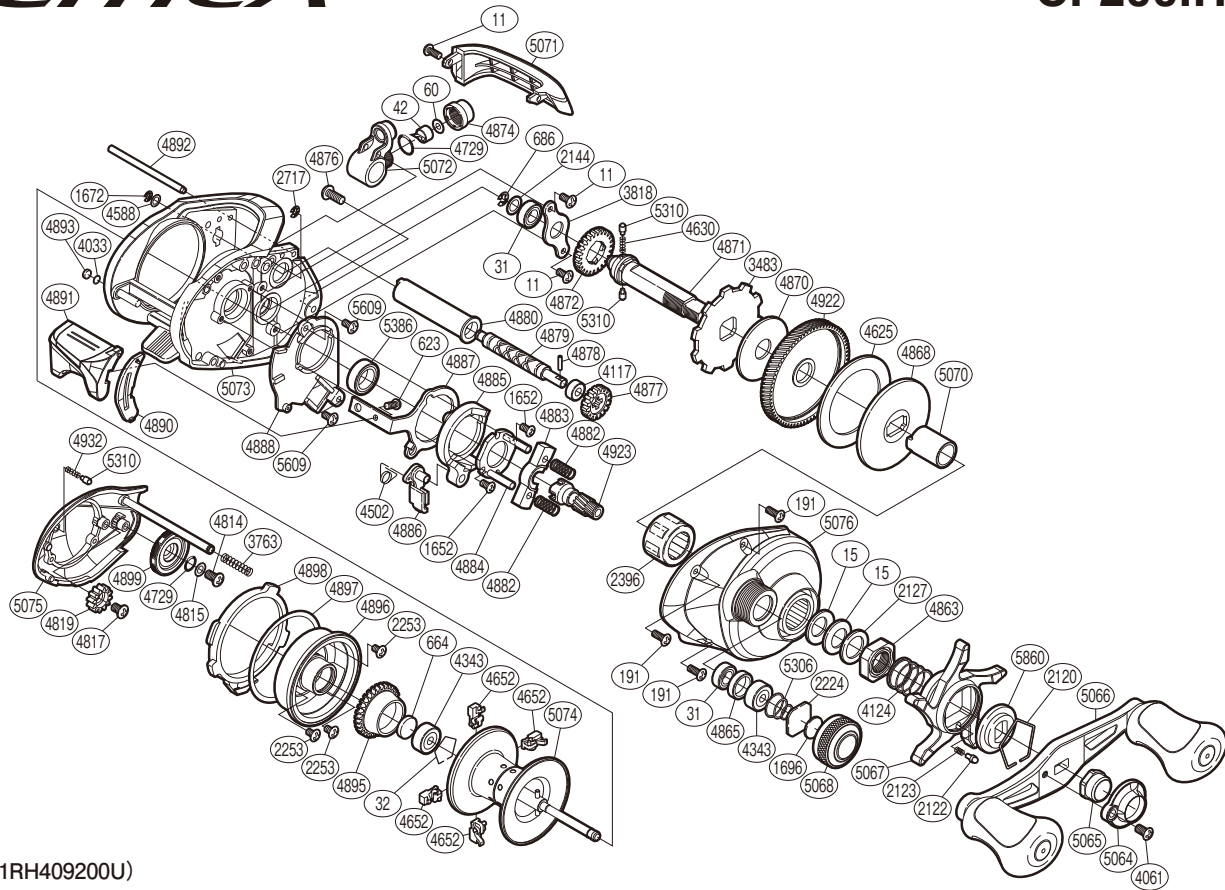

(51RH409200U)

#	Part No.	Description	#	Part No.	Description	#	Part No.	Description
11	10MT0	Screw	4588	10FJZ	Washer	4893	108PY	Anti-Thrust Washer
15	10D60	Drag Spring Washer	4625	106XT	Drag Washer	4895	10EXQ	Brake Ring Gear
31	105BL	Ball Bearing	4630	10JDY	Idle Gear Spring	4896	10F0N	Brake Case
32	10GEW	Bearing Retainer	4652	1046G	Brake Shoe	4897	104MX	Washer
42	10FFZ	Line Guide Pawl	4729	108WQ	O Ring	4898	10BAK	Side Plate Cam Lever
60	10CFW	Spacer	4814	103LE	Screw	4899	10AZB	Brake Dial
191	10MPT	Screw	4815	10GFB	Washer	4922	10CMC	Drive Gear
623	103C0	Screw	4817	103L7	Screw	4923	10CRW	Pinion Gear
664	1057S	Spacer B	4819	10CLF	Idle Gear	4932	10GZQ	Click Spring
686	105NK	E Lock	4863	10A3T	Star Drag Nut	5064	10Q5Q	Handle Nut Plate
1652	10LVE	Screw	4865	10EYS	Bearing Spacer	5065	10FFC	Handle Nut
1672	105NC	E Lock	4868	10D3H	Key Washer	5066	10CEY	Handle Assembly
1696	10896	Cast Control Spacer	4870	10CHF	Drag Washer	5067	10ATY	Star Drag
2120	10KXV	Click Plate Retainer	4871	1058L	Drive Shaft	5068	10KDM	Cast Control Cap
2122	10BT0	Click Pin	4872	10J47	Idle Gear	5070	10BMW	Roller Clutch Inner Tube
2123	10BT2	Click Spring	4874	10FJB	Pawl Cap	5071	10FWD	Level Wind Protector
2127	10J1N	Star Drag Spacer	4876	103DC	Screw	5072	10NVR	Line Guide
2144	10C4F	Washer	4877	10FNV	Idle Gear	5073	10EVD	One-Piece Frame
2224	1085F	Spool Tension Spacer	4878	10AEZ	Worm Shaft Pin	5074	10L13	Spool Assembly
2253	103N4	Screw	4879	104SN	Worm Shaft	5075	10D0A	Left Side Plate
2396	10F5C	Roller Clutch Bearing	4880	10NFQ	Level Wind Guard	5076	10GK4	Right Side Plate
2717	105NB	E Lock	4882	10487	Yoke Spring	5306	10TMT	Spool Tension Spring
3483	109BB	Anti-Reverse Ratchet	4883	1046V	Yoke	5310	10HJG	Idle Gear Pin
3763	10KNG	Side Plate Spring	4884	10F3X	Clutch Cam Retainer	5386	10EX6	Ball Bearing
3818	109T0	Drive Shaft Retainer	4885	10K0N	Clutch Cam	5609	10LCT	Screw
4033	108SK	Washer	4886	10MME	Clutch Pawl	5860	10J26	Star Drag Click Plate
4061	103ED	Screw	4887	10QGH	Clutch Plate			
4117	10PXY	Bushing	4888	10BVL	Clutch Guard			
4124	10A70	Star Drag Spring	4890	1096S	Clutch Bar Guide	4652	1046G	Brake Shoe (accessory)
4343	105C3	Ball Bearing	4891	10CDL	Quick-Fire II Clutch Bar			
4502	104CN	Clutch Pawl Spring	4892	10QSE	Stabilizer Bar	4692	10LQ0	B-100 Oil (accessory)

Please note that the number of adjusting washers may not be the same as shown in the exploded views.
(Adjustment will vary with each individual product.)

(241029)_005