

BOHO CHIC CAL KING BED ASSEMBLY INSTRUCTIONS



PARTS PACKING CONFIGURATIONS



ATTENTION! IF YOU RECEIVED THIS INSTRUCTION IN ADDITION TO INSTRUCTION PACKED IN ANOTHER CARTON, PLEASE DISREGARD THE OTHER INSTRUCTION AND FOLLOW THIS GUIDE TO ASSEMBLE YOUR PRODUCT.

BOX #1:

- A. HEADBOARD 1 PC
- B. LEFT HEADBOARD LEG 1 PC
- C. RIGHT HEADBOARD LEG 1 PC
- D. STRETCHER 1 PC

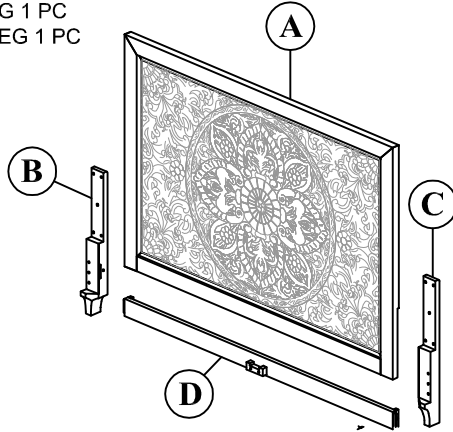

BOX #2:

- E. FOOTBOARD 1 PC
- J. SLAT ROLL 1 SET

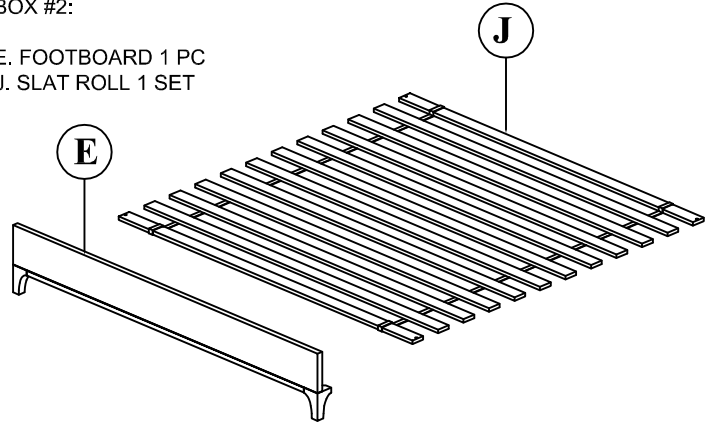

BOX #3:

- F. LEFT SIDE RAIL 1 PC
- G. RIGHT SIDE RAIL 1 PC
- H. CENTER SLAT SUPPORT 1 PC
- I. SLAT SUPPORT LEG 3 PCS
- K. SPACER 2 PCS

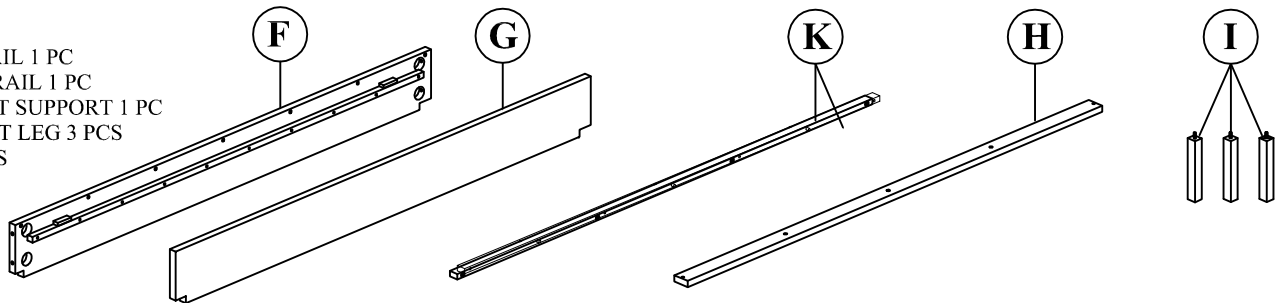

HARDWARE PACKED IN BOX #2

No	Description	Photo	Quantity
1	ALLEN BOLT (M8X40)		12 PCS
2	THREADED BOLT (M8X80)		8 PCS
3	HEX NUT (M8)		8 PCS
4	HALF MOON WASHER		8 PCS
5	SPRING WASHER (M9)		12 PCS
6	FLAT WASHER (M9)		12 PCS
7	WOOD SCREW (M4X30)		6 PCS
8	SPANNER		1 PC
9	ALLEN KEY		1 PC

HARDWARE PACKED IN BOX #3

9	ALLEN KEY		1 PC
10	ALLEN BOLT (M6X50)		8 PCS

BOHO CHIC CAL KING BED FULLY ASSEMBLED

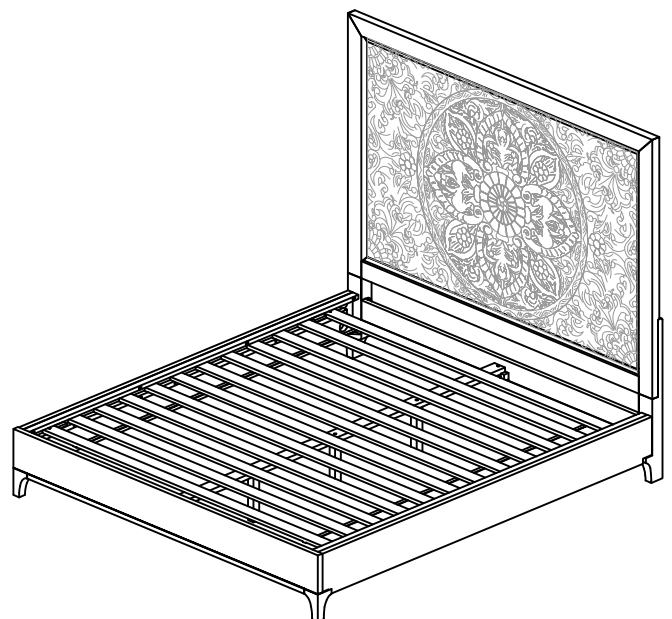

TOOL REQUIRED

PHILLIPS-HEAD SCREWDRIVER (NOT PROVIDED)



BOHO CHIC CAL KING BED ASSEMBLY INSTRUCTIONS



STEP 1:

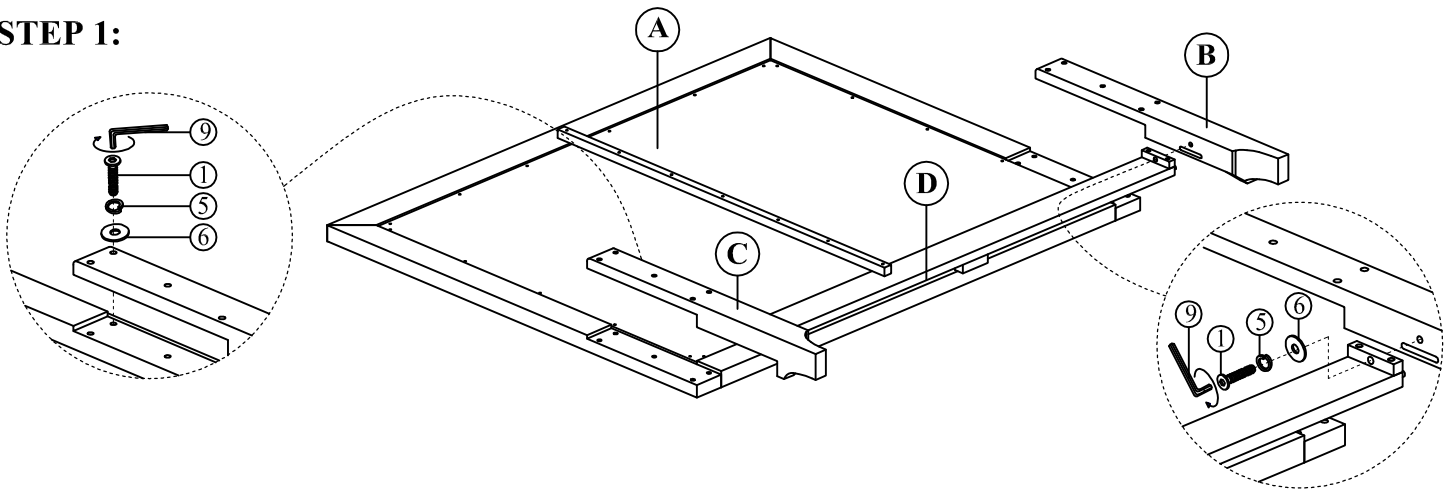

STEP 2:

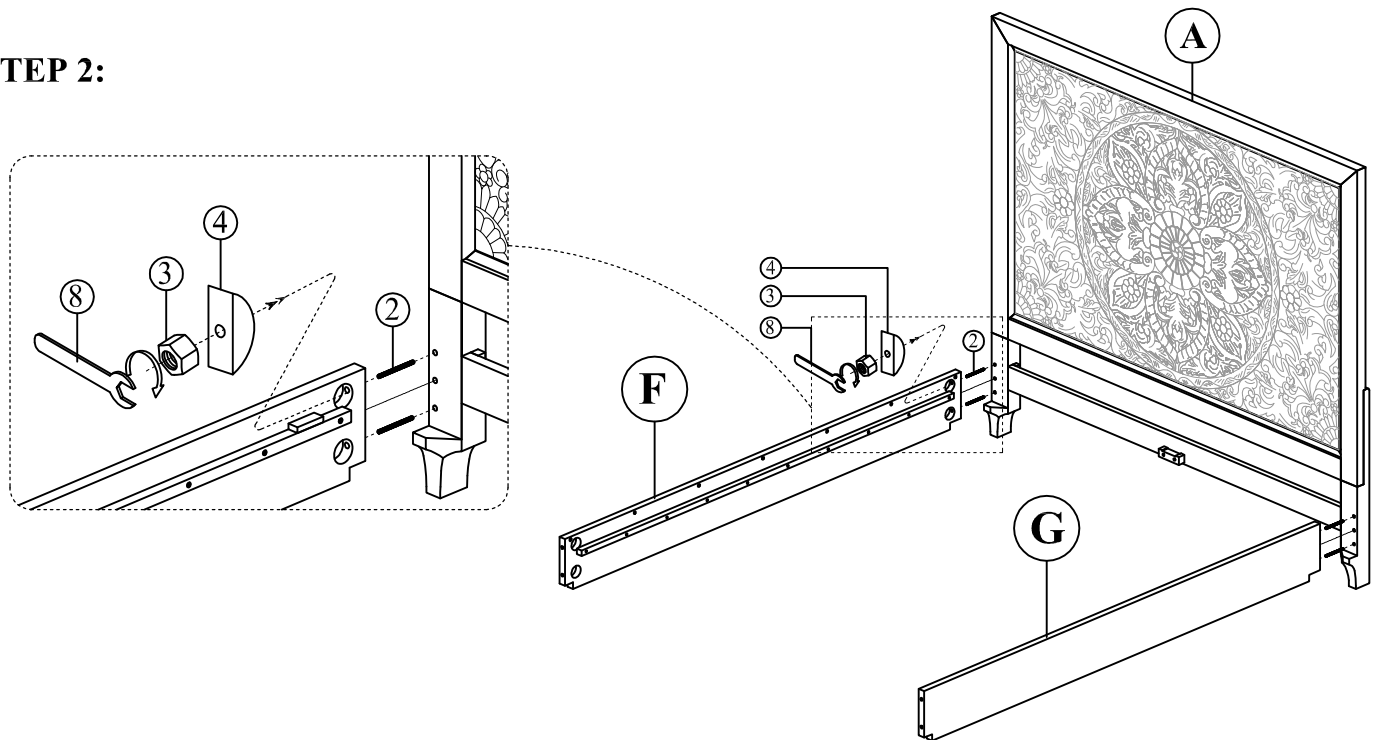

STEP 3:

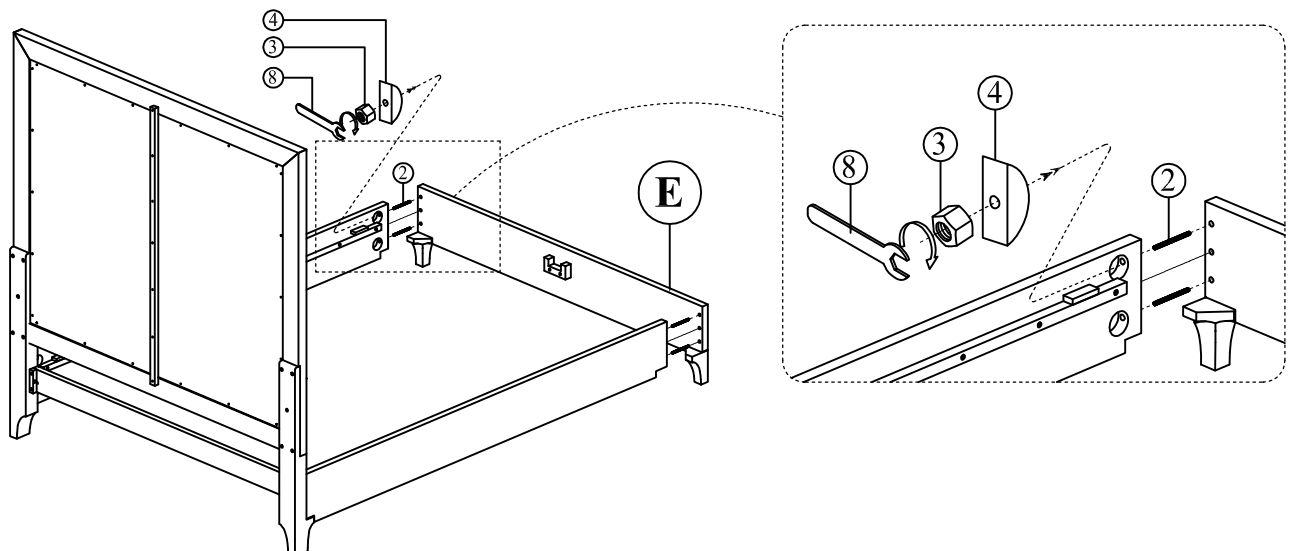

TOOL REQUIRED
PHILLIPS-HEAD SCREWDRIVER (NOT PROVIDED)



BOHO CHIC CAL KING BED ASSEMBLY INSTRUCTIONS



STEP 4:

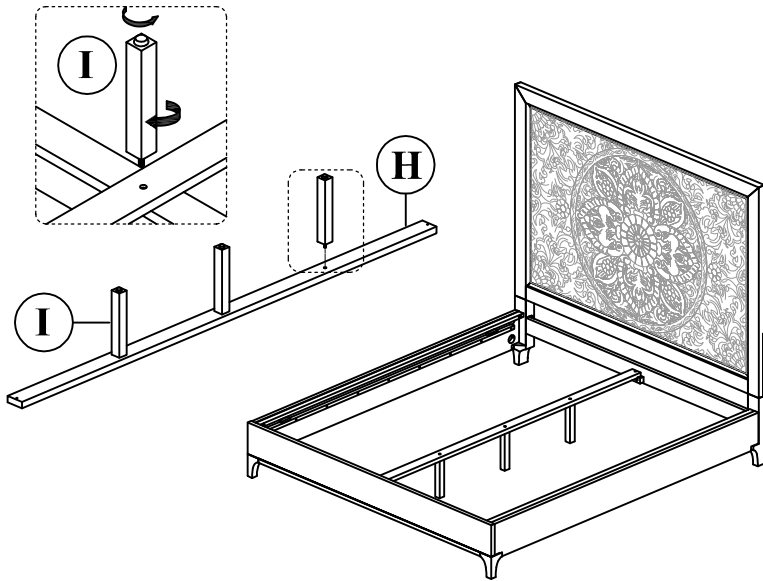

STEP 5:

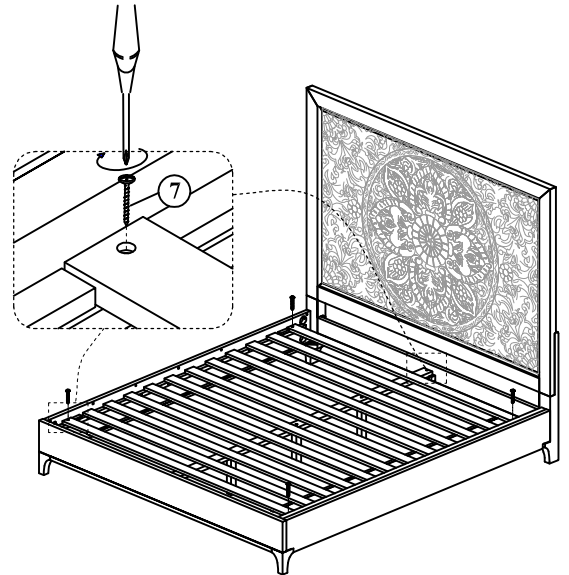

STEP 6:

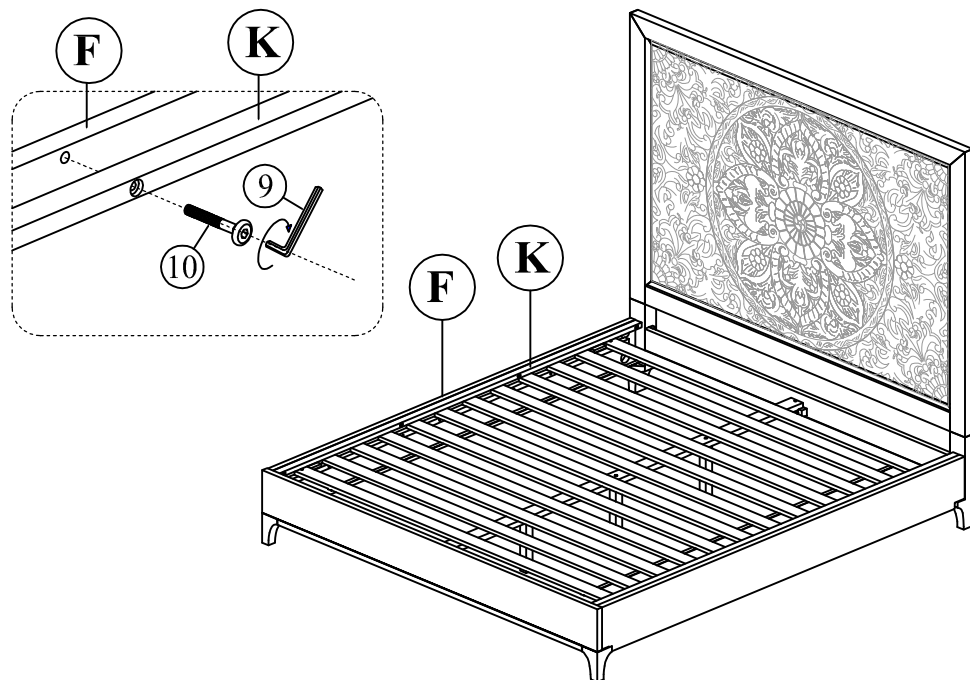

INSTRUCTIONS FOR ADJUSTING LEVELER

POSITION THE BED IN YOUR SPACE AND LOCATE THE LEVELER UNDER EACH SUPPORT LEG. TURN THE LEVELER COUNTER-CLOCKWISE TO EXTEND THE LEVELER AND CLOCKWISE TO RETRACT IT.

ADJUST EACH LEVELER UNTIL EACH SUPPORT LEG IS APPLY EQUAL, UPWARD PRESSURE ON THE SUPPORT SLAT.

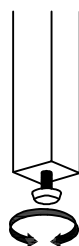

MAINTENANCE INSTRUCTIONS:

REMOVE YOUR MATTRESS, AND BOX SPRING IF APPLICABLE, BEFORE MOVING YOUR BED.

LIFT YOUR BED WHEN MOVING IT; DRAGGING CAN DAMAGE THE SUPPORTS.

RE-ADJUST THE LEVELERS AFTER MOVING YOUR BED.

BOHO CHIC MIRROR ASSEMBLY INSTRUCTIONS



PARTS PACKING CONFIGURATIONS

BOX #1:
A. MIRROR 1 PC
B. MIRROR SUPPORTS 2PCS
* MIRROR HARDWARE PACK

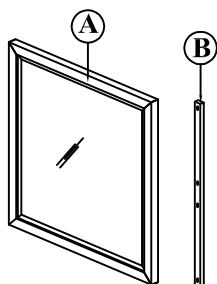

BOX #2:
C. DRESSER (SOLD SEPARATELY) 1 PC

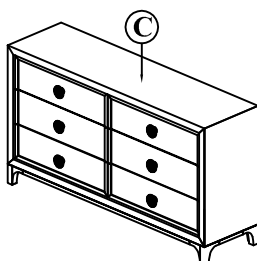

HARDWARE PACKED IN BOX #1

No	Description	Photo	Quantity
1	ALLEN BOLT (M6X50)		8 PCS
2	SPRING WASHER (M6)		8 PCS
3	FLAT WASHER (M6)		8 PCS
9	ALLEN KEY		1 PC

OPTION 1: ATTACHING MIRROR TO DRESSER

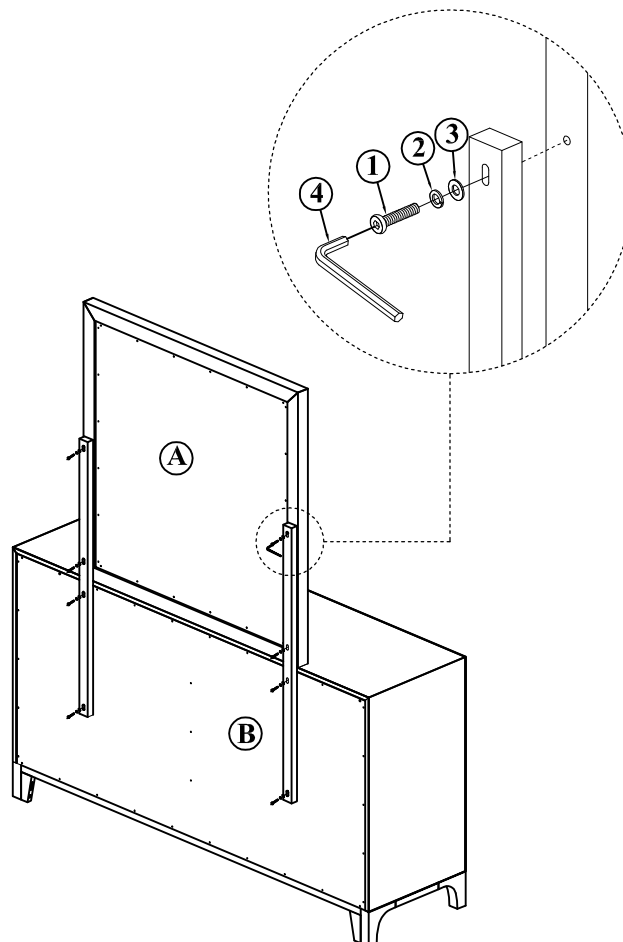

OPTION 2: ATTACHING MIRROR TO WALL

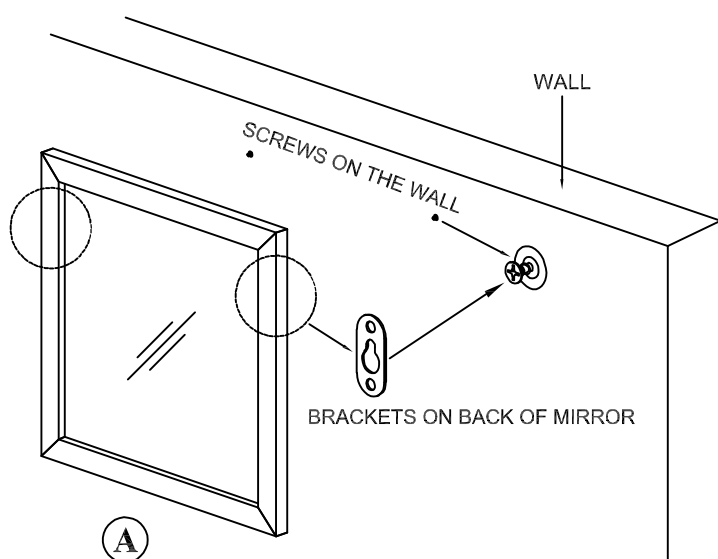

ASSEMBLY COMPLETE

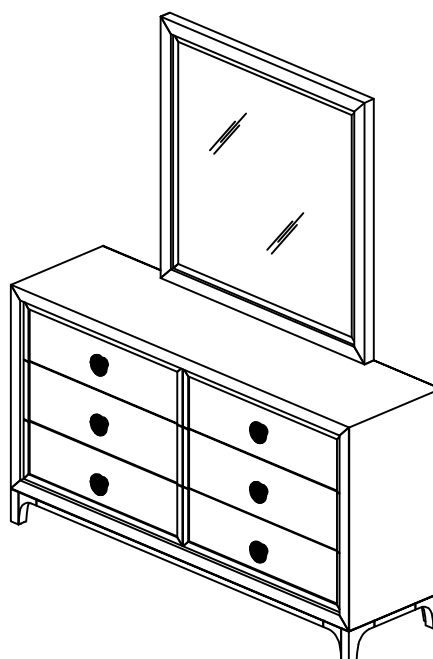

TOOL REQUIRED
PHILLIPS-HEAD SCREWDRIVER (NOT PROVIDED)

