



INSTRUCTION AND USE MANUAL

Safety information

DANGER



TORCH FUEL IS HARMFUL OR FATAL IF SWALLOWED. CONTAINS PETROLEUM HYDROCARBONS. COMBUSTIBLE. READ WARNINGS ON TORCH FUEL BOTTLE CAREFULLY.	DO NOT USE GASOLINE OR OTHER FLAMMABLE FUEL. USE ONLY TIKI® BRAND TORCH FUEL.
READ AND UNDERSTAND THESE INSTRUCTIONS BEFORE USE.	HOT WHILE IN USE.
FAILURE TO FOLLOW WARNINGS AND INSTRUCTIONS MAY RESULT IN SERIOUS INJURY OR PROPERTY DAMAGE.	KEEP CLOTHING, HAIR, AND FACE AWAY FROM FLAME.
FOR OUTDOOR USE ONLY.	DO NOT LEAVE A BURNING TORCH UNATTENDED.
DO NOT PLACE TORCH UNDER COVERED SHELTER OR UMBRELLA, NEAR PEDESTRIAN TRAFFIC, OR NEAR COMBUSTIBLES SUCH AS WOOD STRUCTURES, FUEL, CLOTHING, OR DRY VEGETATION.	DO NOT MOVE THE TORCH WHILE IT IS BURNING.
INSERT POLE INTO THE GROUND AT A MINIMUM DEPTH OF 6 INCHES UNTIL SECURE.	DO NOT TIP TORCH AS FUEL CAN SPILL AND CAUSE FIRE OR SERIOUS INJURY.
KEEP OUT OF REACH OF CHILDREN AND PETS.	DO NOT ATTEMPT TO REFILL A BURNING TORCH. SNUFF THE FLAME AND WAIT 30 MINUTES FOR THE TORCH TO COOL.
USE ONLY IN A WELL-VENTILATED AREA.	DO NOT BLOW OUT THE FLAME.
DO NOT USE WHILE UNDER THE INFLUENCE OF DRUGS OR ALCOHOL.	

RETAIN THESE INSTRUCTIONS FOR FUTURE USE.

©2020 LAMPLIGHT FARMS INC.

TIKI is a trademark of Lamplight Farms Inc.
W140 N4900 Lilly Rd., Menomonee Falls, WI 53051 • www.tikibrand.com

Package Contents

A Torch Head

C Snuffer

E Mounting Bracket (if included)

B Pole Sections (4)

D Fuel Canister

NOTE: Package contents depends on the part number.

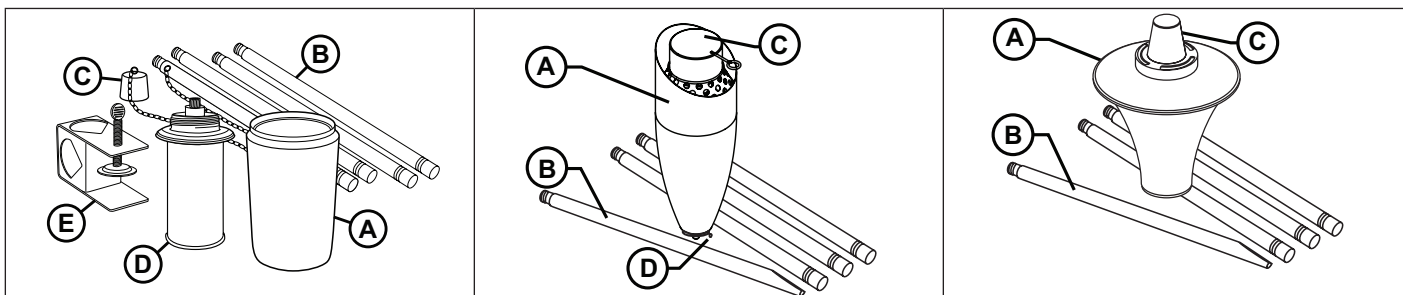

1 ASSEMBLE THE TORCH

The Top pole section has a chain. The Bottom pole section has the angled end and, if included, a hinged step. (Fig. 1)

1. Screw the pole sections together for the height you want. (Fig. 2)
2. Add the torch head to the assembled pole, if it is not attached. (Fig 3)
3. Position the assembled torch before you fill with fuel.

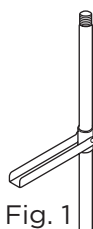

Fig. 1

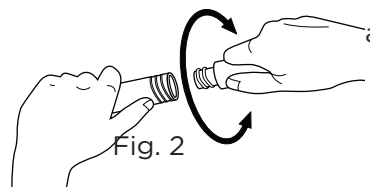

Fig. 2

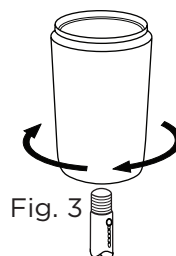

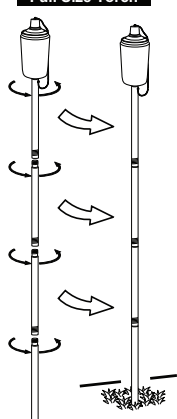

Fig. 3

Torch Height	Pole Sections	To Position
Full Size	4	
Garden	3	 <ol style="list-style-type: none"> 1. Flip the step down into position, if included. 2. Insert pole into the ground. 3. Press the pole into the ground at least 6 inches or until the step is against the ground.
Deck Rail	2	<ol style="list-style-type: none"> 1. Attach the Deck Rail Mounting Bracket at the desired location and tighten. 2. Position the Torch in the Deck Rail Mounting Bracket.
Table Top	None	Place the torch on the table.

Full Size Torch



Garden Torch

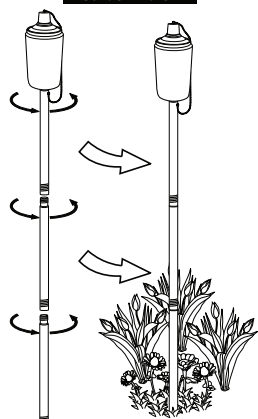

Deck, if bracket included

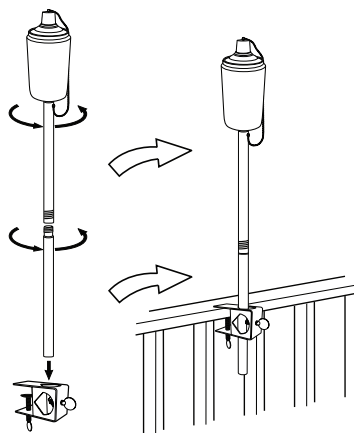
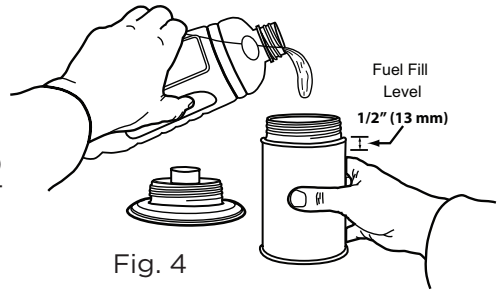

Table Top, for table torches only



2 FILLING AND LIGHTING THE TORCH

1. Fill with TIKI® Brand Torch Fuel to about 1/2 inch (13 mm) below the seam. DO NOT OVERFILL. (Fig. 4)
2. Adjust the wick to expose a maximum of 3/4 inch (19 mm). (Fig. 5) Screw the wick holder into the fuel canister, if one is used. DO NOT OVERTIGHTEN.
3. Place the fuel canister in the decorative torch head. If the wick holder has a tab, align it with the slot on the torch head.
4. Wipe any spilled fuel before lighting.
5. Allow the wick to become saturated with fuel.
6. Use a long lighter or long fireplace match to light the wick.



3 ADJUSTING THE FLAME HEIGHT

- If the torch has a knob, use the knob to adjust the flame height. (Fig. 6)
- Turn the knob counterclockwise to lower the flame.
 - Turn the knob clockwise increase the height of the flame.

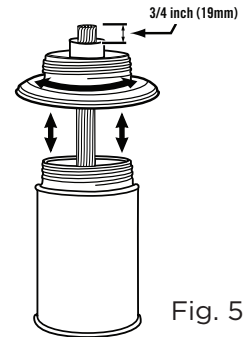

4 EXTINGUISHING THE TORCH

1. If your torch has a knob, turn the knob counterclockwise to lower the flame. (Fig. 6)
2. Place the snuffer over the wick. (Fig. 7) If your torch has a knob, align the notch in the snuffer with the shaft of the knob.
3. When the flame is extinguished, remove the snuffer.
4. Allow the torch to cool for 30 minutes.
5. If your torch has a fuel filter, close it.
6. Place snuffer over wick to protect it from moisture. (Fig. 7) If your torch has a child-resistant cap, place the cap and **turn it clockwise** until tight.

If fuel becomes contaminated with water or the wick gets wet with water, you must replace the wick or fuel. Dispose of the contaminated fuel and wick in accordance with local laws and regulations.

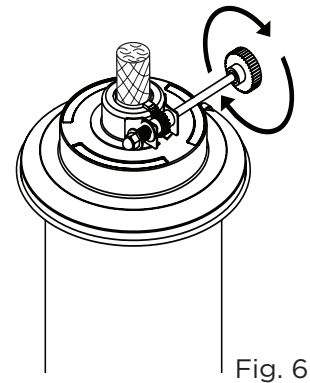

5 STORING TORCHES

1. Store fuel in original bottle with cap secured.
2. Check that the snuffer on each torch is in place. If the torch has a child-resistant cap, verify that it is tight.
3. If the torch has a fuel filter, verify that the opening is closed.
4. Store torches upright in a dry location, away from weather conditions.

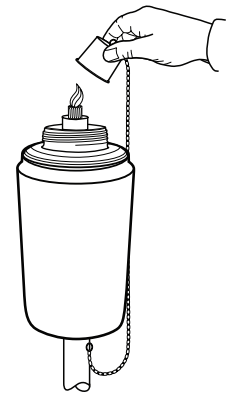



Questions, problems, missing parts? Call Customer Service
1-888-473-1088

TIKIBRAND.COM