

SIDES	BOTTOM
Material: 0.051~0.059"-Stainless steel 316	

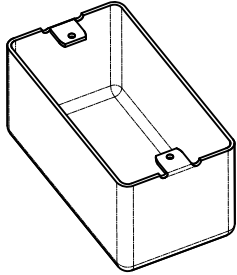

CUTAWAY VIEW B-B

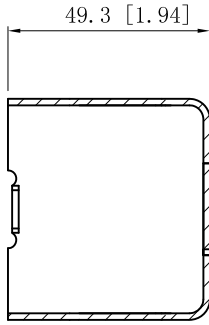
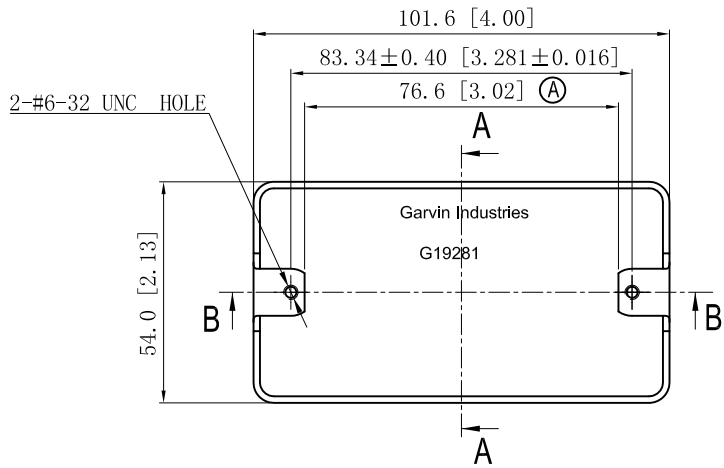

CUTAWAY VIEW A-A

This data sheet is for reference only .GARVIN INDUSTRIES reserves the right to make changes to the design without prior notice.

DESCRIPTION
TRADE REFERENCE TERMS

STANDARD PACKING
50 PCS

GARVIN INDUSTRIES		
TITLE HANDY UTILITY BOXES & EXTENSION RINGS		
SIZE A4	DWG NO. G19281-BLNKSS	REV A
DATA SHEET		
www.garvinindustries.com		