

INSTALLING THE SWIVELS TO THE GUN:

1. Unscrew the swivel locking screw [fig.1] by turning it counterclockwise until it can be moved freely.
2. Push on the end of the swivel locking screw until the gate clears the swivel pin.
3. Rotate the gate to expose the swivel pin. This will allow the pin to be installed through the hole in the swivel stud [fig. 2].
4. Close the gate and align its hole with the swivel pin. Tighten the swivel locking screw by turning it clockwise until tight. Visually check to assure that the base of the swivel locking screw is firmly against the frame of the swivel.
5. Repeat this process for the second swivel.

fig.1



↑
Unscrew swivel locking screw

fig.2

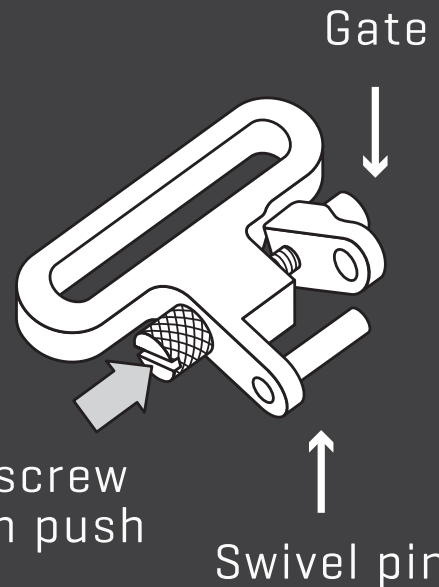

←
Unscrew then push

↑
Swivel pin

CAUTION

SWIVEL MUST BE LOCKED TO PROVIDE MAXIMUM STRENGTH AND DURABILITY. NEVER CARRY THE SLING WITH AN UNLOCKED SWIVEL.

CAUTION

ALWAYS REMEMBER TO FOLLOW THE RULES OF SAFE GUN HANDLING AND STORAGE.