

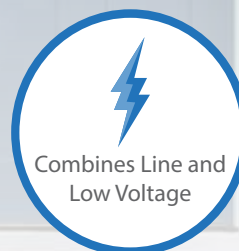

Patent  
Pending



Paintable  
Faceplate



Combines Line and  
Low Voltage



## ELECTRONIC DOOR CHIME **EDC - EDC1120WH1**

The patent-pending Electronic Door Chime (EDC) is a doorbell chime kit that can be installed in new construction homes or retrofitted in existing homes. It uniquely features a door chime that *fits in most single-gang junction boxes* and using the voltage divider, *combines both line and low voltage in one unit*. The EDC comes with the popular *Westminster chime option*, a *paintable faceplate* for a seamless look, and a *lighted doorbell button* to make your doorbell easily visible at night.

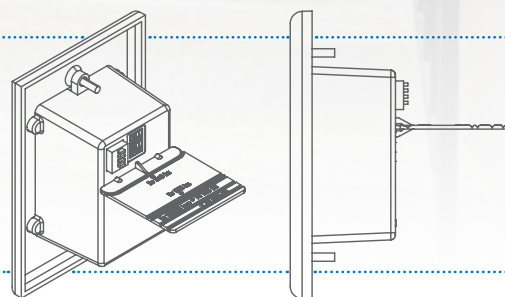

x1  
Lighted Button  
Included



Virtually **eliminate warranty callbacks** and **save installation time and cost** with NICOR's new Electronic Door Chime.



#### Paintable Faceplate

Paintable to match walls

#### Low Voltage

Doorbell Wires

#### Voltage Divider

Combine Line + Low Voltage

#### Line Voltage

Line + Neutral AC Input

#### 1-Gang Junction Box

Fits in most 1-Gang J-Boxes



Westminster Chime

## INSTALLATION INSTRUCTIONS

For detailed instructions, see instruction sheet inside box.

**1.** Carefully unpack fixture. Installation location must have access to both line voltage wiring for the EDC and low voltage wiring for the button.

**2.** Snap off excess material from the voltage divider to an appropriate length.

**3.** Press divider into the Chime, making sure it is fully engaged.

**4.** Connect line voltage wiring. Note: Cap off ground wire in junction box.

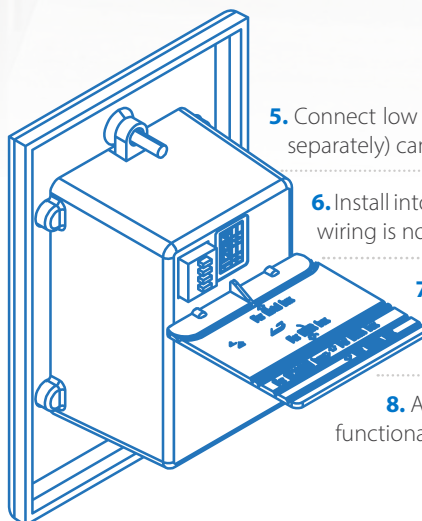

**5.** Connect low voltage doorbell wires. A second button (sold separately) can be installed for control from a second door.

**6.** Install into junction box with the provided screws. Ensure wiring is not pinched or interfering with the divider.

**7.** Attach doorbell button to chime wiring using screw terminals and mount doorbell button.

**8.** Apply power. The button should illuminate. Test functionality of the chime.