

PRE-ASSEMBLY INFORMATION

HARDWARE DESCRIPTION

A

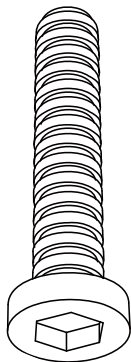

ALLEN KEY SCREW
M8 X 50 mm
QTY 8

B

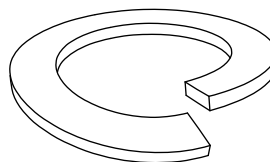

SPRING WASHER
14mm
QTY 8

C

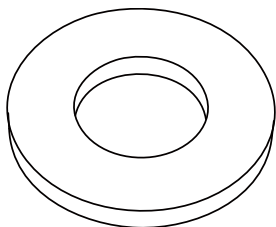

FLAT WASHER
22 mm
QTY 8

D



ALLEN KEY
QTY 1

NEED HELP? For help with assembly or if you are missing a part,
Please call customer service at 1-866-518-0120 ext. 262 (9 am to 4 pm EST)

ASSEMBLY

STEP 1

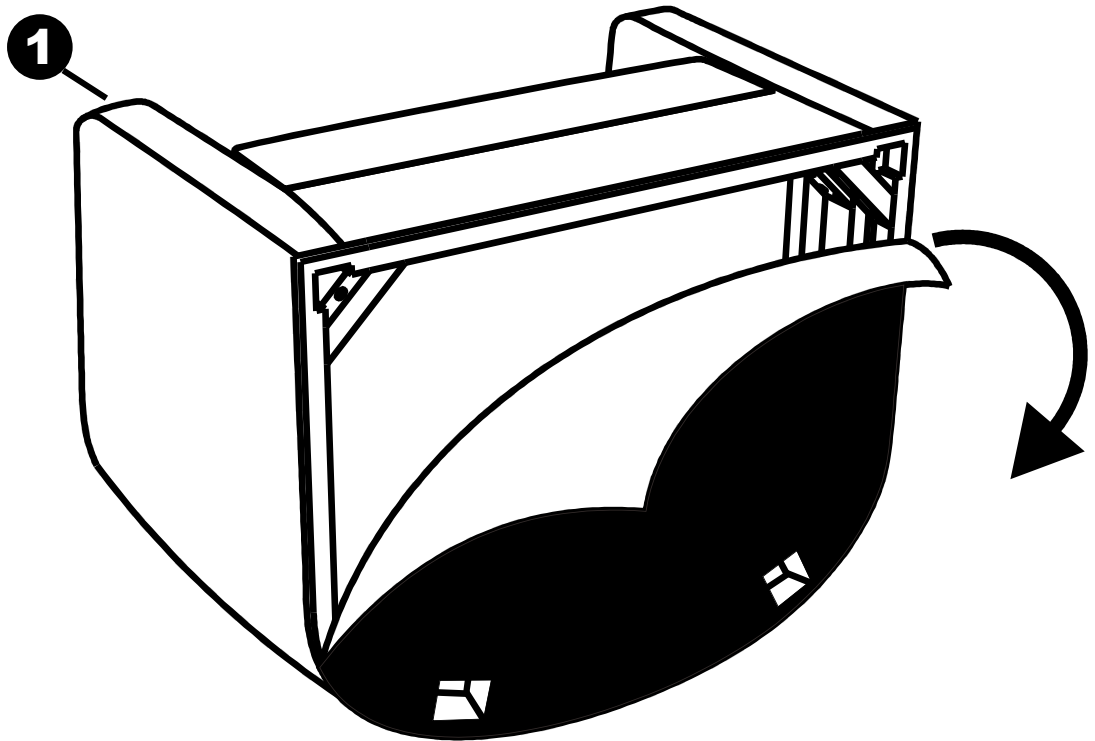

Place the Chair (1) on its back on a flat smooth surface. Remove Feet (2) & (3) and hardware package from inside the fabric of the bottom of the Chair (1).

ASSEMBLY

STEP 2

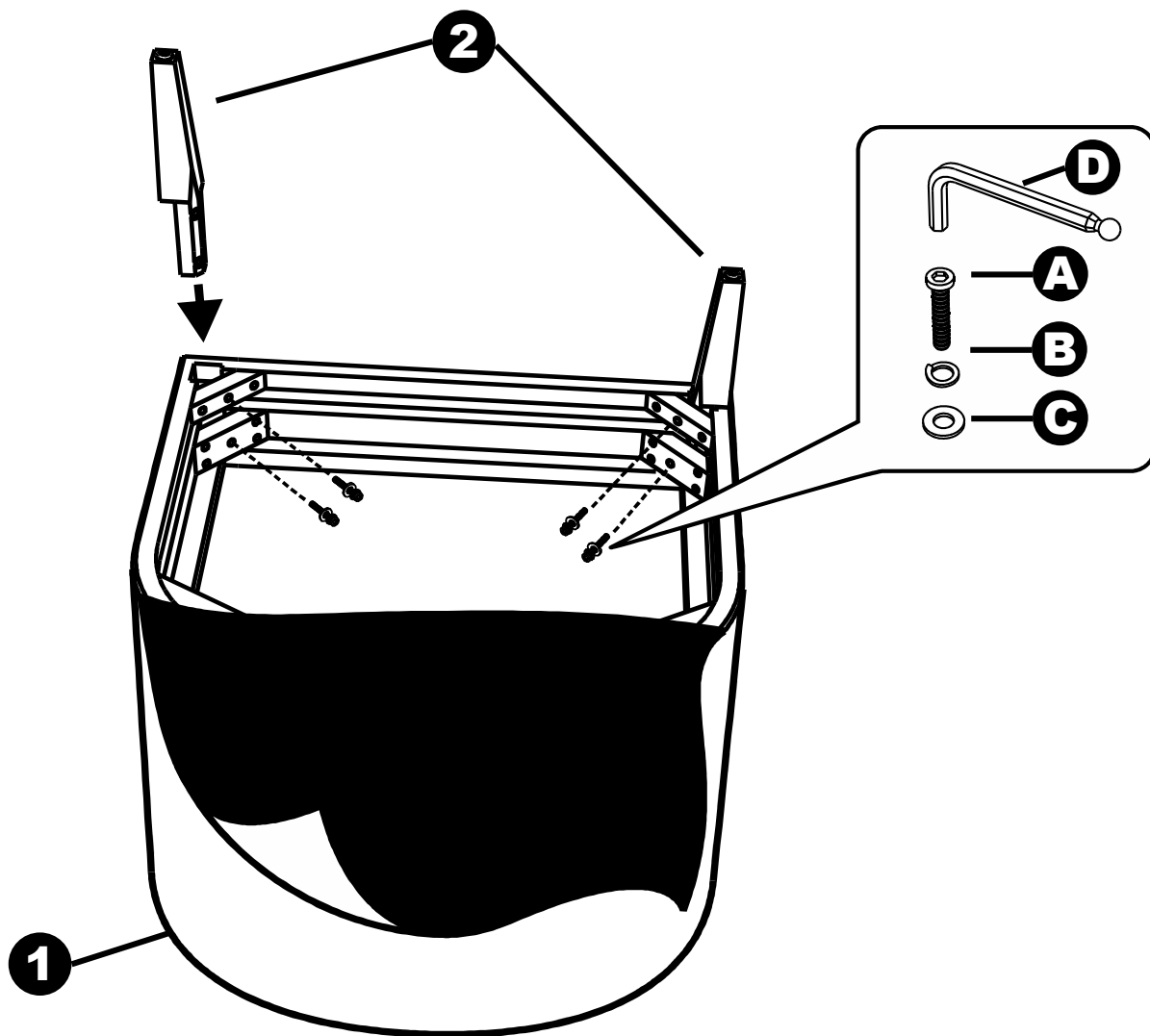

Attach Front Legs (2) to Chair Back (1) using Allen Key Screw (A), Spring Washer (B) and Flat Washer (C). Use Allen Key (D) to tighten.

ASSEMBLY

STEP 3

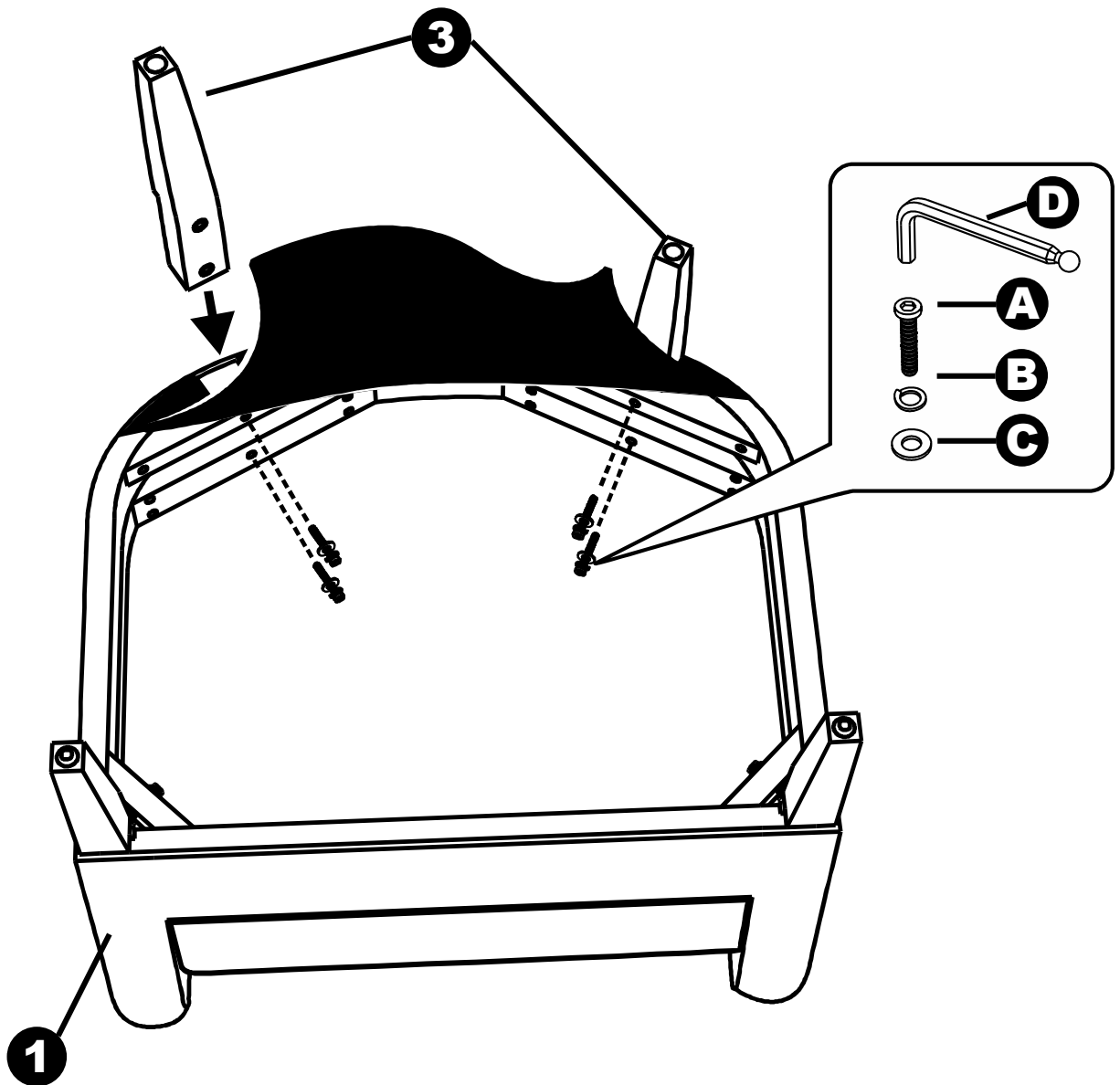

Attach Back Legs (3) to Chair Back (1) using Allen Key Screw (A), Spring Washer (B) and Flat Washer (C).
Use Allen Key (D) to tighten.

ASSEMBLY

STEP 4

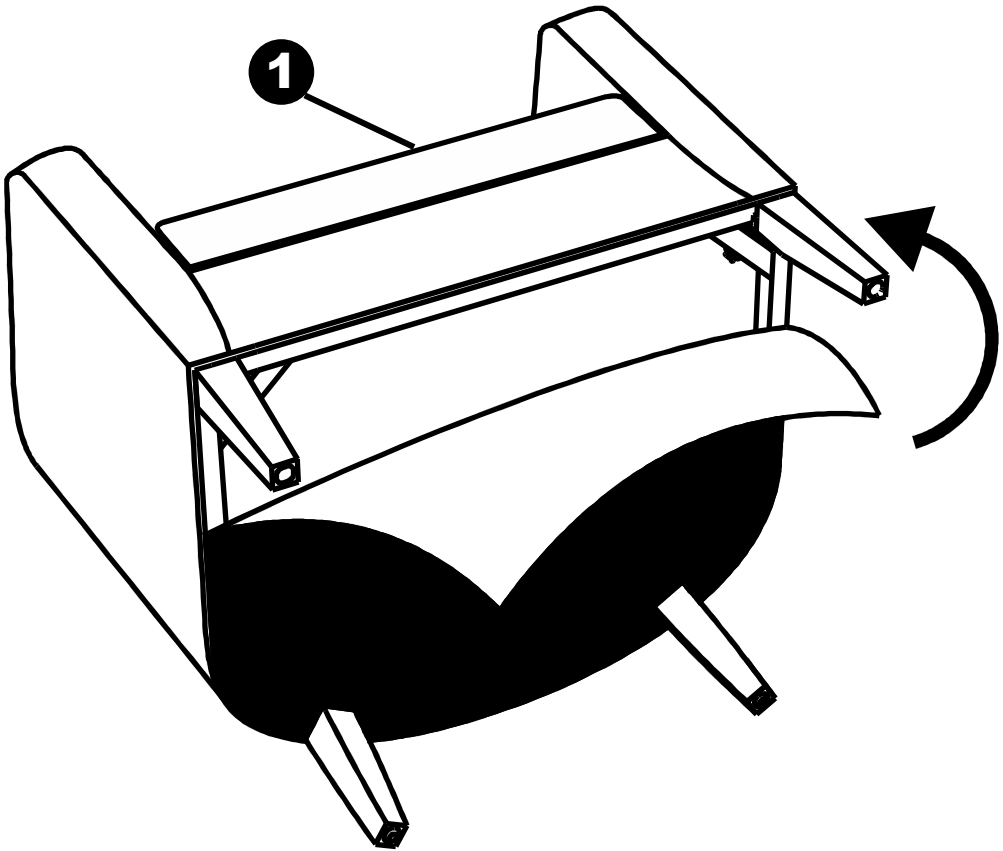

Attach the fabric back on to the bottom of Chair Back (1).

ASSEMBLY

STEP 5

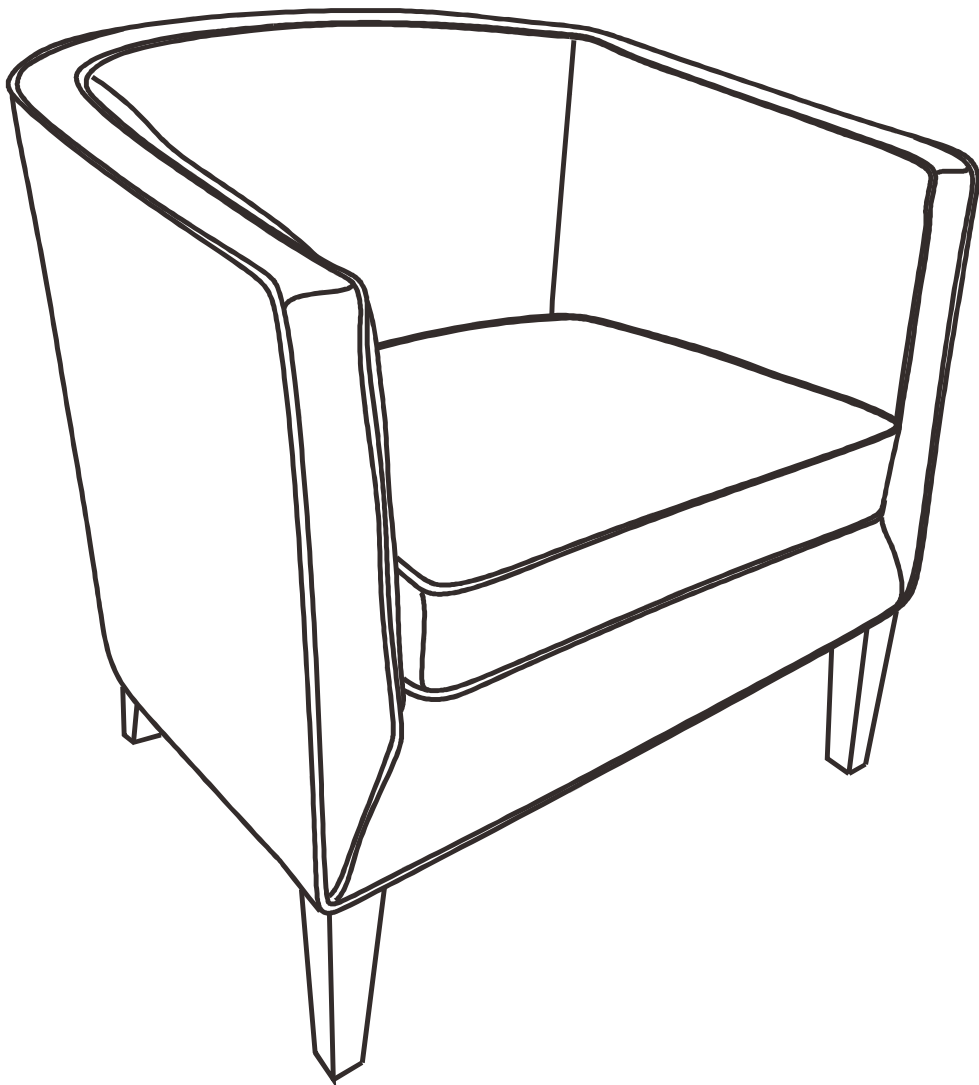

Turn Chair right side up.



WARRANTY

Thank you for purchasing a **Simpli Home – Wyndenhall – Brooklyn + Max** product. These products have been made to demanding, high-quality standards and are guaranteed for domestic use against manufacturing faults for a period of 12 months from the date of purchase. This warranty does not affect your statutory rights.

In case of any malfunction of your product (failure, missing parts, etc.) please contact us at our toll free service line at 1-866-518-0120 ext. 262 from 9 am to 4 pm, Monday to Friday, Eastern Standard Time or by email at simpli-home.com/customer-support.

We reserve the right to repair or replace the defective product, at its discretion.

This product is guaranteed for 12 months if used for normal purposes. Any warranty is invalid if the product has been overloaded or subject to neglect, improper use or an attempted repair by other than an authorized agent. Heavy-duty or daily professional/commercial usage are not guaranteed.

Due to continuous product improvement, we reserve the right to change the product specifications without prior notice.



Questions, problems, missing parts?

Before returning your product
please email Customer Support at
simpli-home.com/customer-support

or call

Customer Support at 1-866-0518-0120 ext. 262
Monday to Friday between 9 am – 4 pm EST

For more information visit us on our website
www.simpli-home.com

Like us on facebook
www.facebook.com/simplihomefurnishings