

SIDES	BOTTOM
2 PCS #8-32×3/8 pack in Poly-Bag seperately	
Material:Steel-0.031"-C.R.S Pored Coated Red	

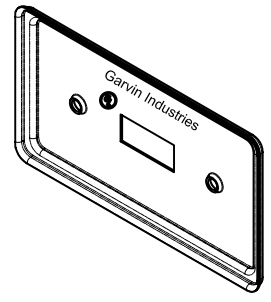
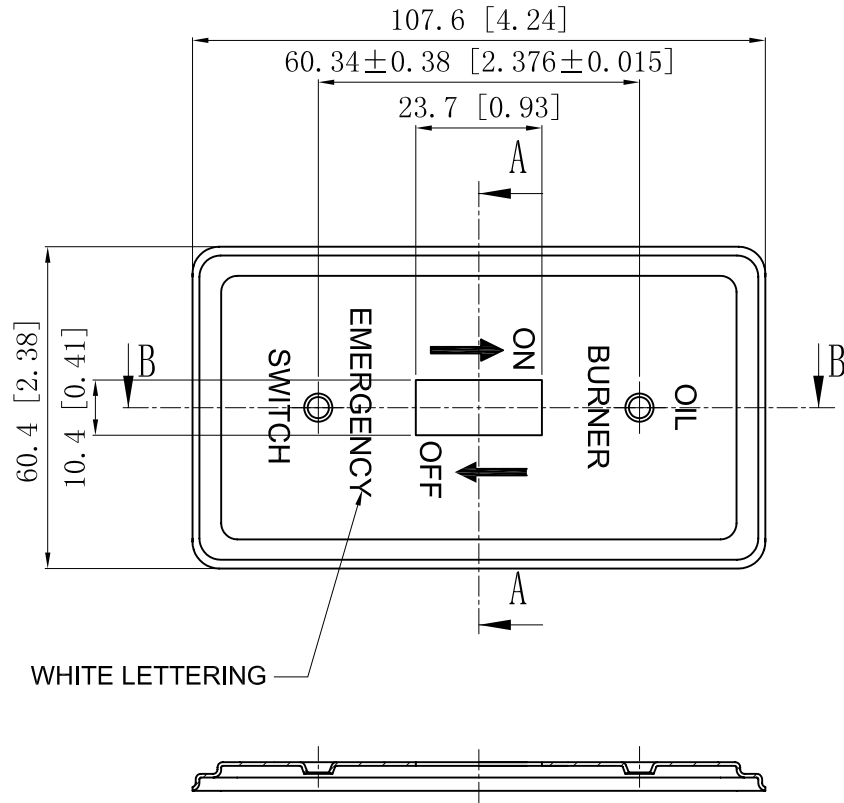
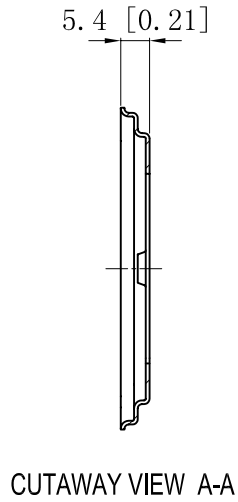

This data sheet is for reference only .GARVIN INDUSTRIES reserves the right to make changes to the design without prior notice.

DESCRIPTION
TRADE REFERENCE TERMS

STANDARD PACKING
25/100 PCS

GARVIN INDUSTRIES		
TITLE 1 GANG STEEL WALL PLATE FOR SHEET ROCK 1-TOGGLE OIL BURNER		
SIZE A4	DWG NO. BPO-19350	REV B
DATA SHEET		