

ASSEMBLY&INSTALLATION

Please read carefully and save these instructions,as you may need them a later date.

CAUTION

Turn off the main power at the circuit breaker before installing the fixture, in order to prevent possible shock.

GENERAL

All electrical connections must be in accordance with local and National Electrical Code(N.E.C) standards. If you are unfamiliar with proper electrical wiring connections obtain the services of a qualified electrician.

Remove the fixture and the mounting package from the box and make sure that no parts are missing by referencing the illustrations on the installation instructions.

ASSEMBLY AND INSTALLATION

1. Carefully unpack the fixture, lay out all parts on a clean surface.
2. Adjust arms of fixture body (1) evenly. Reference to diagram A-A.
3. Remove the finial (3) from nipple (5). Attach mounting bracket (4) to outlet box (7) using outlet box screw (6). Temporarily place fixture body (1) to determine amount of adjustment necessary for nipple (5). Use pliers (not included) to tighten locking nut (15) on nipple until locking nut (15) touches mounting bracket (4).
4. Tie the ground wires (13) from fixture and from outlet box to the ground screw (16) on the mounting bracket (4). Connect the white fixture wire (11) to the supply white wire (neutral wire 10) from the supply circuit. Connect the black fixture wire (9) to the the supply black wire (live wire 8) from the supply circuit.
5. Cover the connections by using provided wire connectors (12). Position wires back inside the outlet box.
6. Place the fixutre body (1) over the outlet box (7), the nipple (5) across the central hole on the canopy, screw the finial (3) on nipple (5) tightly.

ASSEMBLY AND INSTALLATION (CONT.)

7. Install the bulb (14 not included) into the socket. Make sure they do not exceed the maximum wattage specified on the fixture's wattage rating label.
8. Turn on the power.

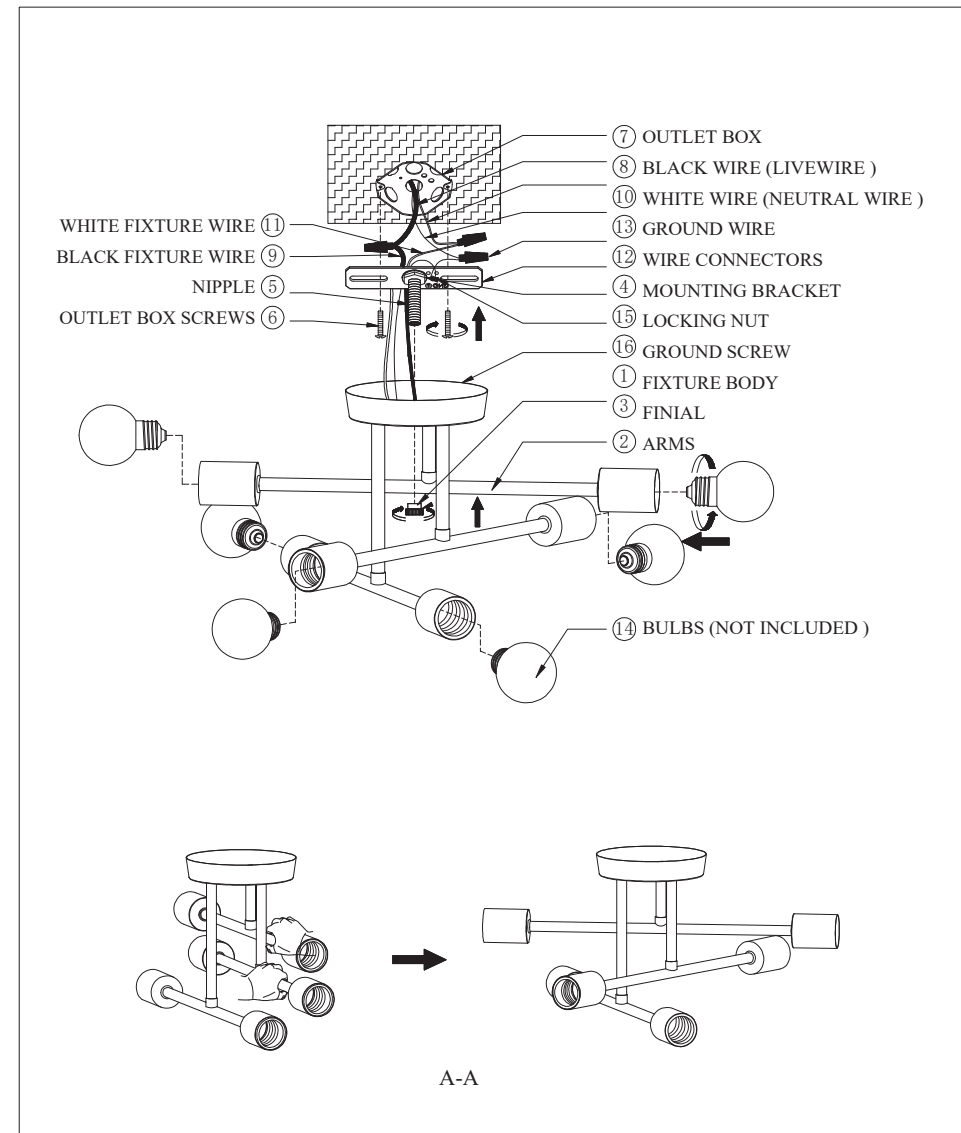
INSTALLATION IS NOW COMPLETED

ITEM NO.: 4256