

Saramonic

UHF Wireless Digital Handheld Microphone
超高频无线数字手持麦克风

UwMic9S HU

User Manual
用户手册



Statement

Please read this manual carefully before use and operate and store in strict accordance with the instructions provided. Please retain for future reference. For any issues that cannot be resolved with the user manual, please refer to your retailer for help or contact us at: info@saramonic.com.

Cautions

1. Do not use the unit under moisture conditions or water, don't expose it to rain. Please store it in a cool, dry place.
2. Please use and store it at normal temperature. Do not move it from overheated to super-cooled condition frequently as well as keep away from heat sources such as heater or oven.
3. When using and storing, please pay attention to dust and moisture.
4. Be careful with violent collisions.
5. To avoid acoustical feedback, do not hold the microphone close to the loudspeakers.
6. For the best pick-up pattern, do not hold your hand against the microphone capsule cover.

Features

- Easy-to-read OLED displays
- 96 UHF channels, 9-level of volumes, 2 groups to select
- Operation range can reach up to 230ft (without obstacle)
- Two charging methods are available (Type-C/Charging dock)
- Built-in 2600mAh Li-ion battery, up to 10 hours of battery life
- Ideal for home karaoke, performance, wedding, conference, etc

Introduction

Saramonic UwMic9S HU is a handheld wireless UHF microphone transmitter that features a compact metallic body, an easy-to-read OLED display and a muting function. The broadcast-quality microphone will capture crystal clear and rich sound. With a built-in antenna, UwMic9S HU supports 230ft operating range (without obstacles), suitable for home karaoke, church, wedding, conference, stage performance.

Product Structure

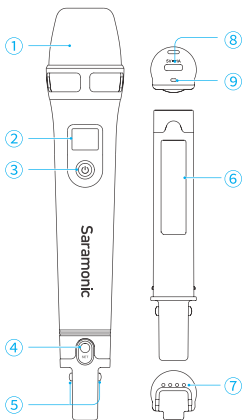

- ① Microphone capsule**
- ② OLED display screen**
For more details, please refer to "OLED Display Operation Guide" on 03 page.
- ③ Power / Mute button**
Power: Long press to turn on/off the microphone.
Mute: Short press the button while transmitting, the audio will be muted. Press it again to restore the audio output.
- ④ SET button**
Long press the SET button to enter the displayed menu setting or save options and exit.
Short press the SET button to switch settings.
- ⑤ "Remove" button of battery**
Press and hold the "Remove" button on both sides and pull it backward to remove the battery.

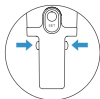

⑥ **Li-ion battery**

⑦ **Charging contacts**

There are charging contacts at the bottom of the battery, which can be directly inserted into the charging dock (sold separately) for charging.

⑧ **USB-C charging port (DC 5V) of Li-ion battery**

After the battery is removed, you can use USB-C charging cable to connect the power supply for charging the battery.

⑨ **Charging indicator of Li-ion battery**

Status	Charging Indicator
Charging	Static Red
Fully charged	Static Blue

OLED Display Operation Guide

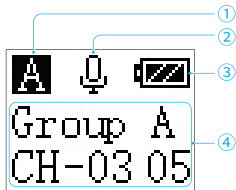

① **Group icon**

Indicate the channel group. (**A** / **B**)

② **Mute indicator**

 Mute OFF  Mute ON

③ **Battery level indicator**

Displays the current battery level. Please remove and charge the battery in time when the indicator starts flashing.

④ **Menu setting**

a. Channel group (A/B)

- You can choose "A" or "B" channel group. Each group has 96 channels. Default is "Group A".

b. Channel (01-96)

- Select the channel within the range 01 to 96. Default is "CH-01".

c. Volume (00-08)

- Set the volume of output audio within the range 00 to 08. Default is "05".

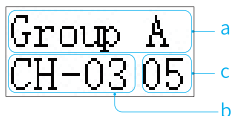

How to set the menu?

1. Press and hold the SET button to enter the menu settings. Then short-press the power button to select the desired option of group/ channel/ volume, their indicating icons will be flashing.
2. Short press the SET button to switch among 3 different settings or press and hold the SET button again to save the option and exit the menu settings.
3. When setting channel/ volume, press and hold the power button to quickly select the option.
4. If there is no operation within 10s, the menu setting would exit automatically.

Note: In order to prevent shutdown caused by misoperation, UwMic9S HU will automatically disable the ON or OFF function of power button after entering the menu setting and restore it after exiting.

Setup Guide

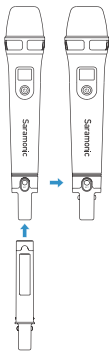

1. Secure the battery firmly to the bottom of the microphone.
2. Press and hold the power button to turn on UwMic9S HU.
3. After successfully syncing the group and channel of the transmitter UwMic9S HU with the UwMic9S RX receiver, they will be automatically paired.
4. You are ready to record.

Note:

- ① Please remove the the battery from the microphone when the device is not used for a long time.
- ② Please always use the same type of battery.
- ③ Removing the battery during operation may generate noise. Please make sure that the unit is turned off before removing the battery.

Package Contents

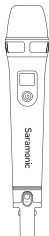

UwMic9S HU Handheld
Microphone × 1

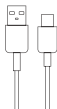

3.9' (1.2m) USB-A to USB-C
Charging Cable × 1

UwMic9S Series Products



UwMic9S
TX



UwMic9S
TX Mini

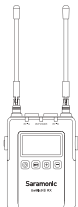

UwMic9S
RX



UwMic9S
RX Mini



UwMic9S
RXUC



UwMic9S
RXDi

Specifications

Display	0.66" OLED
Modulation	FM
Frequency range	UHF
Channel number	96 (Different countries have different UHF standards)
Channel group	A/B
Polar pattern	Super cardioid
Sensitivity	0~-52.4dB \pm 3dB(0dB = 1V / uBar at 1kHz)
Carrier frequencies	514MHz- 596MHz
Reference deviation	\pm 5kHz (-60dBV, 1kHz input)
SNR	\geq 75dB
Voice delay	<0.2ms
Antenna	Built-in antenna
Reference audio input level	-30~-42dBV (MIC input, 0dB attenuation)
Distortion	0.1% or less (32 Ω , 1kHz, 65mW output)
RF output power	<10mW
Frequency response	40Hz~12kHz
Operating range	Up to 230ft (70m) without obstacles
Power requirements	3.7V/2600mAh Li-ion Battery
Battery life	Approx. 10 hours
Dimensions	10.33*1.96*1.96" (262.5*50*50mm)
Weight	Approx. 12.87oz (365g)

声明

请在使用前仔细阅读本手册，并严格按照说明进行操作和存储。请保存以供将来参考。如果用户手册不能帮助您解决某些问题，请向零售商寻求帮助或给我们发送电子邮件：info@saramonic.com。

注意事项

1. 请勿在水下使用本机，不要将其暴露在雨中。请存放在阴凉干燥处。
2. 请在常温下使用并保存。请勿经常在冷热交替状态下使用设备，并远离加热器和烤箱等热源。
3. 使用和存放时，请注意防尘和防潮。
4. 避免剧烈碰撞。
5. 为避免声音反馈，请勿将麦克风靠近扬声器。
6. 为获得最佳拾音模式，请勿将手放在麦克风咪头上。

特点

- 易于阅读的 OLED 显示屏
- 支持 96 个 UHF 频道，9 档增益，2 个通道组选择
- 使用距离可达 70 米（无障碍）
- 两种充电方式可供选择（Type-C/ 充电座充电）
- 内置 2600mAh 锂离子电池，续航时间长达 10 小时
- 非常适合家庭卡拉 OK、表演、婚礼、会议等场景

概述

枫笛 UwMic9S HU 是一款手持式无线话筒 UHF 发射机。其拥有小巧的金属机身以及易于阅读的 OLED 显示屏，设有静音功能。广播级别麦克风，能够捕捉水晶般清澈而丰富的声音。它具有内置天线，支持 70 米无障碍使用距离，适用于家庭卡拉 OK、教堂、婚礼、会议以及舞台表演。

产品结构

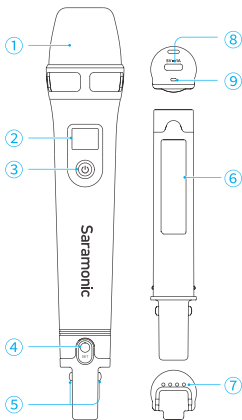

① 麦克风咪头

② OLED 显示屏

详情请参考“OLED 显示屏操作指南”。

③ 电源 / 静音键

电源键：长按打开 / 关闭 UwMic9S HU。
静音键：在音频输出时短按变为静音，再次短按恢复音频输出。

④ SET 键

长按 SET 键进入菜单设置或保存选项并退出。
短按 SET 键切换不同功能设置。

⑤ 电池拆卸按钮

按住两侧电池拆卸按钮向后拉即可取出电池。

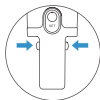

⑥ 锂电池

⑦ 充电触点

电池底部留有充电触点，可直接插入充电座（单独出售）进行充电。

⑧ 锂电池 Type-C 充电口（直流电 5V）

取下电池后，使用 Type-C 数据线连接电源为电池充电。

⑨ 锂电池充电指示灯

状态	充电指示灯
充电中	红灯常亮
充满电	蓝灯常亮

OLED 显示屏操作指南

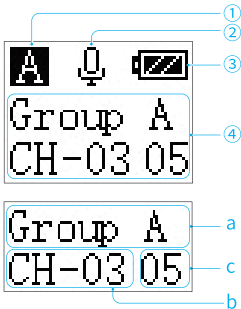

- ① 通道组图示
表示通道组 (A / B)
- ② 静音指示
🔇 静音关闭 🔊 静音开启
- ③ 电池电量指示
显示当前电量情况。当电池图标开始闪烁时请及时取出电池充电。
- ④ 菜单设置界面
 - a. 通道组 (A/B)
 - 可以选择“A”或“B”通道组。每个通道组有 96 个频道。系统默认“A组”。
 - 频道设置范围为 01-96。系统默认“CH-01”。
 - b. 麦克风增益 (00-08)
 - 输出音量设置范围为 00-08。系统默认“05”。

如何设置菜单？

1. 长按 SET 键进入菜单设置，短按电源键选择通道组 / 频道 / 增益所需选项，其指示图标呈闪烁状态。
2. 短按 SET 键可在 3 种功能设置中切换，或再次长按 SET 键保存选项并退出菜单设置。
3. 进行频道设置和增益设置时，长按电源键可快速选择频道和音量。
4. 若在 10 秒内无任何操作，UwMic9S HU 将自动退出菜单设置。

注意：为防止误操作导致关机，产品电源键的开关机功能将在进入菜单设置后自动关闭，退出菜单设置后即恢复。

设置向导

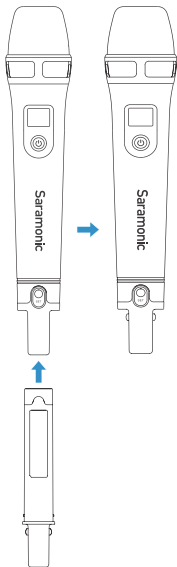

1. 将电池紧紧安装在麦克风底部。
2. 长按电源键启动 UwMic9S HU。
3. 将 UwMic9S HU 话筒的通道和频道调节到与 UwMic9S RX 接收器一致，UwMic9S HU 话筒与 UwMic9S RX 接收器将自动联机。
4. 开始录制。

注意：

- ① 长时间不使用设备时，请将电池从麦克风取出。
- ② 请始终使用同类型电池。
- ③ 操作过程中取出电池可能会产生噪音。请确保该装置在取出电池之前已关闭。

包装清单



UwMic9S HU
手持麦克风 × 1

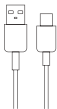

1.2米 USB-A 转
Type-C 充电线 × 1

枫笛 UwMic9S 系列



UwMic9S
TX



UwMic9S
TX Mini

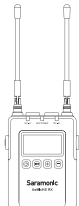

UwMic9S
RX



UwMic9S
RX Mini



UwMic9S
RXUC



UwMic9S
RXDi

参数

显示屏	0.66 英寸 OLED 显示屏
调制方式	FM
频段范围	UHF
频道数	96 (不同国家 UHF 标准不同)
频道组	A/B
拾音模式	超心型
灵敏度	0~-52.4dB ± 3dB(1kHz 时 0dB = 1V / uBar)
载波频率	514 MHz- 596 MHz
参考偏差	± 5kHz (-60dBV, 1kHz 输入)
信噪比	≥ 75dB
声音延迟	<0.2ms
天线	内置天线
参考音频输入电平	-30~-42dBV (MIC 输入, 0dB 衰减)
失真	≤ 0.1% (32Ω, 1kHz, 65mW 输出)
射频输出功率	<10mW
频率响应	40Hz~12kHz
操作距离	高达 70 米 (无障碍)
供电方式	3.7V/2600mAh 锂电池
电池续航	约 10 小时
尺寸	262.5*50*50mm
重量	365g



For better recording experience, the application **SmartRecorder** is recommended.

为获得更好的录制体验，推荐使用枫笛 Saramonic 自主研发应用软件 **SmartRecorder**。



Scan the QR code and follow us!
扫描微信关注枫笛公众号

Shenzhen Jiayz Photo Industrial., Ltd
深圳市长丰影像器材有限公司

A16 Building, Intelligent Terminal Industrial Park of Silicon Valley
Power, Guanlan, Longhua District, Shenzhen, China
深圳市龙华区观澜街道大富工业区硅谷动力智能终端产业园 A16 栋

☎ 400-613-1096

🌐 www.saramonic.com

✉ info@saramonic.com