



2- Door Warmer/Merchandiser

Item No: **51040/51048**

120V~60 Hz, 600W, 5A



WARNING ELECTRICAL SHOCK HAZARD.

FAILURE TO FOLLOW THESE INSTRUCTIONS COULD RESULT IN SERIOUS INJURY OR DEATH.

WARNING: Handling the cord on this product may expose you to lead, a chemical known to the State of California to cause cancer and birth defects or other reproductive harm. WASH HANDS AFTER HANDLING.

Electrical ground is required on this appliance.

1. Do not modify the power supply cord plug. If it does not fit the outlet, have a proper outlet installed by a qualified electrician.
2. Do not use an extension cord with this appliance.
3. Check with a qualified electrician if you are in doubt as to whether the appliance is properly grounded.

SAFETY INSTRUCTIONS

1. Plug electrical cord into a certified electrical outlet with a corresponding voltage rating as listed on the machine model labels.
2. Always unplug the electric cord when appliance is not in use and before cleaning, adjusting or maintaining this steamer. Do not operate with a damaged cord or plug or after the machine malfunctions, has been dropped or damaged. Use authorized service for examination, electrical or mechanical adjustment or repair.
3. This equipment will be HOT during use and for a short time after it is turned off. BE CAREFUL. To avoid burns, do not let bare skin touch hot surfaces. If provided, use handles when moving this appliance. Keep combustible materials away from appliance.
4. Extreme caution is necessary when any appliance is used by or near children and whenever the appliance is left operating and unattended.
5. This appliance is not intended for use in wet locations. Never locate appliance where it may fall into a water container.

Do not insert or allow foreign objects to enter any ventilation or exhaust opening as this may cause an electrical shock, fire or damage to the appliance.

ASSEMBLY INSTRUCTIONS

1. The Warmer has an operator side (the side with the controls) and a customer side.
2. Remove the nylon packing ties and tape on the shelves and brackets.
3. For **Front Counter Applications** you can position the shelves either in a flat or sloping format.
 - a. For Flat shelves – position the shelves using the corresponding height slots on both sides.
 - b. For Sloping shelves – position the shelves on higher slots on the operator side.
4. Plug the machine into a properly grounded 120 volt outlet.
5. Turn on the warming element with the front switch.
6. Adjust the thermostat to the desired temperature. (The LIGHT will remain on until the cabinet reaches the set temperature)
7. Load the warmer with the desired amount of food product.
8. Turn the machine off when not in use.

CLEANING

1. Turn off the machine and unplug it from the power source.
2. Remove any remaining food product from the machine.
3. Remove the shelves from the Machine and clean in a sink or dishwasher with mild detergent.
4. Clean out any food product from the base of unit with a damp cloth and mild detergent.
5. Clean the glass panels and cover with any standard glass cleaner.
6. Re-assemble the machine.
7. Plug the machine back into the 120 volt power source.

DIAGRAM

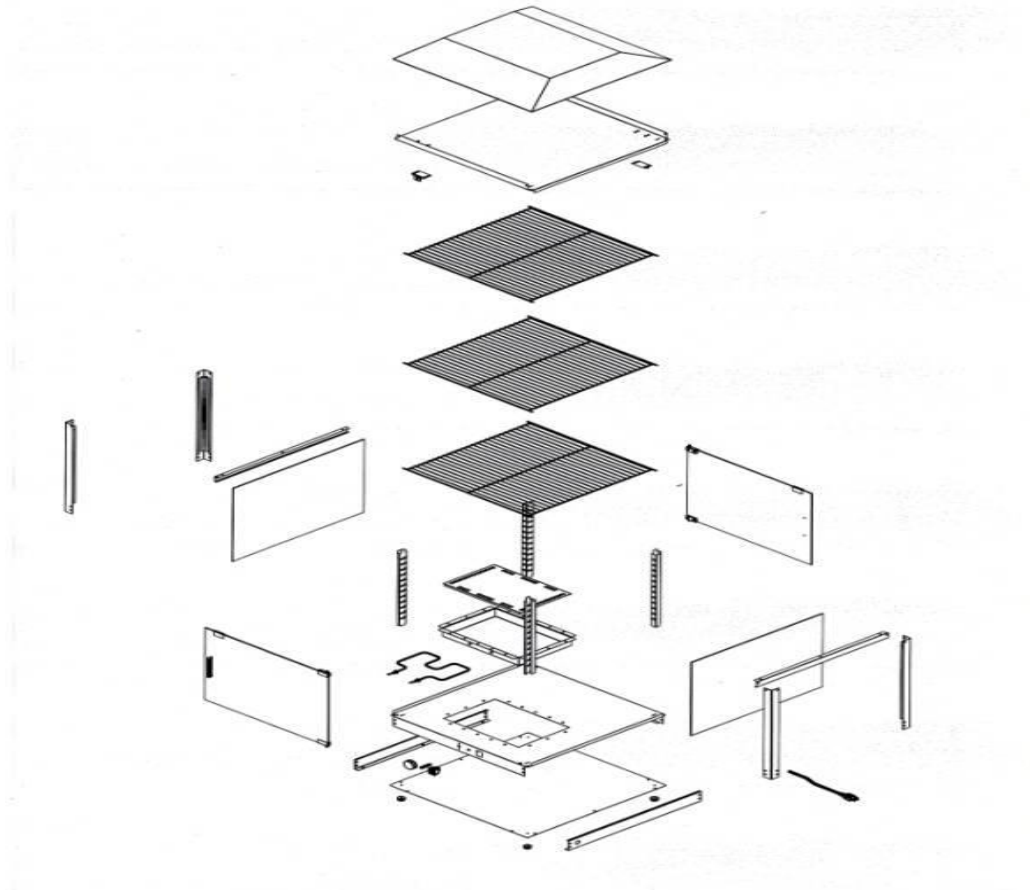

PARTS LIST

Part #	Description
5401	On/Off switch
5402	Thermostat
5403	Thermostat Dial
5404	Heating Element
5405	21" Shelf
5406	13" Shelf
5407	Shelf Bracket
5408	Glass Door (51048)
5409	Glass Door (51040)
5410	Door Hinge

Part #	Description
5411	Door Handle
5412	Door Magnet
5413	Door Strike Plate
5414	Canopy (51040)
5415	Side Glass (51040)
5416	LED
5417	Decal (51040)
5418	Canopy (51048)
5419	Side Glass (51048)
5420	Decal (51048)

Wiring Diagram

