

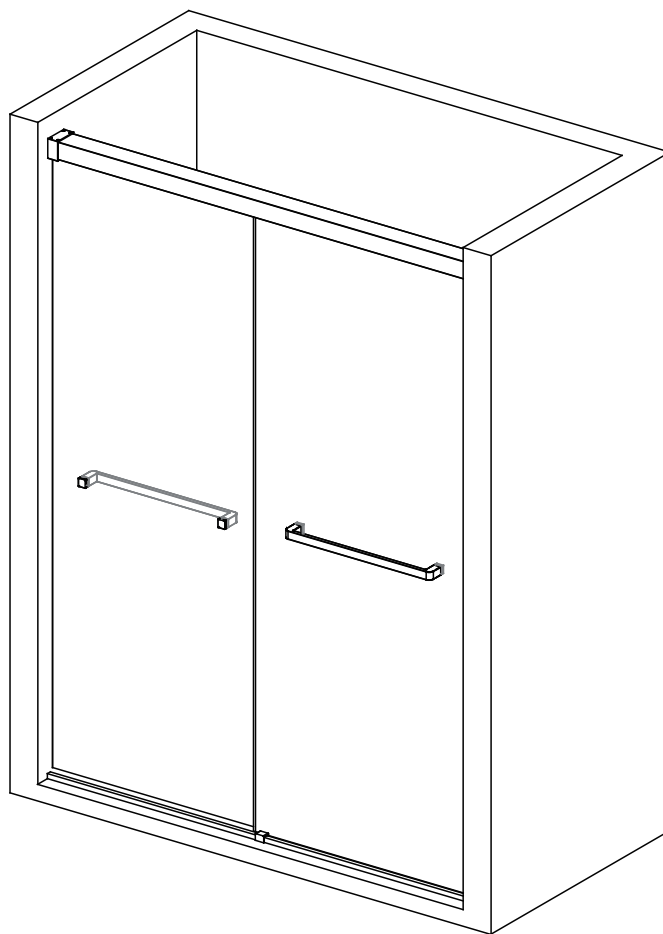

ITEM: SD-AZ21-01**
SD-AZ21-02**
ANZZI GLASS SHOWER DOOR
INSTALLATION & OPERATION MANUAL
V1.1
06/15/2025



DON'T WAIT! REGISTER NOW!

Register your product within 90 days to ensure it is recognized as a purchase and covered under warranty.

Register online at <https://anzzi.com/pages/register> or scan the QR code on PG. 2.



PRODUCT REGISTRATION*

IMPORTANT: Warranty will not be recognized unless product is registered.

Register online at <https://anzzi.com/pages/register> or Scan the QR code below.

Registering your product maximizes your warranty benefits and ensures prompt service and support.

1

USE YOUR PHONE CAMERA
TO SCAN THE QR CODE



2

FILL IN A QUICK
REGISTRATION FORM

Thank you for your purchase!

Registering your products ensures you maximize your warranty benefits and receive prompt service and support.

Name*

Email*

City*

Order #*

Installer Name

Model Purchased*

Installer Phone Number

Customer Age Range

Submit

3

CLICK SUBMIT AND
ENJOY PEACE OF MIND

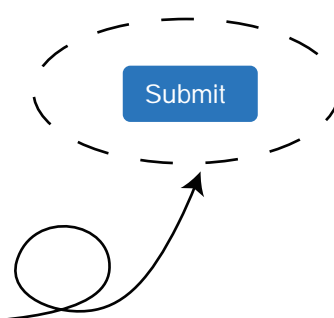

Need help? For technical support call **305-614-4070** or visit us at **www.ANZZI.com**

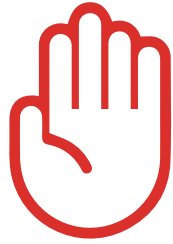

STOP!

READ BEFORE YOU PROCEED!

TO KEEP GLASS FROM BREAKING, MAKE SURE:

- 1. Due to the weight of this product, at least two people are needed for a safe installation.**
- 2. Glass corner protectors remain on during installation.**
- 3. Glass protective seals are mounted to the door before opening/closing.**
- 4. Glass panels are aligned & level with wall/floor.**
- 5. Stoppers must be installed correctly. Prevents door from striking wall.**
- 6. Slider must be installed correctly for smooth sliding.**

SAFETY PRECAUTIONS

General Safety Warnings

1. **Read Instructions First** – Carefully read the entire installation manual before beginning. Improper installation may result in product failure or injury.
2. **Use Proper Tools** – Always use the recommended tools and hardware to ensure safe and correct installation.
3. **Work with a Partner** – Due to the weight and fragility of glass panels, never attempt to install them alone. A minimum of two people is required.

Handling Tempered Glass Panels

4. **Do Not Strike or Edge-Load the Glass** – Tempered glass is strong but can shatter if struck on its edges or corners.
5. **Always Carry Glass Vertically** – Transport and handle glass panels in an upright position to reduce the risk of breakage.
6. **Wear Protective Gear** – Use safety gloves, closed-toe shoes, and eye protection when handling glass.
7. **Inspect Before Installation** – Check for cracks, chips, or defects before installation. Do not install damaged glass panels.
8. **Do Not Drill or Modify the Glass** – Altering the glass in any way can compromise its integrity and cause it to shatter.
9. **Keep the Glass in a Secure Area Until Installation** – Store glass panels upright on a non-slip surface, away from heavy traffic areas.
10. **Avoid Sudden Temperature Changes** – Do not expose tempered glass to extreme temperature shifts, as this can cause it to shatter.

Installation Precautions

11. **Secure the Work Area** – Ensure the installation site is free of obstacles, water, or debris to prevent slipping or dropping the glass.
12. **Check Wall and Floor Strength** – Ensure mounting surfaces are sturdy enough to support the shower door assembly.
13. **Tighten Fasteners Securely but Cautiously** – Over-tightening hardware can stress and damage glass components.
14. **Follow Manufacturer's Weight Limits** – Ensure that the structure can support the weight of the installed shower doors.

Post-Installation Warnings

15. **Do Not Slam the Doors** – Forcefully closing shower doors can cause damage or breakage over time.
16. **Regularly Check for Loose Hardware** – Periodically inspect hinges, rollers, and handles for stability.
17. **Do Not Hang Items on Glass Doors** – Hanging towels or objects on the doors may stress the hardware or glass, leading to breakage.

WARNING

PROTECTIVE EQUIPMENT MUST BE WORN WHEN HANDLING GLASS



INSTALLATION GUIDE

BEFORE YOU BEGIN

- Please check the product for damage and missing parts immediately upon delivery. Damage reported after installation will not be covered under our warranty. Please handle the product with care. Avoid impacting the sides and edges of the glass.
- Consult your local building codes before installation.
- To reduce the risk of breakage, keep the corner protectors on the glass during installation.
- If this unit is being installed in new construction, please install all required plumbing and drainage before installing the shower. Use a licensed plumber or contractor for all plumbing installations if required by local code.
- Before beginning installation, make sure all surfaces are level, solid and will support the total weight of the unit. Also, make sure the walls are at right angles. An uneven installation surface, rounded corners, or improperly angled side walls can cause serious installation problems. Please note that some adjustments and drilling might be necessary during the installation process.
- Protect all primary surfaces of the product during installation. Never place the glass directly on a tile floor. Keep the corner protectors in place until they need to be removed. Always use wood or cardboard to protect the bottom edge and corners of the glass before and during installation.



WARNING

- Install this unit on a finished threshold and against finished walls.
- Avoid drilling into hidden pipes or electrical cables when making holes in the walls.
- Due to the weight of this product, at least two people are needed for a safe installation.
- When cutting or drilling metal components or handling glass, wear protective eyewear, gloves, and closed-toe shoes to minimize the risk of personal injury.
- Failure to follow these instructions may result in personal injury, property damage, or product failure, and could void the warranty.

INSTALLATION GUIDE

BEFORE YOU BEGIN



ATTENTION

- The surface of the threshold must be level for proper installation.
- This model requires a minimum 2.7" (68 mm) flat level threshold space for installation.

Tools Required



- This product is heavy and requires two people to install.

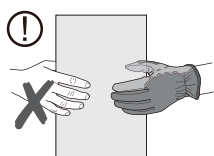

- Use cut-resistant, non-slip gloves to reduce the risk of personal injury and to hold the glass firmly.

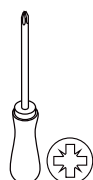

Phillips
Screwdriver

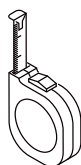

Tape
Measure

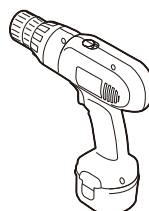

Drill



1/8"
(3mm)
Drill Bit



7/32"
(5.5mm)
Drill Bit



5/16"
(8mm)
Drill Bit

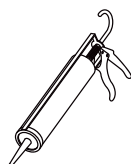

100%
Silicone
Sealant



Pencil



Rubber
Mallet



Safety
Glasses

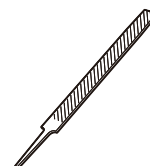

Metal File



Tin Snips



Stud Finder

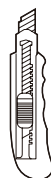

Knife



Level

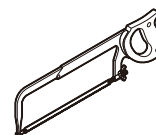

Hack
Saw

or

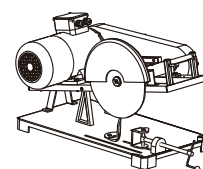

Chop
Saw



This product is heavy and requires two people to install.

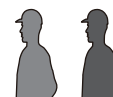



WARNING

To prevent damage to glass and potential injury, carefully follow the instructions on **page 4**.

PARTS

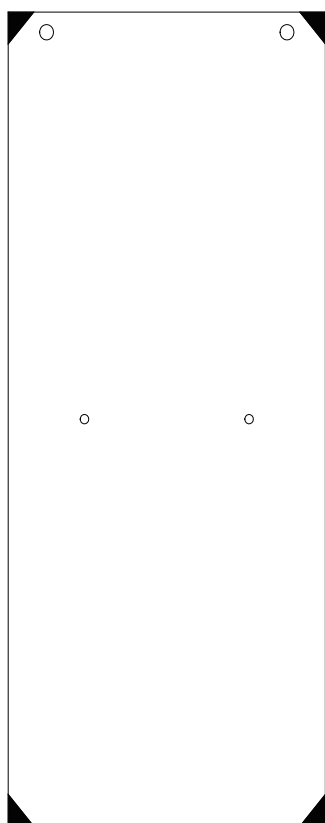

[09]x2

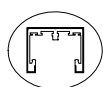

[01]x1



[11]x1

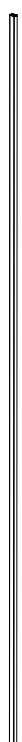

[08]x4



[05]x2



[15]x1

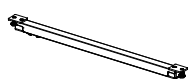

[06]x4



[10]x2

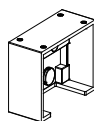

[03]x2

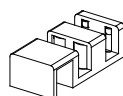

[13]x1



[04]x5



[02]x5

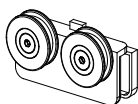

[07]x4



[12]x3



[14]x3



[19]x1



[16]x1



[17]x3



[18]x1



[20]x1



[21]x2



WARNING

To prevent damage to glass and potential injury, carefully follow the instructions on page 4.

ASSEMBLY

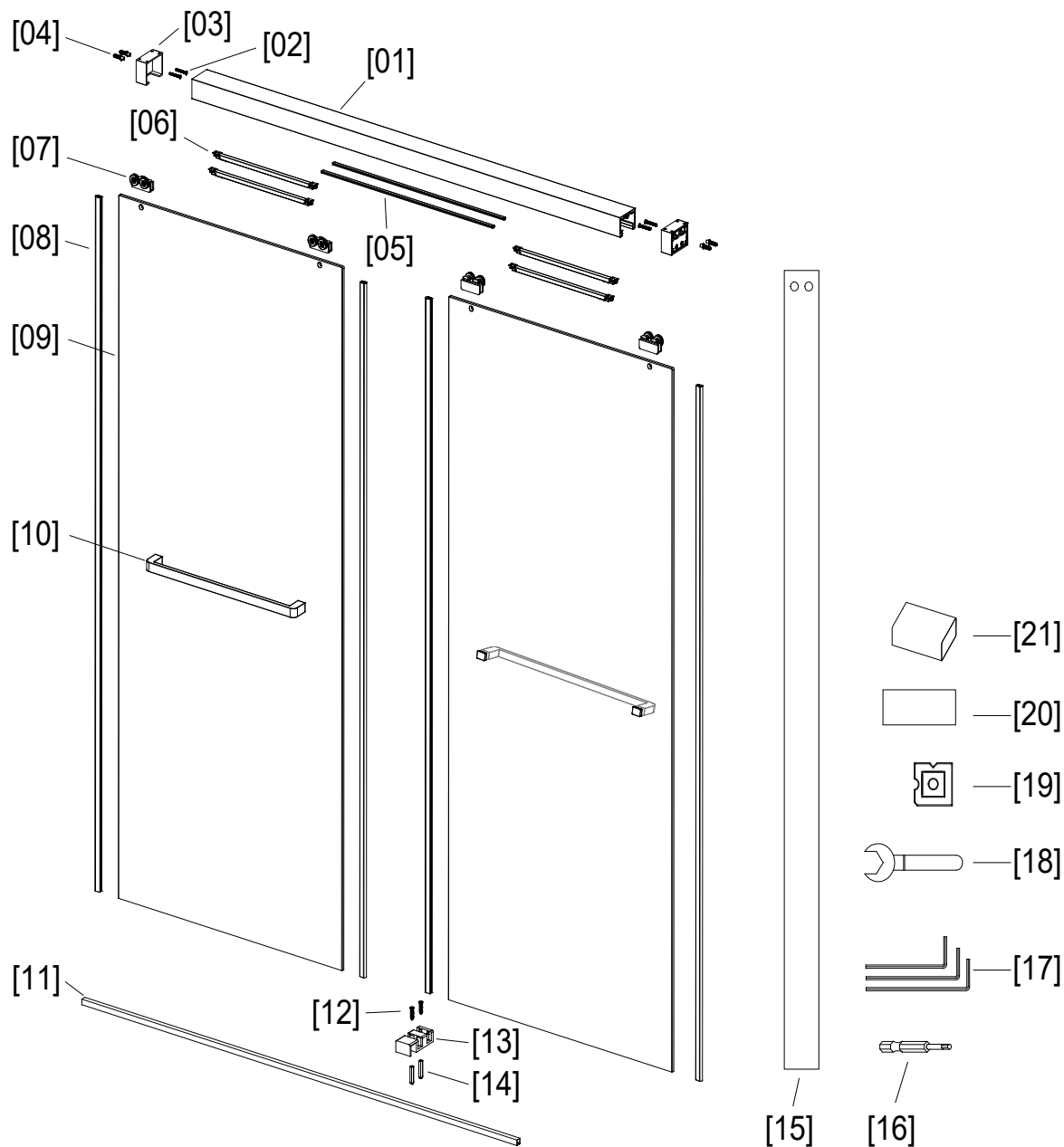

Part	Description	Qty.	Part	Description	Qty.
[01]	Support Bar	1	[12]	Screw #8x0.79" [ST4x20mm]	2
[02]	Screw #10x1.57" [ST 5x40mm]	4	[13]	Guide Block	1
[03]	Wall Bracket	2	[14]	Small Anchor	2
[04]	Anchor	4	[15]	Template	1
[05]	Anti-jump Bar	2	[16]	Screw Driver Bit	1
[06]	Damper	4	[17]	Allen Keys	3
[07]	Roller	4	[18]	Wrench	1
[08]	Side Water Sealing Strip	4	[19]	Cleaner	1
[09]	Door	2	[20]	Gague	1
[10]	Handle Set	2	[21]	Plastic Sleeve	2
[11]	Bottom Rail	1			

SD-AZ21-01**

48"x76"

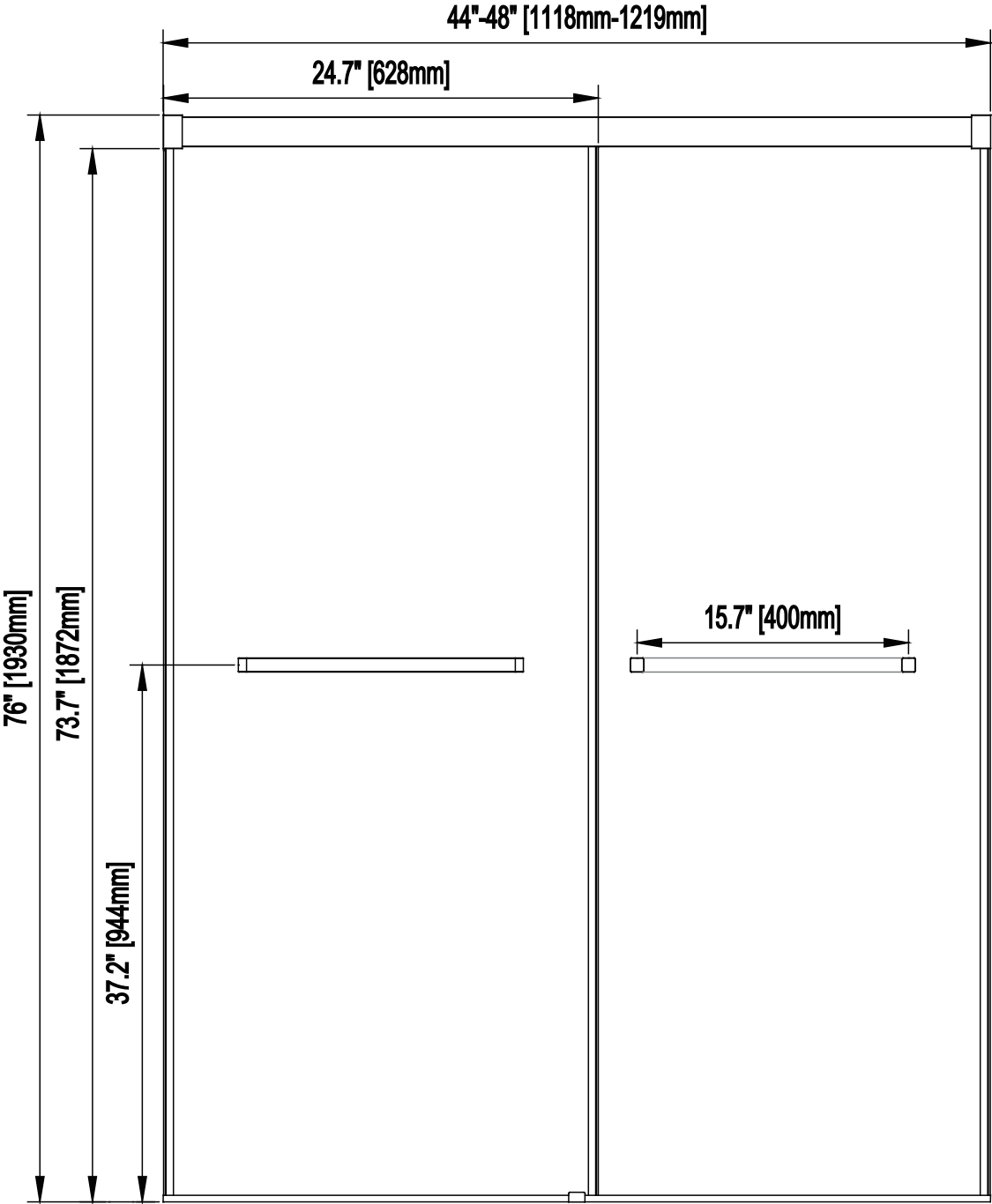

SD-AZ21-02**

60"x76"

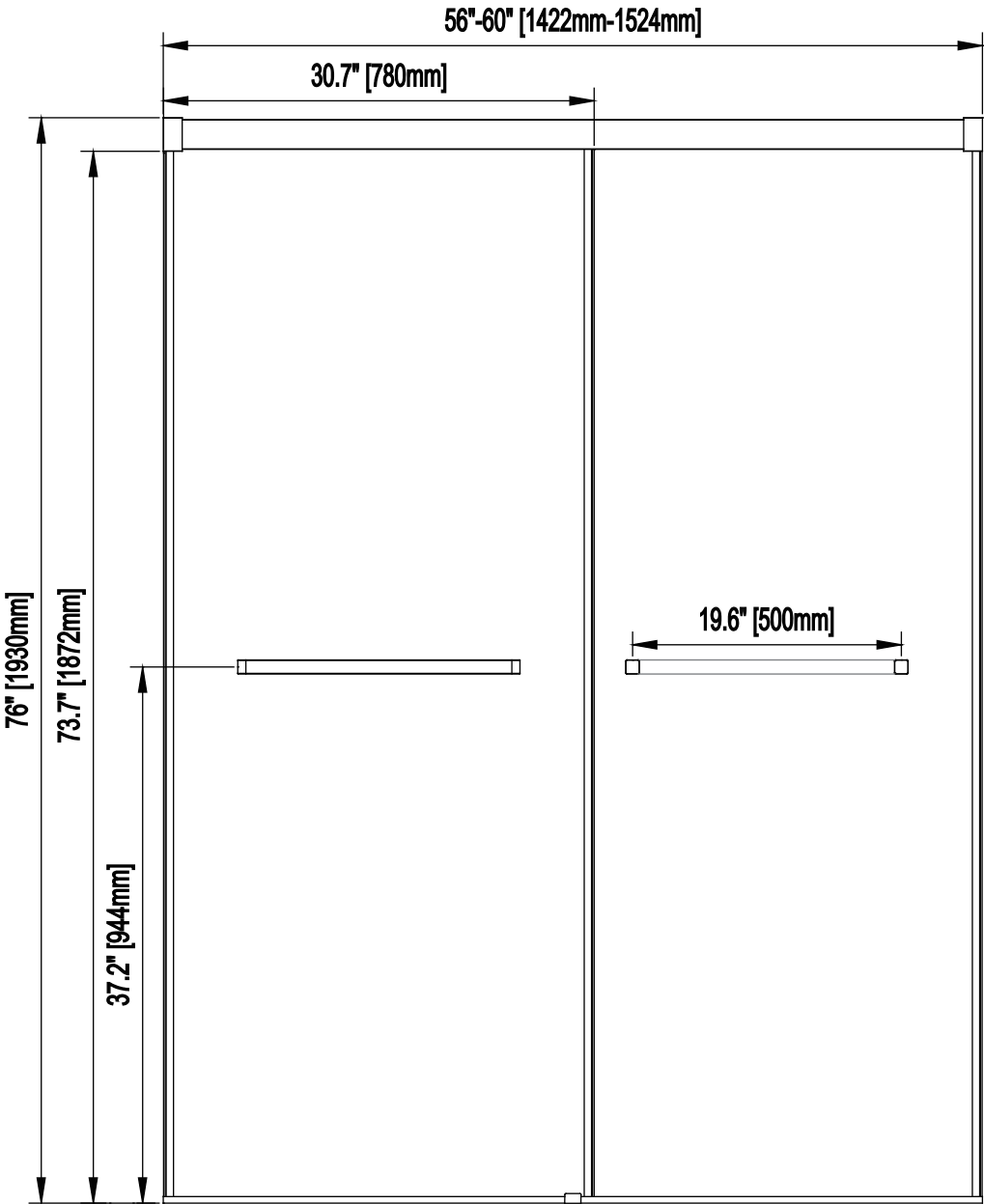



ATTENTION

- To avoid personal injury or property damage, identify components and read all instructions before installing.
- This model requires a minimum 2.7" (68mm) of flat level threshold space for installation. (Dimension "D" of Fig 1.)

INSTALLATION INSTRUCTIONS

Step 1

1. Measure the finished opening width at the bottom surface ("W2") and at the top ("W1").
The height of top: H=76" [1930mm]

IMPORTANT: If the widths of the Support Bar [01] and Bottom Rail [11] align correctly, cutting is unnecessary. If they don't, please see step 2 for cutting instructions.

2. Using a pencil or another marking tool (such as masking tape), mark distance **W1-1" (25mm)** on the **Support Bar [01]** (to leave some space for the Wall Anchor, **W2** on the **Bottom Rail [11]**).

IMPORTANT: Double check the measurements before cutting. Remove the **Anti-jump Bars [05]** from the **Support Bar [01]**. Cut the **Support Bar [01]** and **Bottom Rail [11]** with a fine-toothed hacksaw (32 TPI) for the best results.

If needed, use a metal file to smooth rough edges. Clean up metal shavings.

 Install the **Anti-jump Bars [05]** back to the **Support Bar [01]**.

DO NOT stand on or use a vice to hold the **Support Bar [01]** and **Bottom Rail [11]** while cutting.

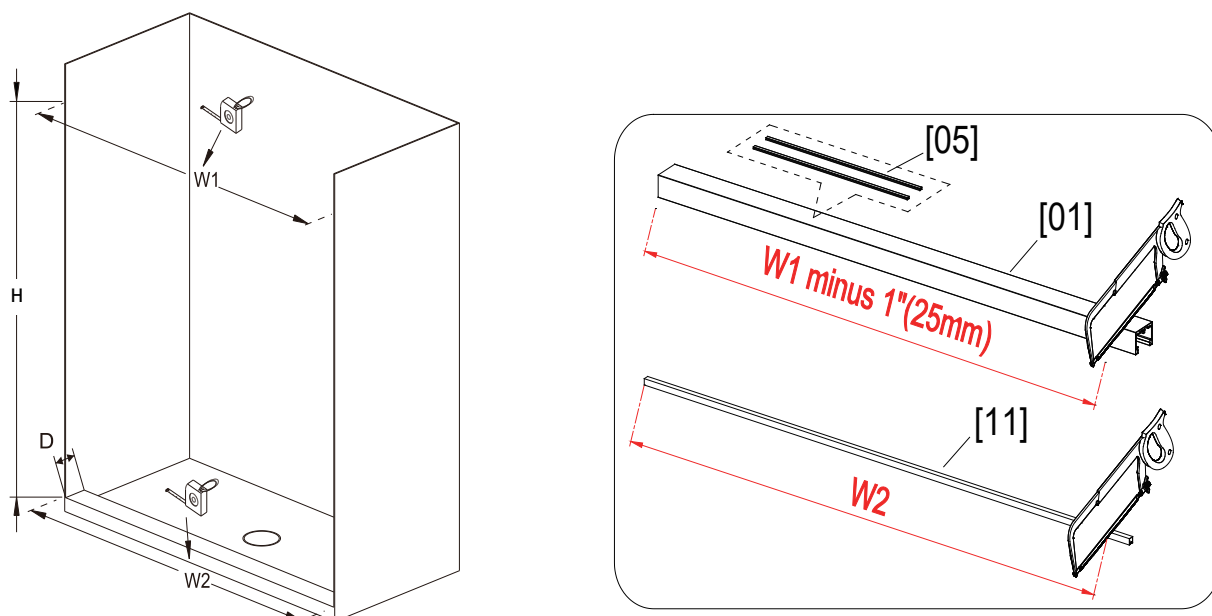

Fig 1

- This shower door must be mounted to a stud. Minimum threshold space is required.
IMPORTANT: Using a stud finder, ensure the wall intended to hold the door has a stud at the installation point. A stud in this location must be identified to support the support bar in order to proceed with the installation. If there is no stud in the shown area, we recommend employing a qualified contractor to install one.

Step 2

1. Position the **Template [15]** to the side wall of shower room with one of its side **A"** behind the outside wall. **A"** is the distance between the side of the **Template [15]** and the outside wall. **A"** should be no less than 0.11"[3mm].
2. Use a pencil to mark the screw holes on the wall through the **Template [15]**.
3. Use a pencil to draw a line on the side wall along the side of **Template [15]** near the threshold.

IMPORTANT:

- a. Make sure there are studs behind the positions of the screw holes.
- b. Ensure the marks on the side walls are equidistant from the outside wall.

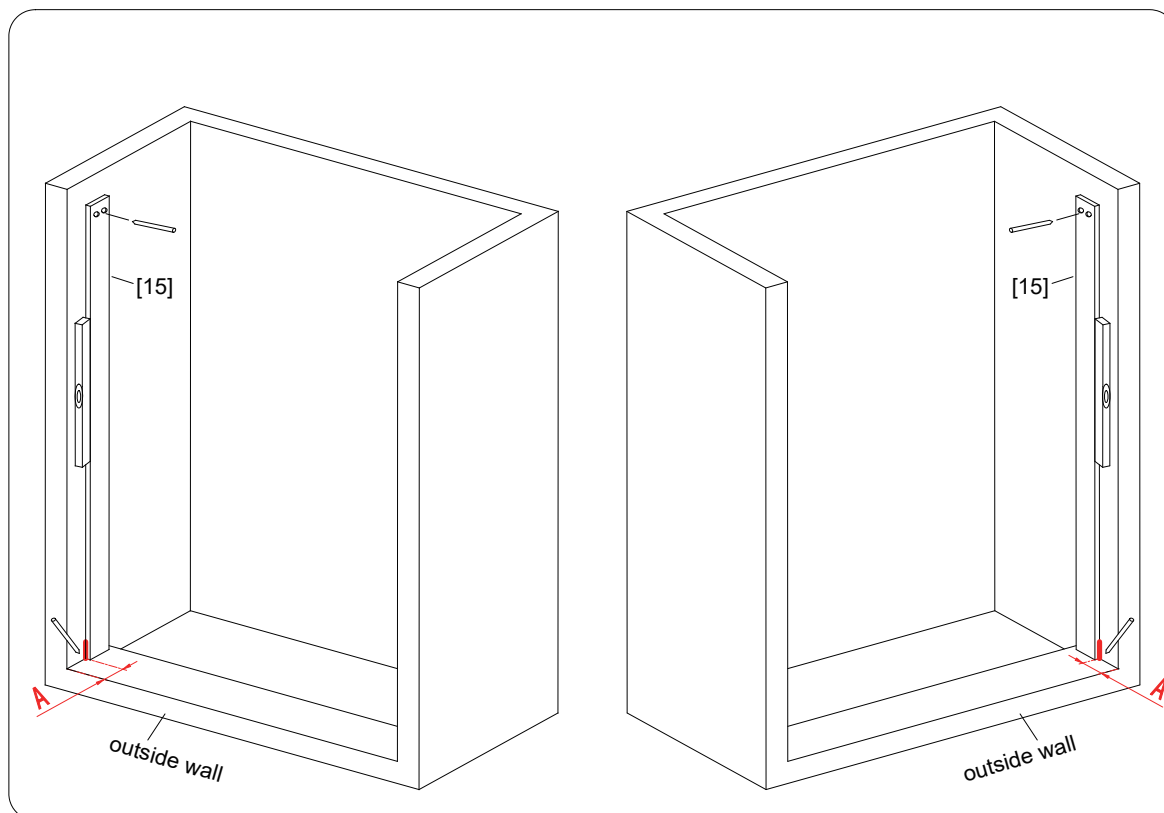

Fig 2

Step 3

1. **Drill 5/16"** holes at the locations marked in Step 2. (Refer to Fig. 3.1)
2. **Insert the Anchors [04]**. (Refer to Fig. 3.2)
3. **Remove the Wall Bracket Anchors** from the **Wall Brackets [03]** by loosening their screws. Then, secure them onto the wall by using **Screws [02]** and a **Screw Driver Bit [16]**. (Refer to Fig. 3.3)
4. **Ensure the Damper [06]** is in the correct position as shown in the diagram. The anchor should be properly aligned with the **Damper [06]**. (Refer to Fig. 3.4)
5. **Slide the anchors of the Dampers [06]** into the slot of the **Support Bar [01]** until the **Dampers [06]** are positioned approximately 2" behind the edge of the **Support Bar [01]**. Lightly tighten the screw at the **stopper** to hold the **Dampers [06]** in place. Ensure the **stopper** side is facing outward. (Refer to Fig. 3.5)

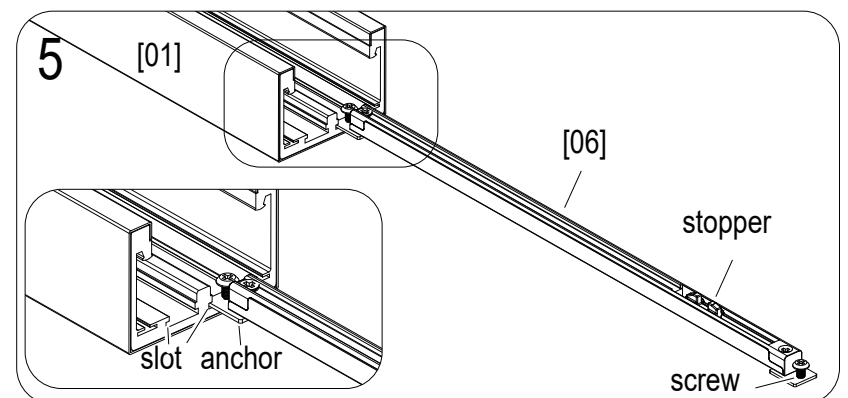
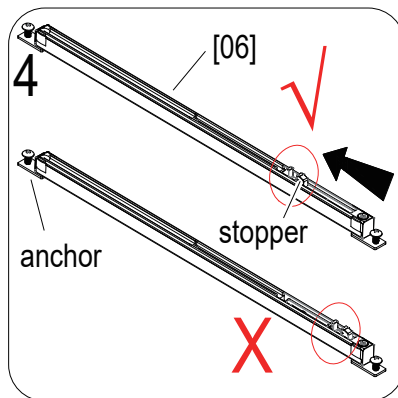
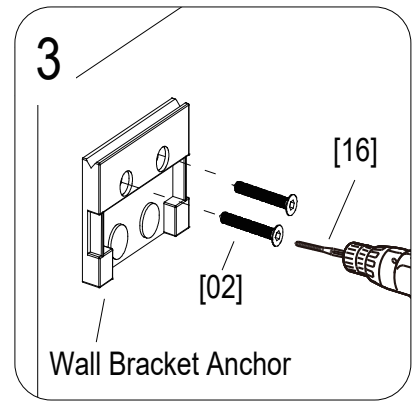
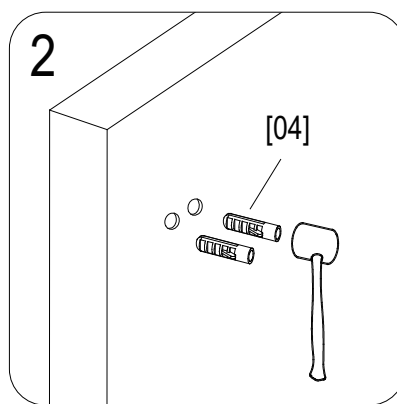
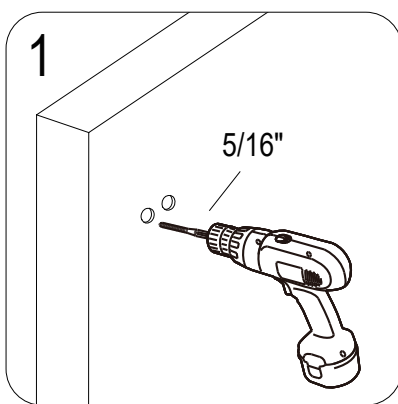

Fig 3

Step 4

To prevent scratches or damage to the Support Bar during installation, please follow these steps to apply the included plastic sleeves before mounting the Wall Brackets.

Step-by-Step Instructions

1. Slide the **Plastic Sleeves [21]** onto both ends of the **Support Bar [01]**. (Refer to Fig. 4.1)
2. Position the sleeves so that they tightly cover the grooved areas on each end of the **Support Bar [01]**. (Refer to Fig. 4.1a)
3. Install the **Wall Brackets [03]** over the **Plastic Sleeves [21]**, as shown in the illustration below. (Refer to Fig. 4.1a)
4. Align the **Support Bar [01]** with the **Wall Bracket Anchor** and slide the **Wall Bracket [03]** into place. Confirm that the **Anti-Jump Bars [05]** are inside the **Support Bar [01]**. (Refer to Fig. 4.2, Fig. 4.3)
5. Once the **Wall Brackets** are fully secured to the **Wall Bracket Anchors**, carefully cut and remove the **Plastic Sleeves [21]**. (Refer to Fig. 4.3)
6. Push the **Wall Bracket [03]** firmly against the wall and tighten all screws to secure it in place. (Refer to Fig. 4.2)

⚠ Do not install the Wall Brackets without the plastic sleeves in place, as this may result in permanent scratches or surface damage to the Support Bar.

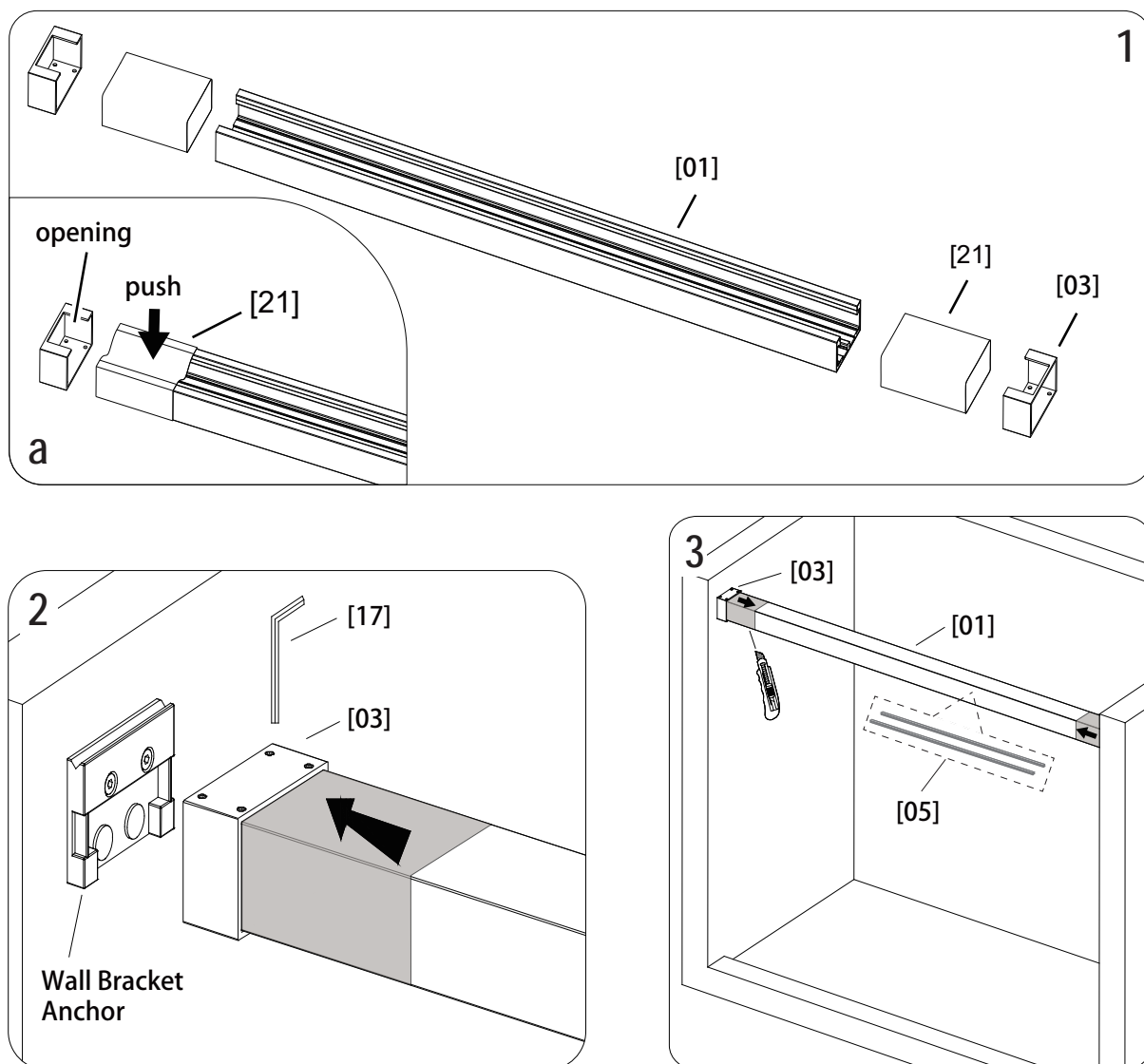

Fig 4

Step 5 – Installing the Guide Block Anchor

Notice:

This step covers the installation of the **guide block anchor** using screws for securing **Guide Block [13]**.

If you are using a **screw-free installation** method for **Guide Block [13]**, skip this step and **do not drill holes or install the guide block anchor**.

1. **Apply high-quality silicone sealant** along the slots of the **Bottom Rail [11]**. Position the Bottom Rail so that its outer side aligns with the marked lines on the side wall.
(Refer to Fig. 5.1 and Fig. 5.2)
2. Lightly position the **guide block anchor** just behind the midpoint of **Bottom Rail [11]**. Using the guide block anchor as a template, **mark the screw hole locations**.
(Refer to Fig. 5.1)
3. Remove the **guide block anchor** and drill pilot holes at the marked locations:
 - **1/8" holes** if drilling into **acrylic or wood**
 - **7/32" holes** if drilling into **tile**. Then, insert the **Small Anchors [14]**.
(Refer to Fig. 5.3 and Fig. 5.4)
4. Reposition and **secure the guide block anchor** using **Screws [12]**. (Refer to Fig. 5.5)

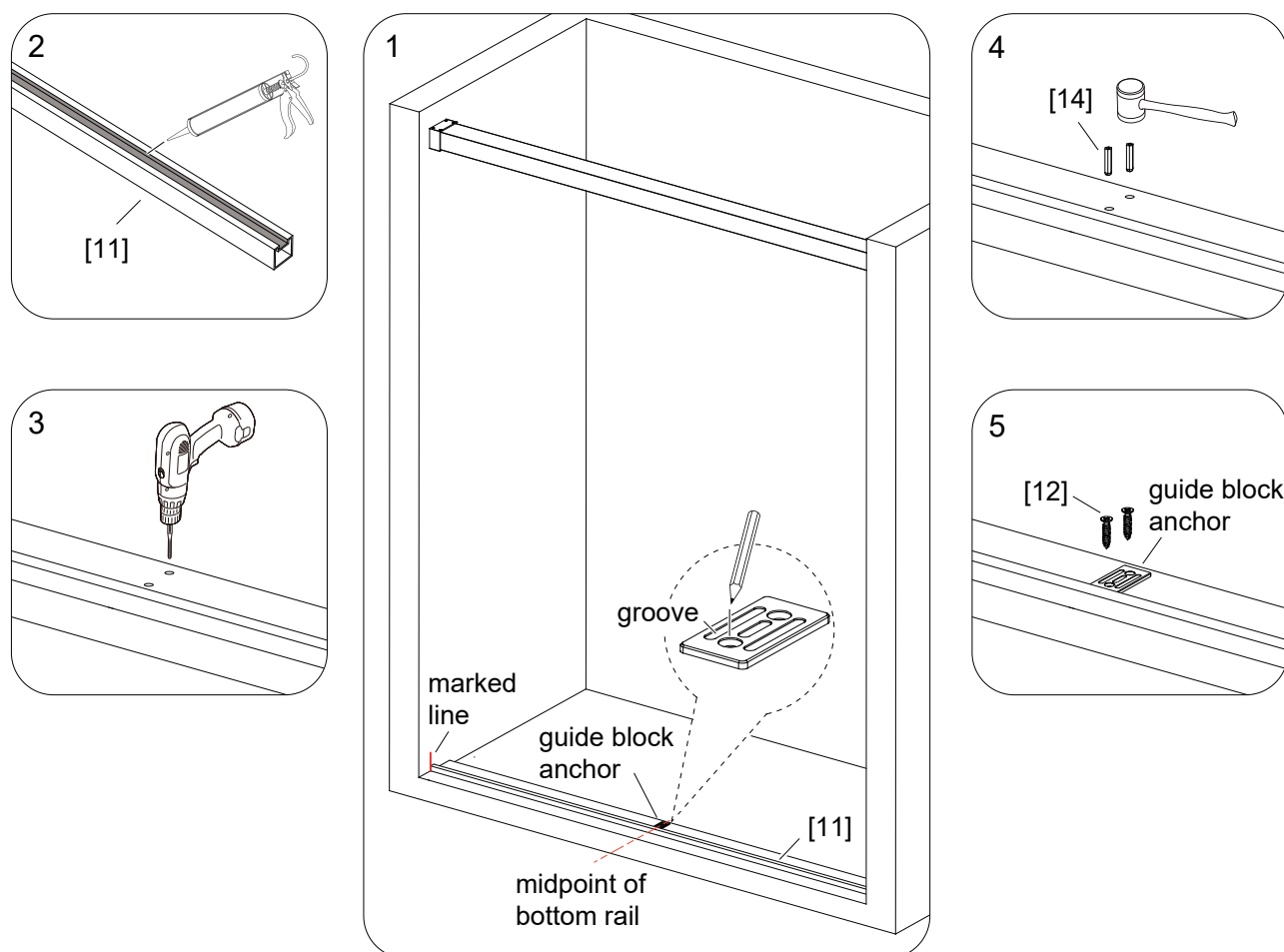

Fig 5



WARNING

To prevent glass damage and potential injury, follow all instructions carefully—especially those on page 4.

Step 6 – Installing the Rollers and Doors

1. Prepare the Door Assembly (Refer to Fig. 6.1)

- Remove **two Corner Protectors** from the top of the **Door [09]**.
- Remove the **Screw** and **Eccentric Block** from the **Roller [07]** and attach the Roller to the Door.
- Make sure both **Rollers [07]** are on the same side of the Door, and the **arrow on the Eccentric Block** is at the lowest position.

2. Adjust the Damper [06] (Refer to Fig. 6.2)

- Loosen the screw on **Damper [06]**.
- Adjust the Damper so the **gap between the Damper and the Wall Anchor** matches the width of the **Gauge [20]**.

3. Secure the Damper (Refer to Fig. 6.2)

- Tighten the screws on both sides of the **Damper [06]** to lock it in place.

4. Hang the Doors [09] (Refer to Fig. 6)

- Slide the **Anti-jump Bars [05]** to one side until they stop.
- Lift and hold the **Door [09]**, then hang the **Rollers [07]** onto the **rails of the Support Bar [01]** from the opposite side.
- First, install the Roller that is positioned near the middle of the Support Bar.
- Then, slide the Door to the opposite side and install the second Roller.

5. Position the Anti-jump Bars

- Slide the **Anti-jump Bars [05]** into the center position of the **Support Bar [01]** to secure the Door.

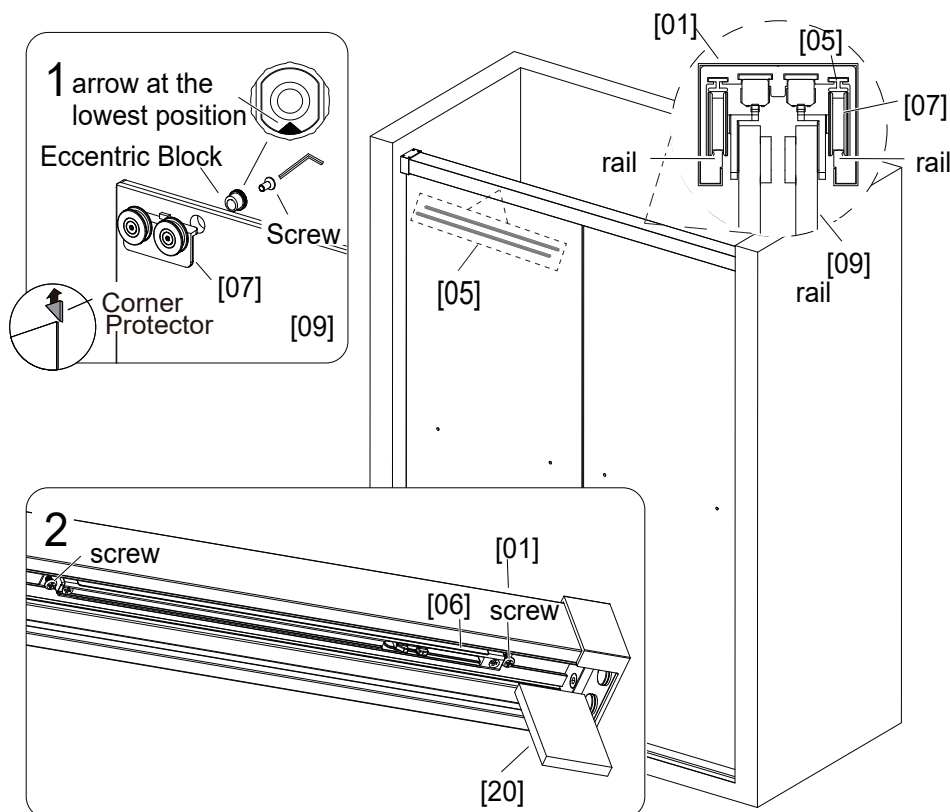

Fig 6



WARNING

To prevent injury or glass damage, follow the instructions on page 4.

Step 7 – Final Door & Seal Block Installation

1. Applying Silicone to the Guide Block (Refer to Fig. 7.1)

- Apply **high-quality silicone sealant** to the **bottom** of the **Guide Block [13]**.

2. Install the Guide Block (Refer to Fig. 7.2, Fig. 7.5)

- Slide the **Doors [09]** to one side to create a working space.
- Position the **Guide Block [13]** behind the **Doors [09]**.
- If using the screw method: place the Guide Block onto the **guide block anchor** and secure it.
- For screw-free installation: place the Guide Block at the center of the **Bottom Rail [11]** to hold it in place with silicone only.

3. Install Side Water Sealing Strips (Refer to Fig. 7.3)

- Remove the **Corner Protectors** from the edges of the **Doors [09]**.
- Attach the **Side Water Sealing Strips [08]** to both door sides, ensuring the strip ends align with the **bottom of the doors**.

4. Check and Adjust Door Alignment (Refer to Fig. 7.4)

- Slightly push the **Doors [09]** to either wall to inspect for gaps between the doors and side walls.
- If misaligned, loosen the **Roller [07] screw**, then use **Wrench [18]** to adjust the **Eccentric Block**.
- After adjustment, retighten the screw and install the **cover** over the Eccentric Block.

IMPORTANT:

Keep the **Doors [09]** in a **vertically closed position for 24 hours** to allow the **Guide Block [13]** to fully bond with the silicone sealant.

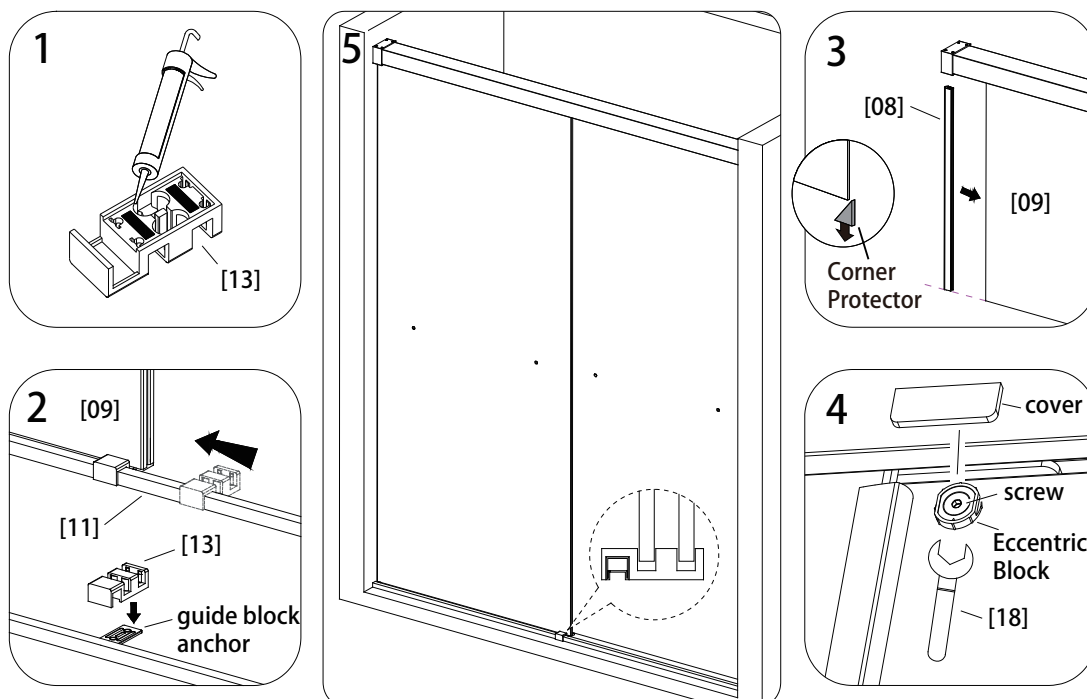

Fig 7



WARNING

To prevent glass damage or injury, be sure to follow all instructions on page 4 before proceeding.

Step 8 – Handle Installation

1. Install the Handle Set [10]

- Disassemble the **Handle Set [10]**.
- From the front of **Door [09]**, insert the **Handle** and two **Gaskets**.
- From the rear side of the door, attach two more **Gaskets** and **Clips**.
- Secure the handle in place by tightening the **Screws**.
- *Tip:* Ensure the **Gasket** protrusions face inward toward the **Door [09]**.

2. Install the Covers

- Fit the **Covers** over the **Clips**.
- Align the **Covers** properly with the **Handle**, then gently press the **Covers** into place.
- Tighten the **Hex Screws** to fully secure the assembly.

Note:

- The **Handle** on the outer glass panel should face outward.
- The **Handle** on the inner glass panel should face inward.

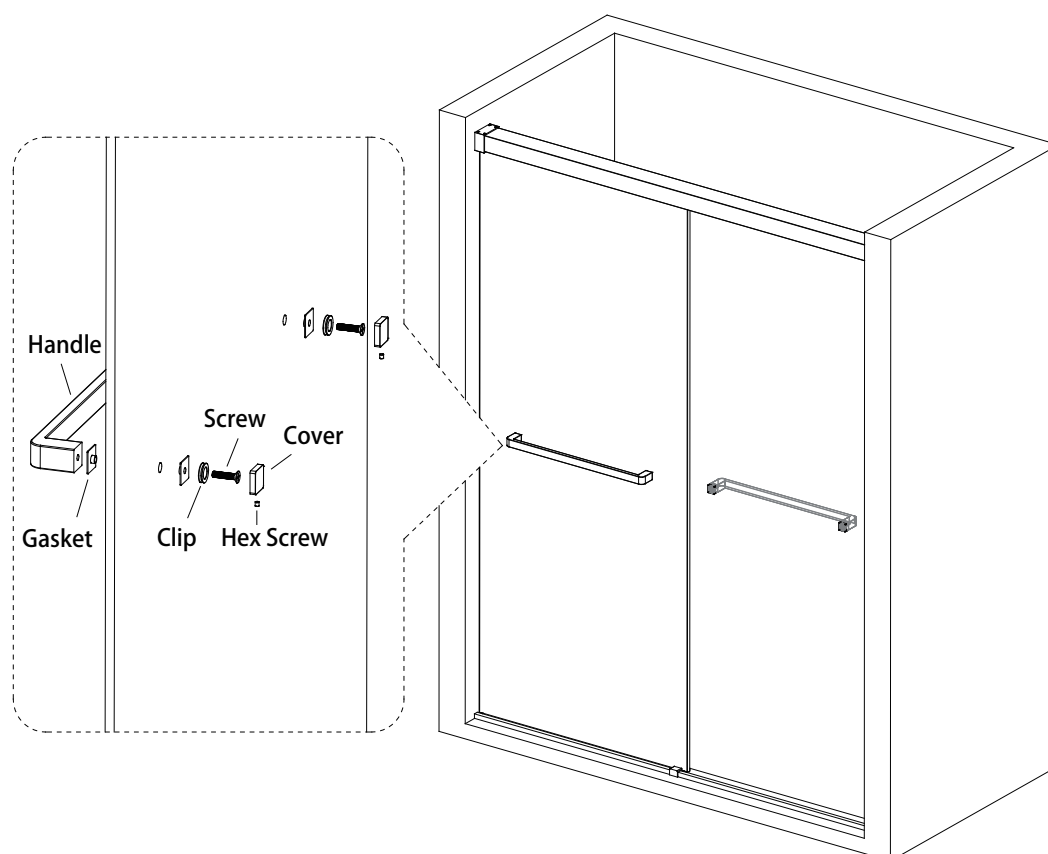

Fig 8

Step 9

1. Apply a **high-quality silicone sealant** at the corners form by the **Bottom Rail [11]**, **Guide Block [13]** and threshold.



Allow 24 hours for the silicone to fully cure before using the shower.



Use **Cleaner [19]** to smooth and clean up the silicone.

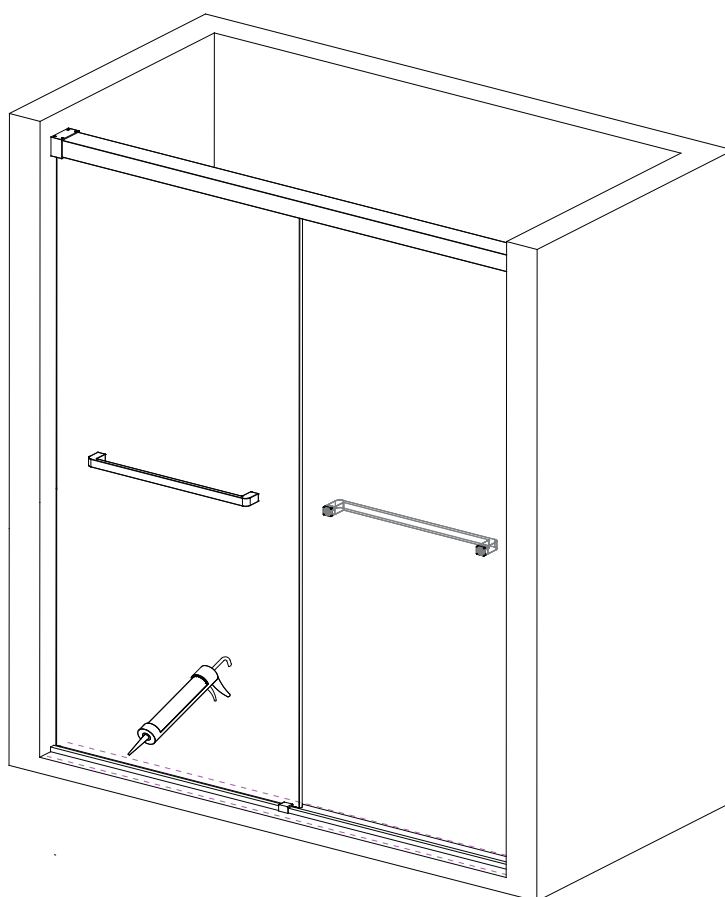

Fig 9

Care & Maintenance

BASES/TUBS and BACK WALLS: Wipe them off after each use with a soft cloth. To clean the acrylic surface, use non-abrasive sprays or cream based cleaners. Avoid the use of aerosol spray cleaners. Never use abrasive cleansers, metal brushes, or scrapers, as they can scratch or dull the surface.

GLASS: Wipe off the glass after each use with either a soft cloth or a squeegee to prevent soap buildup and water spots (hard water can etch the surface of the glass over time if left to dry). To avoid damaging the surface, never use abrasive cleaners or cleaning products that contain scouring agents. Likewise, never use bristle brushes or abrasive sponges that can scratch the surface.

HARDWARE: To ensure a long-lasting finish, wipe off the metal parts after using with a soft cloth. Do not use abrasive cleaners or cleaning products containing ammonia, bleach, or acid. If accidentally used, rinse the surface as soon as possible to prevent damage to the finish (peeling or corrosion). After cleaning the polished finishes, rinse thoroughly and wipe dry with a soft cloth. Clean stainless steel surfaces at least once a week. When applying stainless steel cleaner or polish to stainless steel hardware, work with (not across) the grain. Never use an abrasive sponge or cloth, steel wool, or wire brush, which may permanently scratch the surfaces.

NOTE: Regularly inspect the glass and all hardware for misalignment, proper attachment, and damage. Contact ANZZI with any questions or concerns.

