

SHIMANO

ANTARES

ANT-R

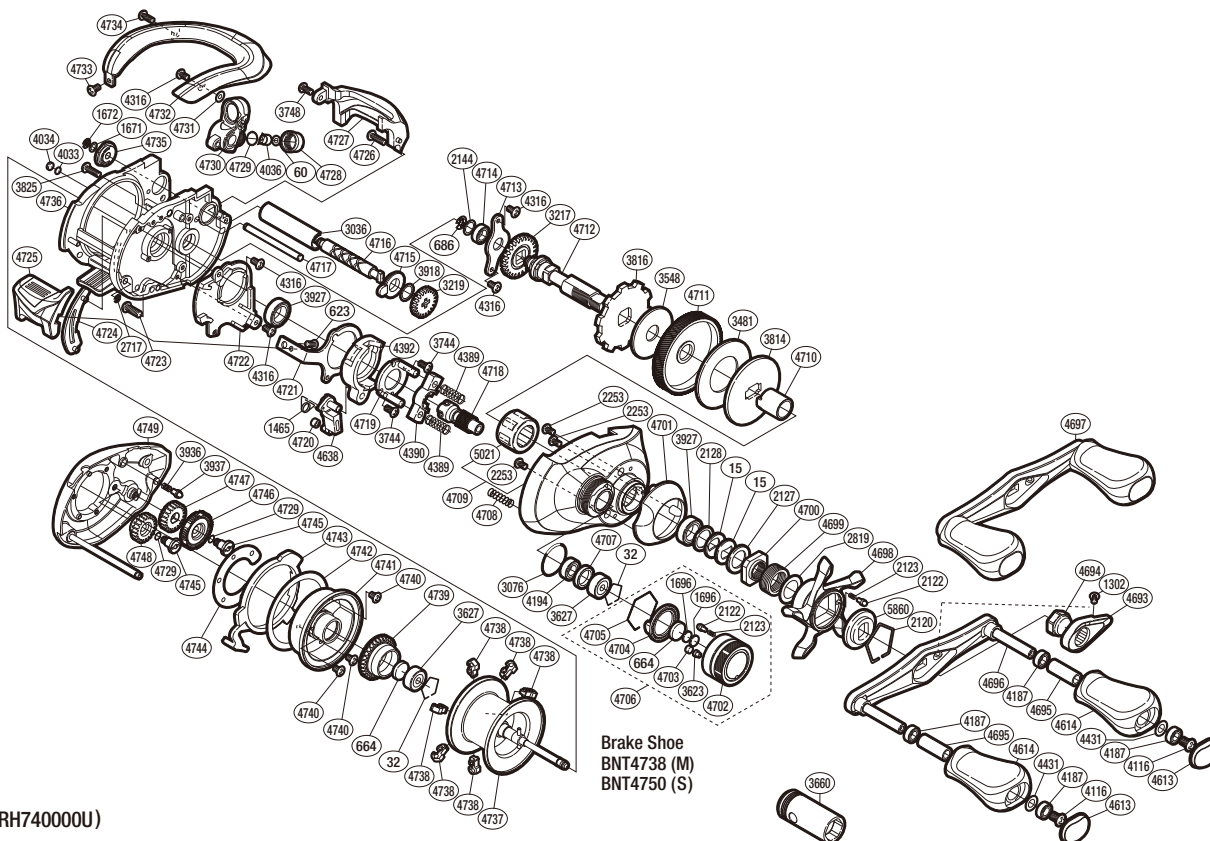

(51RH740000U)

#	Part No.	Description	#	Part No.	Description	#	Part No.	Description
15	10D60	Drag Spring Washer	4034	108Q2	Anti-Thrust Washer	4718	10CU5	Pinion Gear
32	10GEW	Bearing Retainer	4036	10FFW	Line Guide Pawl	4719	10F43	Clutch Cam Retainer
60	10CFW	Spacer	4116	103E9	Screw	4720	1048C	Clutch Pawl Bushing
623	103C0	Screw	4187	104VX	Ball Bearing	4721	10QLP	Clutch Plate
664	1057S	Spacer B	4194	105BP	Ball Bearing	4722	10BVX	Clutch Guard
686	105NK	E Lock	4316	10MT2	Screw	4723	103CG	Screw
1302	103N8	Screw	4389	104BU	Yoke Spring	4724	1099B	Clutch Bar Guide B
1465	10N1Z	Clutch Pawl Spring	4390	1046S	Yoke	4725	10MXW	Quick-Fire II Clutch Bar
1671	10BHX	Washer	4392	10KSB	Clutch Cam	4726	10MT8	Screw
1672	105NC	E Lock	4431	10G8G	Washer	4727	10QH1	Level Wind Protector
1696	10896	Cast Control Spacer	4613	10AVV	Handle Knob Seal	4728	10FJD	Pawl Cap
2120	10KXV	Click Plate Retainer	4614	10329	Handle Knob	4729	108WQ	O Ring
2122	10BT0	Click Pin	4638	105ZU	Clutch Pawl	4730	10NYQ	Line Guide
2123	10BT2	Click Spring	4693	10Q5W	Handle Nut Plate	4731	10CFV	Spacer
2127	10J1N	Star Drag Spacer	4694	10FFH	Handle Nut	4732	104N7	Thumb Rest
2128	105PW	Bearing Washer	4695	109VL	Handle Knob Pipe	4733	10LVD	Screw
2144	10C47	Washer	4696	109VE	Handle Shank Assembly	4734	10LVL	Screw
2253	103N4	Screw	4697	10CFE	Handle Assembly	4735	104SR	Worm Bushing B
2717	105NB	E Lock	4698	10AX8	Star Drag	4736	10JNQ	One-Piece Frame
2819	10HHN	Washer	4699	10A71	Star Drag Spring	4737	10L7Q	Spool Assembly
3036	10N1H	Level Wind Guard	4700	10A0B	Star Drag Nut	4738	1046M	Brake Shoe M
3076	108W8	O Ring	4701	10K0A	Clutch Button Attachment	4739	10EXU	Brake Ring Gear
3217	10J77	Idle Gear	4702	10KFU	Cast Control Cap	4740	10LVA	Screw
3219	10FP4	Idle Gear	4703	10C5Z	Retainer Sheet	4741	10FXH	Brake Case
3481	10LN7	Drag Washer	4704	10L2F	Cast Control Click Plate	4742	104N6	Washer
3548	10CHZ	Drag Washer	4705	10L6Y	Cast Control Click Holder	4743	10BBW	Side Plate Cam Lever
3623	10CCX	Cast Control Cap Retainer	4706	10HWE	Cast Control Cap Assembly	4744	108F1	Brake Case Washer
3627	105C0	Ball Bearing	4707	10EYU	Bearing Spacer	4745	10A6M	Screw
3744	10LVH	Screw	4708	10KNE	Damper Spring	4746	10B21	Br Dial
3748	10MPR	Screw	4709	10J36	Right Side Plate	4747	10BGN	Br Dial Gear
3814	10D3M	Key Washer	4710	10BN1	Roller Clutch Inner Tube	4748	10CLG	Idle Gear
3816	10D77	Anti-Reverse Ratchet	4711	10CR8	Drive Gear	4749	10HU4	Left Side Plate
3825	10LUY	Screw	4712	105CX	Drive Shaft	5021	10F33	Roller Clutch Bearing
3918	10G84	Washer	4713	109T5	Drive Shaft Retainer	5860	10J26	Star Drag Click
3927	10EX8	Ball Bearing	4714	104JZ	Ball Bearing			
3936	10B51	Click Spring	4715	10NCZ	Worm Bushing A	3660	10MDK	Reel Wrench (Accessory)
3937	10B4Z	Click Pin	4716	104ZN	Worm Shaft	4692	10LQ0	B-100 Oil (Accessory)
4033	108SK	Washer	4717	10QSL	Stabilizer Bar	4750	1046N	Brake Shoe S (Accessory)

Please note that the number of adjusting washers may not be the same as shown in the exploded views.
(Adjustment will vary with each individual product.)

(241120)_004