

IPS Tankless Water Heater Valve Service Kits

Specifications

- IPS end connection
- Constructed of forged brass
- Color-coded hot and cold valves
- 1 year limited warranty
- Can handle up to 600 psi of water pressure
- 32°F - 180°F temperature range

May include:

- lead free pressure relief valve
- lead free sweat adapter
- lead free recirculation valve
- gas sediment trap
- 1" OD (3/4" ID) X 24" long, 3/4" male pipe thread X 3/4" female pipe thread yellow coated corrugated stainless steel gas connector
- lead free gas ball valve

Applications

- Potable water

Materials

- Brass

Product Offering (Dimensions on following page)

Part Code	Size	Pressure Relief Valve	Sweat Adapter	Recirculation Valve	Gas Connector	Gas Ball Valve	Gas Sediment Trap
D05002	3/4"	--	--	--	--	--	--
D05011	1"	--	--	--	--	--	--
D05013	1"	Yes	--	--	--	--	--
D05014	1"	Yes	Yes	--	--	--	--
D05102	3/4"	Yes	--	--	--	--	--
D05105	3/4"	Yes	--	Yes	--	--	--
D05112	3/4"	Yes	--	--	Yes	Yes	Yes

Certifications/Listings/Approvals

- NSF/ANSI/CAN 372 and 61
- NSF/ANSI 14
- IAPMO/ANSI Z1157
- IAPMO approved for cUPC usage (components individually certified)
- Lead law compliant



Job Name _____
 Location _____
 Engineer _____
 Contractor _____
 Tag _____ PO# _____

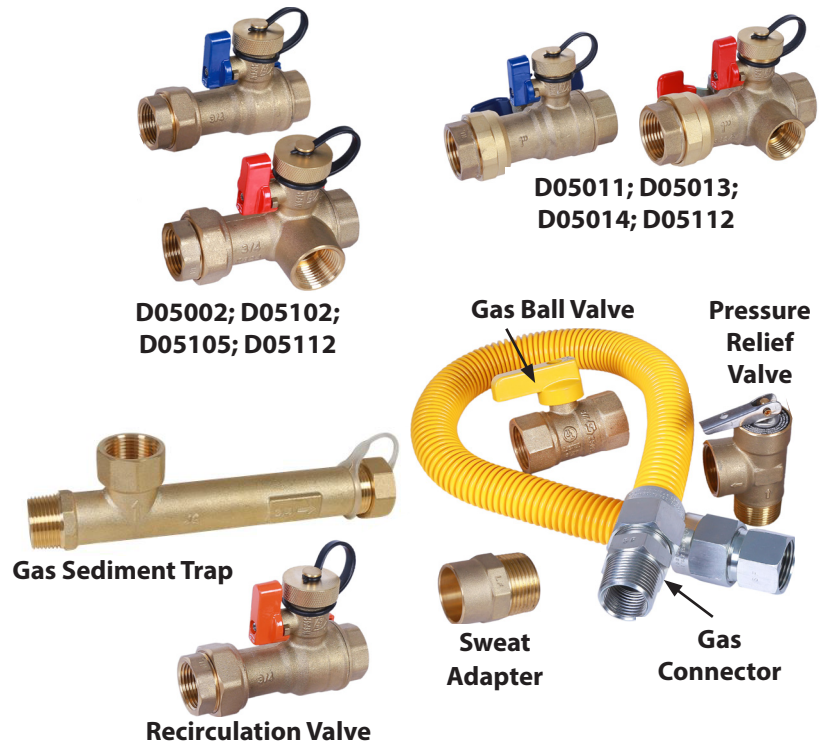

Dimensions

Part Code	Size	A	B	C	D	E	F
D05002	3/4"	1.77"	3/4 - 14 NPT	3.96"	.63"	3/4 - 14 NPT	3.09"
D05011	1"	2.22"	1 - 11.5 NPT	4.53"	.63"	1 - 11.5 NPT	3.75"
D05013	1"	2.22"	1 - 11.5 NPT	4.53"	.63"	1 - 11.5 NPT	3.75"
D05014	1"	2.22"	1 - 11.5 NPT	4.53"	.63"	1 - 11.5 NPT	3.75"
D05102	3/4"	1.77"	3/4 - 14 NPT	3.96"	.63"	3/4 - 14 NPT	3.09"
D05105	3/4"	1.77"	3/4 - 14 NPT	3.96"	.63"	3/4 - 14 NPT	3.09"
D05112	3/4"	1.77"	3/4 - 14 NPT	3.96"	.63"	3/4 - 14 NPT	3.09"

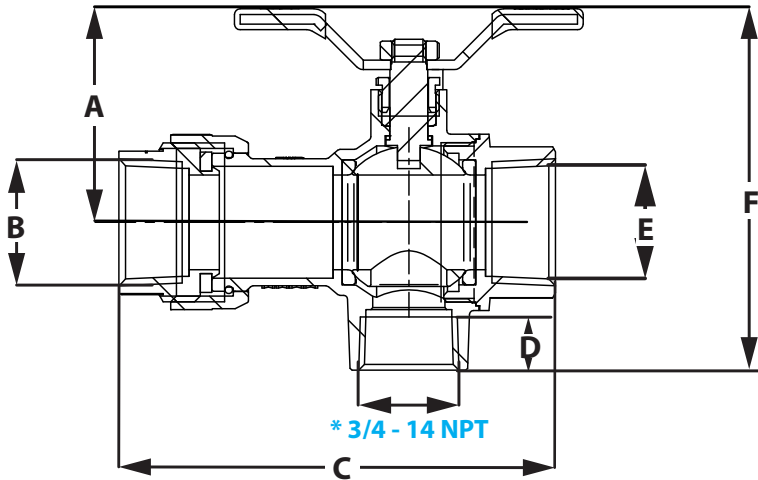

Hot/Cold/Recirculation Valve

NOTE: The recirculation valve is the same valve as the cold water valve, but with an orange handle.

*** Cold Valve and Recirculation Valve do not have this port**

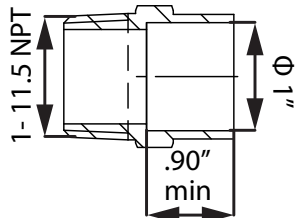

Sweat Adapter

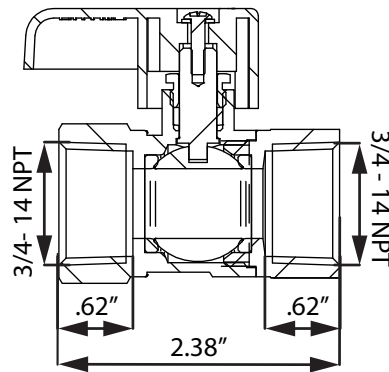

Gas Ball Valve

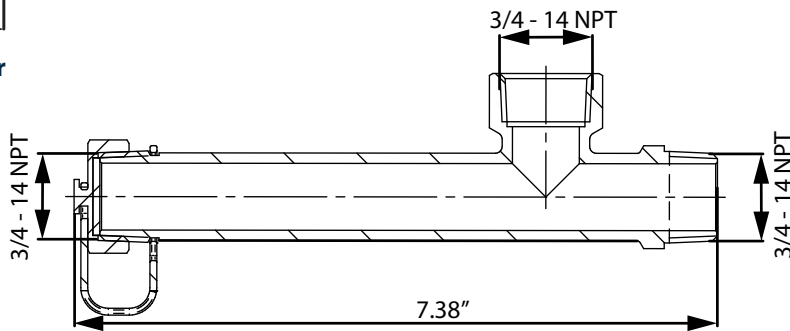

Gas Sediment Trap

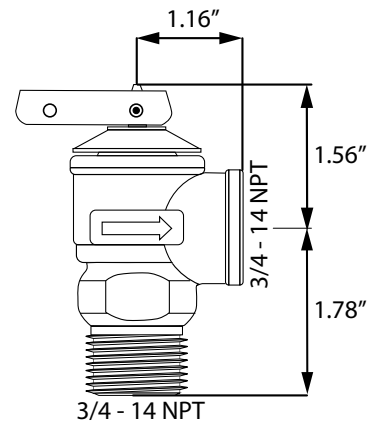

Pressure Relief Valve

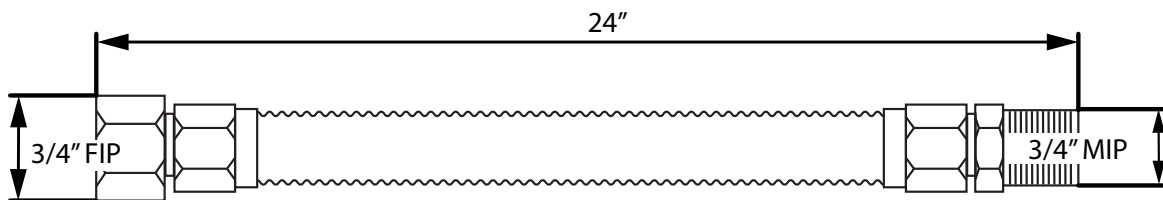

Gas Connector