

INSTALLATION INSTRUCTIONS

Soap Dispenser

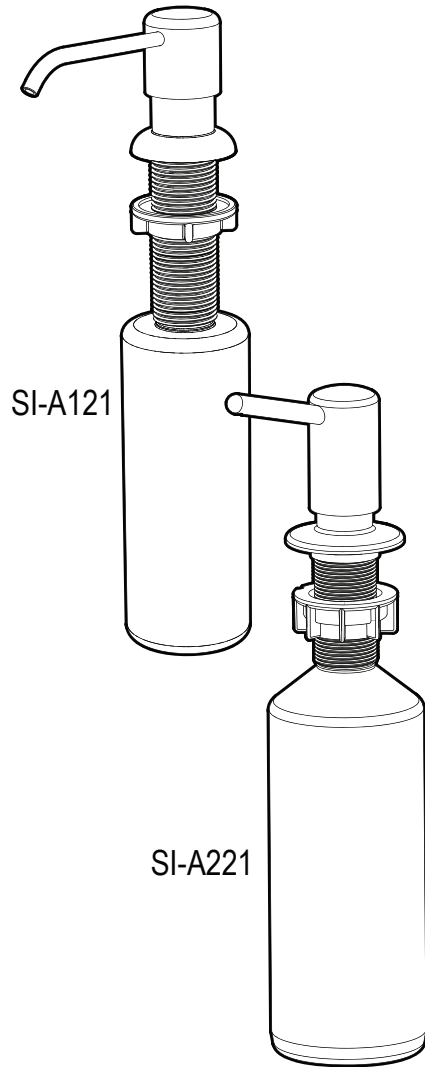

PREPARE FOR MOUNTING

- 1 Unthread and remove Soap Bottle and Mounting Nut.

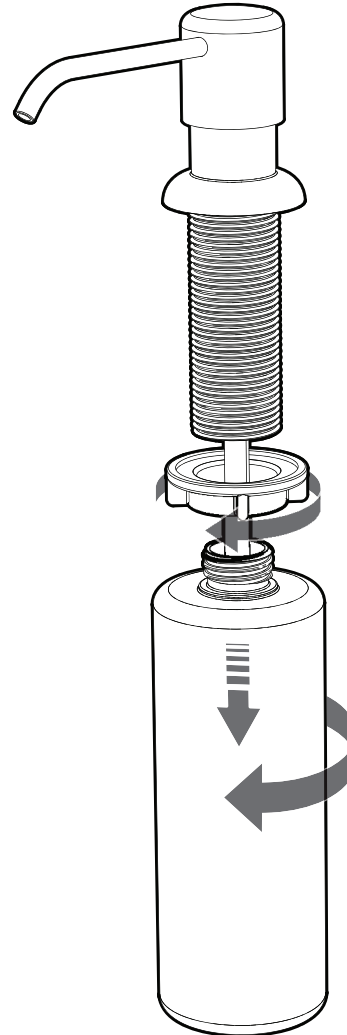

MOUNT SOAP DISPENSER

- 2 Lower Soap Dispenser assembly through hole in mounting surface. Secure from below with the Mounting Nut. Hand Tighten into final position. Thread Soap Bottle on to Soap Dispenser. Hand Tighten only.

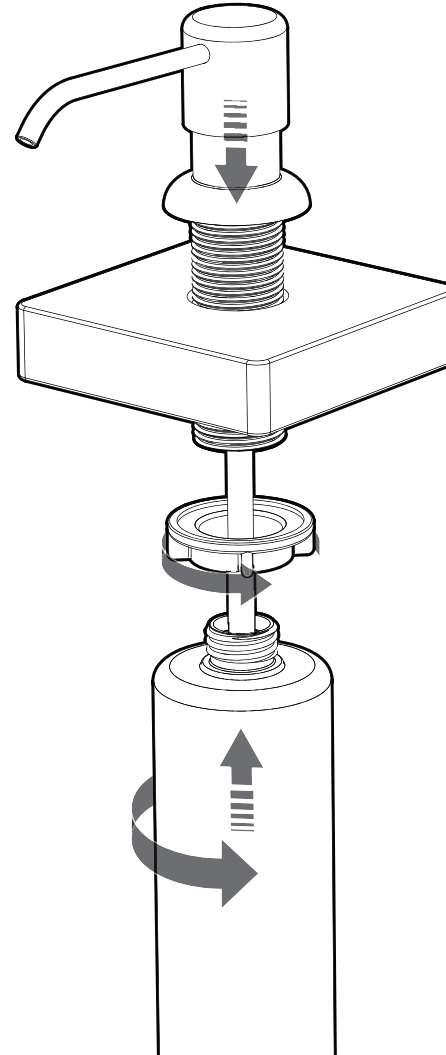

FILL SOAP BOTTLE

- 3 If your Soap Pump came preinstalled, Pull UP on the upper Collar of the Soap Dispenser to remove Soap Pump. From above, fill Soap Bottle with Liquid Soap. Reinstall Soap Dispenser Pump.

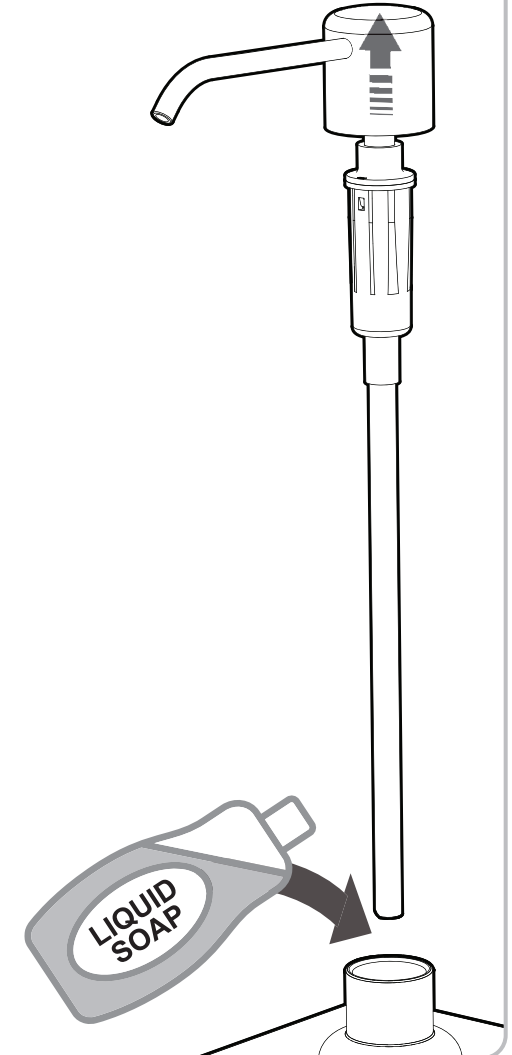

SI-A121 ROUGH IN DIAGRAM

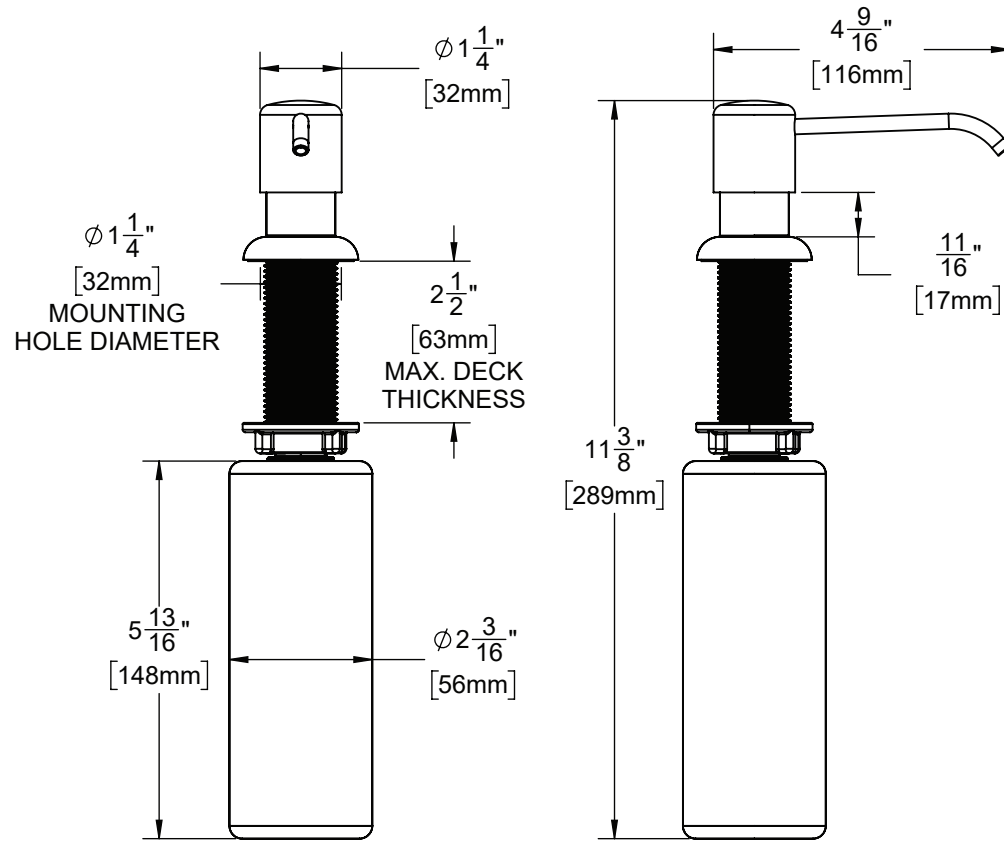

SI-A221 ROUGH IN DIAGRAM

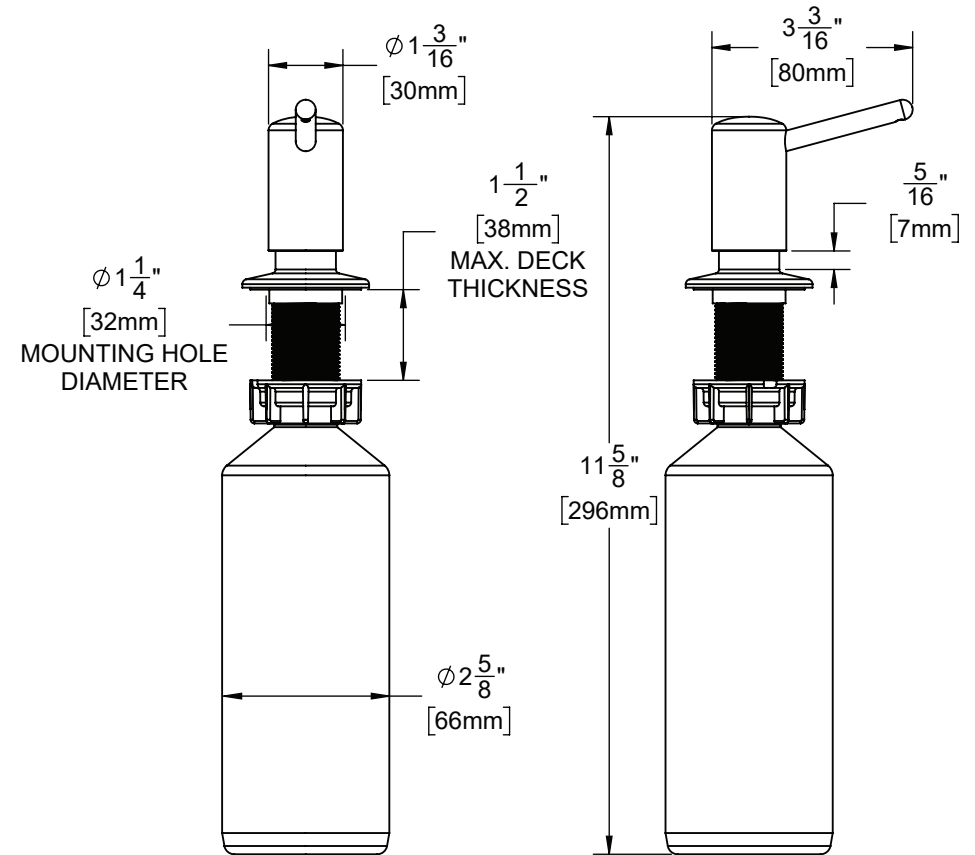

IMPORTANT

Be sure to read and understand all instructions before beginning installation.

Cover the drain to avoid loss of parts.

Be sure to wear proper eye protection.

Do NOT over tighten any connections or damage may occur.

Your new Speakman Product is designed for years of trouble-free performance. Keep it looking new by cleaning it periodically with a soft cloth. The use of harsh chemicals and abrasives on any of the Speakman custom finish products may damage the finish and void the product warranty. Please be sure to only use approved cleaners. Please contact Speakman for any clarification of acceptable cleaners.

Visit www.speakman.com for warranty information.