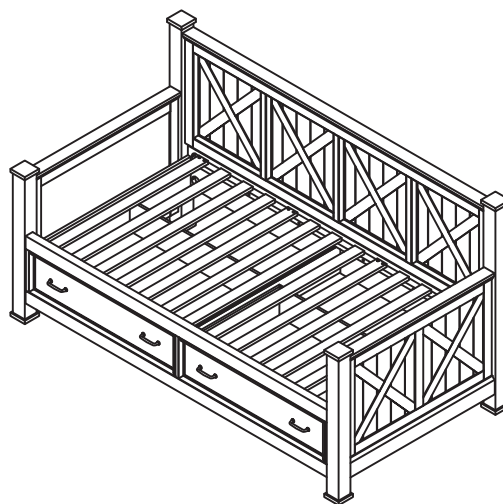
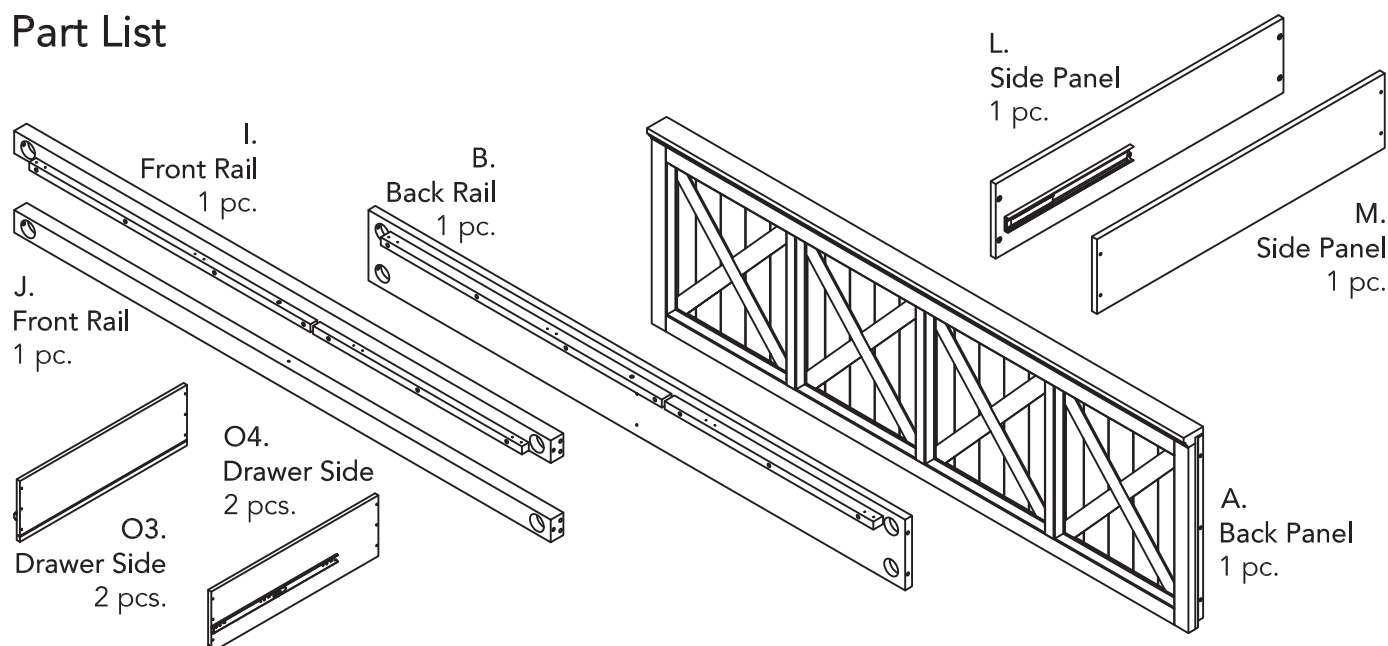
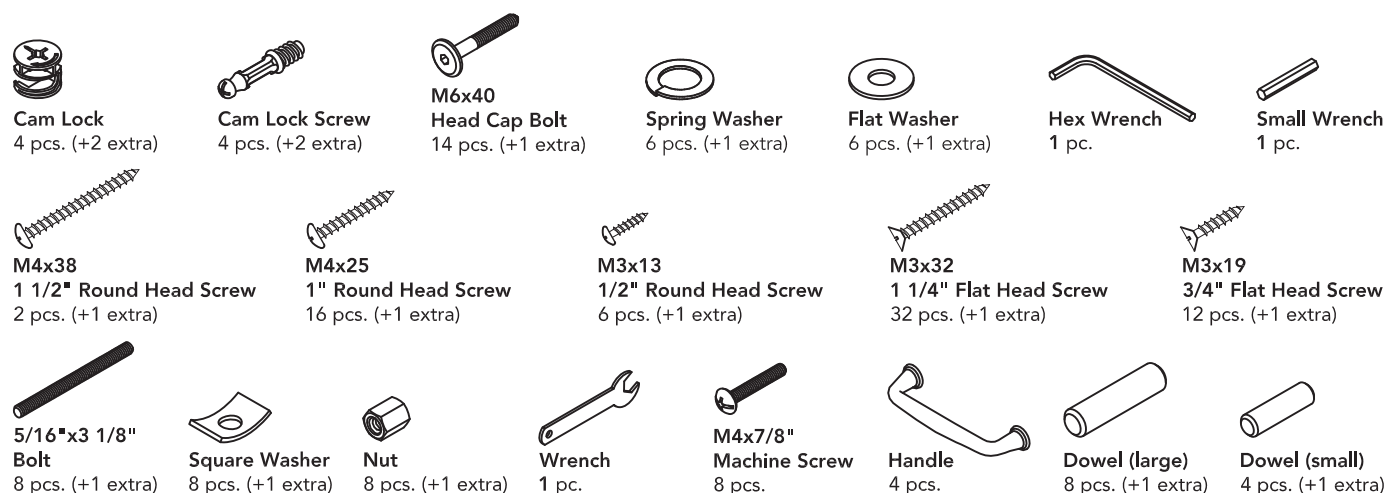

**IMPORTANT**

Carefully remove all the parts from the carton and place them individually on a soft cloth to prevent scratches or other damage.

Carefully and strictly follow these assembly instructions to ensure a completed product as designed.

Do not use power tools above 8 volts to assemble.

**Part List****Hardware List**

**Cartons 5523-852 and 853 are also needed for assembly.**

Tool(s) required for assembly: Phillips screwdriver, Level

Home Styles Customer Service: [www.homestyles-furniture.com](http://www.homestyles-furniture.com),  
[servicedesk@homestyles-furniture.com](mailto:servicedesk@homestyles-furniture.com), 888-680-7460, 877-831-0319

## Assembly Instructions 2/10

### IMPORTANT

- Use a soft cloth between these parts and the floor.
- Do not use power tools above 8 volts to assemble.
- Do not tighten all the bolts until each part is properly assembled.
- The unit must be level to work properly. Use the included adjustable levelers to level.
- Keep Hex Wrench and Wrench as the bolts and nuts may need to be tightened in the future.

### STEP 1

Insert Bolts into pre-drilled holes in Back Posts (C), (D) and Front Posts (F), (G), then tighten.

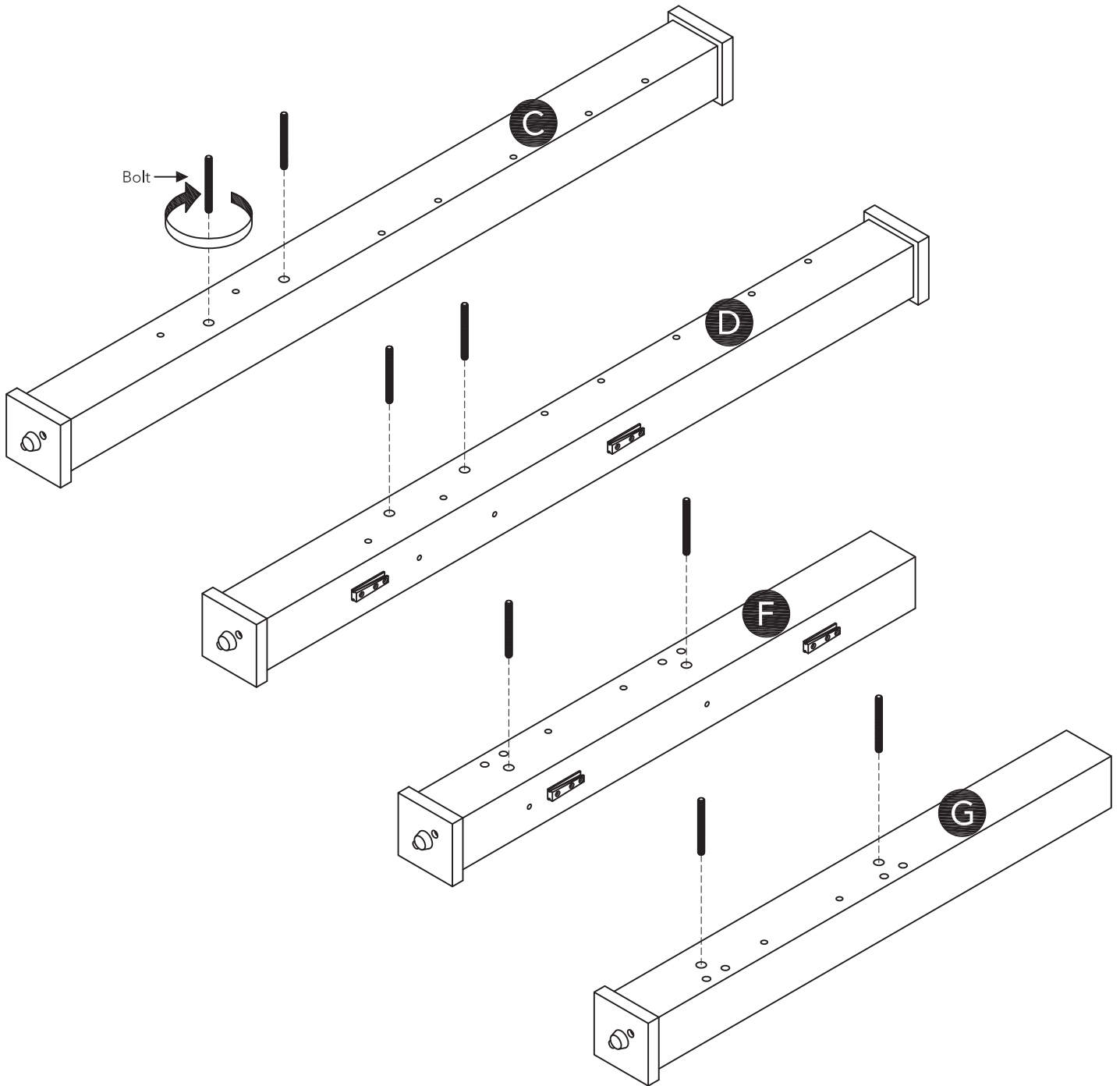

# Assembly Instructions 3/10

## STEP 2

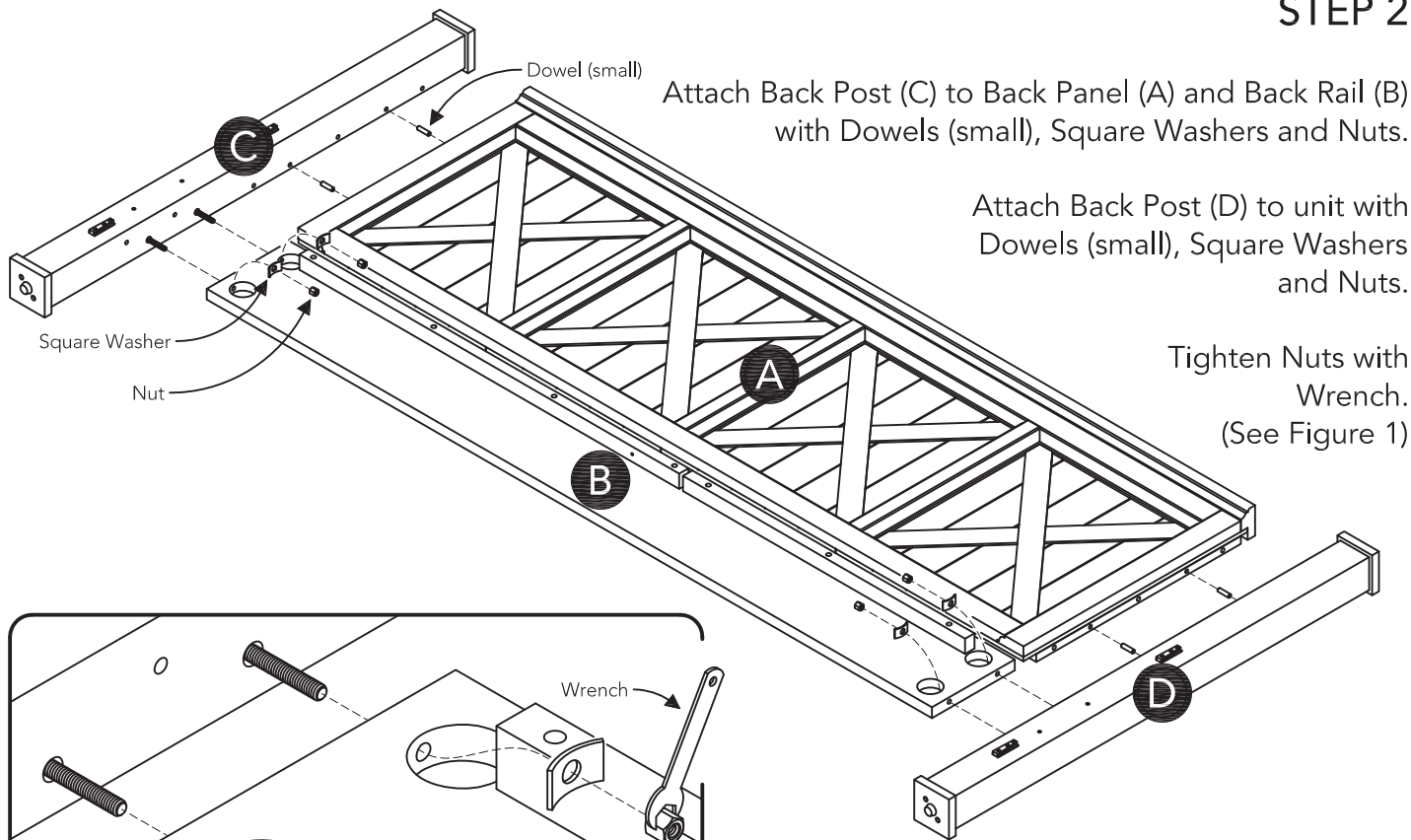

Figure 1

## STEP 3

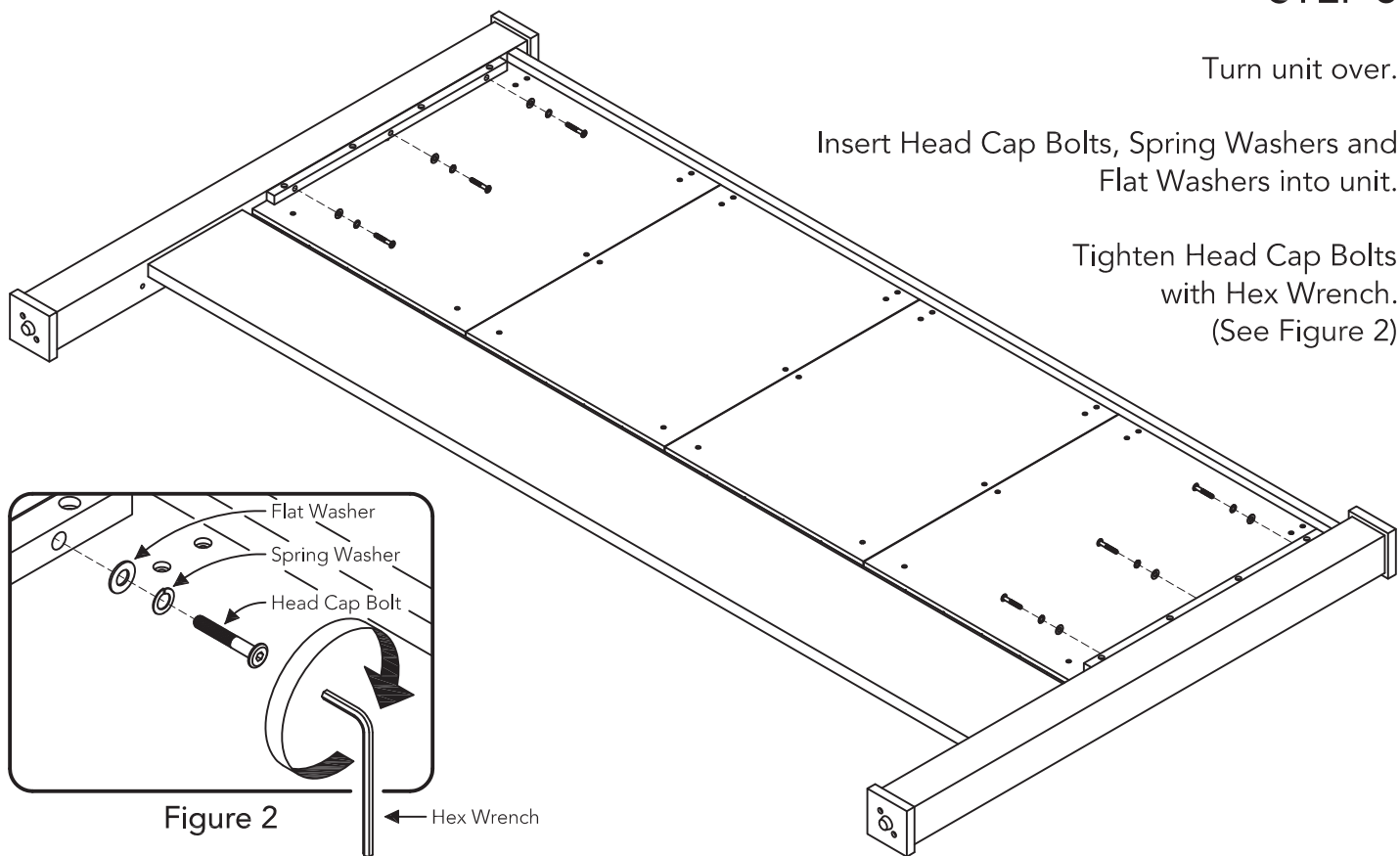
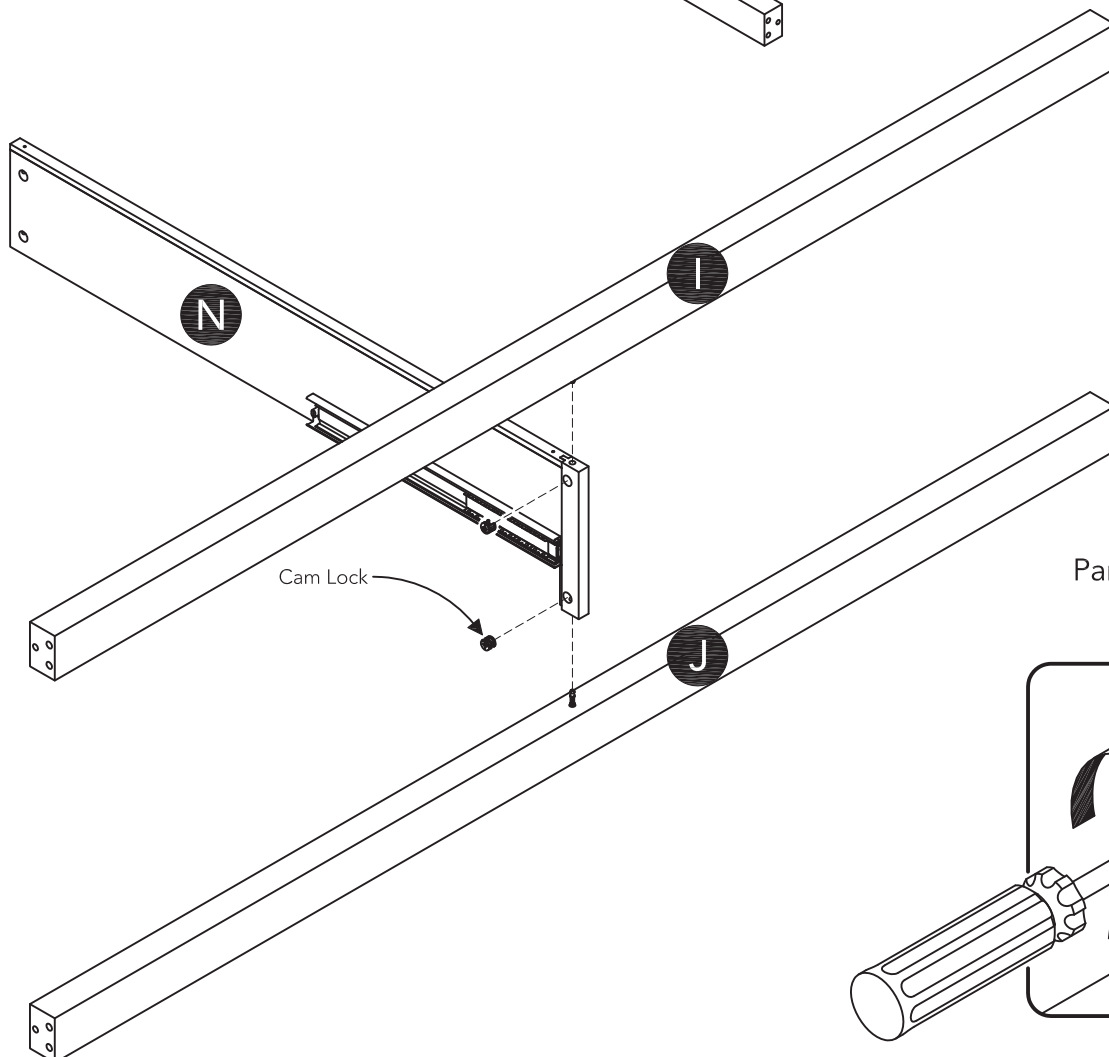
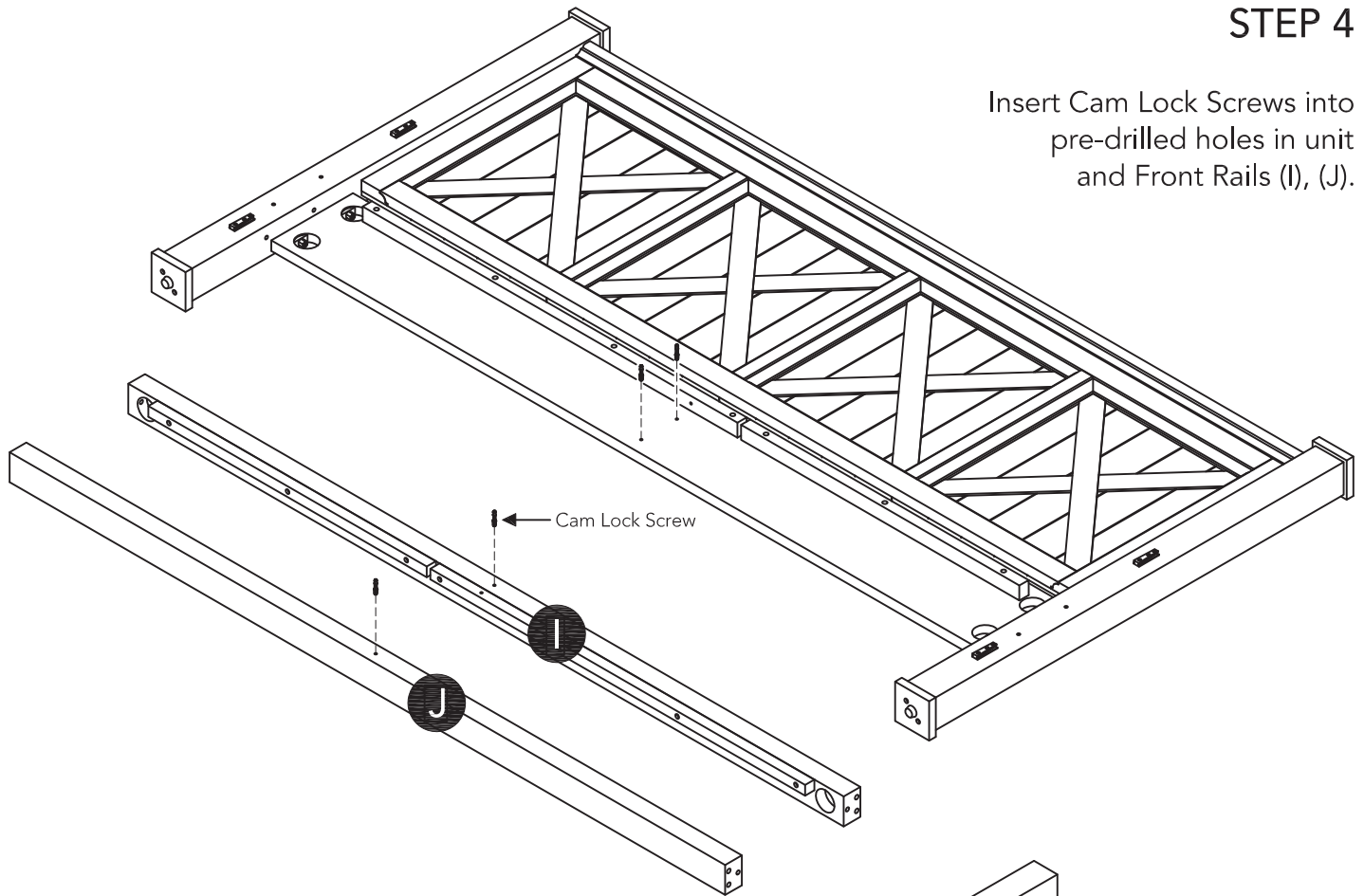

Figure 2

## STEP 4

Insert Cam Lock Screws into pre-drilled holes in unit and Front Rails (I), (J).



## STEP 5

Attach Front Rails (I) and (J) to Middle Panel (N) with Cam Locks. (See Figure 3)

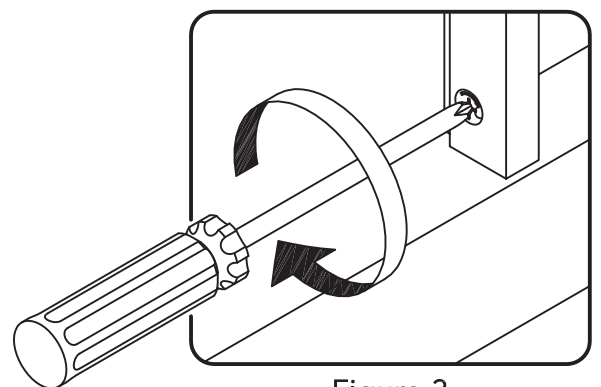

Figure 3

STEP 6

Attach Front Posts (F) and (G) to unit with Dowels (large), Square Washers and Nuts.

Tighten Nuts with Wrench.  
(See Figure 4)

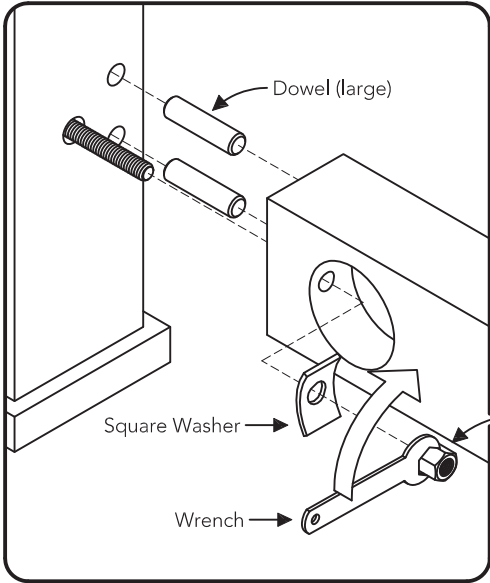
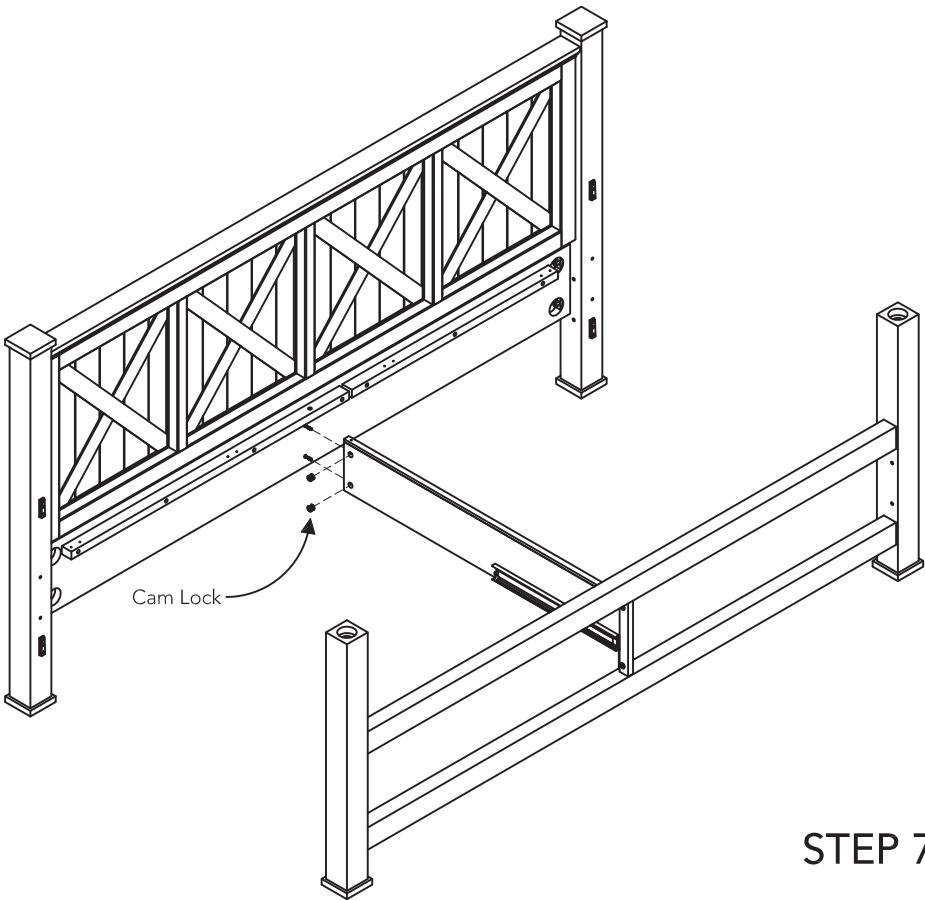
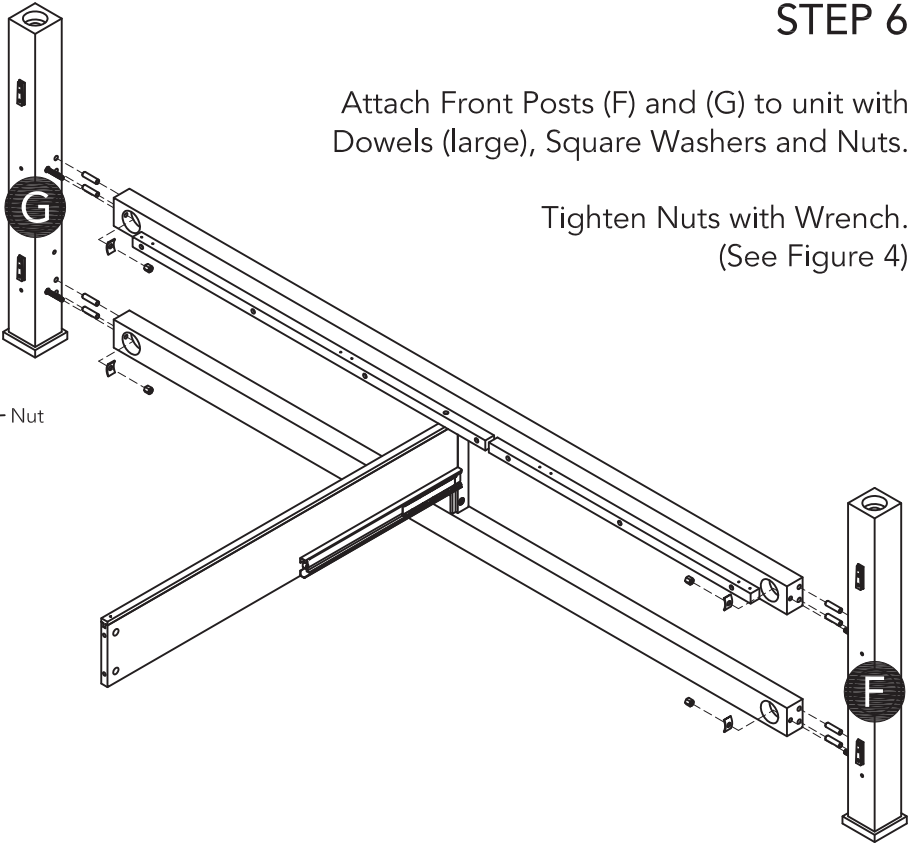

Figure 4



STEP 7

Attach unit from Step 3 to unit from Step 6 with Cam Locks.  
(See Figure 5)

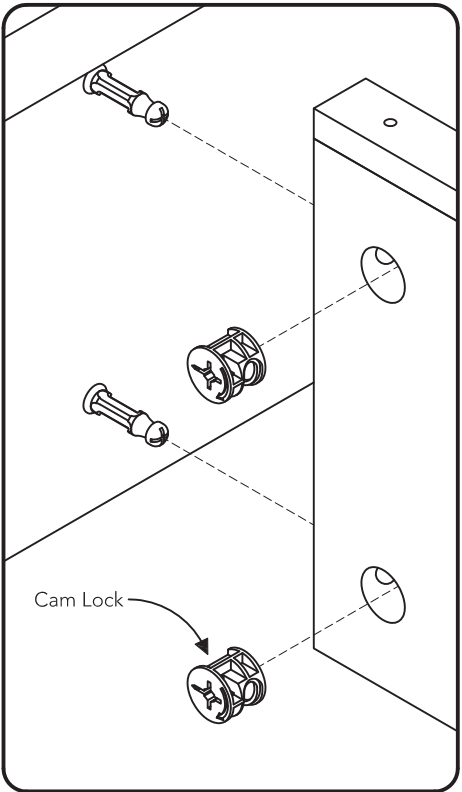

Figure 5

## STEP 8

Attach Side Panels (E) to unit by sliding metal sleeves on Side Panels (E) onto metal clips on unit. (See Figure 6)

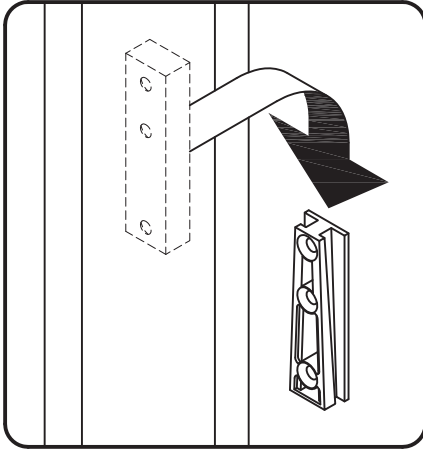
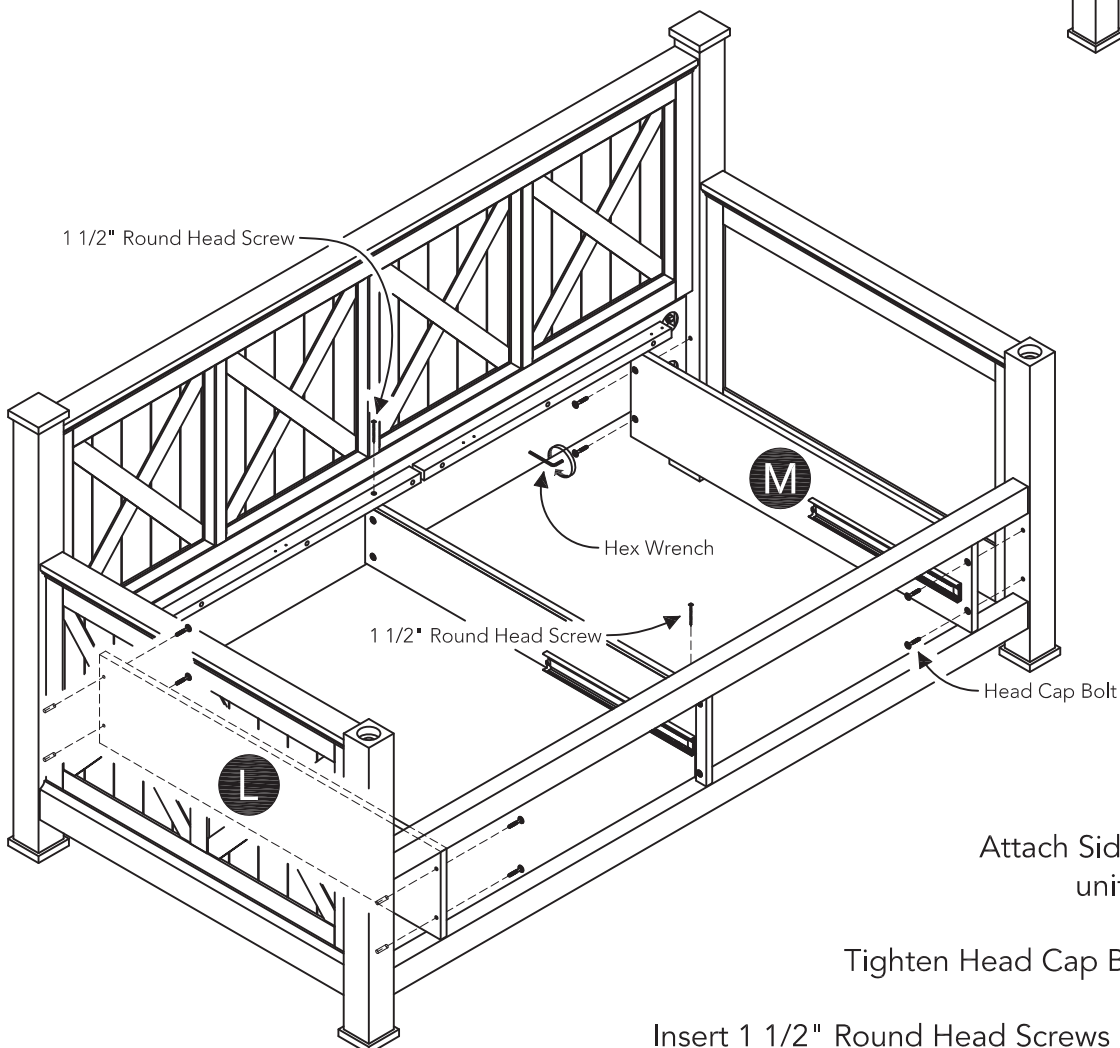
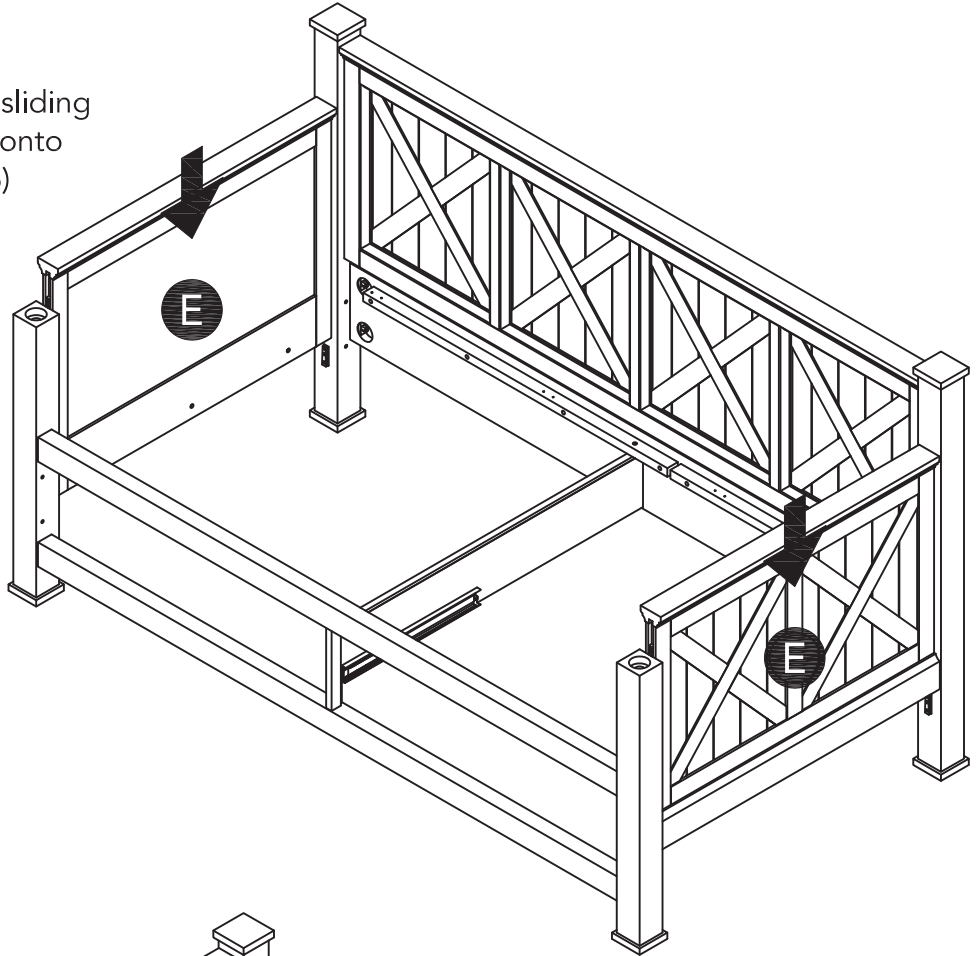

Figure 6



## STEP 9

Attach Side Panels (L) and (M) to unit with Head Cap Bolts.

Tighten Head Cap Bolts with Hex Wrench.

Insert 1 1/2" Round Head Screws into unit, then tighten.



## STEP 10

Attach Post Caps (H) to unit. (See Figure 7)

Attach Slat (K) to unit with 1" Round Head Screws into pre-drilled holes in unit.

Level unit by adjusting the adjustable levelers on bottom of unit. (See Figure 8)

Note: Unit must be level to work properly.

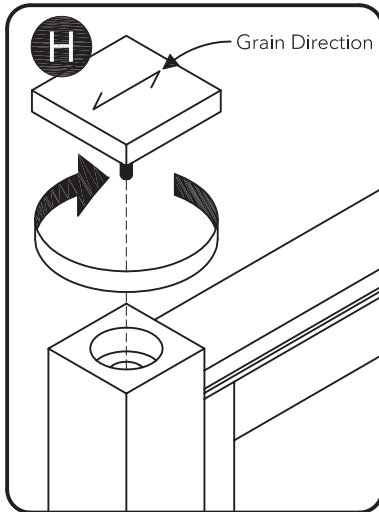

Figure 7

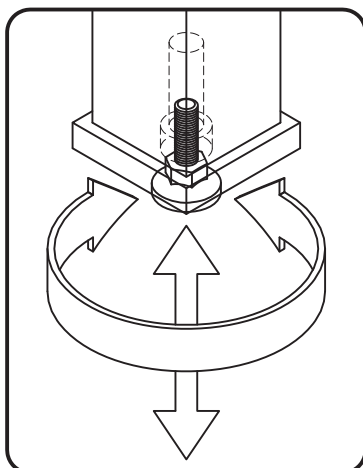
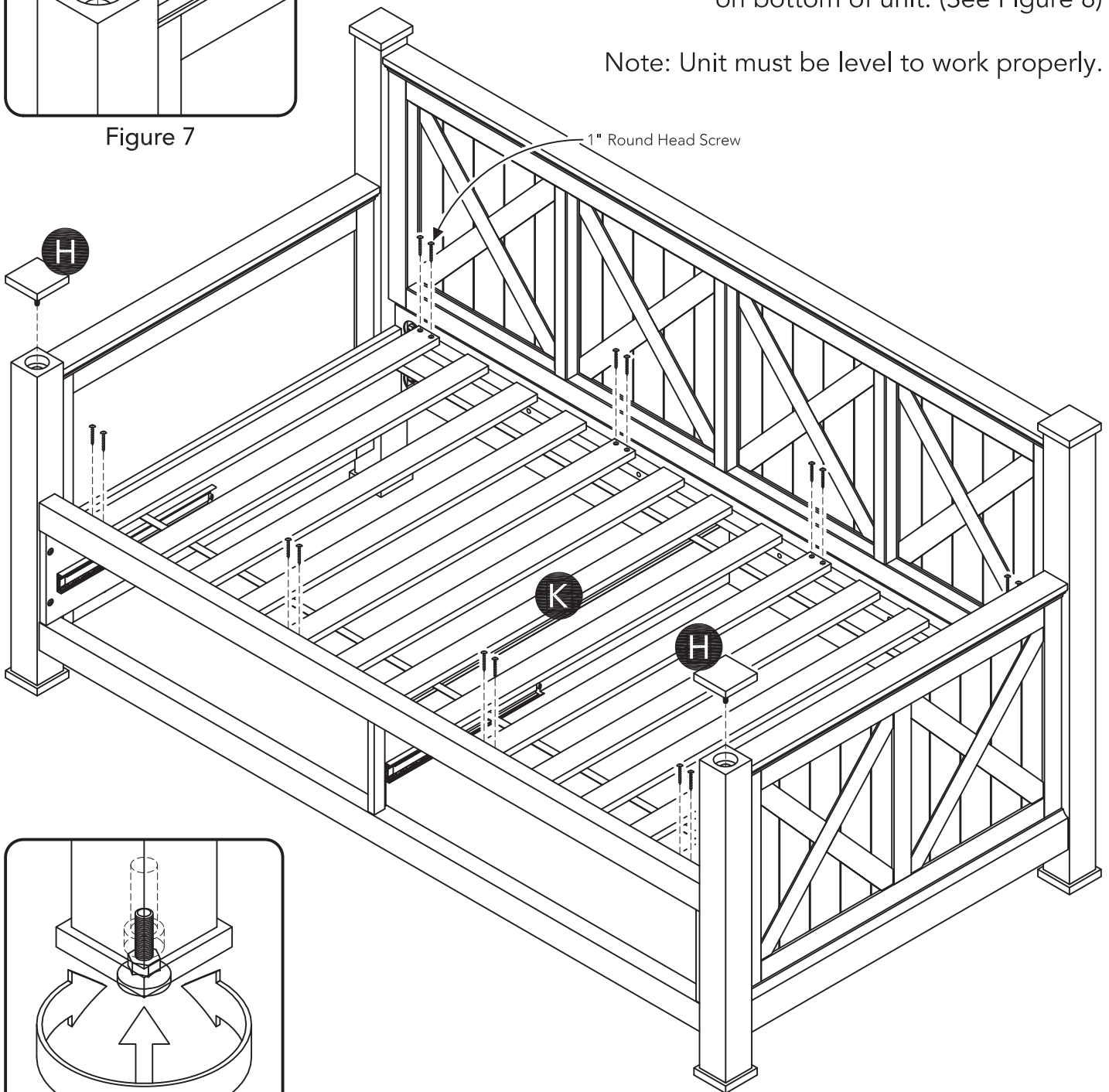
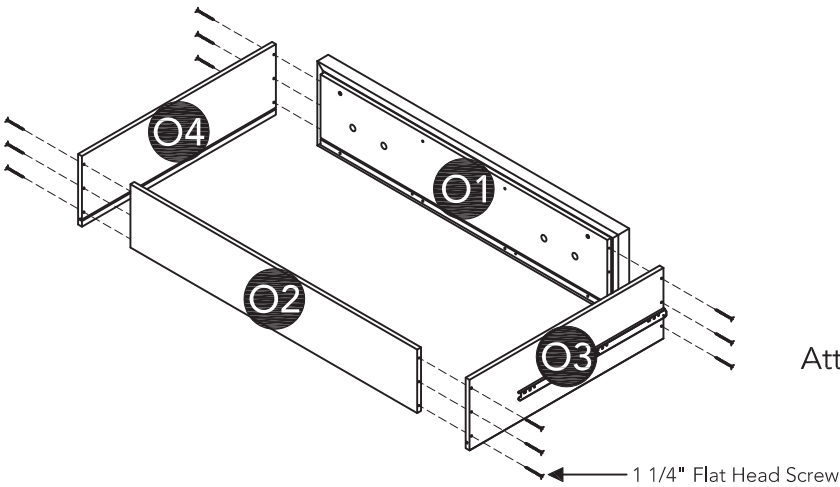

Figure 8

## Drawer (O)



### STEP 11

Attach Drawer Sides (O3) and (O4) to Drawer Front (O1) and Drawer Back (O2) with 1 1/4" Flat Head Screws.

### STEP 12

Insert Drawer Bottom (O5) into groove.

Attach Supports (O6) to unit with 1 1/4" Flat Head Screws.

Insert 1/2" Round Head Screws into Drawer Bottom (O5), then tighten.

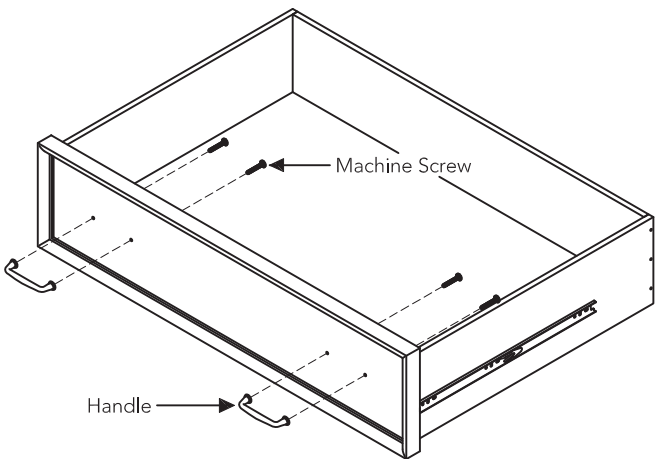
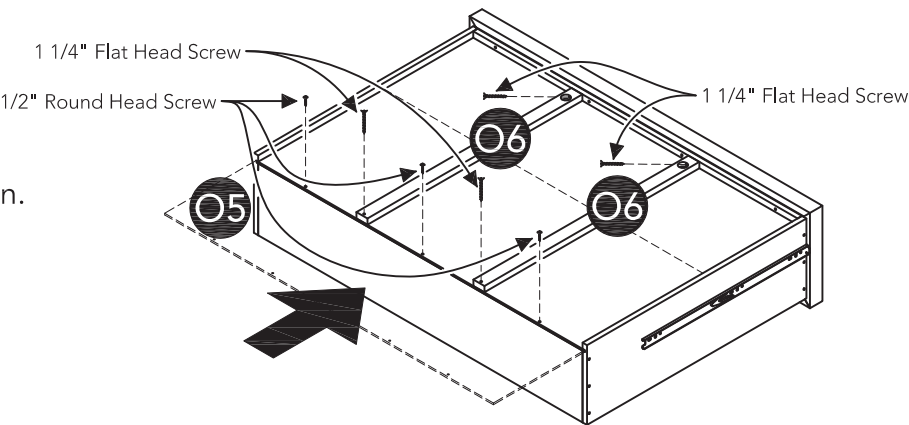

### STEP 13

Attach Handles with Machine Screws.

Note: Drawer assembly is not complete until 3/4" Flat Head Screws are used in a later step.

### Part List

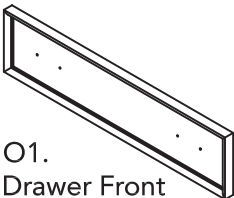

O1.  
Drawer Front  
2 pcs

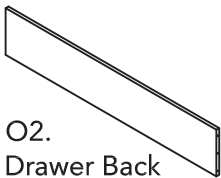

O2.  
Drawer Back  
2 pcs.

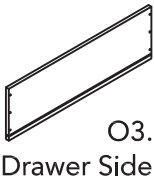

O3.  
Drawer Side  
2 pcs.

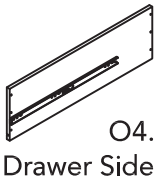

O4.  
Drawer Side  
2 pcs.

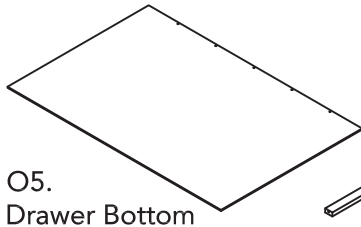

O5.  
Drawer Bottom  
2 pcs.



O6.  
Support  
4 pcs.



## STEP 14

Loosen slightly screws pre-installed on back of drawer fronts.

## STEP 15

Align metal runners on sides of Drawers (O) into metal guides on unit and slide Drawers (O) into unit.

Adjust drawer front panels left or right and up or down until gaps look proportional.

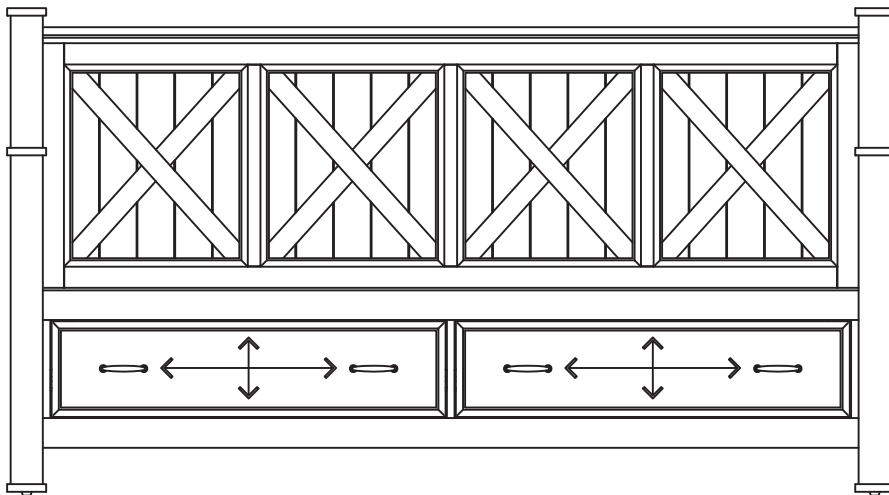
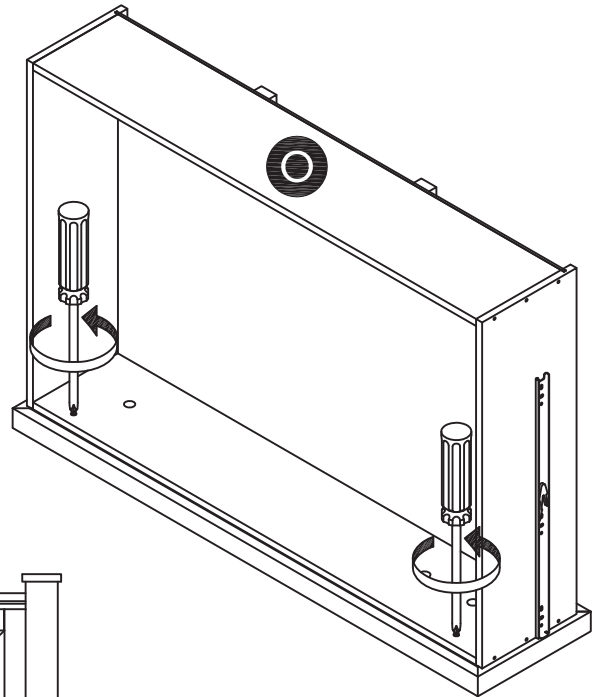

## STEP 16

Pull each drawer open slowly and re-tighten screws from Step 14.

Make sure drawer front panels do not move and remove each drawer by pushing plastic lever on left side up, pushing plastic lever on right side down, and pull open. (See Figures 9 and 10)

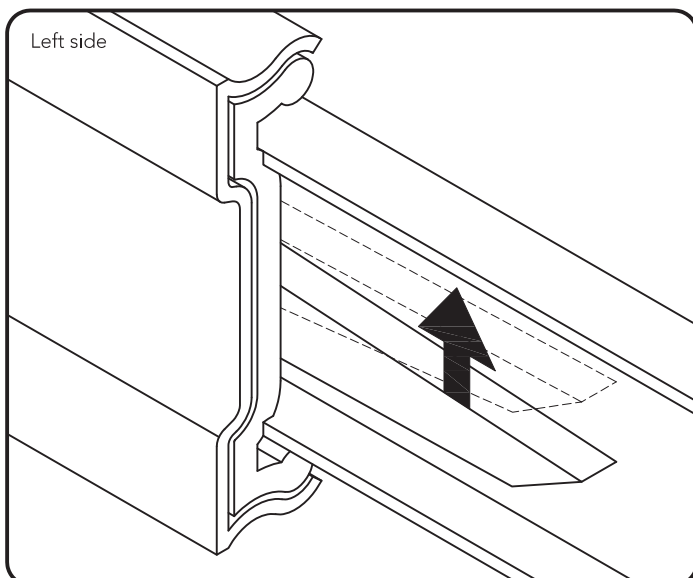

Figure 9

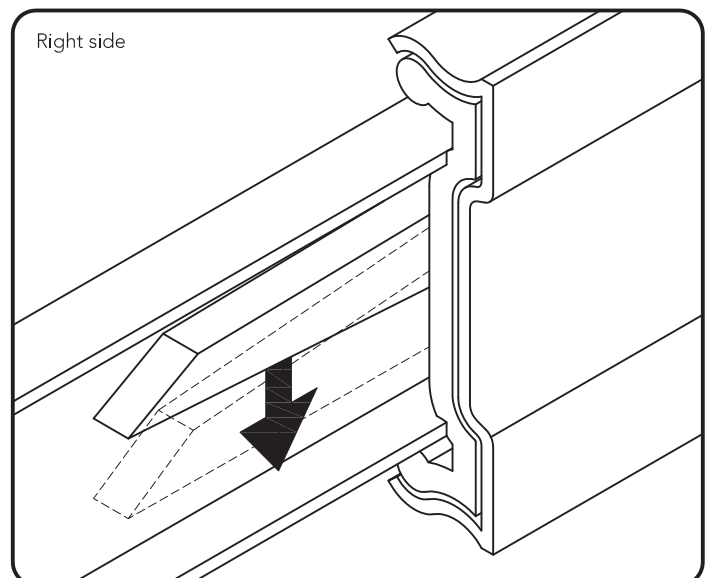
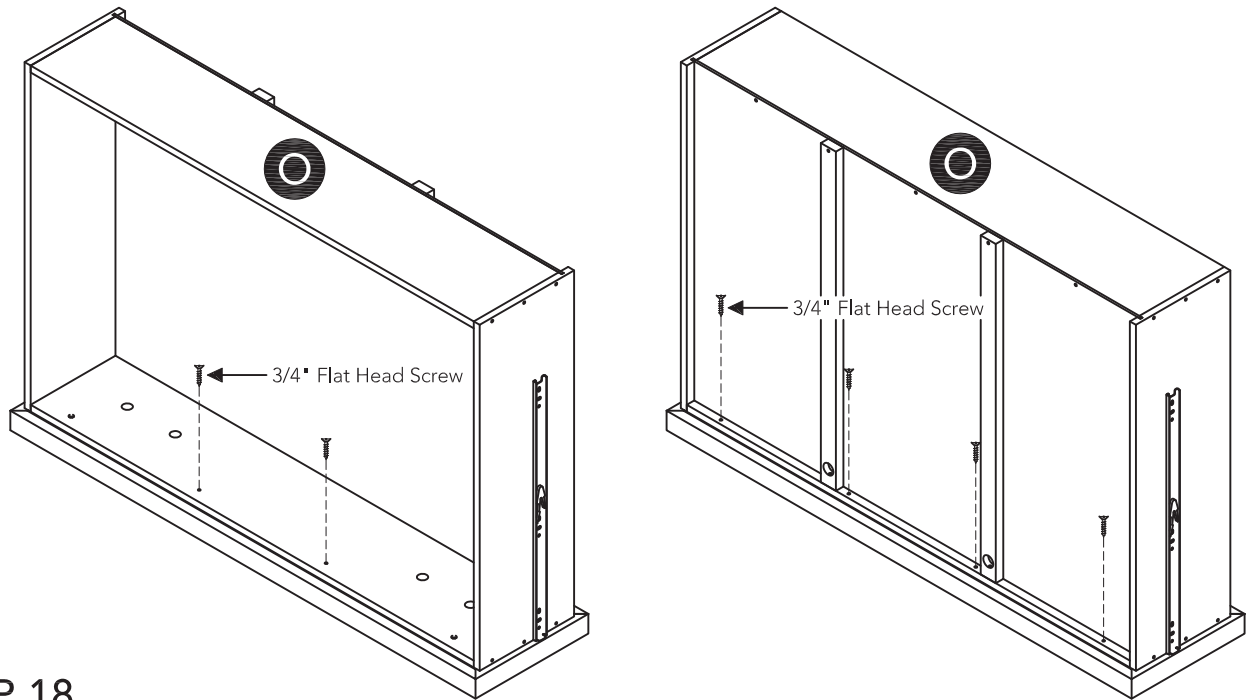

Figure 10

## STEP 17

Lock each drawer front panel into position with 3/4" Flat Head Screws.

Note: These 3/4" Flat Head Screws must be installed to complete the drawer assembly.



## STEP 18

Align metal runners on sides of Drawers (O) into metal guides on unit and slide Drawers (O) into unit.

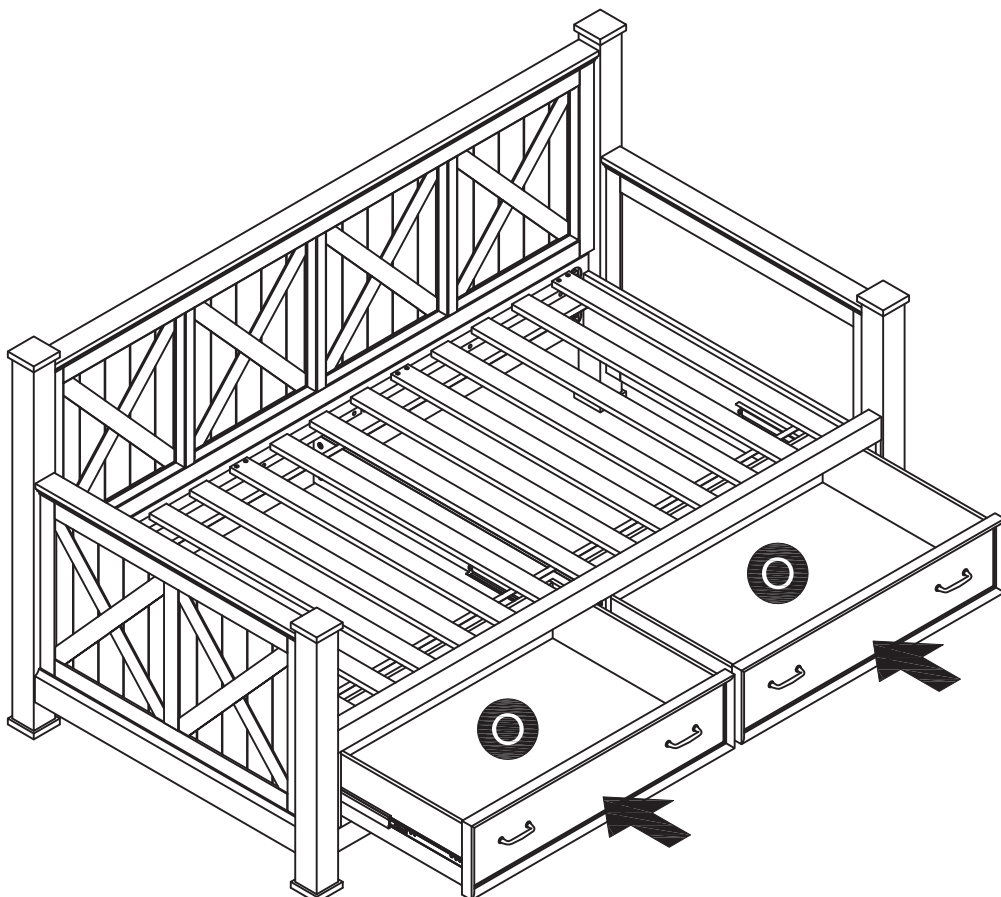

# CARE INSTRUCTIONS

## NEVER

allow liquids to remain on furniture.  
Absorption causes parts to warp  
and split and finishes to delaminate.

## NEVER

use glass cleaners on  
finished furniture. Ammonia  
chemically attacks the finish.



Do not use power tools  
above 8 volts to assemble.

**PREVENT  
CRACKING**



Do not place  
in direct sunlight.

**PREVENT  
FADING**



Do not write  
directly on surface.

**PREVENT  
MARKING**



Do not place hot  
objects on surface.

**PREVENT  
FINISH DAMAGE**



Do not use rubber  
based placemats.

**PREVENT  
DISCOLORING**



Do not use commercial  
waxes and polishes.

**PREVENT  
YELLOWING**

## CLEAN

with a soft cloth moistened  
in lukewarm soap and water.  
Buff with a dry clean cloth.



Home Styles will provide replacements free of charge for missing or damaged hardware or parts within 30 days of purchase. Digital images of the defective parts may be required. If the product was not purchased from an authorized retail affiliate, Home Styles is under no obligation to provide replacement parts. Parts are not available for fully assembled items nor are parts available for sale. Replacements for missing or damaged hardware or parts may be requested at:

[www.homestyles-furniture.com/customer-service/replacement-parts](http://www.homestyles-furniture.com/customer-service/replacement-parts)

Home Styles Customer Service: [www.homestyles-furniture.com](http://www.homestyles-furniture.com),  
[servicedesk@homestyles-furniture.com](mailto:servicedesk@homestyles-furniture.com), 888-680-7460, 877-831-0319