

**BOSS**<sup>®</sup>  
AUDIO SYSTEMS

**POLCAM USER MANUAL**  
UNIVERSAL OFF-ROAD  
FRONT OR REAR-VIEW CAMERA  
COMPATIBLE WITH POLARIS<sup>®</sup>  
RZR RIDE COMMAND™



## Introduction

Congratulations on your purchase, and welcome to BOSS Audio Systems!

This camera is designed to be mounted on the front or rear of your Polaris RZR vehicle. The camera is compatible with Polaris RZR models equipped with Ride Command unit. With the supplied connection cables, you can easily plug and play on any other head unit with a video input.

## Delivery content

- 1x Front/Rear camera with female JST Ride Command compatible connector
- 1x Universal Power/Video cable with male JST connector
- Camera mounting kit
- User manual

## Before use

Read and understand all instructions before you use your product. If you do not follow the instructions in this manual, we are not responsible for injury or damage resulting from improper handling, or vehicle damage due to improper installation. This will also void the warranty.

## Important safety precautions

- Use of the camera must not replace other safe driving habits. Precise control and looking around before backing up is necessary.
- Always remember that the area displayed by the camera system is limited, and certain obstacles may not be detected or not reliably detected.
- Servicing must only be carried out by a technician. Contact our technical support for any service question.

## Installation precautions

- **WARNING:** Always consult a professional installer.
- Improper wiring and mounting of the product can cause damage, injury or accident. Have installation performed by a professional only. Contact our technical support for any installation questions.
- Observe the safety and operating instructions of the devices which are connected to the product.
- Only use the accessories provided with the product.

## Wiring

### Important notes on wiring

- This product must be used with 12 DC power supply. Never connect this product to any other power supply.
- Disconnect the negative terminal of the vehicle battery prior to installation.
- Make sure wires are not squeezed or damaged by sharp edges. Use rubber bushings for protection if needed.

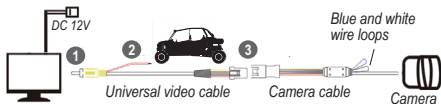

- 1. Connect the camera to the monitor on your vehicle. See ①.**  
Connect the yellow RCA plug of the supplied video cable to the video input on your monitor.  
See the user manual of your monitor for power connection to the monitor.
- 2. Connect the camera to power supply. See ②.**  
For the front camera:  
Connect the red splitting wire of the video cable to the accessory power of your vehicle. When connected to the accessory power, the camera will auto power on and display live view upon starting the vehicle engine.  
For the rear camera:  
Connect the red splitting wire of the video cable to the positive wire of the reverse light. When connected to the reverse light, the camera will auto power on and display live view upon putting the vehicle in the reverse gear.
- 3. Connect the video and camera cables together. See ③.**  
Now you complete all the camera wiring.

### Image setting

- When used as a front camera, cut off the blue wire loop to avoid reverse image. When used as a rear camera, keep the blue wire loop uncut for rear view image.
- To display guide lines in the camera view, keep the white wire loop uncut. Otherwise, cut it off.
- To activate the image setting change (cut-off of the wire loop), unplug the camera cable and plug it again.

## Mounting

### Important notes on mounting

- When making modifications to the vehicle due to the installation, make sure traffic safety and stability of the vehicle is not impaired.
- When drilling or cutting any holes on your vehicle, make sure the fuel tank, fuel lines, hydraulic lines and electrical wiring are not damaged.

### Option 1: Flush mount

1. Select a suitable location on the front or rear of your vehicle (e.g. front or rear bumper). Then cut an appropriate hole which fits the camera securely.
2. Flush mount the camera as illustrated below. No screws are required.

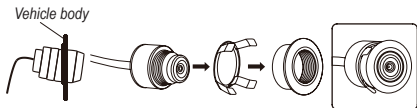

### Option 2: Hanging mount

1. Select a suitable location on the front or rear of your vehicle (e.g. front or rear bumper). Then cut an appropriate hole for the camera cable, and drill two screw holes for the mounting bracket.
2. Use the supplied two screws to fix the bracket then attach the camera to the bracket as illustrated below.



## Care of the environment

Do not throw away the product with the normal household waste at the end of its life, but hand it in at an official collection point for recycling. By doing this, you help to preserve the environment.

## Troubleshooting

Refer to the checklist below to solve the problems when using the product. If problems persist, contact our technical support. Do not attempt to disassemble or modify the product.

Problem	Solution
No image	Check that the power cable is correctly or securely connected (see section "Wiring"). Check that the video cable has a good connection to the video input on the monitor. Check that the reverse gear is engaged for the rear camera. Check to ensure correct image settings on your monitor.
Image blurring	Check for water drops or dust on the camera lens. Clean it with a damp, fiber-free cloth.
Image shaking	Check the camera is securely mounted.
Image slanted	Check the camera is horizontally mounted.

## Specifications

Power supply .....	12V DC (allowable 9 – 15 V DC)
Viewing angle .....	170°
TV system.....	PAL/NTSC
Video output .....	1.0 vp-p, 75 $\Omega$
Signal-to-noise ratio.....	$\geq 48$ dB
Operating conditions.....	-22 to +158°F (-30 to +70°C), max. 95% RH
White balance.....	Auto
Illumination .....	min. 0.5 lux
Automatic gain control (AGC).....	Auto
Effective pixels.....	656 x 492

*Product information is subject to change without notice.*

**BOSS**<sup>®</sup>  
AUDIO SYSTEMS



BOSS Audio Systems  
3451 Lunar Court • Oxnard, CA 93030  
[www.bosssaudio.com](http://www.bosssaudio.com)  
805-751-4853 Customer Service  
Tech Support: [www.bosssaudio.com/support](http://www.bosssaudio.com/support)



0821