

Record your model number below for future reference:

Important Information
Observe all local plumbing and building codes.

1 Determine the valve stem adapter length. Refer to the plaster guard.

Thin Wall: Use the #3 adapter and the 13/16" (21 mm) screw.

Standard Wall: Use the #1 adapter and the 13/16" (21 mm) screw.

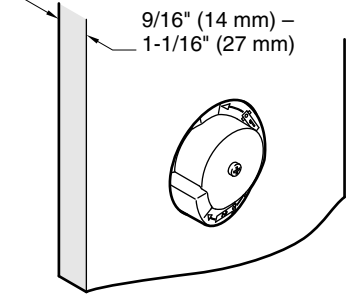
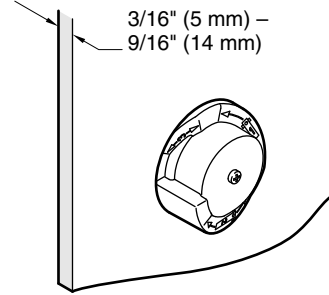
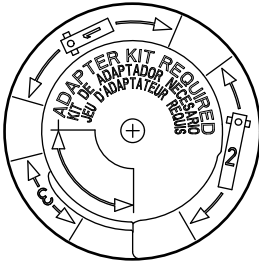

Thick Wall: Use the #2 adapter and the 1-3/8" (35 mm) screw.

2 Remove the plaster guard. Place the spline adapter on the valve stem.

3 Temporarily fit the valve stem adapter on the spline adapter.

4 Position the handle on the valve stem adapter.

5 2-way valve: Water should flow from the main shower accessory with the handle position at 4 o'clock.

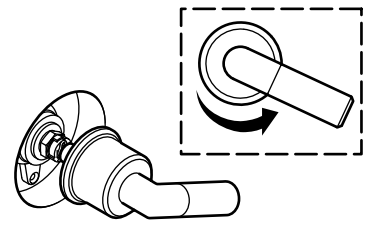
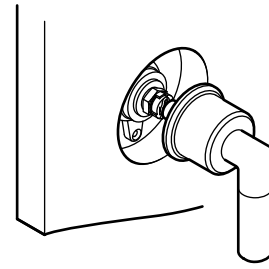
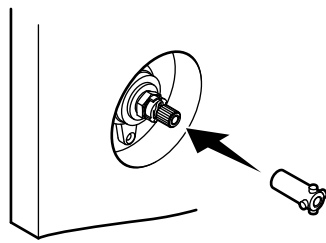
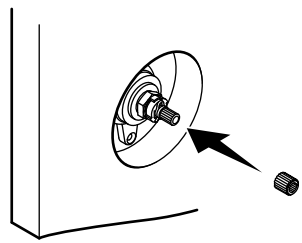
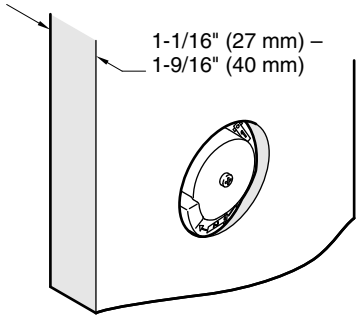

3-way valve: Water should flow from the main shower accessory with the handle position at 12 o'clock.

6 To adjust position, remove the handle and valve stem adapter. Turn the spline adapter.

7 Secure the valve stem adapter with the proper length screw.

8 Secure the plate assembly to the valve with proper length screws. **Do not overtighten.**

9 Fit the faceplate over the plate assembly with the notch down.

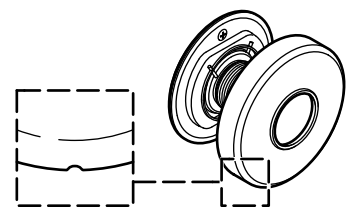
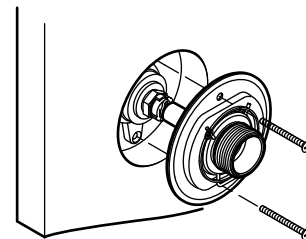
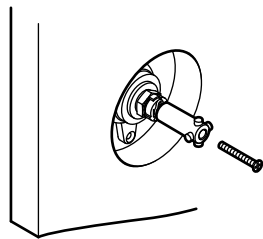
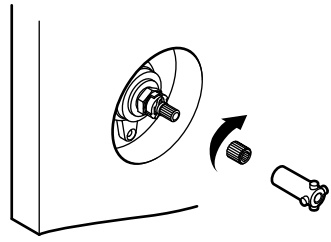
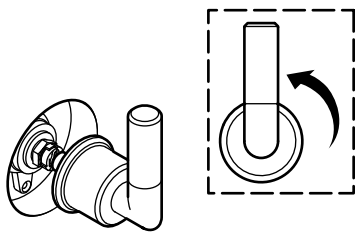

10 Point the handle down. Thread the bonnet onto the hub.

