



TF 1700

Standalone Outdoor Fingerprint Reader Controller

IP65 rated Fingerprint Access Control Reader



Biometric Performance:

Reliable, durable and highly accurate ZK fingerprint sensor with latest fingerprint matching algorithm which provides less than 1.5 second user recognition.



Communication:

TF1700 installs easily on your network having both Ethernet and RS232/485 serial ports. Weigand-OUT port allows connection of reader to ZK or any 3rd party access control panel. Using Weigand-IN port you connect to any card reader for dual factor authentication.



Easy Operation and Management:

Works without computer. Complete setup and programming can be done via keypads and embedded firmware. Audio-Visual Indication for acceptance and rejection of valid/invalid fingerprints, cards and passwords.



Full Access Control Built In:

Relay Outputs for electric lock and alarm. Inputs for door status sensor and request to exit hardware. Supports multiple timezones and personnel groups for programming valid entry zones.



Waterproof Enclosure:

IP65 rated waterproof enclosure permits this reader to be used for outdoor applications. The cables and connectors are epoxy sealed at the back of the reader.



Capacity:

Can store up to 2,200 fingerprint templates, 10,000 cards and 30,000 transactions. The data can be backed up to a USB Flash Disk and can also be transferred to another reader in the absence of computer connectivity



Options:

Internal Proximity Card or Mifare Card reader allows dual factor authentication for access control.



For Software Developers:

Free SDK and development tools are available for developers/partners who wish to integrate TF1700 with any application which requires verifying people.

Standalone Installation

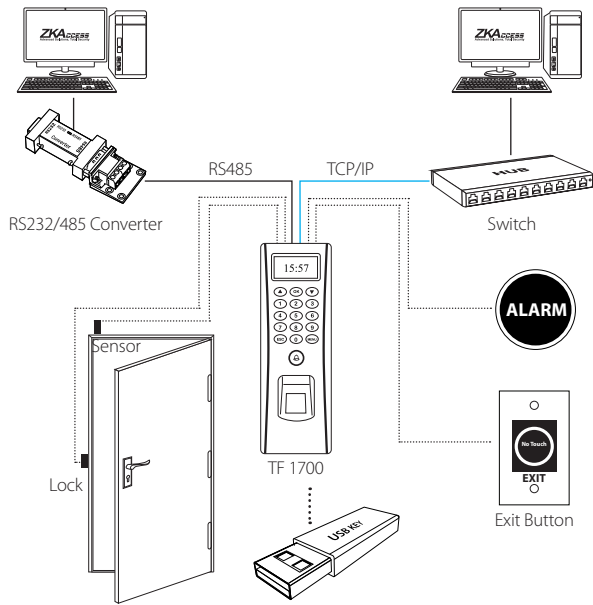

Installation with Access Control Panel

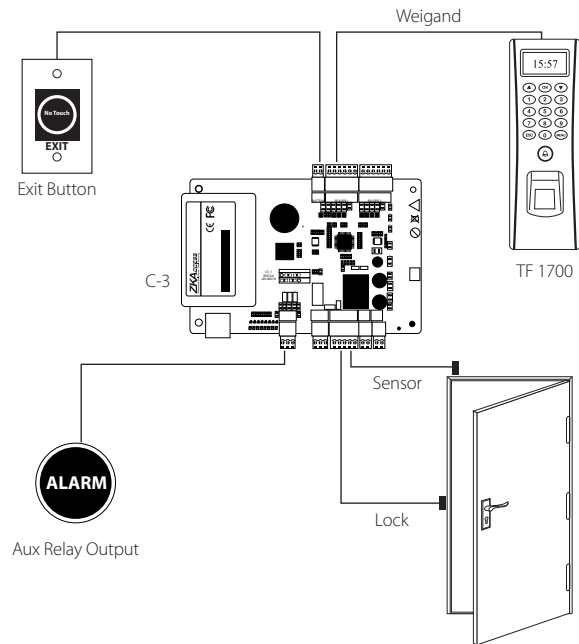

Specifications

Capacity

Fingerprint: 2,200 templates
Cards: 10,000 templates
Transactions: 30,000 logs

Display

3.5inch OLED Monochrome Display

Access Control Interface

3rd party electric lock, door sensor, exit button, alarm, door bell

Communication

Ethernet, RS 232, RS485, Weigand Input and Output, USB Host

Power

12V DC, 3A

Environment

Operating Temperature:
 32° to 113° F (0° to 45° C)
 Operating Humidity: 20% to 80%

Dimensions

Height: 7.28in (18.5cm)
Length: 2.46in (6.25 cm)
Width: 1.63in (4.15 cm)
Weight: 0.80lbs (0.36kg)

Supported Card Formats

ID Card
 Mifare Card

Part Numbers

TF 1700

TF 1700-ID with Proximity card reader

TF 1700-M with Mifare card reader

What's in the Box

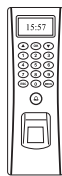

TF 1700

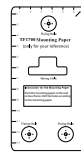

Installation Template

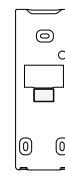

Back Plate

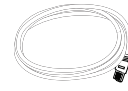

Network Cable

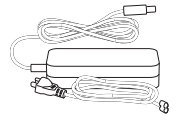

AC Power Adapter



Cables

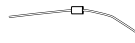

Diode



Screws



Screwdriver



Design and Specifications subject to change without notice

6 Kingsbridge Road, Suite 8
 Fairfield, NJ 07004
 +1 862 505 2101
 sales@zkaccess.com
 zkaccess.com