

homestyles®

20 06662 0032

# Dining Table



## IMPORTANT

Carefully remove all the parts from the carton and place them individually on a soft cloth to prevent scratches or other damage.

Carefully and strictly follow these assembly instructions to ensure a completed product as designed.

This product is made of aluminum. Do not use power tools above 8 volts to assemble and only tighten bolts until snug. Over tightening can damage the aluminum.

## Part List

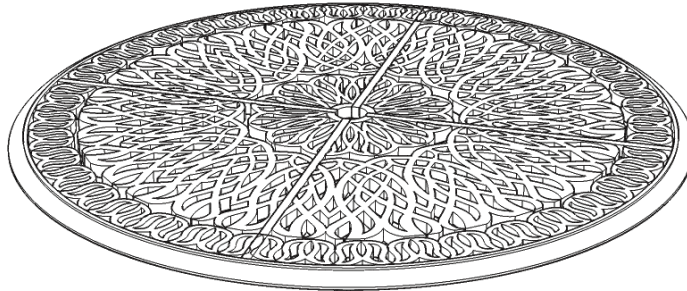

A.  
Top  
1 pc.

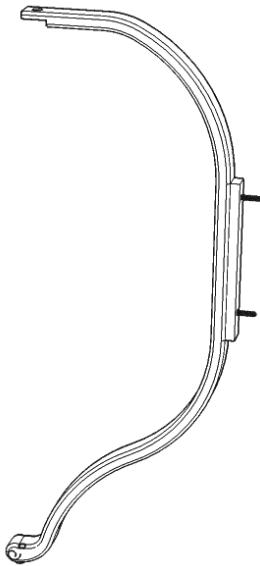

B.  
Leg  
4 pcs.

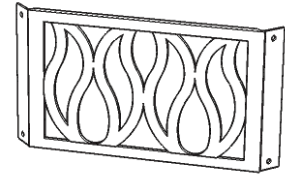

C.  
Stretcher  
4 pcs.

## Hardware List



Hex Wrench  
1 pc.

Wrench  
1 pc.



Spring Washer  
12 pcs. (+1 extra)

M8  
Nut  
12 pcs. (+1 extra)

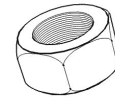

Small Hex Wrench  
1 pc.

M8x30  
Bolt  
4 pcs. (+1 extra)



Flat Washer  
12 pcs. (+1 extra)

Cap  
12 pcs. (+1 extra)

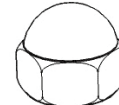

Cover  
1 pc.



Tool(s) required for assembly: Level

Home Styles Customer Service: [www.homestyles-furniture.com](http://www.homestyles-furniture.com),  
[servicedesk@homestyles-furniture.com](mailto:servicedesk@homestyles-furniture.com), 888-680-7460, 877-831-0319

## Assembly Instructions 2/3

### IMPORTANT

- Use a soft cloth between these parts and the floor.
- Do not use power tools above 8 volts to assemble.
- Do not tighten all the bolts until each part is properly assembled.
- The unit must be level to work properly. Use the included adjustable levelers to level.
- Keep Wrench as the nuts may need to be tightened in the future.

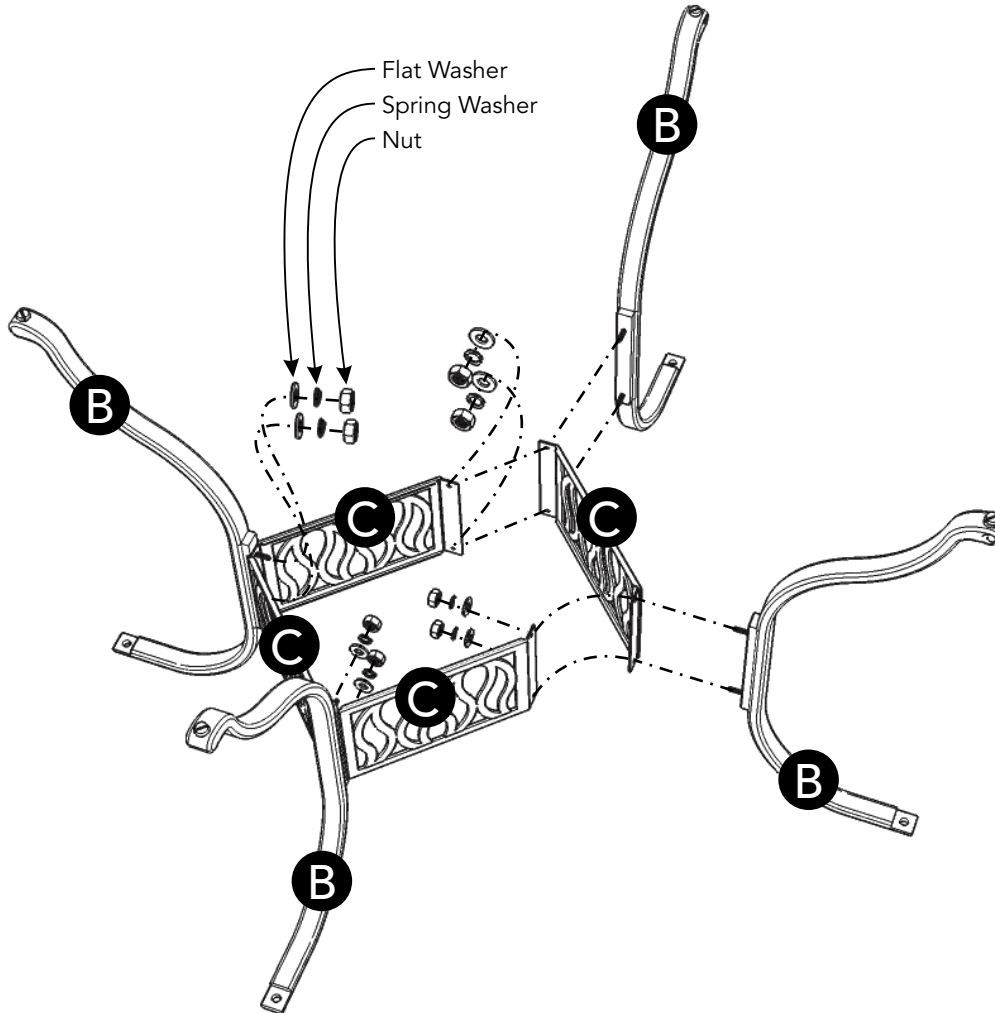

### STEP 1

Attach Legs (B) to Stretchers (C) with Flat Washers, Spring Washers and Nuts, tightening Nuts only halfway. (See Figures 1 and 2)

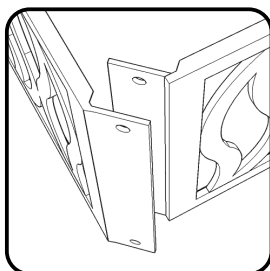

Figure 1

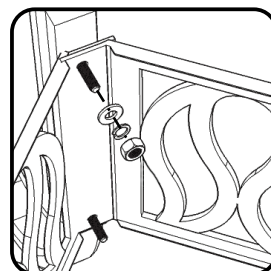

Figure 2

## Assembly Instructions 3/3

### STEP 2

Place Top (A) upside down on a soft cloth.

Insert Bolts into pre-drilled holes in Top (A), then tighten. (See Figure 3)

Attach unit to Top (A) with Flat Washers, Spring Washers and Nuts, tightening Nuts only halfway.

Tighten all Nuts used in Steps 1 and 2.

Cover all Nuts with Caps.

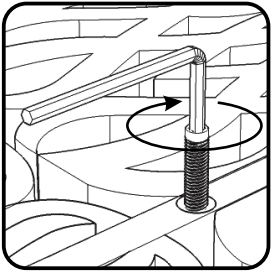
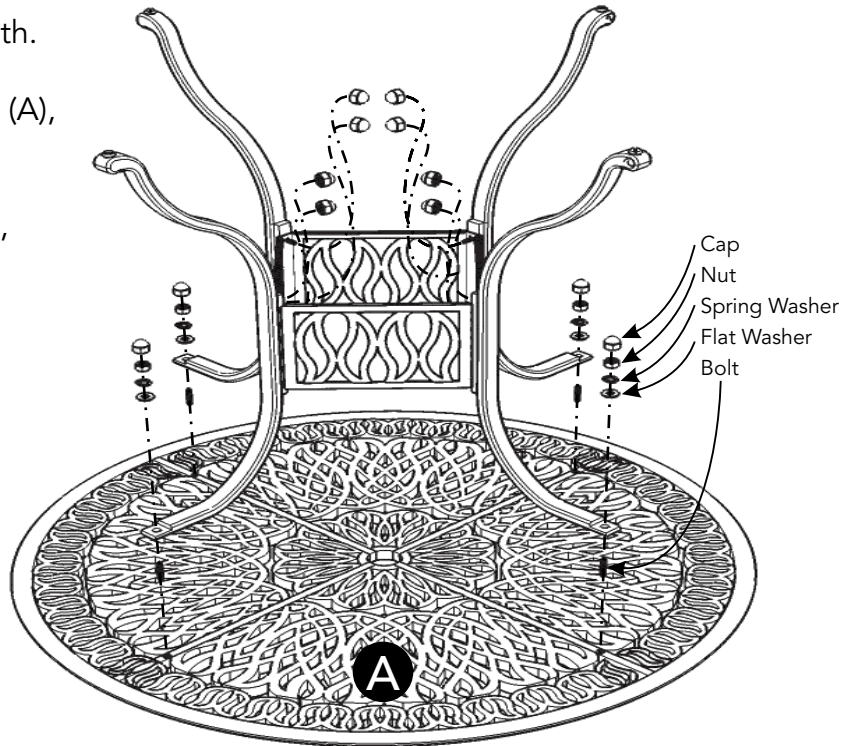

Figure 3

### STEP 3

Turn table over to its upright position.

Cover umbrella hole with Cover.

Level table by adjusting the adjustable levelers on bottom of legs. (See Figure 4)

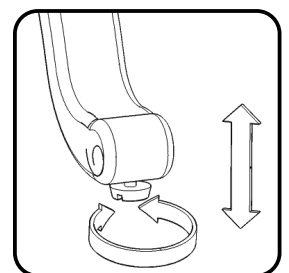
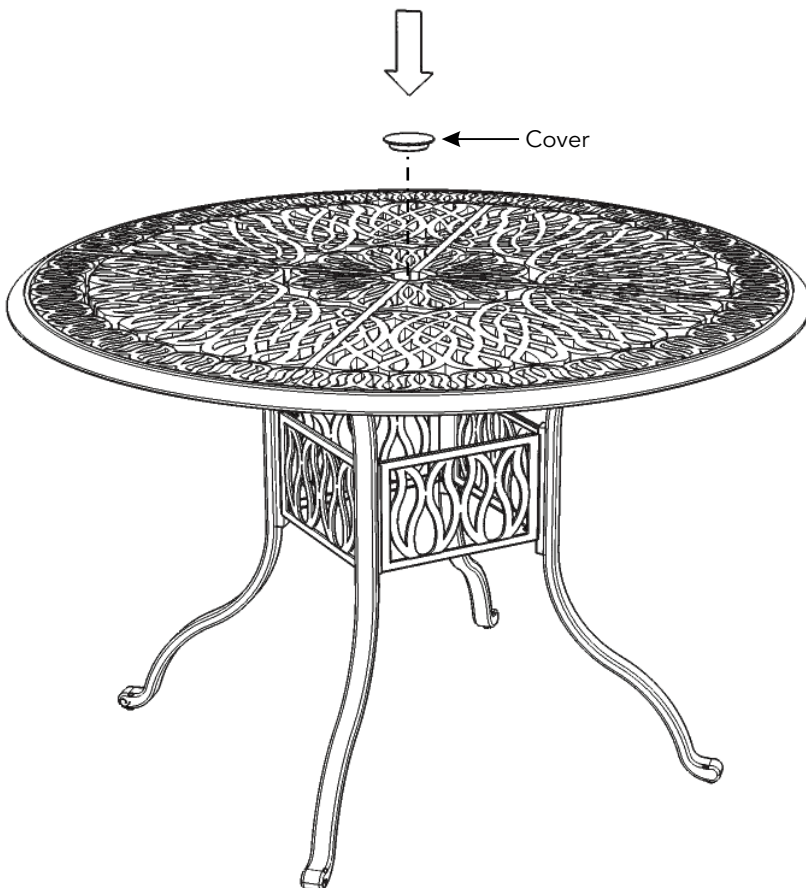

Figure 4

# CARE INSTRUCTIONS

## NEVER

allow liquids to remain on furniture.  
Absorption causes parts to warp  
and split and finishes to delaminate.

## NEVER

use glass cleaners on  
finished furniture. Ammonia  
chemically attacks the finish.



Do not use power tools  
above 8 volts to assemble.  
**PREVENT  
CRACKING**

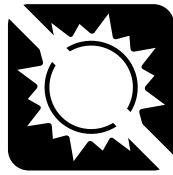

Do not place  
in direct sunlight.  
**PREVENT  
FADING**



Do not write  
directly on surface.  
**PREVENT  
MARKING**



Do not place hot  
objects on surface.  
**PREVENT  
FINISH DAMAGE**

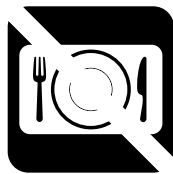

Do not use rubber  
based placemats.  
**PREVENT  
DISCOLORING**



Do not use commercial  
waxes and polishes.  
**PREVENT  
YELLOWING**

## CLEAN

with a soft cloth moistened  
in lukewarm soap and water.  
Buff with a dry clean cloth.



Home Styles will provide replacements free of charge for missing or damaged hardware or parts within 30 days of purchase. Digital images of the defective parts may be required. If the product was not purchased from an authorized retail affiliate, Home Styles is under no obligation to provide replacement parts. Parts are not available for fully assembled items nor are parts available for sale. Replacements for missing or damaged hardware or parts may be requested at:

[www.homestyles-furniture.com/customer-service/replacement-parts](http://www.homestyles-furniture.com/customer-service/replacement-parts)

Home Styles Customer Service: [www.homestyles-furniture.com](http://www.homestyles-furniture.com),  
[servicedesk@homestyles-furniture.com](mailto:servicedesk@homestyles-furniture.com), 888-680-7460, 877-831-0319