

Model 730-L-BLK High Back Fixed Arm Upholstered Chair

Parts Listing

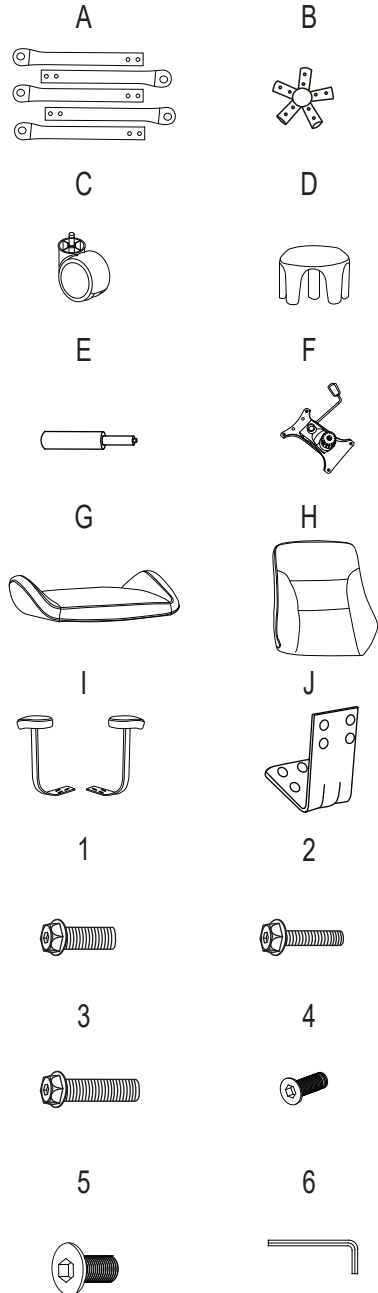

Assembly Instructions



Tools Needed: Allen Wrench (provided)
Please read all instructions before assembly.

- Step 1: Insert 5 Metal Legs (A) to the Center Part (B) as below drawing showing.
- Step 2: Using 10 Screws (5) to fix the 5 Metal Legs (A) to the Center Part (B). Tighten all screws with Allen Wrench (6).
- Step 3: Insert Casters (C) into bottom of Assembled Chair Base (A&B). Put Base Cover (D) on top Assembled Chair Base (A&B). Insert Gas Lift (E) into center hole of Assembled Chair Base (A&B).
- Step 4: Attach Arms (I) to Chair Seat (G) by using 6 Screws (2). Tighten with Allen Wrench (6).
- Step 5: Attach Seat Mechanism (F) to Chair Seat (G) by using 4 Screws (1). Tighten with Allen Wrench (6).
- Step 6: Attach J-BAR (J) to Chair Back(H) by using 4 Screws (4). Tighten with Allen Wrench (6).
- Note: Please place the J-bar with the arrow pointing to the top of back cushion during assembly.
- Step 7: Attach J-BAR (J) to Chair Seat(G) by using 4 Screws (3). Tighten with Allen Wrench (6).
- Step 8: Turn the Assembled Seat upright and locate the central hole of the Seat Plate (F) over the Gas Lift (E). Push down firmly until connection is secure.

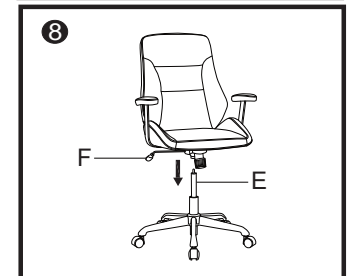
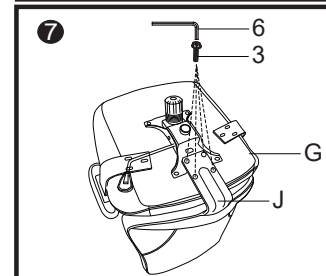
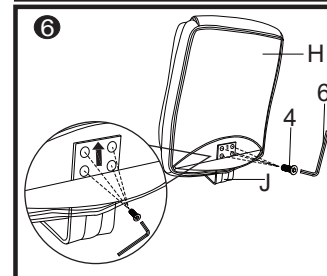
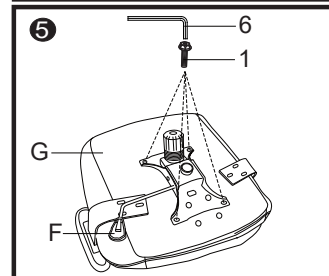
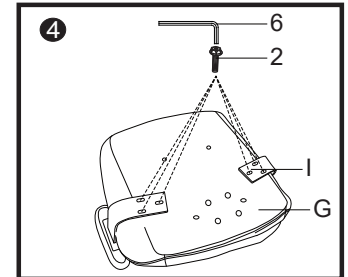
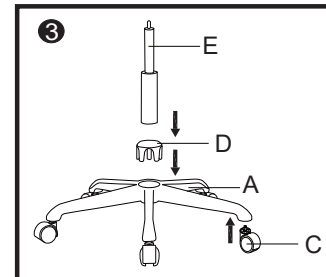
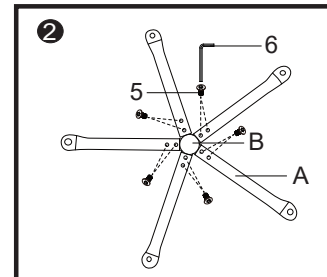
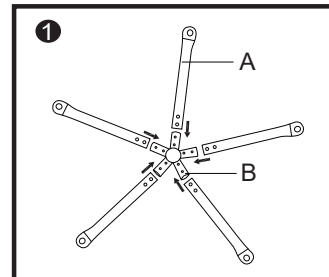

WEIGHT CAPACITY: 225 lbs.

Assembly Notes:

During assembly, hand tighten screws only. When all screws are in place, you may then tighten all screws completely.

CAUTION:

1. Do not use this chair as a step ladder.
2. Check for loose screws and tighten them every 6 months.

ofm

161 Tradition Trail, Holly Springs, NC, 27540
 800-520-7471 (voice) 919-362-4765 (fax)
 919- 303-6389 (voice) www.ofminc.com
 support@ofminc.com