

Vanity with Mirror

IMPORTANT

Carefully remove all the parts from the carton and place them individually on a soft cloth to prevent scratches or other damage.

Carefully and strictly follow these assembly instructions to ensure a completed product as designed.

Do not use power tools above 8 volts to assemble.

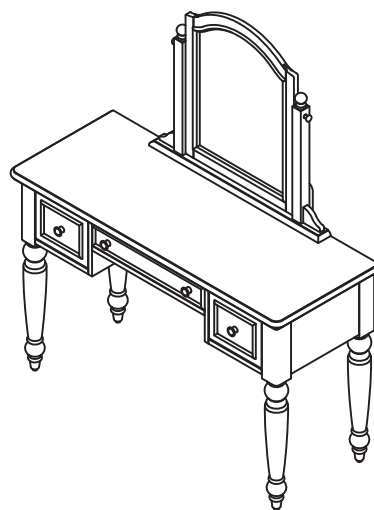

Part List

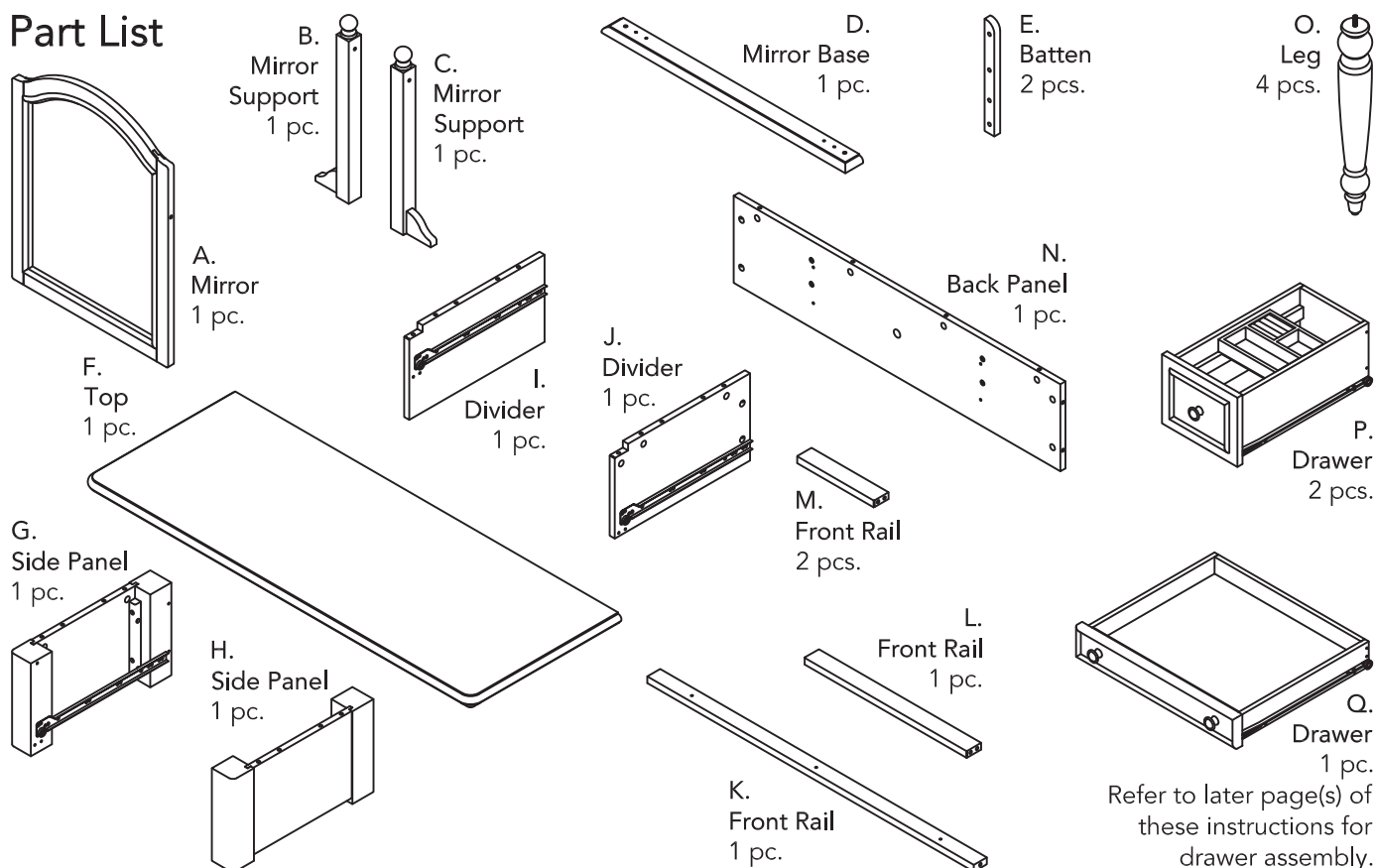

Hardware List

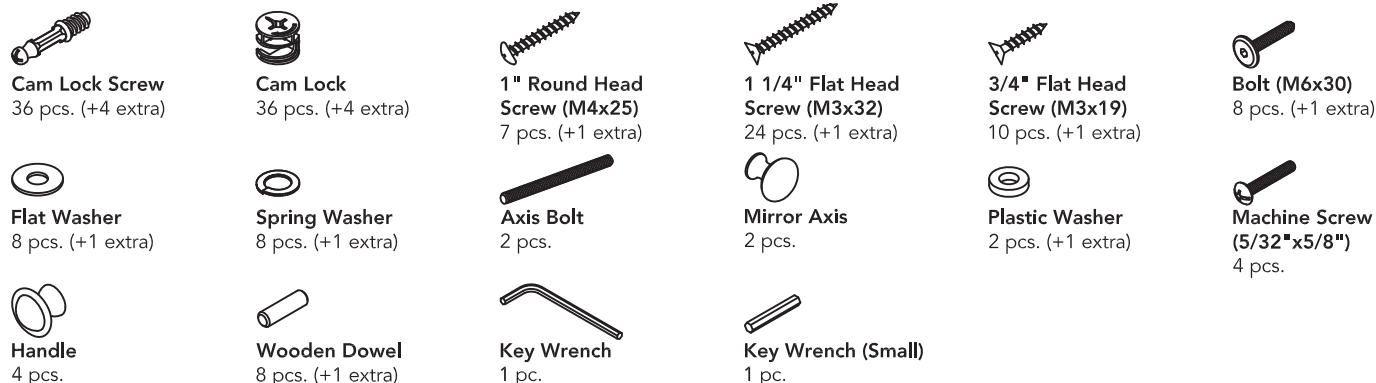

Tool(s) required for assembly: Phillips screwdriver, Level, Pencil, Drill (8 volts or less), 3/8" Drill Bit

Home Styles Customer Service: www.homestyles-furniture.com,
servicedesk@homestyles-furniture.com, 888-680-7460, 877-831-0319

Assembly Instructions 2/11

IMPORTANT

- Use a soft cloth between these parts and the floor.
- Do not use power tools above 8 volts to assemble.
- Do not tighten all the screws until each part is properly assembled.
- The unit must be level to work properly. Use the included adjustable levelers to level.
- Keep Key Wrench in a safe place as the Bolts may need to be tightened up in the future.

STEP 1

Insert Cam Lock Screws into pre-drilled holes of Top (F), Side Panels (G), (H), Dividers (I), (J), Front Rail (K) and Back Panel (N), then tighten.

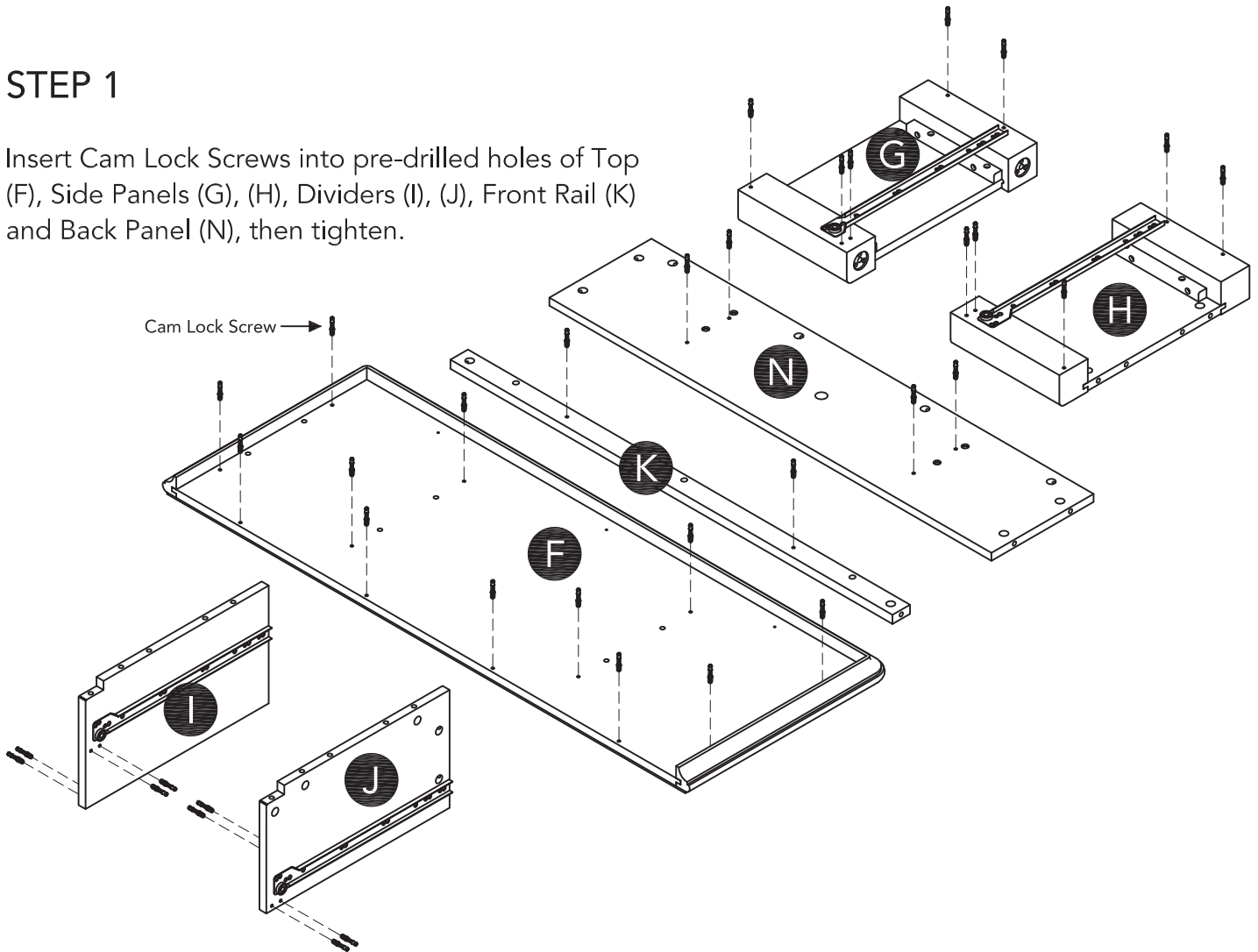

STEP 2

Attach Front Rails (L) and (M) to Dividers (I) and (J) with Cam Locks.
(See Figure 1)

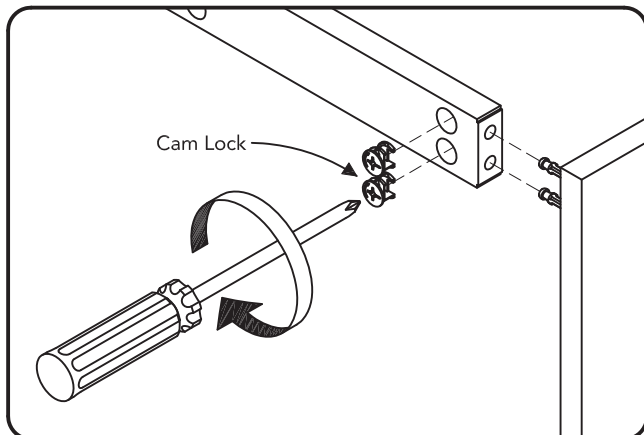
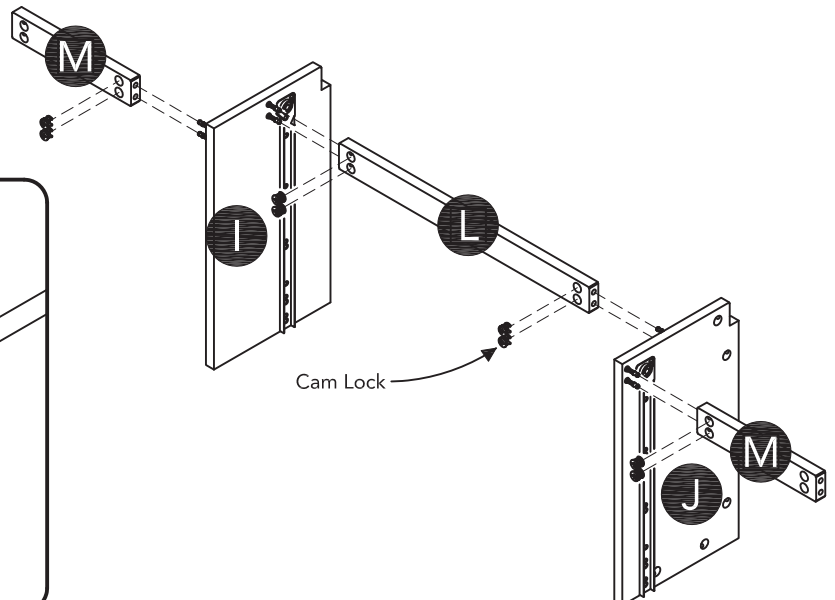

Figure 1



STEP 3

Attach Front Rail (K) and Back Panel (N) to unit with Cam Locks.
(See Figure 2)

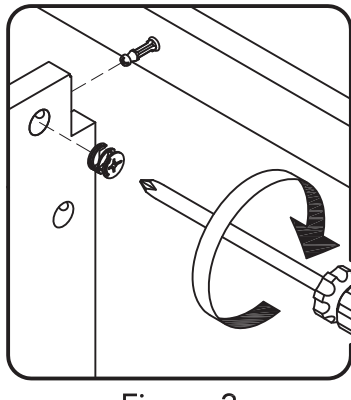
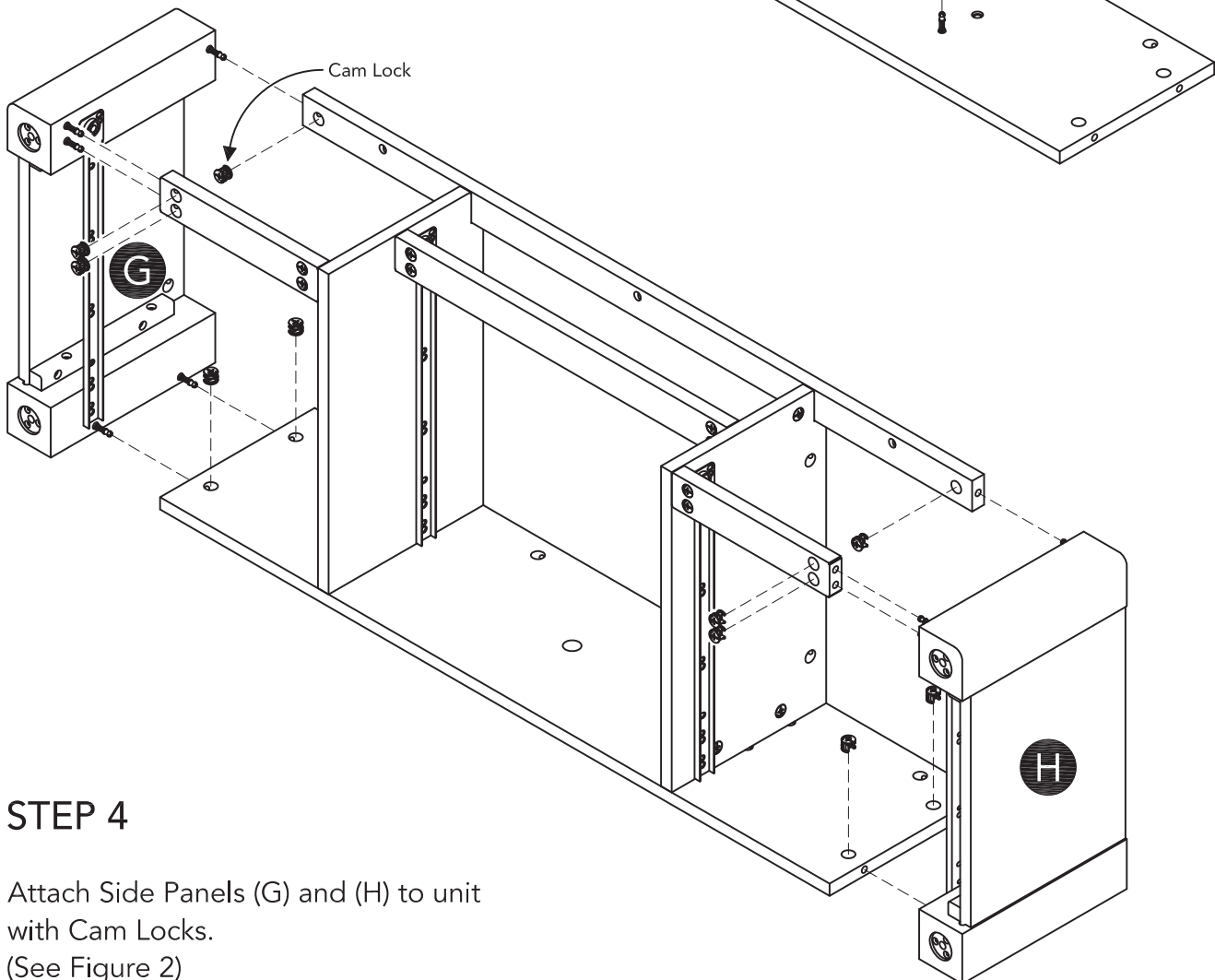
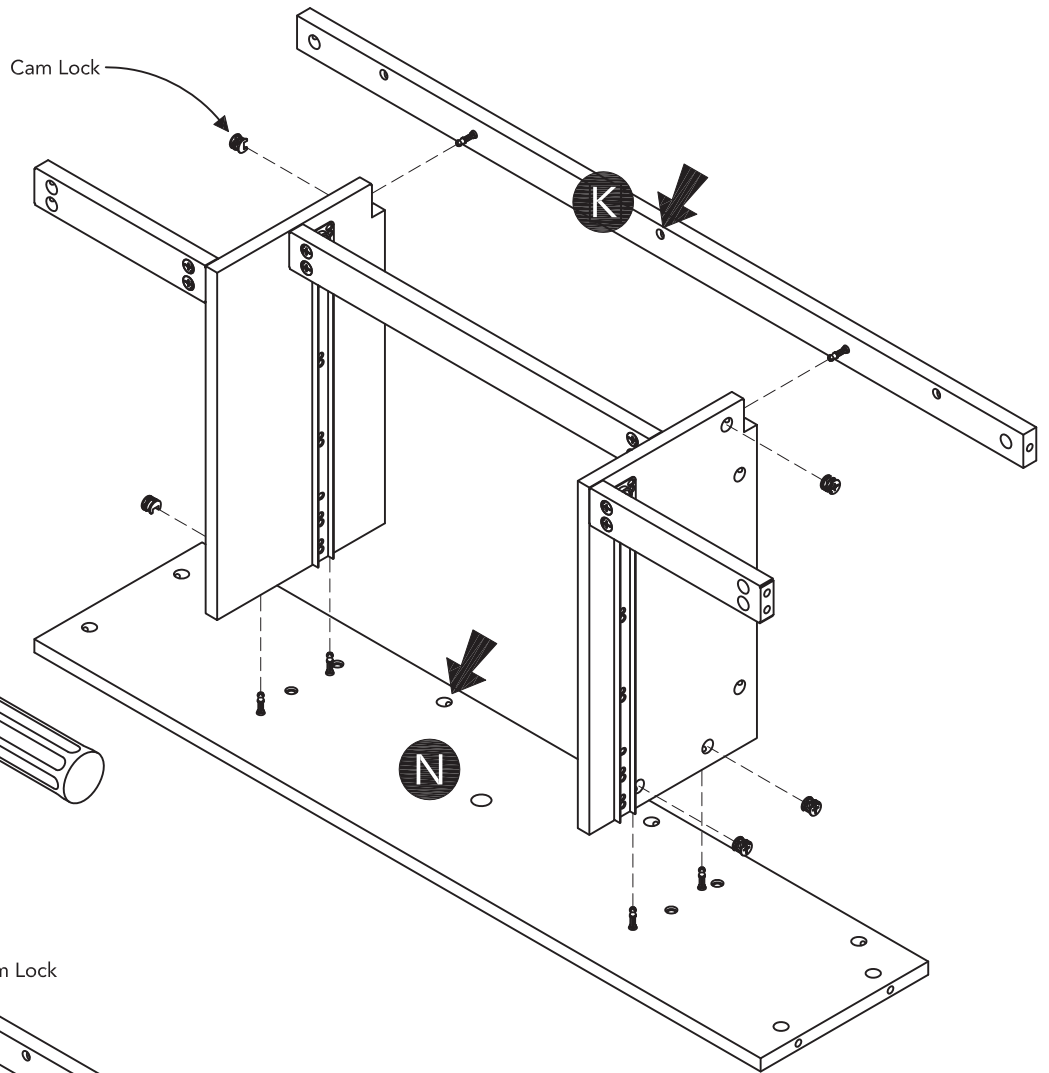

Figure 2



STEP 4

Attach Side Panels (G) and (H) to unit with Cam Locks.
(See Figure 2)

Assembly Instructions 4/11

STEP 5

Attach Top (F) to unit with Cam Locks, 1" Round Head Screws and Wooden Dowels.

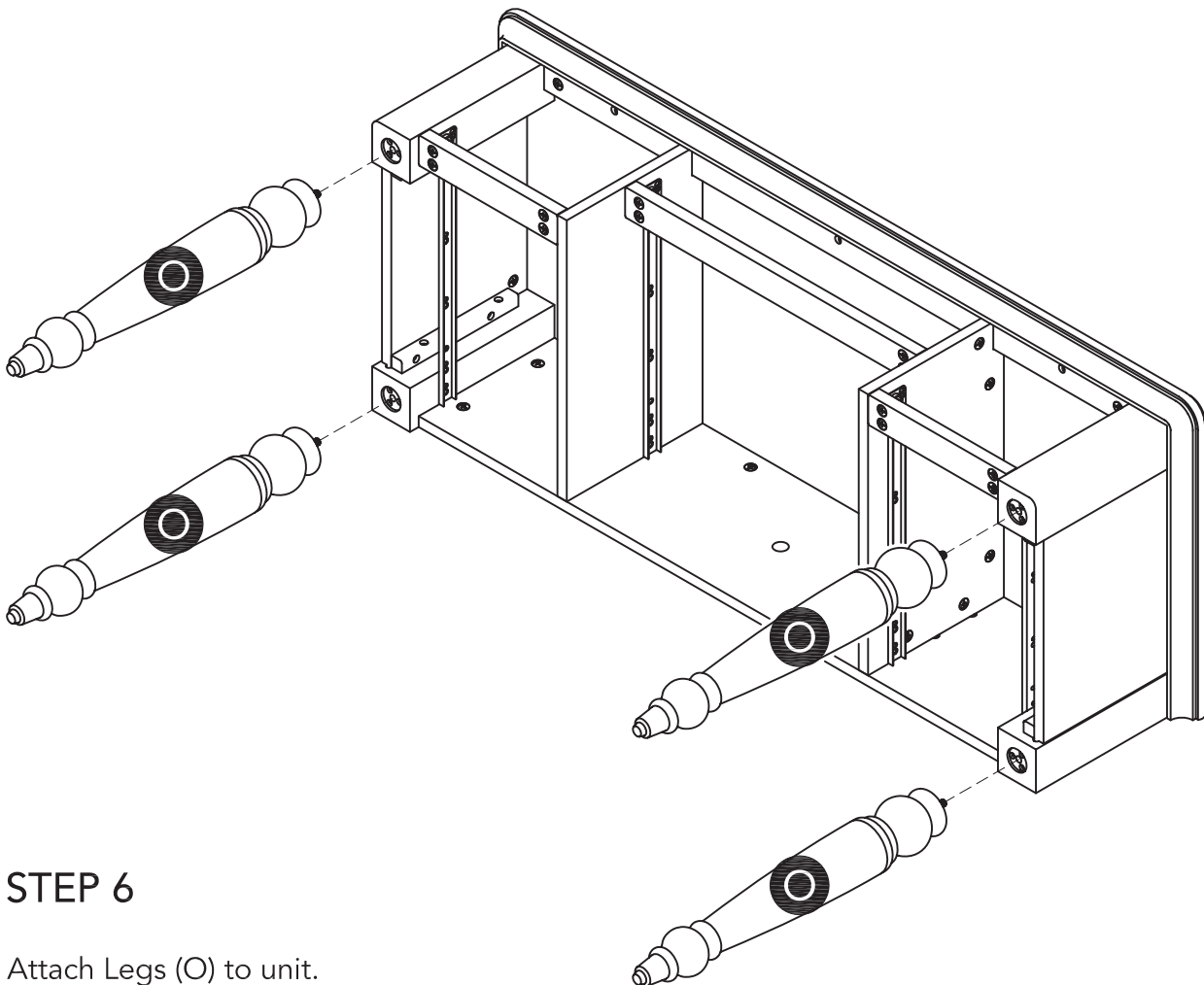
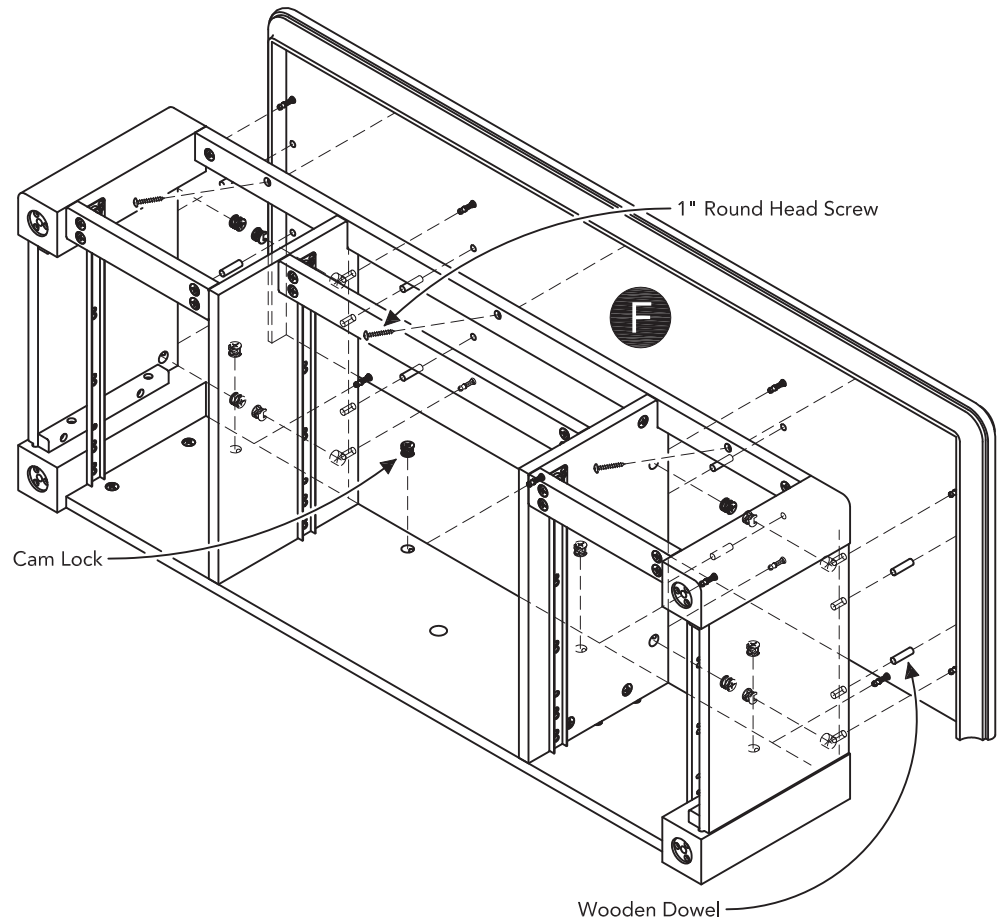

STEP 6

Attach Legs (O) to unit.

STEP 7

Attach Mirror Supports (B) and (C) to Mirror Base (D) with 1" Round Head Screws.

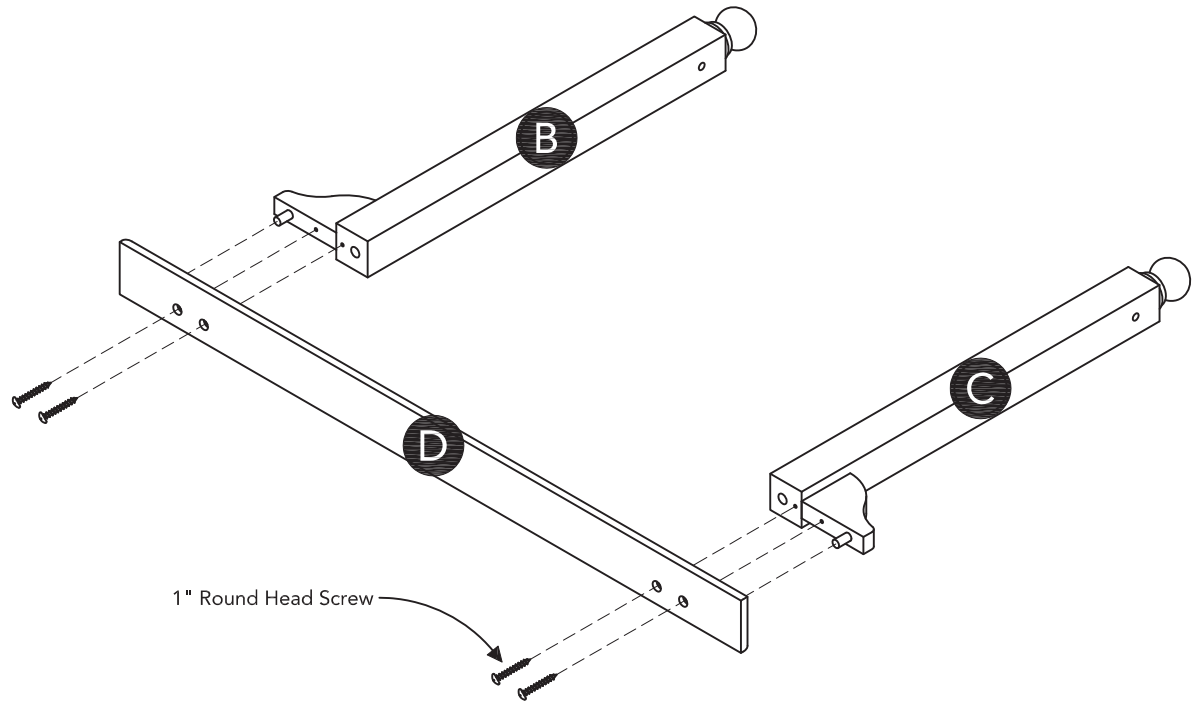

STEP 8

Attach Mirror (A) to unit using
Axis Bolts, Mirror Axes and
Plastic Washers.
(See Figure 3)

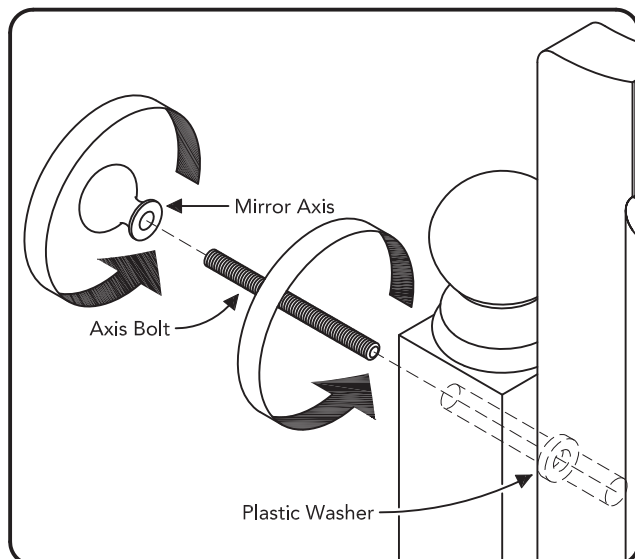
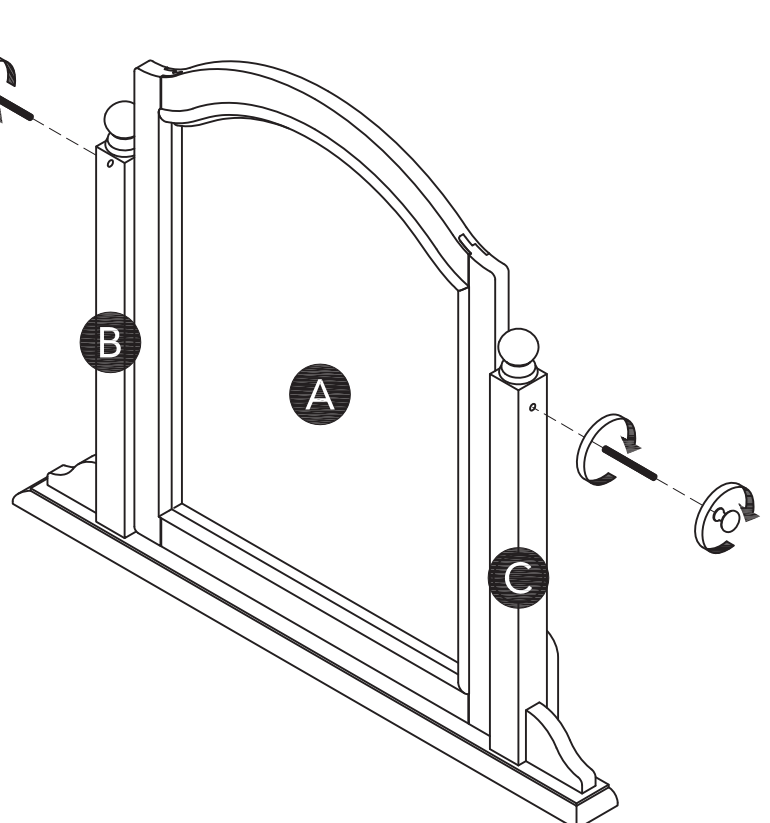

Figure 3



STEP 9

Attach Battens (E) to unit from Step 6 and unit from Step 8 with Bolts, Spring Washers and Flat Washers.

Tighten Bolts using Key Wrench. (See Figure 4)

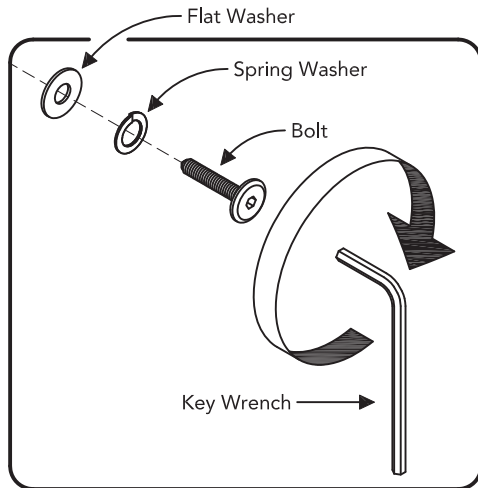
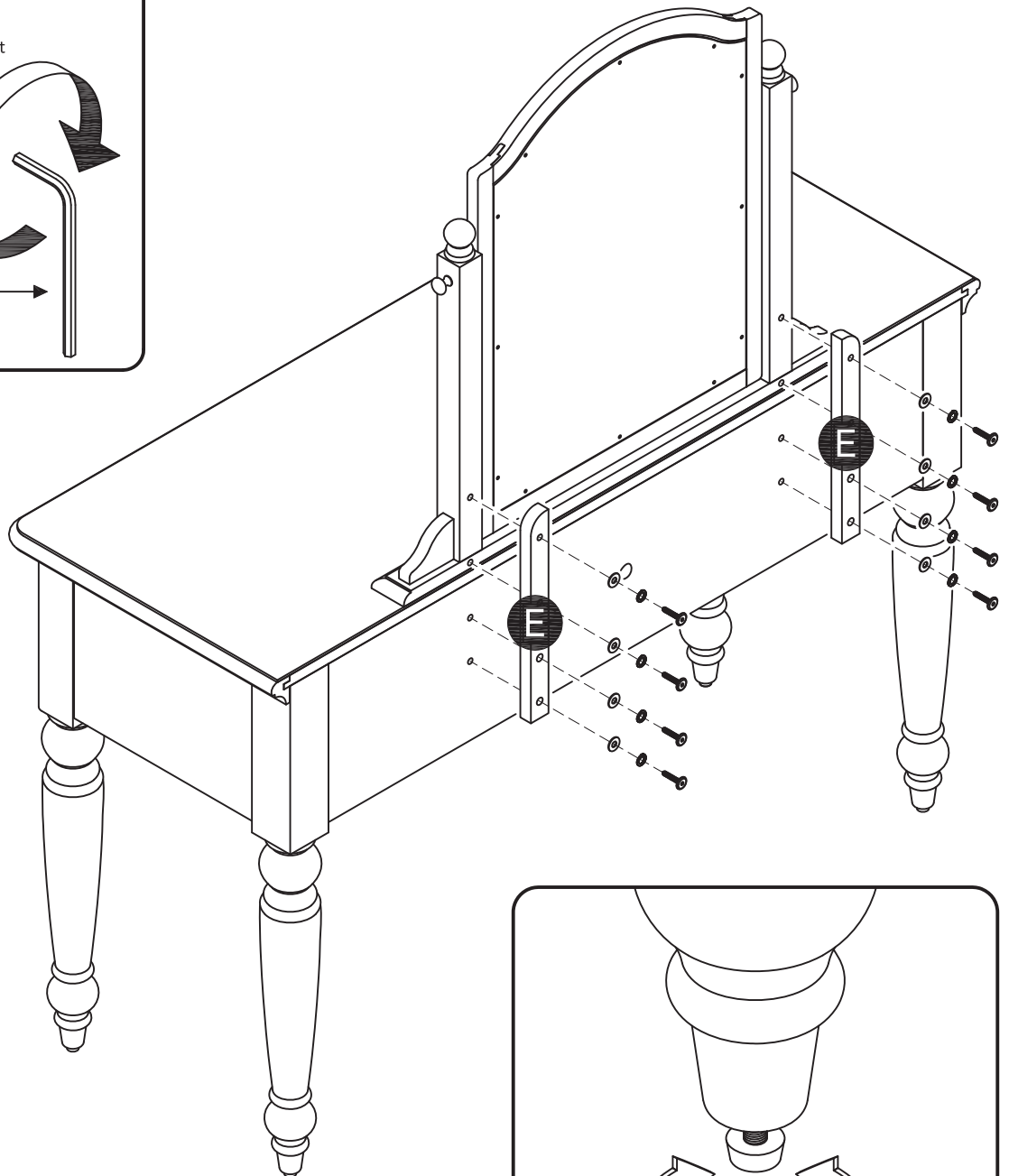

Figure 4



STEP 10

Level unit by adjusting the adjustable levelers on bottom of legs. (See Figure 5)

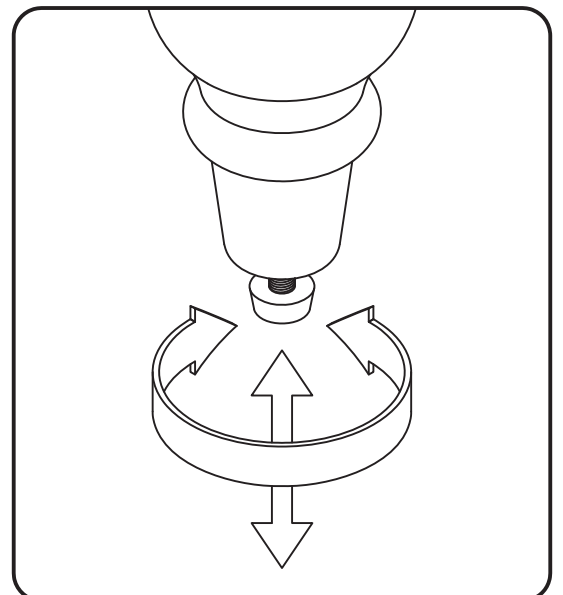

Figure 5

Assembly Instructions 7/11

IMPORTANT

- To help reduce the risk of the unit tipping over, the Tip-over Restraint must be installed following these instructions exactly.

STEP 11

Place the unit at desired location.

Mark wall with pencil to show position of hole in Back Panel (N). (See Figure 6)

Move unit.

Drill a 3/8" hole in wall 1" below mark.

Insert Anchor into the wall hole and attach Tip-over Restraint to Anchor with 1 1/2" Round Head Screw and Flat Washer. (See Figure 7)

Move unit back into place and insert Tip-over Restraint into unit through hole in Back Panel (N). (See Figure 8)

Attach Tip-over Restraint to unit with 1/2" Round Head Screw and Flat Washer. (See Figure 9)

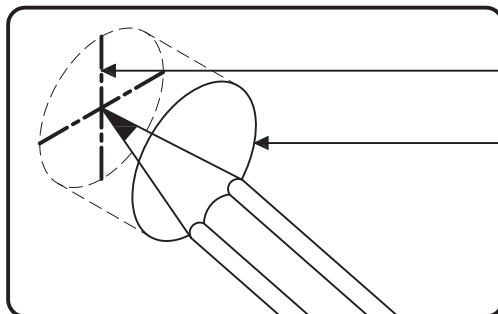
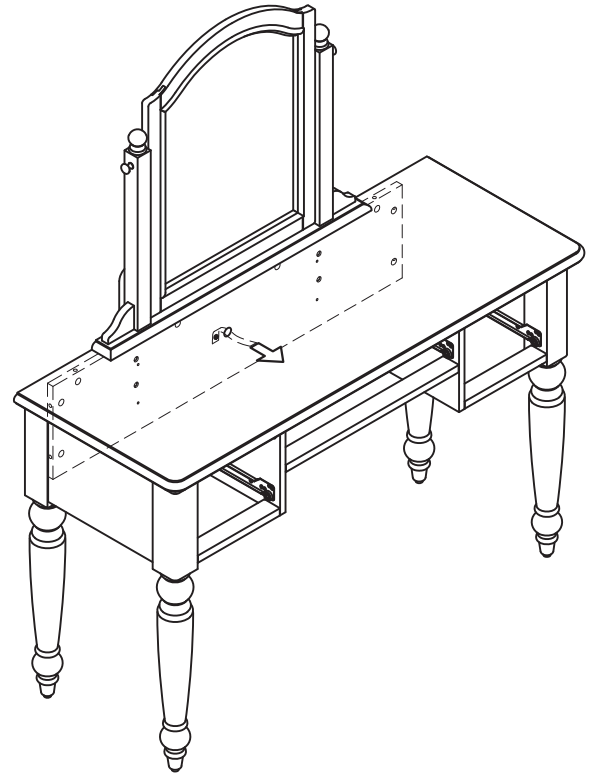

Figure 6

Pencil mark
Hole in Back Panel (N)

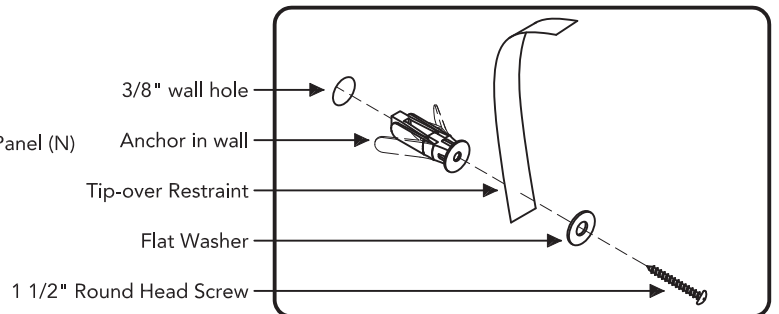

Figure 7

3/8" wall hole
Anchor in wall
Tip-over Restraint
Flat Washer
1 1/2" Round Head Screw

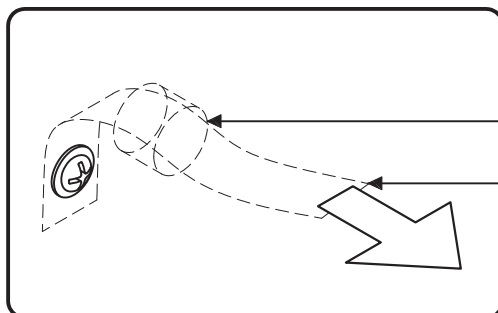

Figure 8

Hole in Back Panel (N)
Tip-over Restraint

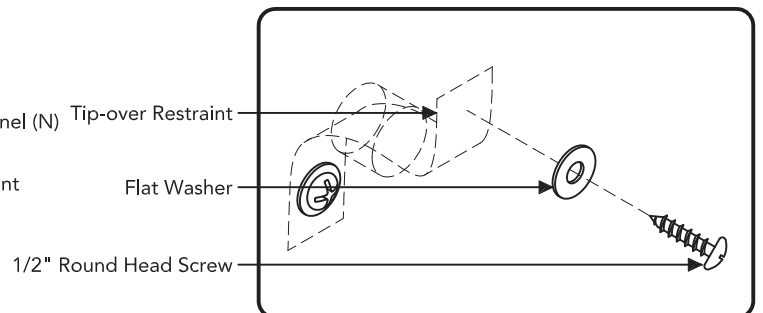

Figure 9

Tip-over Restraint
Flat Washer
1/2" Round Head Screw

Hardware List



Tip-over Restraint
1 pc.



Anchor
1 pc. (+1 extra)



1 1/2" Round Head Screw
(M3x38)
1 pc.



1/2" Round Head Screw
(M3x13)
1 pc. (+1 extra)



Flat Washer
2 pcs. (+1 extra)

Drawer (P)

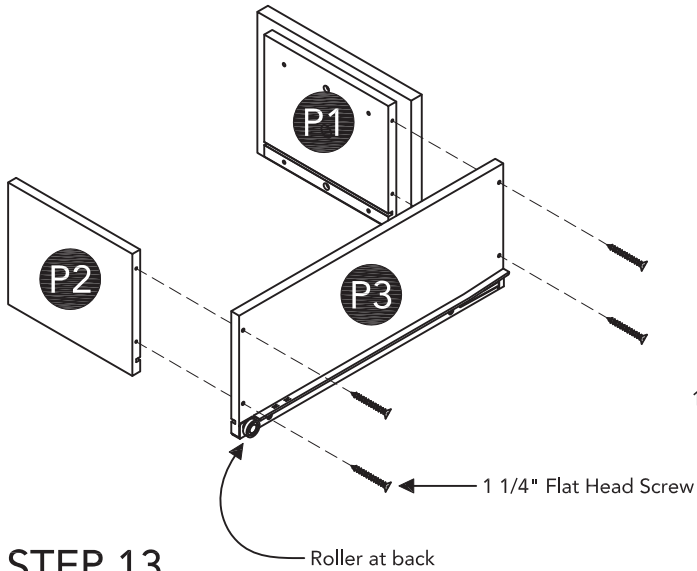

STEP 13

Insert Drawer Bottom (P5) into the groove.

Attach Drawer Side (P4) to unit with 1 1/4" Flat Head Screws.

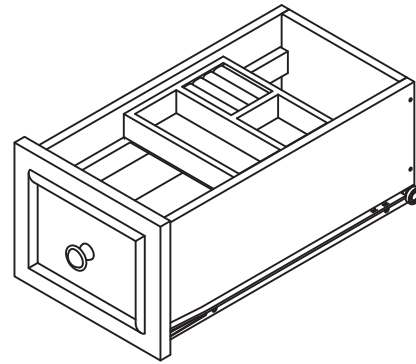

STEP 12

Attach Drawer Side (P3) to Drawer Front (P1) and Drawer Back (P2) with 1 1/4" Flat Head Screws.

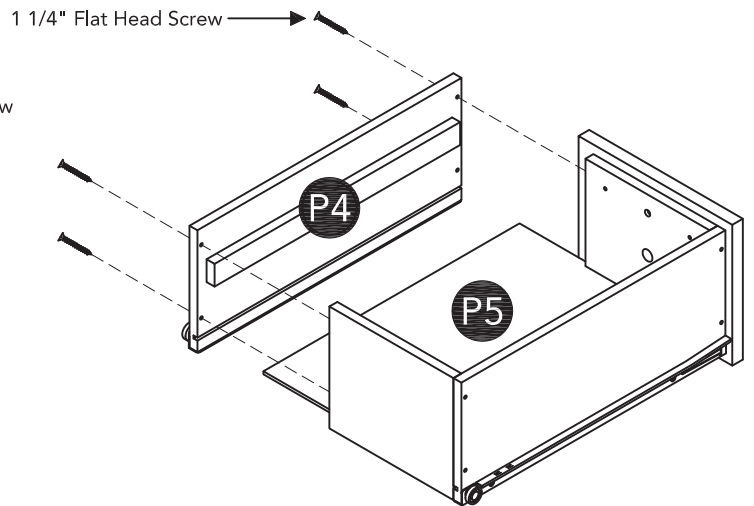

STEP 14

Attach Handle with Machine Screws.

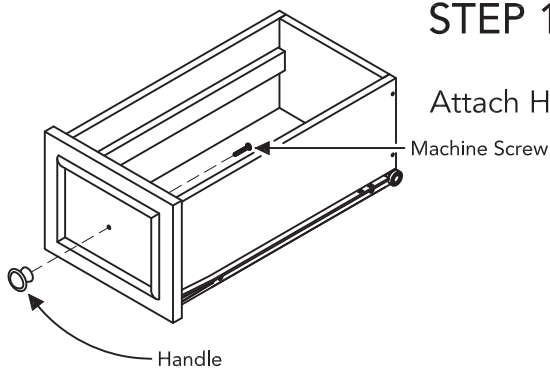

STEP 15

Place Jewel Box (P6) into position.

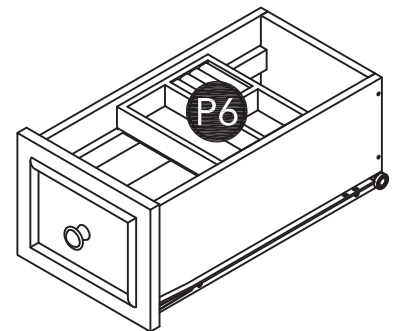

Note: Drawer assembly is not complete until 3/4" Flat Head Screws are used in a later step.

Part List

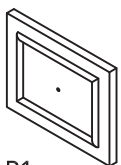

P1.
Drawer Front
2 pcs.

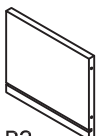

P2.
Drawer Back
2 pcs.

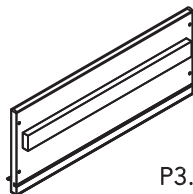

P3.
Drawer Side
2 pcs.

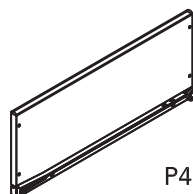

P4.
Drawer Side
2 pcs.

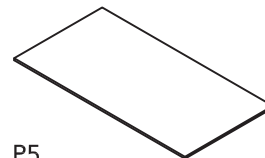

P5.
Drawer Bottom
2 pcs.

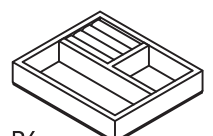

P6.
Jewel Box
2 pcs.

Drawer (Q)

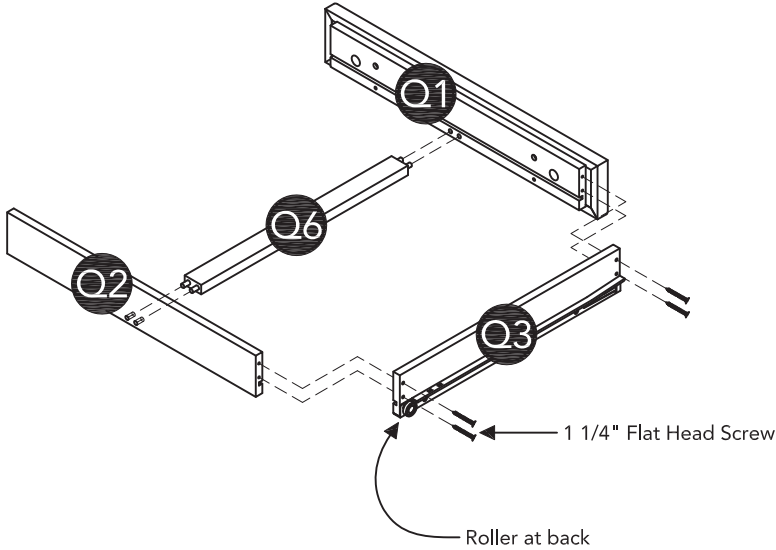

STEP 16

Attach Support (Q6) to Drawer Front (Q1) and Drawer Back (Q2).

Attach Drawer Side (Q3) to Drawer Front (Q1) and Drawer Back (Q2) with 1 1/4" Flat Head Screws.

STEP 17

Insert Drawer Bottom (Q5) into the groove.

Attach Drawer Side (Q4) to unit with 1 1/4" Flat Head Screws.

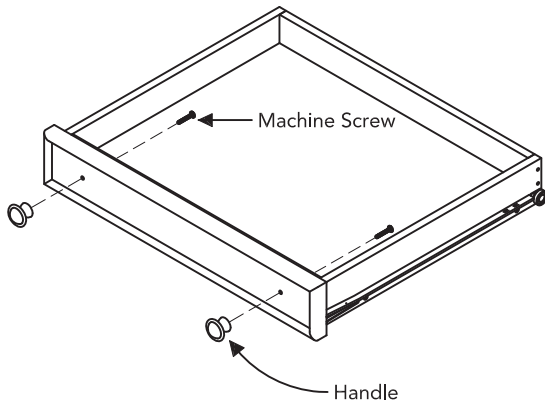
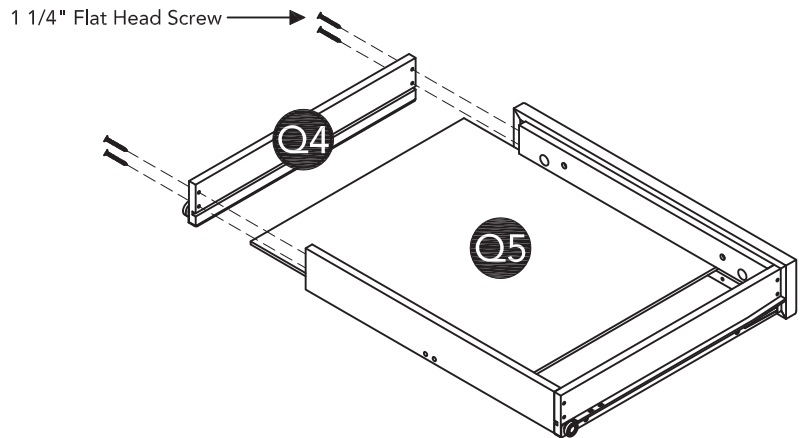

STEP 18

Attach Handles with Machine Screws.

Note: Drawer assembly is not complete until 3/4" Flat Head Screws are used in a later step.

Part List

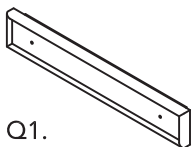

Q1.
Drawer Front
1 pc.

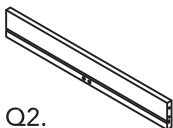

Q2.
Drawer Back
1 pc.

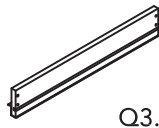

Q3.
Drawer Side
1 pc.



Q4.
Drawer Side
1 pc.

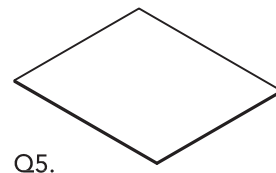

Q5.
Drawer Bottom
1 pc.



Q6.
Support
1 pc.

STEP 19

For Drawer (P) uninstall the lower center screw and loosen slightly the upper center screw.

For Drawer (Q) loosen slightly the two screws pre-installed on back of drawer front.

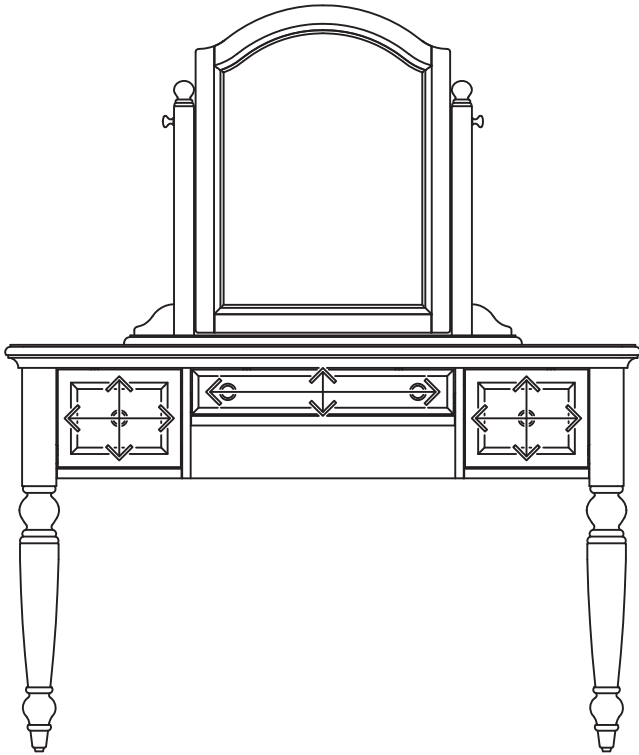
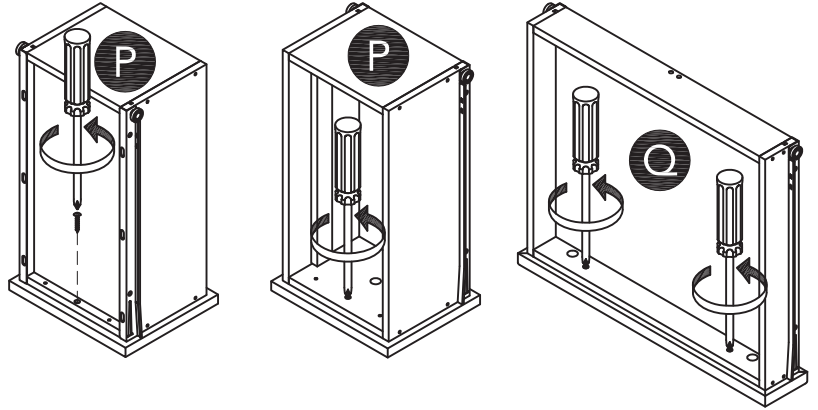

STEP 20

Insert drawers into unit, then adjust drawer front panels left or right and up or down until drawer gaps look proportional.

STEP 21

Pull each drawer open slowly and re-tighten screws from Step 19. Make sure drawer front panels do not move and lock drawer front panels into position with 3/4" Flat Head Screws.

Note: These 3/4" Flat Head Screws must be installed to complete the drawer assembly.

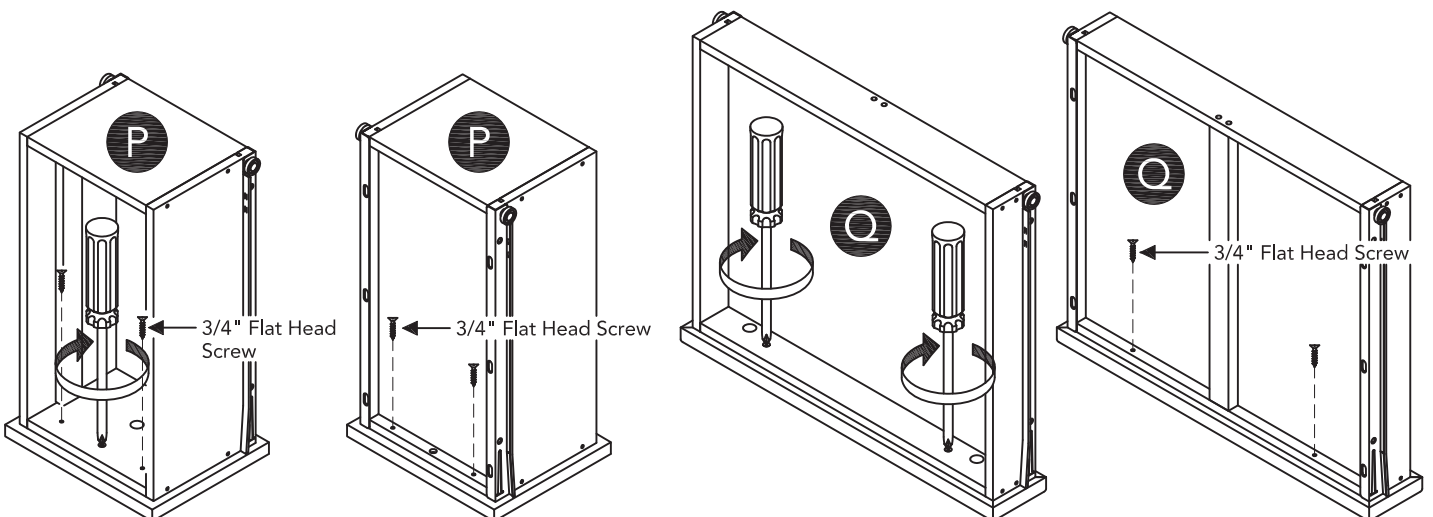

STEP 22

Slide Drawers (P) and (Q) into position.

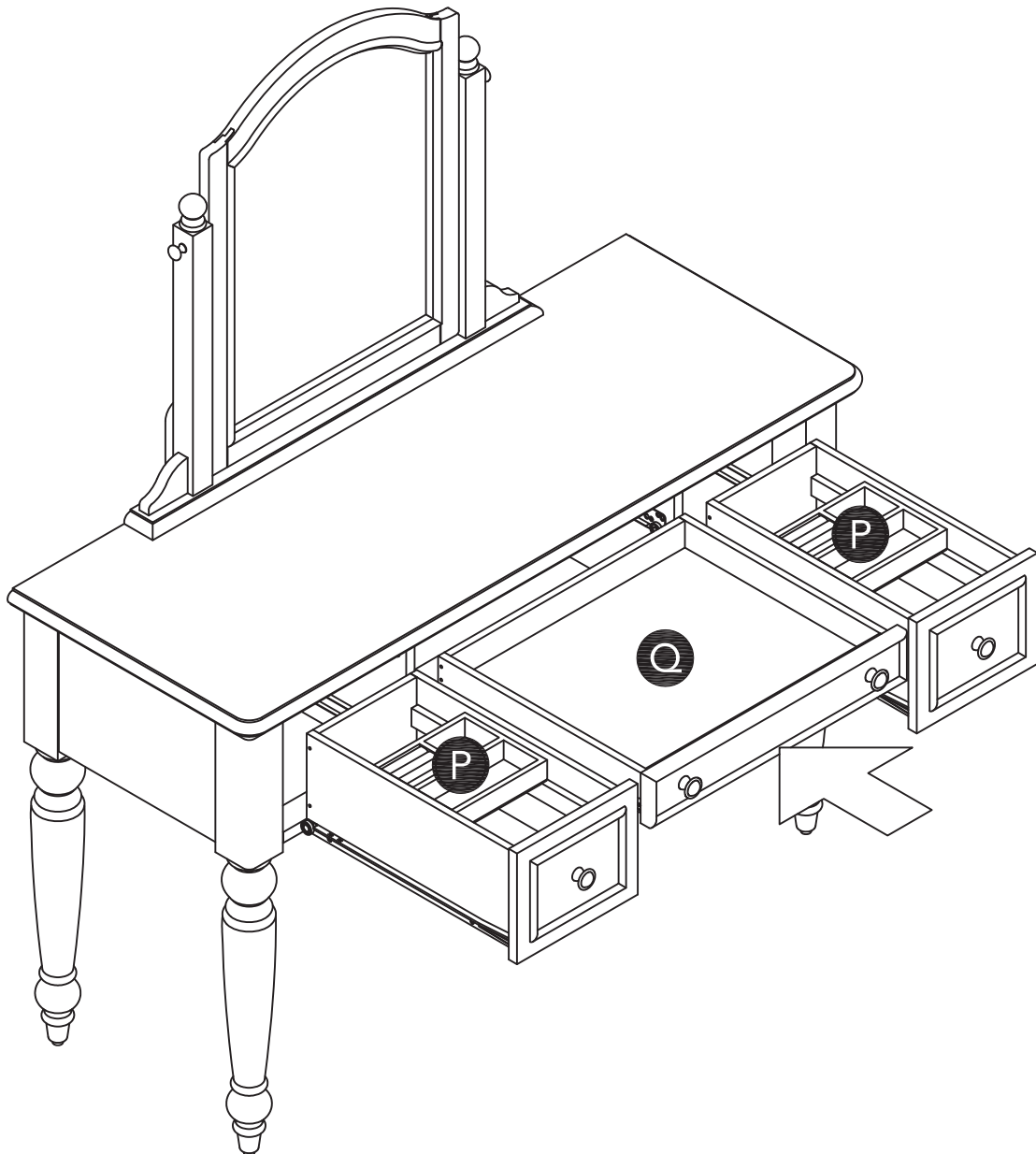

CARE INSTRUCTIONS

NEVER

allow liquids to remain on furniture.
Absorption causes parts to warp
and split and finishes to delaminate.

NEVER

use glass cleaners on
finished furniture. Ammonia
chemically attacks the finish.



Do not use power tools
above 8 volts to assemble.

**PREVENT
CRACKING**



Do not place
in direct sunlight.

**PREVENT
FADING**



Do not write
directly on surface.

**PREVENT
MARKING**



Do not place hot
objects on surface.

**PREVENT
FINISH DAMAGE**



Do not use rubber
based placemats.

**PREVENT
DISCOLORING**



Do not use commercial
waxes and polishes.

**PREVENT
YELLOWING**

CLEAN

with a soft cloth moistened
in lukewarm soap and water.
Buff with a dry clean cloth.



Home Styles will provide replacements free of charge for missing or damaged hardware or parts within 30 days of purchase. Digital images of the defective parts may be required. If the product was not purchased from an authorized retail affiliate, Home Styles is under no obligation to provide replacement parts. Parts are not available for fully assembled items nor are parts available for sale. Replacements for missing or damaged hardware or parts may be requested at:

www.homestyles-furniture.com/customer-service/replacement-parts

Home Styles Customer Service: www.homestyles-furniture.com,
servicedesk@homestyles-furniture.com, 888-680-7460, 877-831-0319