



PILOT PRO MANUAL

Installation and Operating Instructions

NATURAL GAS - W255G, W355G, W505G, W255G-3, W355G-3, W505G-3, W255G-5, W355G-5, W505G-5, W255G-7, W355G-7, W505G-7

⚠ WARNING: If the information in these instructions is not followed exactly, a fire or explosion may result causing property damage, personal injury or loss of life.

- Do not store or use gasoline or other flammable vapors and liquids in the vicinity of this or any other appliance.
- **WHAT TO DO IF YOU SMELL GAS**
 - Do not try to light any appliance.
 - Do not touch any electrical switch; do not use any phone in your building.
 - Immediately call your gas supplier from a neighbor's phone. Follow the gas supplier's instructions.
 - If you cannot reach your gas supplier, call the fire department.
- Installation and service must be performed by a qualified installer, service agency or the gas supplier.

INSTALLER: Leave this manual with the appliance.
CONSUMER: Retain this manual for future reference.

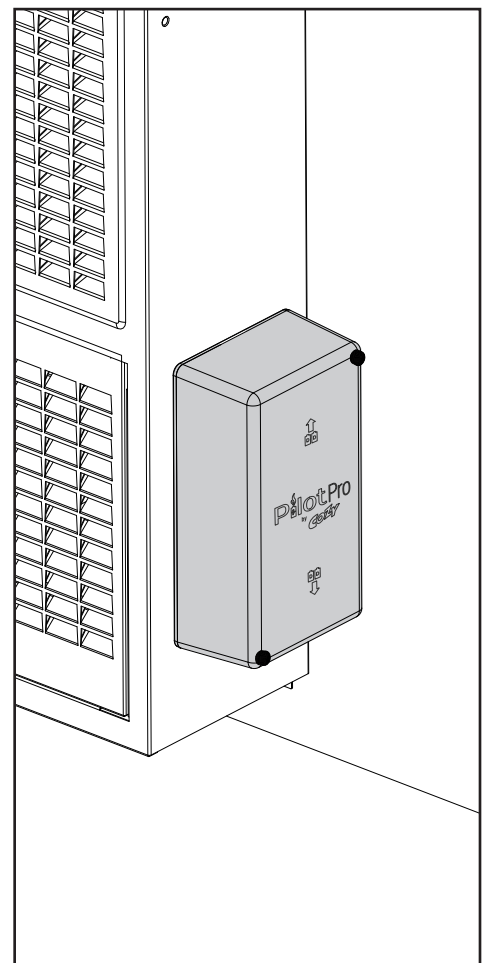

THE CONTENTS ON THIS MANUAL ARE IN STRICT ACCORDANCE WITH
ANSI STANDARD Z21.71 AND SHOULD BE FOLLOWED BY A PROFESSIONAL INSTALLER ONLY.

WARNING: Operation of any furnace without the properly installed, factory furnished vent system & vent cap could result in Carbon Monoxide (C.O.) poisoning and possible death. For your safety, this furnace & the vent system should be inspected at least annually by a qualified service technician.

CONTENTS

Before Installation

Standards	2
Part List	3-4

Installation

Installation Steps	5-17
Wiring / Electrical	18-25
Starting Pilot Pro	26-28

Lighting Instructions	29
------------------------------------	----

Troubleshooting	30
------------------------------	----

Burner Flame Adjustment	31
--------------------------------------	----

Notes	31
--------------------	----

Warranty	32
-----------------------	----

READ CAREFULLY BEFORE INSTALLING UNIT

These installation instructions are a general guide and do not supersede applicable local codes and ordinances. Before planning or making the installation be sure it complies with all phases of the local heating code. (Or, in the absence of local codes, with the latest edition of National Fuel Gas Code, ANSI.Z223.1, or CAN1-B149).

The appliance, when installed, must be electrically grounded in accordance with local codes, or in the absence of local codes, with the latest edition of National Electrical Code ANSI / NFPA 70, or Canadian Electrical Code CSA-C22.1.

All of the ANSI and NFPA standards referred to in these installation instructions are the ones that were applicable at the time the design of this appliance was created.

NFPA Standards:

NATIONAL FIRE PROTECTION ASSOCIATION

1 Batterymarch Park
Quincy, Massachusetts | USA 02169-7471

ANSI & Canadian Standards:

CSA GROUP

178 Rexdale Boulevard,
Toronto, Ontario | Canada M9W 1R3

Installer must leave these instructions with the consumer, have them complete, and return the warranty card.

The State of Massachusetts requires that installation and service of a gas appliance be performed by a plumber or gas fitter licensed in the Commonwealth of Massachusetts.



Tools Required for Assembly:

- Phillips - Head Screwdriver
- Needle Nose Pliers
- 3/16" Drill Bit
- Wire Cutters

PARTS LIST AND REFERENCE

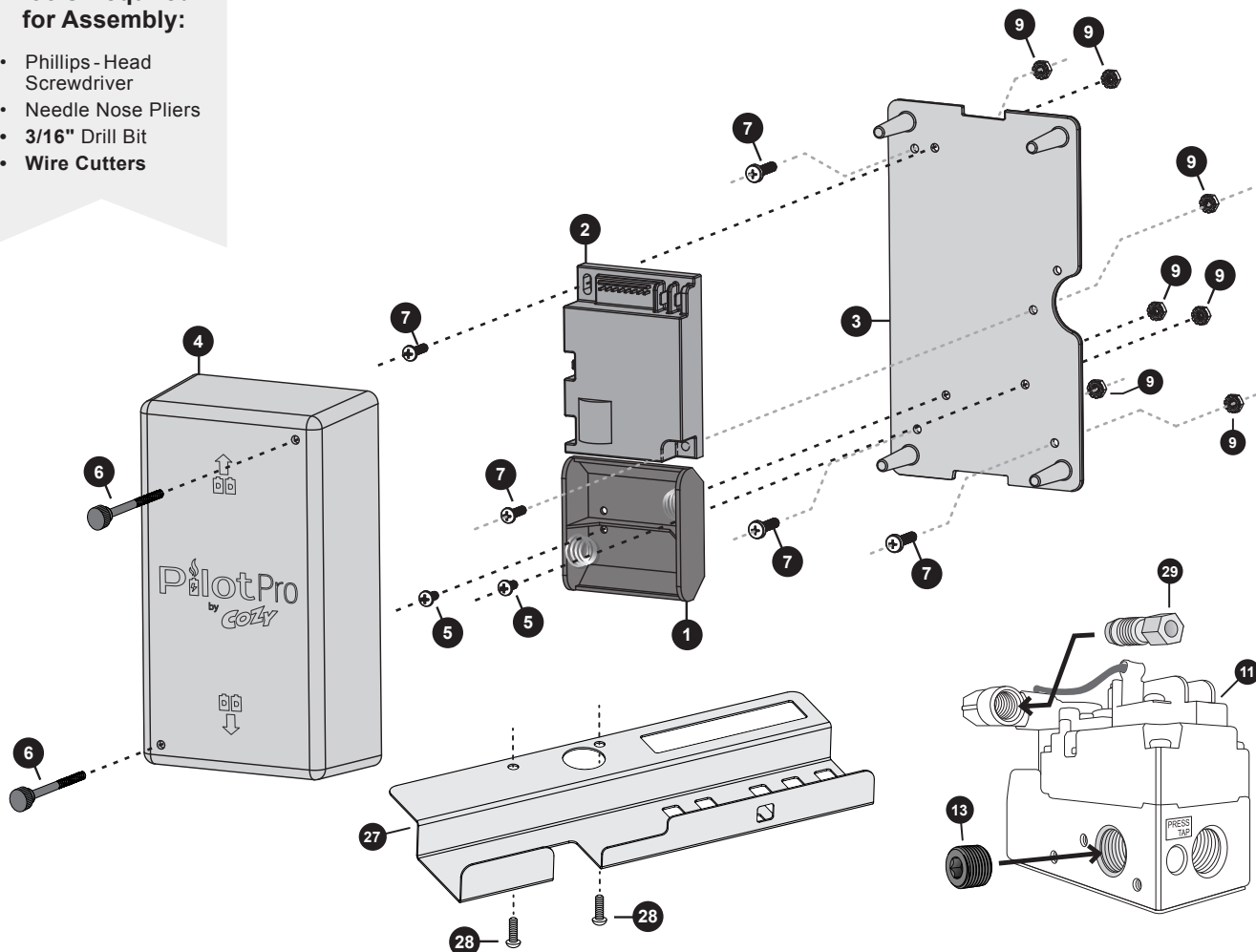

REF	PART NO.	DESCRIPTION	QTY	REF	PART NO.	DESCRIPTION	QTY
1	1018002	Battery Pack	1	17	50953	Nut, Wire Gray*	2
2	1018000	Control Module	1	18	1018045	Label, Ladder Schematic**	1
3	1018397	Mounting Plate	1	19	1018044	Label, Wiring Diagram**	1
4	1018398	Cover	1	20	1018171	Label, Modifications**	1
5	50139	Screw, #8 x 3/8"	2	21	1018055	Lighting Instructions*	1
6	1018690	Screw with Knob	2	22	1018416	1.5V D-Cell Battery	2
7	1018526	Screw, #8-32 x 3/4"	5	23	1018039	Pilot Pro Manual*	1
8	1018331	Screw, #4 x 1.5"	1	24	1018501	Electrical Sleeving*	2
9	50052	Nut, #8	7	25	B-6395	Tie, Cable 7in*	4
10	1018330	Nut, #4	1	26	1018351	Nut, Flame Sensor	1
11	1018036	IID Valve, Natural	1	27	1018541	Bracket, Valve	1
12	1018001	IID Wiring Harness	1	28	50187	Screw, #10-24 x 3/8"	2
13	1018037	Outlet Plug	1	29	84084	Compression Nut, Large	1
14	1018634	Ignitor, Pilot	1	30	80037	Compression Nut, Small	1
15	1018350	Flame Sensor	1	31	1018543	Pilot Tube	1
16	1018302	Wire, Flame Sensor	1				

* Not shown ** See page 19



PARTS LIST AND REFERENCE

Do not return product if you are missing parts. Please Call: (855) 589-5380

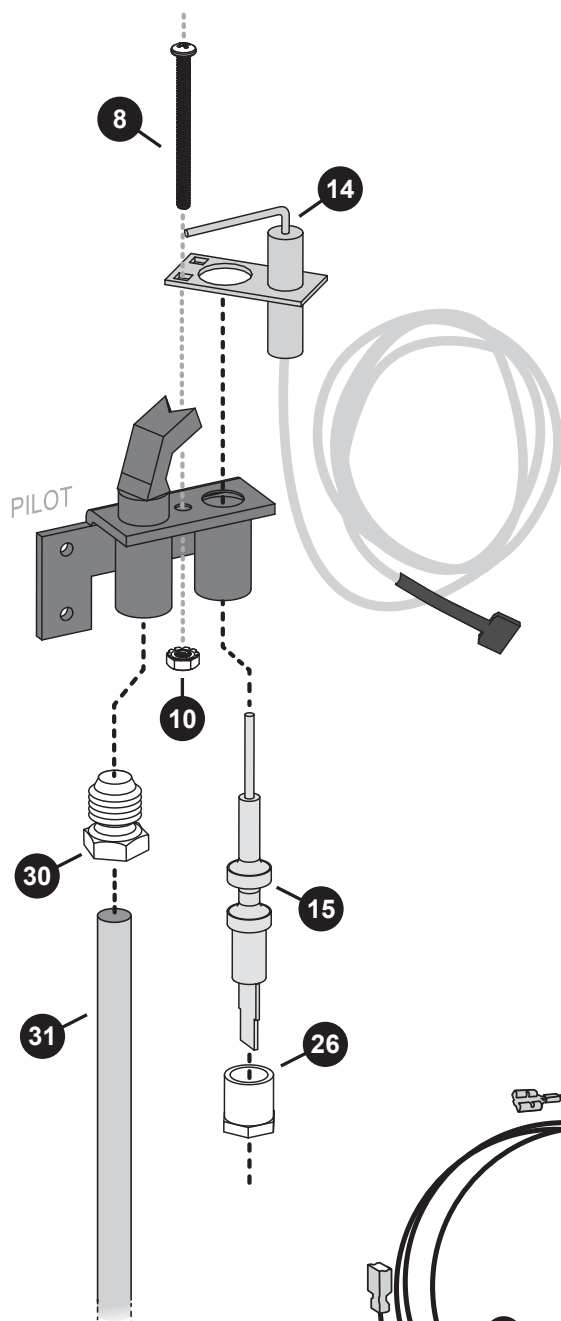

Illustrations in this section are to scale for faster identification of hardware during assembly:

- | | | |
|----|------------------------------------------------------|--|
| 5 | Screw, Phillips Head, #8 8-32 x 3/8" (x2)
50139 | |
| 6 | Screw with Knob (x2) 1018690 | |
| 7 | Screw, Phillips Head, #8 32 x 3/4" (x5)
1018526 | |
| 8 | Screw, Phillips Head, #4 4-40 x 1.5" (x1)
1018331 | |
| 28 | Screw, Phillips Head, #10 24 x 3/8" (x2)
50187 | |
| 9 | External-Tooth Lock Nut #8 (x7)
50052 | |
| 10 | External-Tooth Lock Nut #4 (x1)
1018330 | |

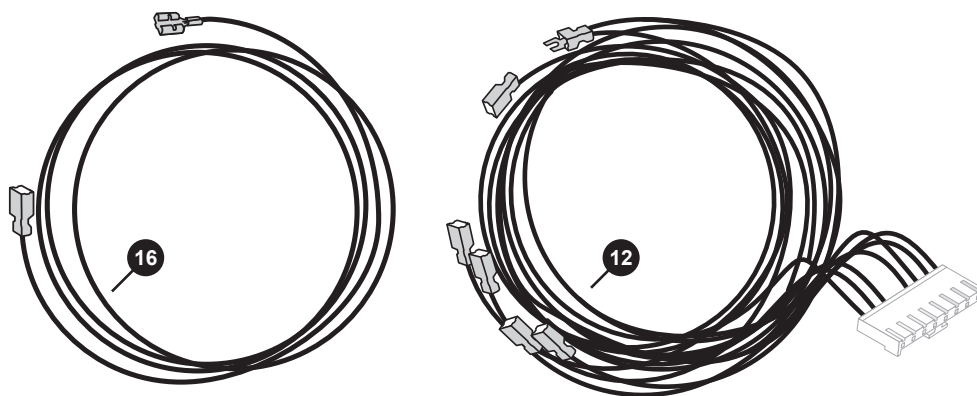

HOW TO PROPERLY ORDER PARTS:

In addition to the part description and numbers, please be prepared to provide: Model number, serial number & type of gas used.
This information can be found on the rating plate that is attached to the heater.

NOTE: Parts & schematic drawings on current models are shown at: cozyheaters.com | Specifications subject to change without notice.



PILOT PRO INSTALLATION INSTRUCTIONS

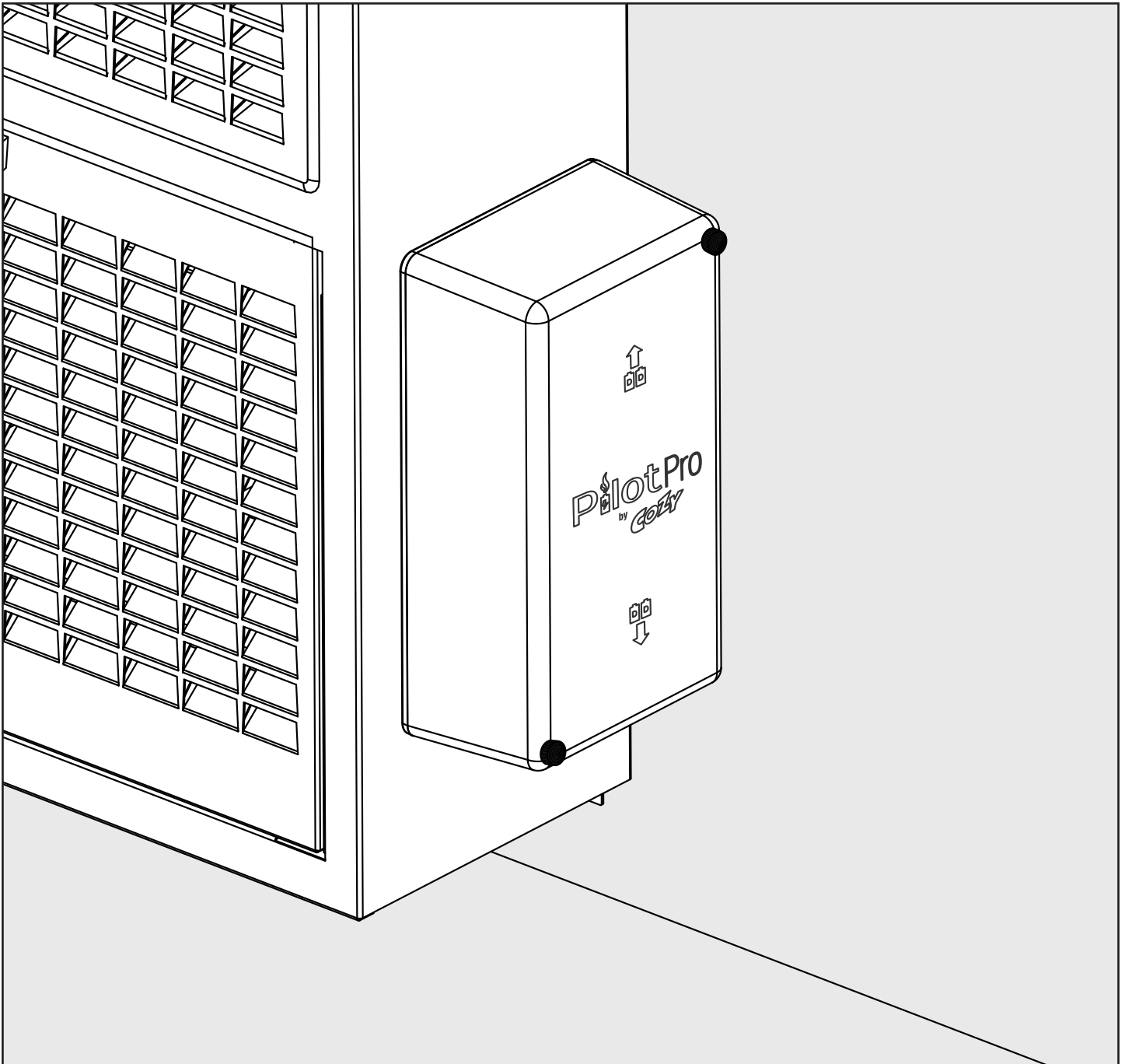

INSTALLATION

Step 1

SAFETY INSPECTION PROCEDURE PER ANSI Z21.71

EXHIBIT A: Recommended procedure for safety inspection of an existing appliance installation as a preliminary step to applying an automatic intermittent pilot system.

The following procedure is intended as a guide to aid in determining that an appliance is properly installed and is in a safe condition for continuing use.

This procedure is predicated on central furnace and boiler installations equipped with an atmospheric gas burner(s) and not of the direct vent type. It should be recognized that generalized test procedures cannot anticipate all situations. Accordingly, in some cases, deviation from this procedure may be necessary to determine safe operation of the equipment.

- A. This procedure should be performed prior to any attempt at modification of the appliance or the installation.
- B. If it is determined there is a condition which could result in unsafe operation, the appliance should be shut off and the owner advised of the unsafe condition. The following steps should be followed in making the safety inspection:
 1. Conduct a gas leakage test of the appliance piping and control system downstream of the shutoff valve in the supply line to the appliance.
 2. Visually inspect the venting system for proper size and horizontal pitch and determine there is no blockage or restrictions, leakage or corrosion or other deficiencies which could cause an unsafe condition.
 3. Shut off all gas to the appliance and shut off any other fuel-burning appliance within the same room. Use the shutoff valve in the supply line to each appliance. If a manual gas valve is not in the gas supply line within 6 feet (1.83 mm) of the appliance in an accessible location one shall be installed.
 4. Inspect burners and crossovers for blockage & corrosion.
 5. Applicable only to warm air heating appliances. Inspect heat exchangers for cracks, openings or excessive corrosion.
 6. Applicable only to boilers. Inspect for evidence of water or combustion product leaks.
 7. Insofar as is practical, close all building doors and windows and all doors between the space in which the appliance is located and other spaces of the building. Turn on clothes dryers. Turn on any exhaust fans, such as range hoods and bathroom exhausts, so they will operate at maximum speed. Do not operate a summer exhaust fan. Close fireplace dampers. If after completing Steps 7 through 12, it is believed sufficient combustion air is not available, refer to 1.3.4 of the National Fuel Gas Code (Z223.1) for guidance.
 8. Place in operation the appliance being inspected. Follow the lighting instructions. Adjust thermostat so appliance will operate continuously.
 9. (a) Determine that the pilot is burning properly and that main burner ignition is satisfactory by interrupting and reestablishing the electrical supply to the appliance in any convenient manner.
(b) Determine manifold pressure in order to match input after the new control is installed.
 10. (a) Visually determine that main burner gas is burning properly: i.e. , no floating , lifting or flashback. Adjust the primary air shutter(s) as required.
(b) If appliance is equipped with high and low flame control or flame modulation, check for proper main burner operation at low flame.
 11. Test for spillage at the draft hood relief opening after 5 minutes of main burner operation. Use a draft gage, the flame of a match or candle, or smoke from a cigarette, cigar or pipe.
 12. Return doors, windows, exhaust fans, fireplace dampers and all other fuel-burning appliances to their previous conditions of use.
 13. Applicable only to warm air heating appliances. Check both limit control and fan control for proper operation.

Limit control operation can be checked by temporarily disconnecting the electrical supply to the blower motor and determining that the limit control acts to shut off the main burner gas.

INSTALLATION

Step 2

SAFETY INSPECTION PROCEDURE PER ANSI Z21.71; EXHIBIT B: Procedure for installing automatic intermittent pilot systems.

PRIOR TO BEGINNING THIS PROCEDURE, a preliminary examination of the appliance and the automatic intermittent pilot system should be made to determine that the automatic intermittent pilot system can be properly applied to the appliance.

This procedure is intended as a guide to aid in safely installing a listed automatic intermittent pilot system on an existing listed appliance equipped with an atmospheric gas burner(s) & not of the direct vent type.

This procedure is based on the assumption that the history of the specific installation has been one of safe and satisfactory operation.

This procedure is predicated on central furnace and boiler installations, and it should be recognized that generalized procedures cannot anticipate all situations. Accordingly, in some cases deviation from this procedure may be necessary to determine safe operation of the equipment.

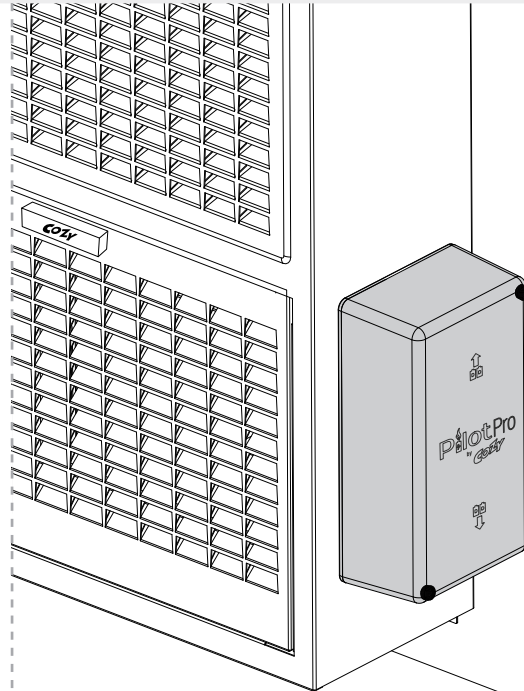

Step 3

- The input rating of the system must be equal to or greater than the name plate input rating of the appliance.
- The existing pilot burner shall be used or if it must be replaced, it shall be replaced with an identical model located in the same mounting as the original pilot.
- If electronic components are installed in an area subject to water then means shall be provided to protect components.

The following steps should be followed in making the modifications:

- 1. Perform a safety inspection of the existing appliance installation.**

See Exhibit A (pg 6) for a recommended procedure for such a safety inspection.

- 2. Shut off all gas and electricity to the appliance.**

To shut off gas use the shutoff valve in the supply line to the appliance. If a manual gas valve is not in the gas supply line within 6 feet (1.83 mm) of the appliance in an accessible location one shall be installed. Do not use the shutoff valve which is provided as part of a combination control.

INSTALLATION

Step 4

The Pilot Pro may be installed near the base of either side of the heater housing. Choose which side to mount the Pilot Pro.

Be sure to leave enough room to remove the pilot pro cover for maintenance access.

For easy removal of the cover, allow at least 10" of space from the heater housing.

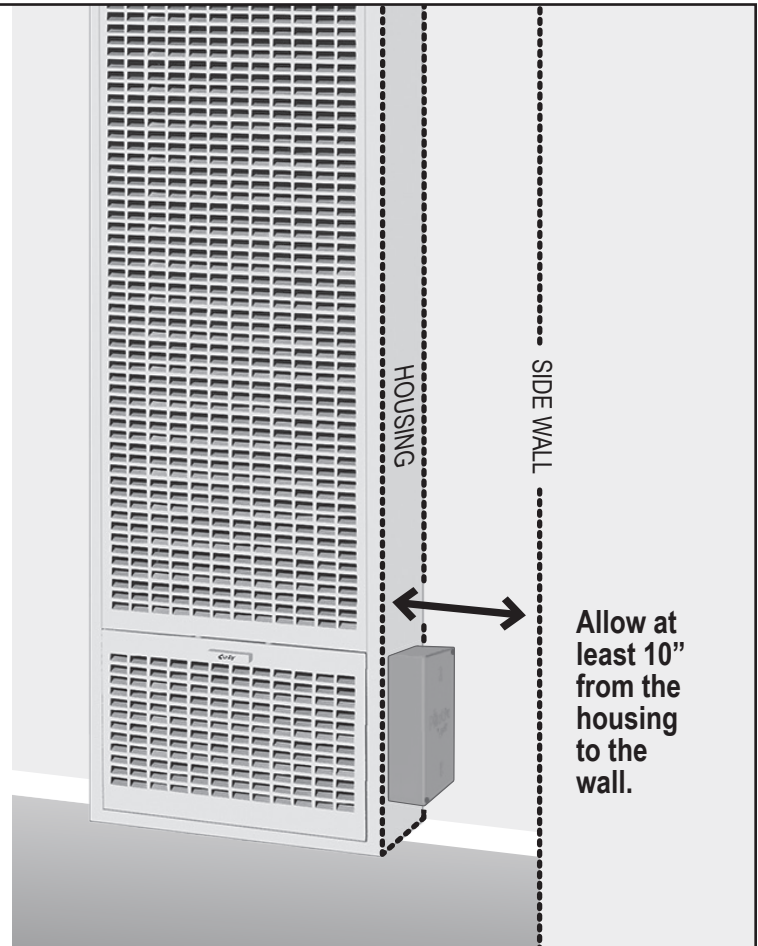

Step 5

Remove the heater housing and lay it on the ground. Also, temporarily remove and set aside the service access door.

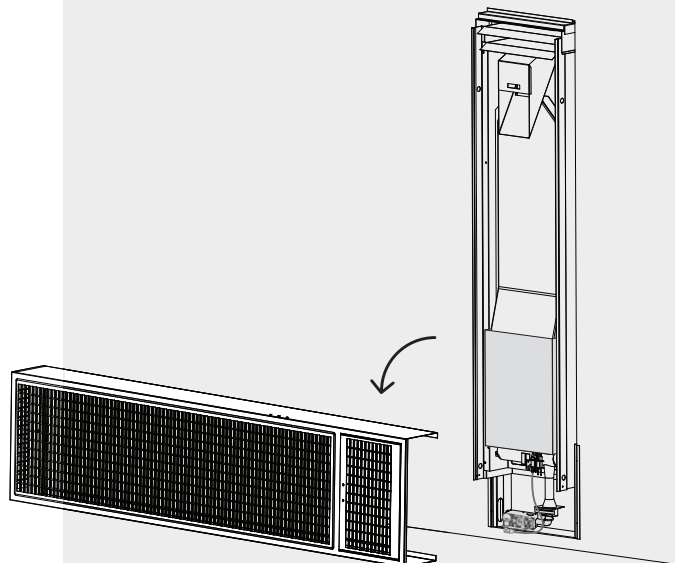

INSTALLATION

Step 6

- Remove the door from the heater housing.
- Locate the Pilot Pro in the carton and remove the cover from baseplate with a screwdriver.
- Check the inside of the housing for safety labels. Try to avoid drilling through any pertinent safety information during this step.

USE THE MOUNTING PLATE (3) FOR THE FOLLOWING STEPS.

MOUNTING PLATE MUST BE MOUNTED AS DIRECTED BELOW OR WIRE HARNESS WILL NOT REACH.

1. PLEASE NOTE **A** OF THIS STEP.

Do not mount the PilotPro any higher than the top of the access door of the housing.

2. PLEASE NOTE **B** OF THIS STEP.

Align the PilotPro very close to the back edge of the housing.

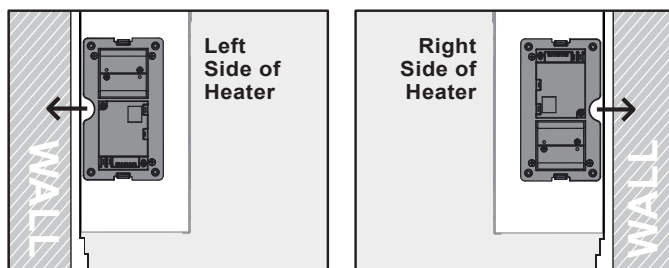

3. PLEASE NOTE **C** OF THIS STEP.

Be sure to face the notch / cutout of the mounting plate (3) toward the wall.

4. Using the mounting plate (3) as a template, align in place as illustrated. Using a marker or pencil, leave a mark for the three hole locations on the metal housing.

SET ASIDE THE MOUNTING PLATE (3).

**DO NOT DRILL DIRECTLY THROUGH MOUNTING PLATE.
DRILL MAY CRACK THE MOUNTING PLATE.**

5. Drill the three holes into housing using a 3/16" drill bit.

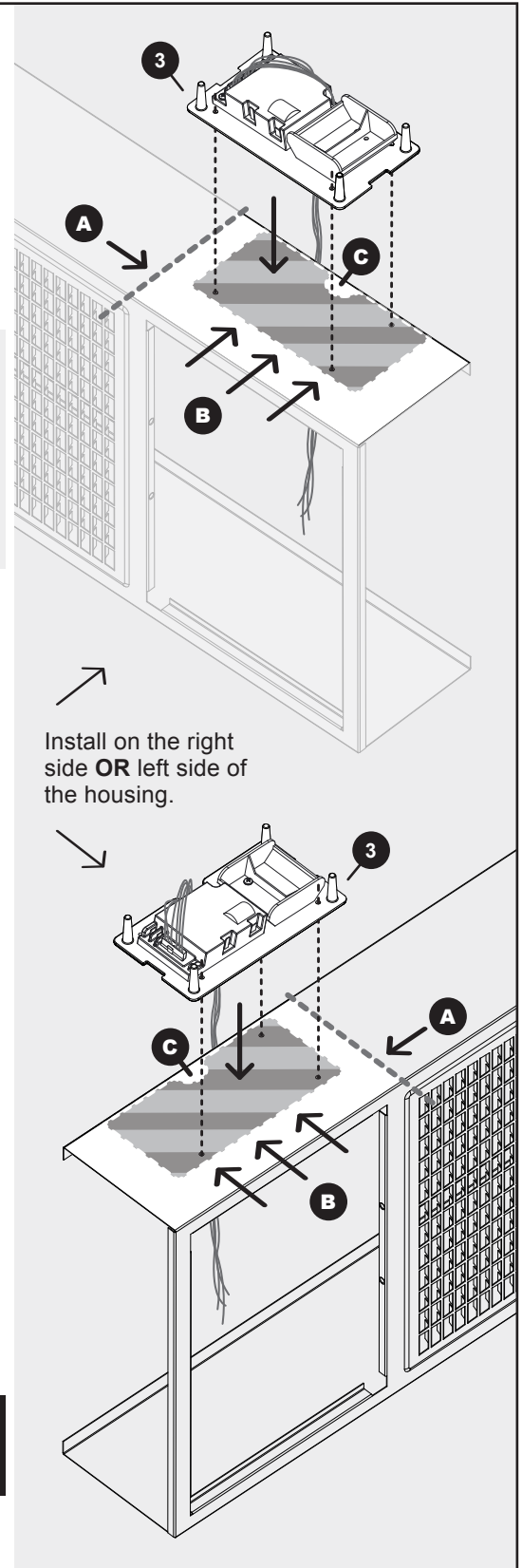

INSTALLATION

Step 7

With a Phillips head screw driver, attach the controls assembly to the side of the heater housing using:

- x3 Screws #8 x 3/4" (7)
- x3 Nuts #8 (9)

DO NOT use a powered drill for this step, it could crack the mounting plate.

USE A SCREWDRIVER AND HAND-TIGHTEN ONLY.

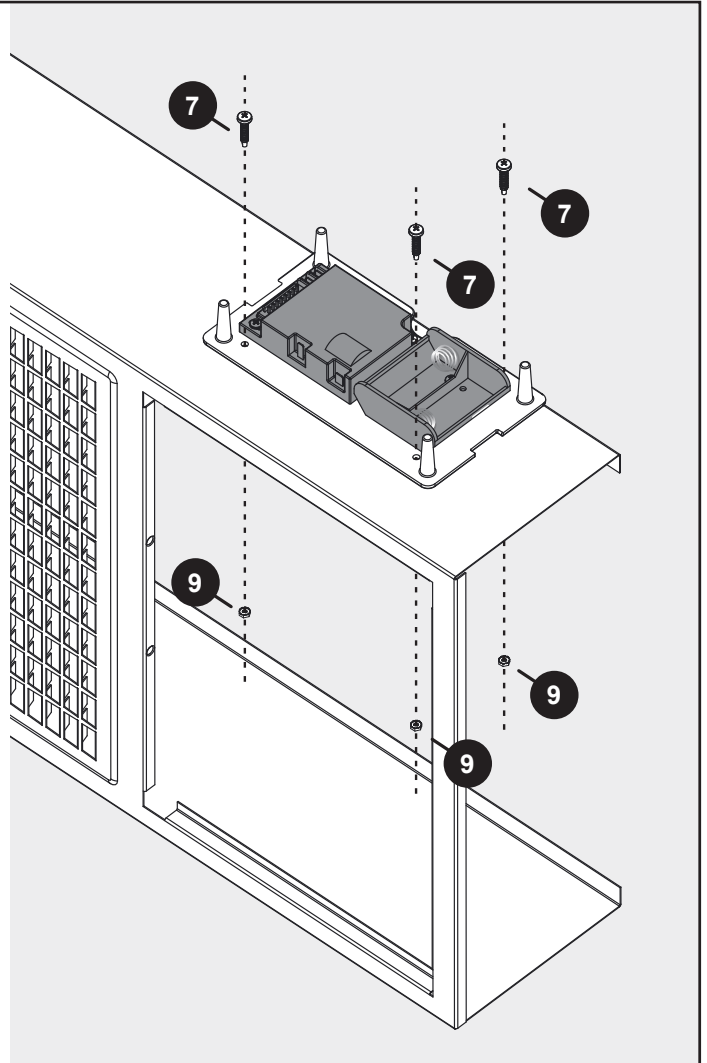

Step 8

Temporarily remove the existing Heat Shield from your heater.

Do not discard. Set aside these parts as you will be re-installing the Heat Shield later.

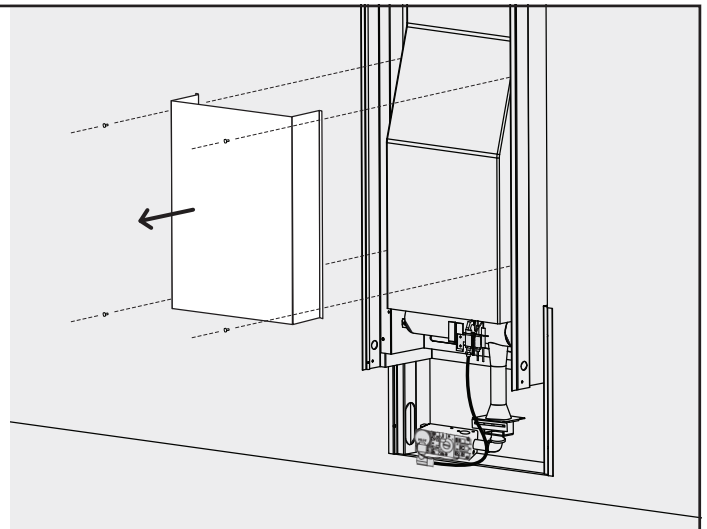

INSTALLATION

Step 9

Verify again that gas to the appliance has been shut off.

Disconnect the gas line from the current valve.

Extract the burner assembly by removing the two screws holding it in place (See illustration to the right).

NOTE: Keep screws for re-installation.

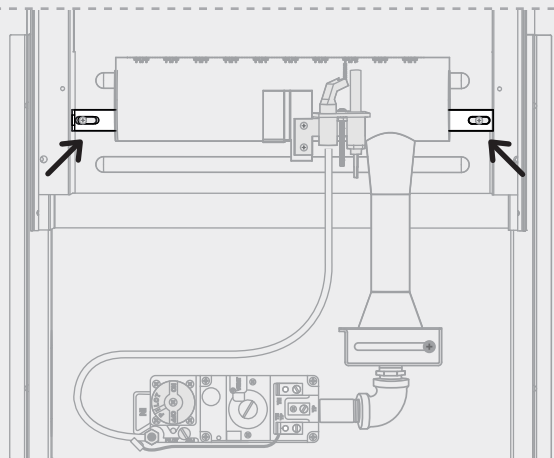
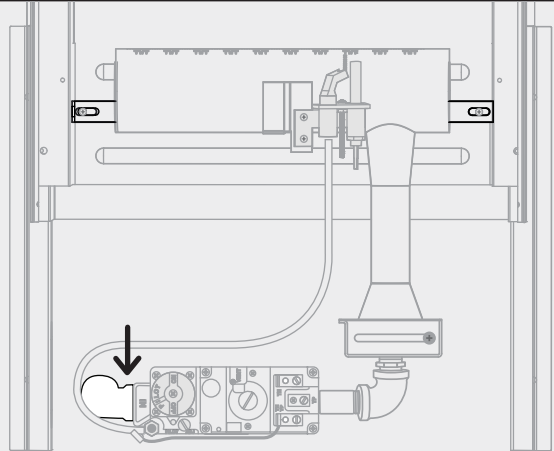

Step 10

1. Disconnect all wiring.
2. Disconnect pilot tube from the pilot assembly. *NOTE: Do not lose pilot orifice. It may want to fall out of pilot once tube is disconnected.*
3. Remove valve from the burner assembly.

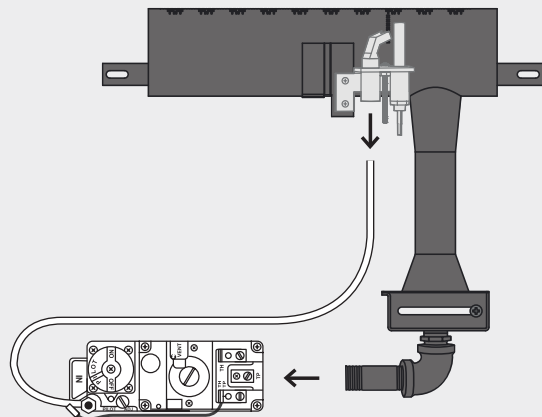

INSTALLATION

Step 11-A

The Pilot Pro valve comes with two outlets.

1. Prior to installing the valve, seal the outlet that is on the same side as pilot tube outlet, with provided plug (13) and pipe dope (*pipe dope not included*).

NOTE: Ensure that there are no leaks.

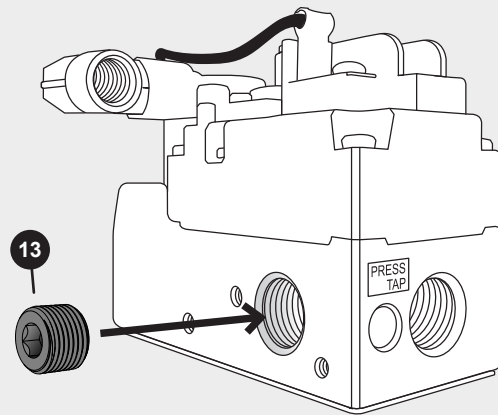
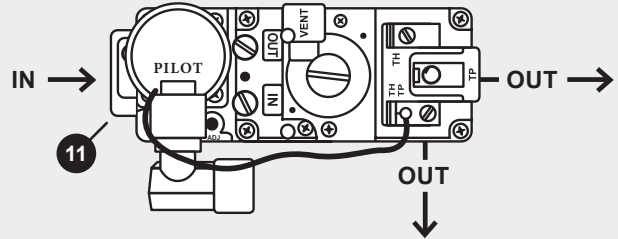

2. Attach the new valve (11) with pipe dope.

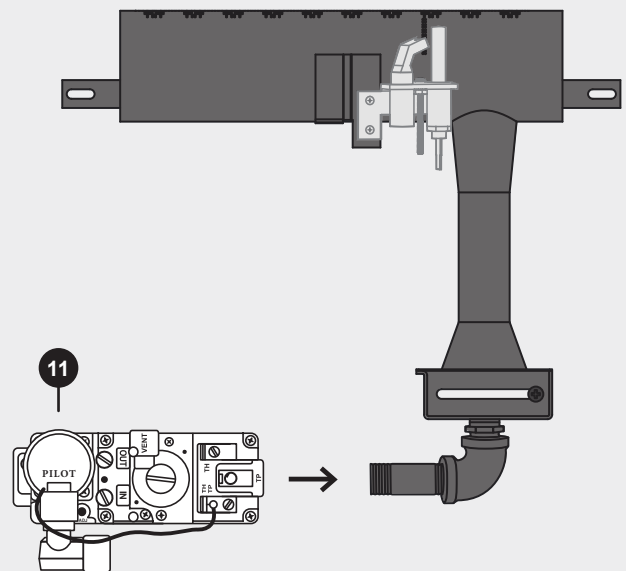

INSTALLATION

Step 11-B

To ensure valve (11) does not contact the floor, orient valve from horizontal to a max of 30°.

NOTE:

Temporarily mount the burner in furnace and ensure valve clears the floor. If ok, remove burner and continue to the next step.

Horizontal :

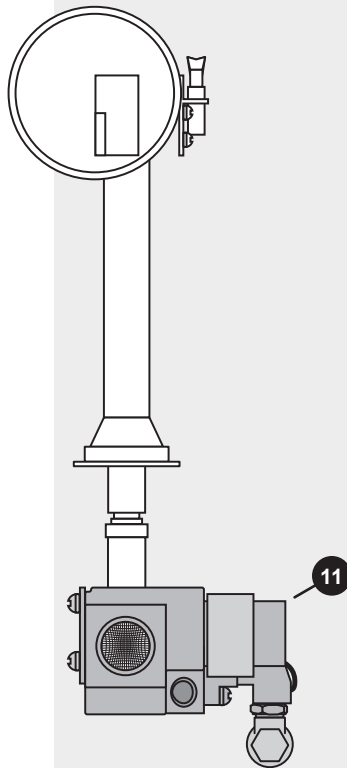

Max 30° :

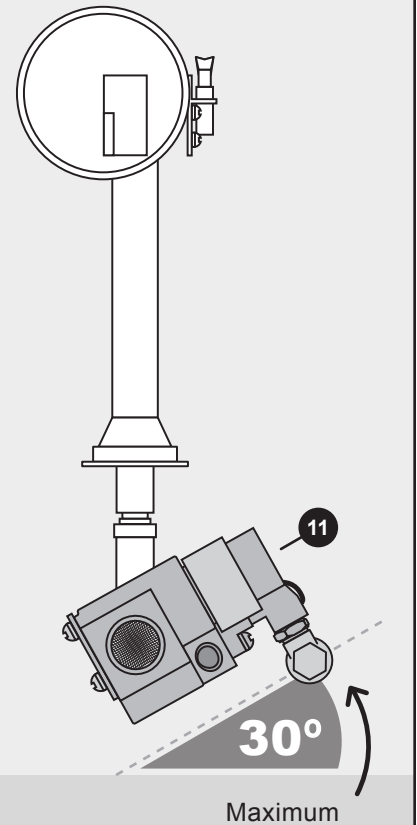

Step 12-A

Install pilot tubing (31) to the new valve (11) with compression nut, large (29).

CAUTION: *Tubing needs to be re-shaped gently. DO NOT KINK!*

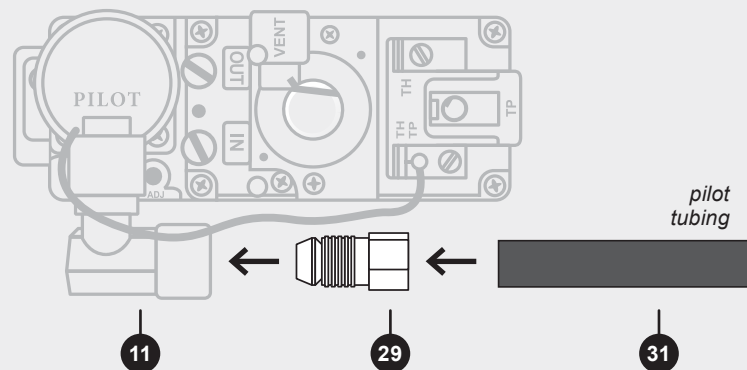

INSTALLATION

Step 12-B

Install pilot tube (31)
to the pilot assembly using
compression nut, small (30).

*Ensure pilot orifice
identified in step 10 is
installed into pilot.*

CAUTION:
Tubing needs to be re-shaped
gently. *DO NOT KINK!*

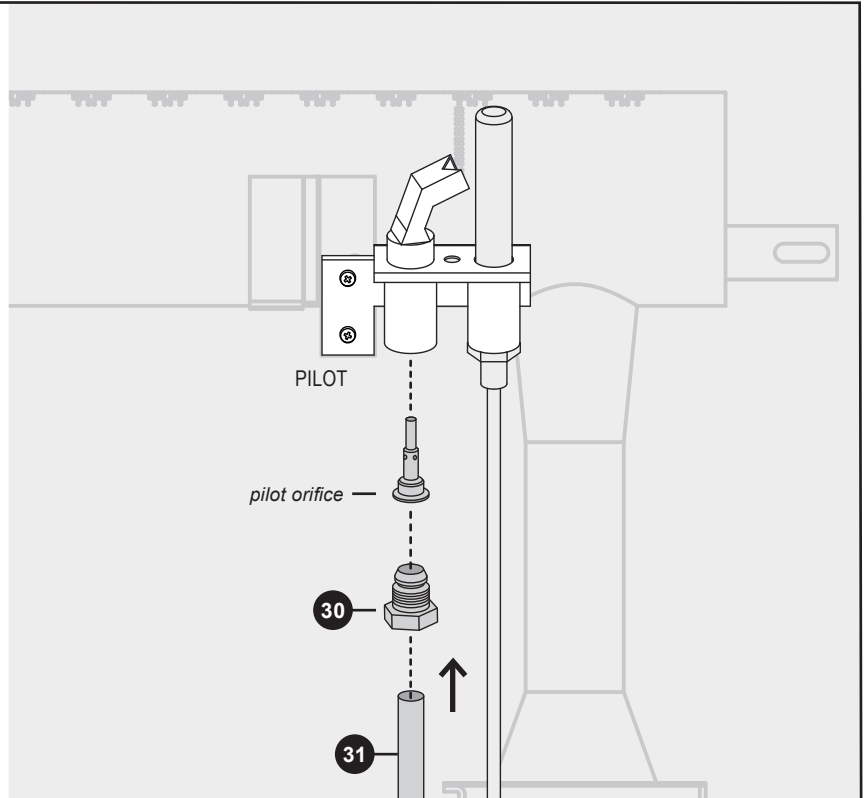

Step 13

Remove thermopile
from the existing pilot.

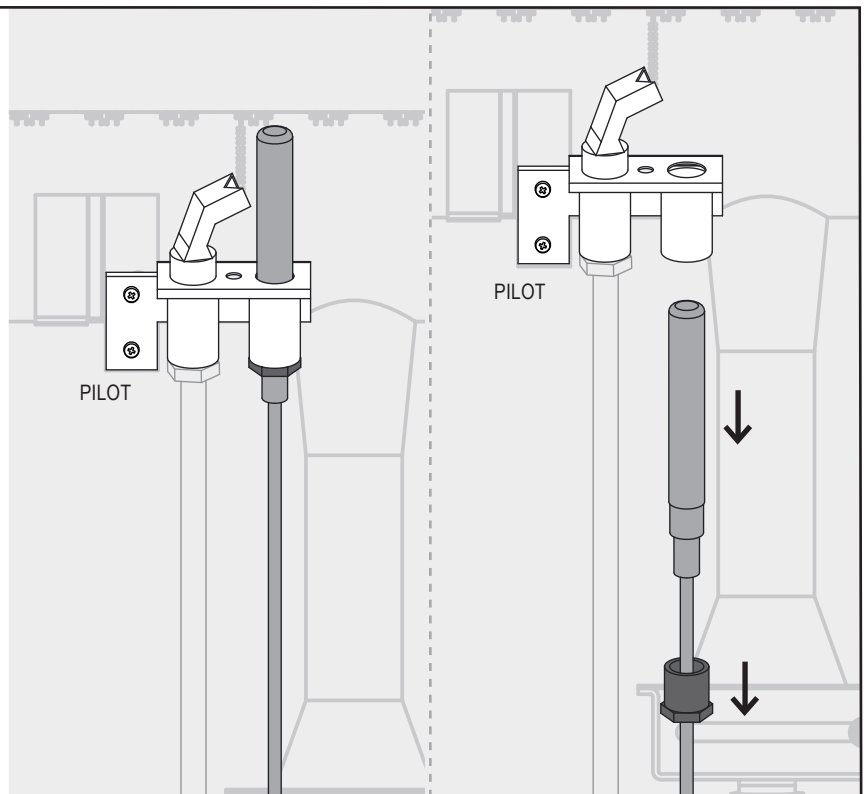

INSTALLATION

Step 14

Insert flame sensor (15) into the same location as the thermopile that was removed on Step 13. Orient flat tab extending from the bottom of the flame sensor (15) parallel to the burner as shown.

Secure in place using the flame sensor nut (26). Do not over-tighten as flame sensor could crack!

Connect flame sensor wire (16) to the blade connector at the base of the flame sensor (15).

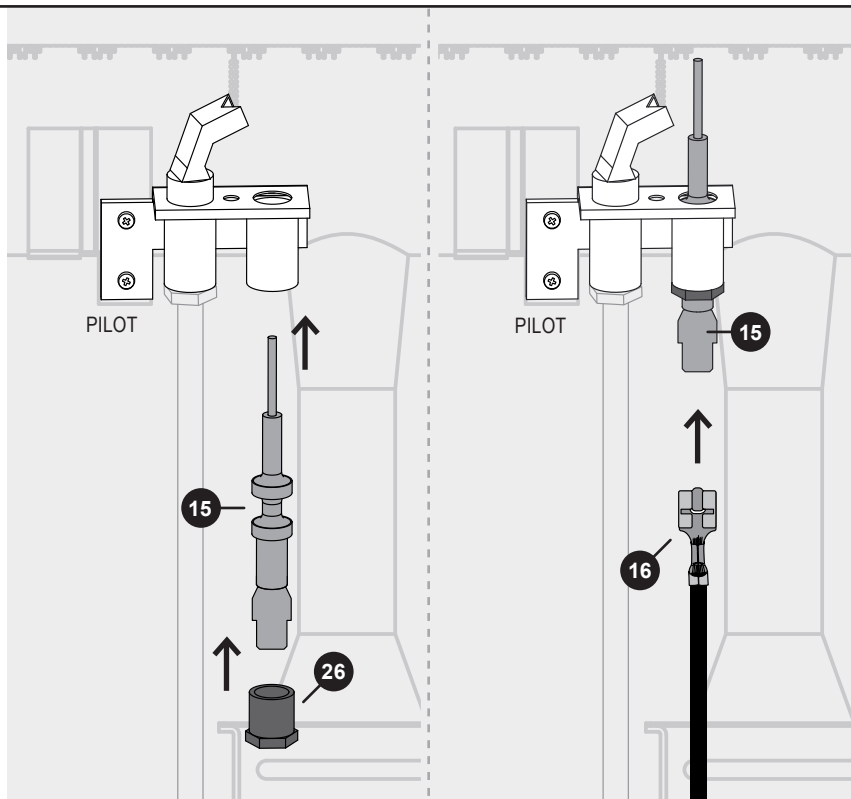

Step 15

Align the ignitor (14) with the top of the pilot bracket as illustrated here.

Run the very long and thin #4 screw (8) through the ignitor (14) and pilot.

Rotate the ignitor (14) as far away from the burner as possible.

Secure these parts firmly in place by adding the #4 nut (10).

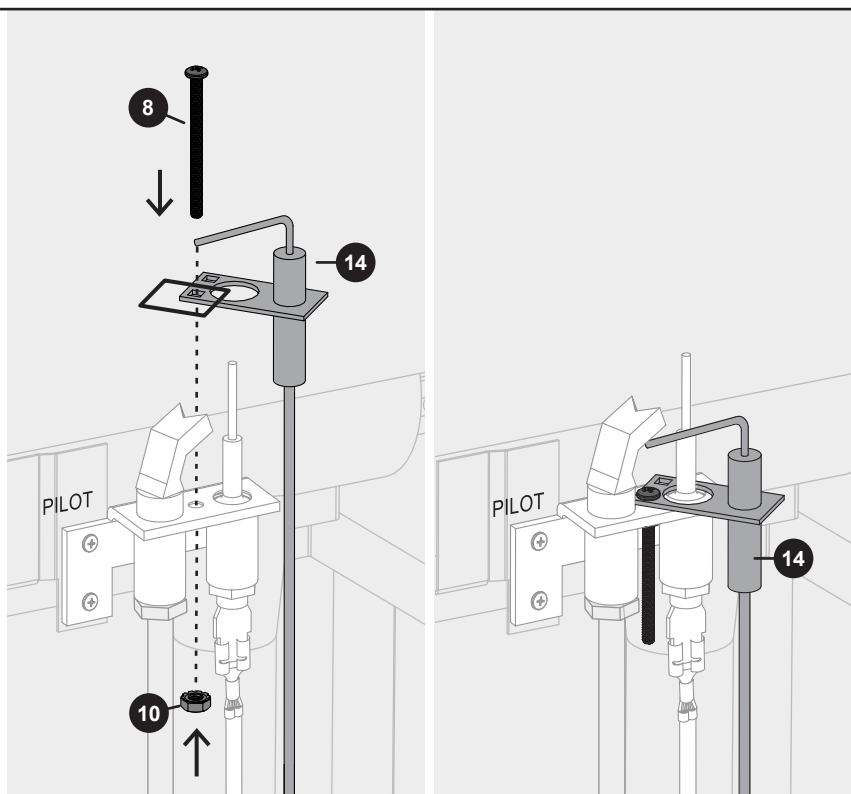
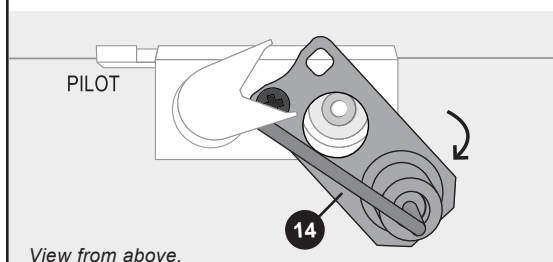

INSTALLATION

Step 16

Check to ensure the ignitor (14) is located properly.

- Ignitor probe (14) should be $\frac{1}{8}$ " under the hood.
- Ignitor probe (14) should be $\frac{3}{16}$ " away from flame sensor (15).
- Probe should be bent so that the tip of the probe sparks only against the hood of the pilot.
- DO NOT TWIST IGNITOR WIRE OR IT MAY BREAK FROM CERAMIC BASE.

*DO NOT USE A
BROKEN IGNITOR.*

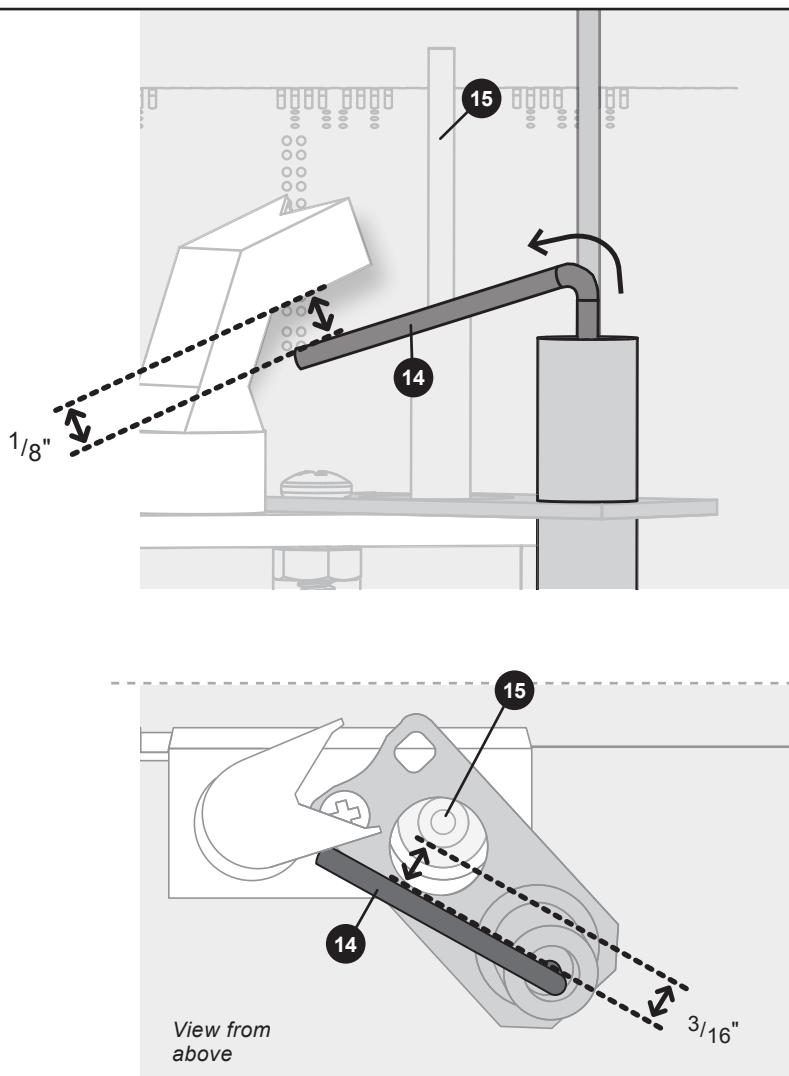

Step 17

Add the valve bracket (27) to the base of the Pilot Pro Valve (11) using:

- x2 Screws #10-24 x $\frac{3}{8}$ " (28)

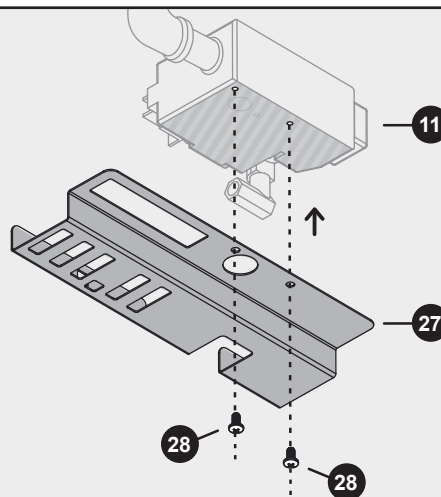

INSTALLATION

Step 18

Reinstall the burner assembly using the original two screws that held it in place (See illustration to the right).

Next, re-connect the gas line to the valve.

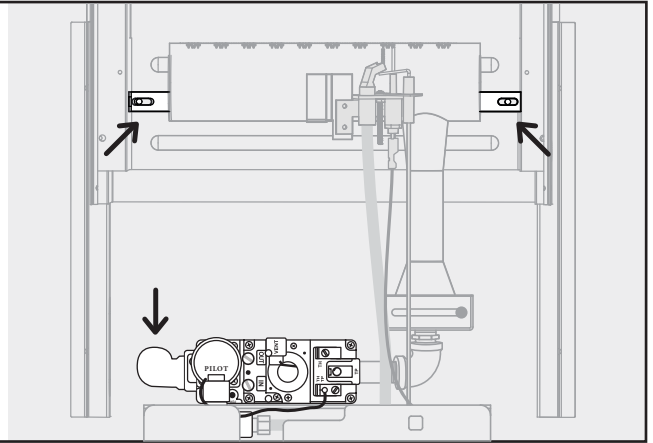

Step 19

Ensure flame sensor (15) and flame sensor wire connector (16) Do NOT contact any metal surface such as the heat shield and pilot tube.

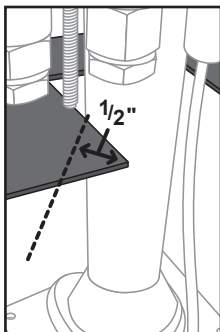

If necessary, using pliers, bend the corner of the heat shield away from the flame sensor (15) and wire connector (16).

Do not bend more than 1/2" from the corner as shown.

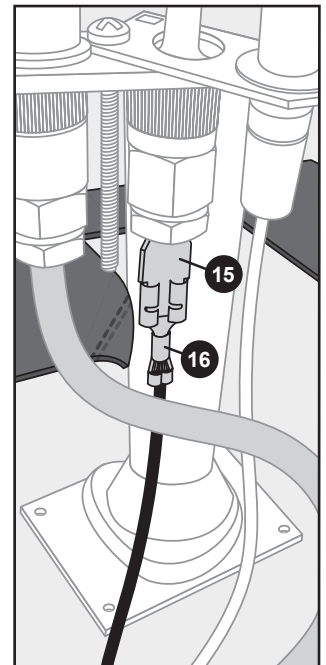
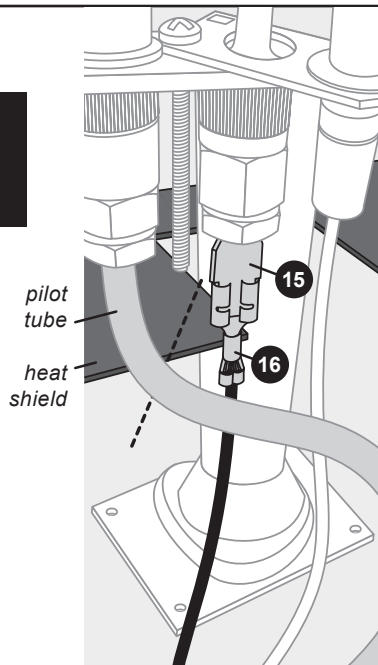

Step 20

Reinstall the Heat Shield that was removed from your heater during this installation.

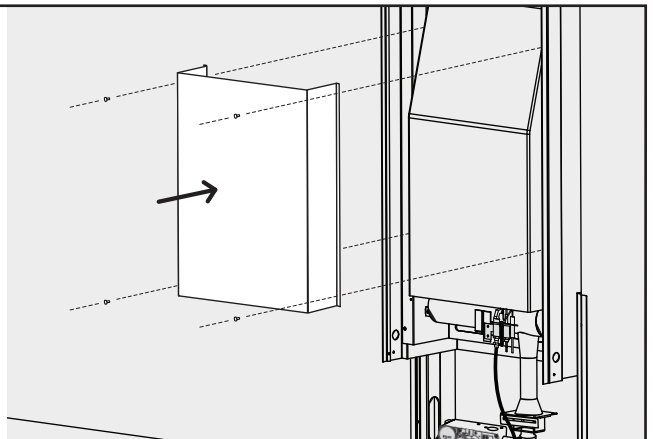



PILOT PRO ELECTRICAL CONNECTION



PILOT PRO ELECTRICAL CONNECTION

WARNING: PLEASE USE CAUTION WHILE INSTALLING THE ELECTRICAL CONNECTION



Step 1

1. Fill out and apply modification sticker (20) with date, name and contact information.



WARNING:
DO NOT ATTEMPT TO LIGHT THIS APPLIANCE MANUALLY.
BURN, INJURY OR ELECTRIC SHOCK MAY RESULT.
This appliance has been modified to use an automatic intermittent pilot system. Attempting to light this appliance manually may cause burns, injury or electric shock.

Date of Installation: _____

Name of Installer: _____

Contact for Installer (Address or Telephone): _____

20

1018171-A

2. Apply the ladder schematic (18), wiring diagram (19) and the modification sticker (20) inside the front panel of the heater.

NOTE: Place the labels near the base (on either side). They should be visible through the service door.

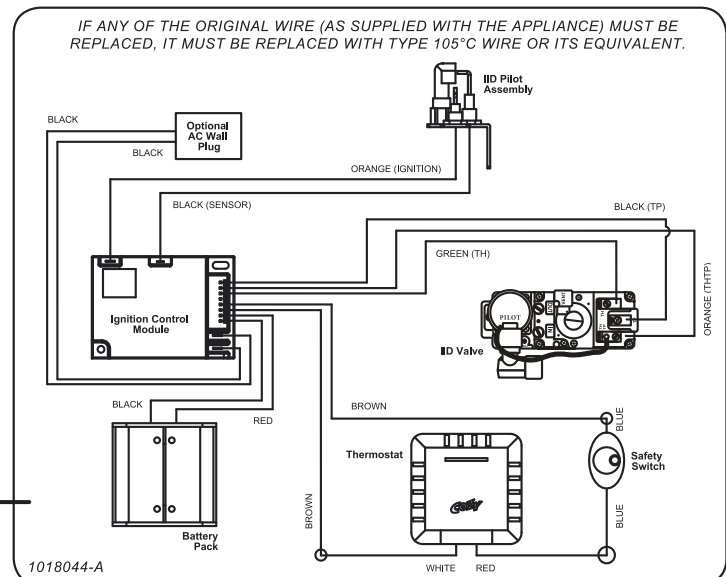
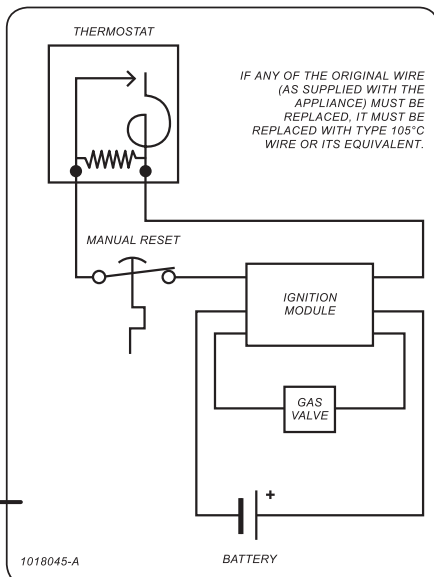
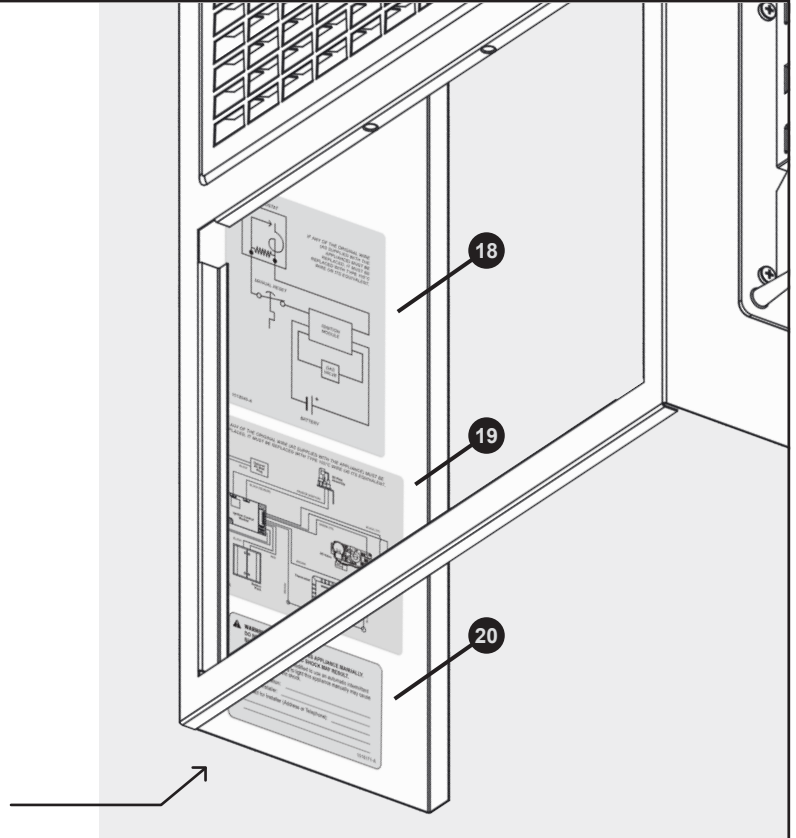

PILOT PRO ELECTRICAL CONNECTION

WARNING: PLEASE USE CAUTION WHILE INSTALLING THE ELECTRICAL CONNECTION



Step 2

Reattach the front panel housing on the heater.

NOTE: Leave the access door open until installation has been complete.

Make sure there are no sharp edges on the rim of the heater housing that could potentially damage the wires.

Step 3

Direct the control module wires (2) through the small notch on the side of the mounting plate (3).

Tuck the wires around the edge of the heater housing, against the wall, and inside the heater.

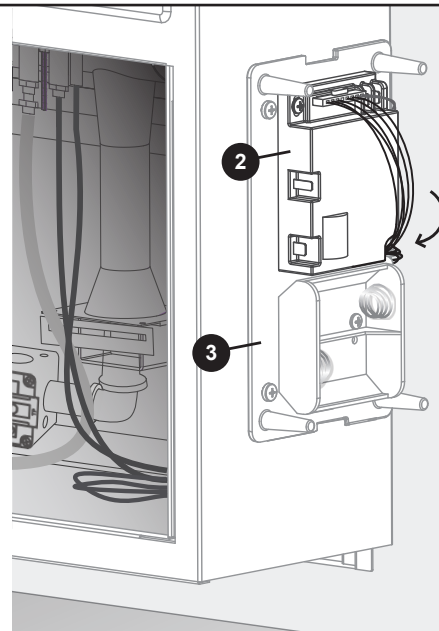
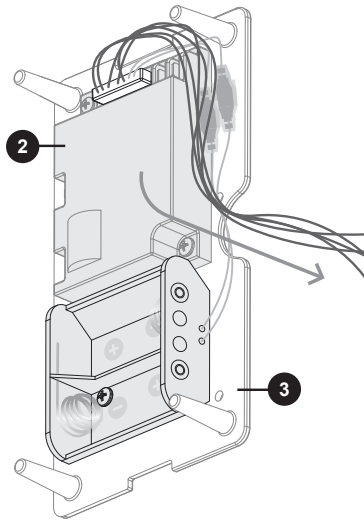

On the inside of the heater, you will see orange and black wires extending from the burner.

Lead the orange pilot ignitor wire (14) and black flame sensor wire (16) out of the heater beside the wires you have just directed in.

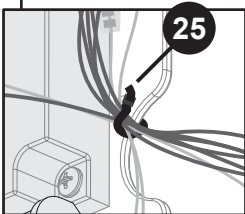
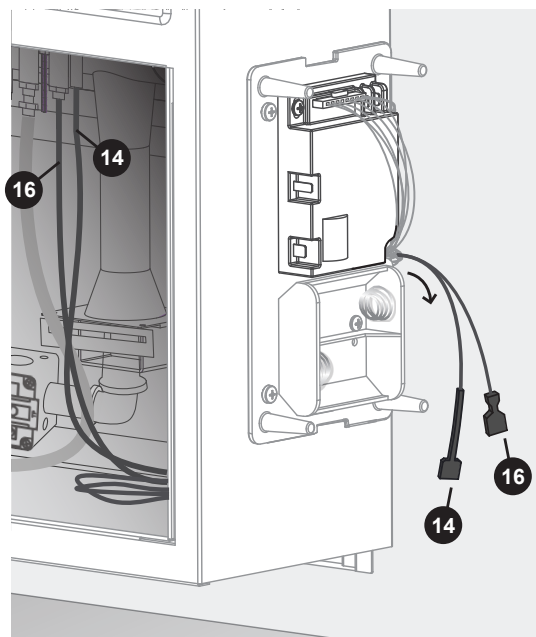

Run a cable tie (25) through the small hole beside the notch on the mounting plate (3).

Gather and secure the wires to and from the Control Module (2) with the cable tie (25).

PILOT PRO ELECTRICAL CONNECTION

WARNING: PLEASE USE CAUTION WHILE INSTALLING THE ELECTRICAL CONNECTION



Step 4

- Connect Black TP wire to the TP terminal of valve.
- Connect Green TH wire to TH terminal of the valve.
- Connect Orange THTP wire to the THTP terminal of the valve.

NOTE: Ensure that all of the connections are tightened firmly.

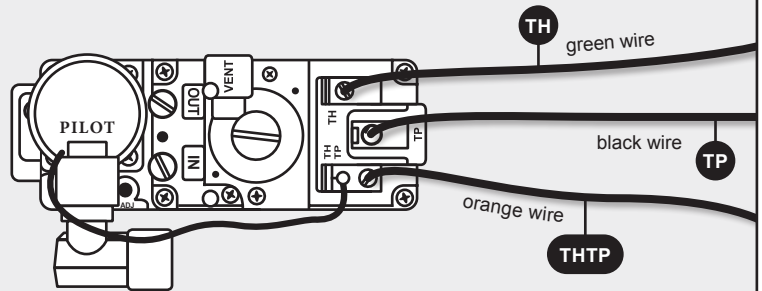

Step 5

- A** Connect bare brown SWI wire from the control module wiring harness (12) to the white thermostat wire, using a wire nut (17).
- B** Connect the brown male blade quick connect SWI wire from the control module wiring harness (12) to the blue female quick connect from safety switch.

WARNING:
The two brown wires must be wired properly to prevent carbon monoxide poisoning or death.

- C** Connect the bare blue wire from safety switch to the red thermostat wire, using a wire nut (17).

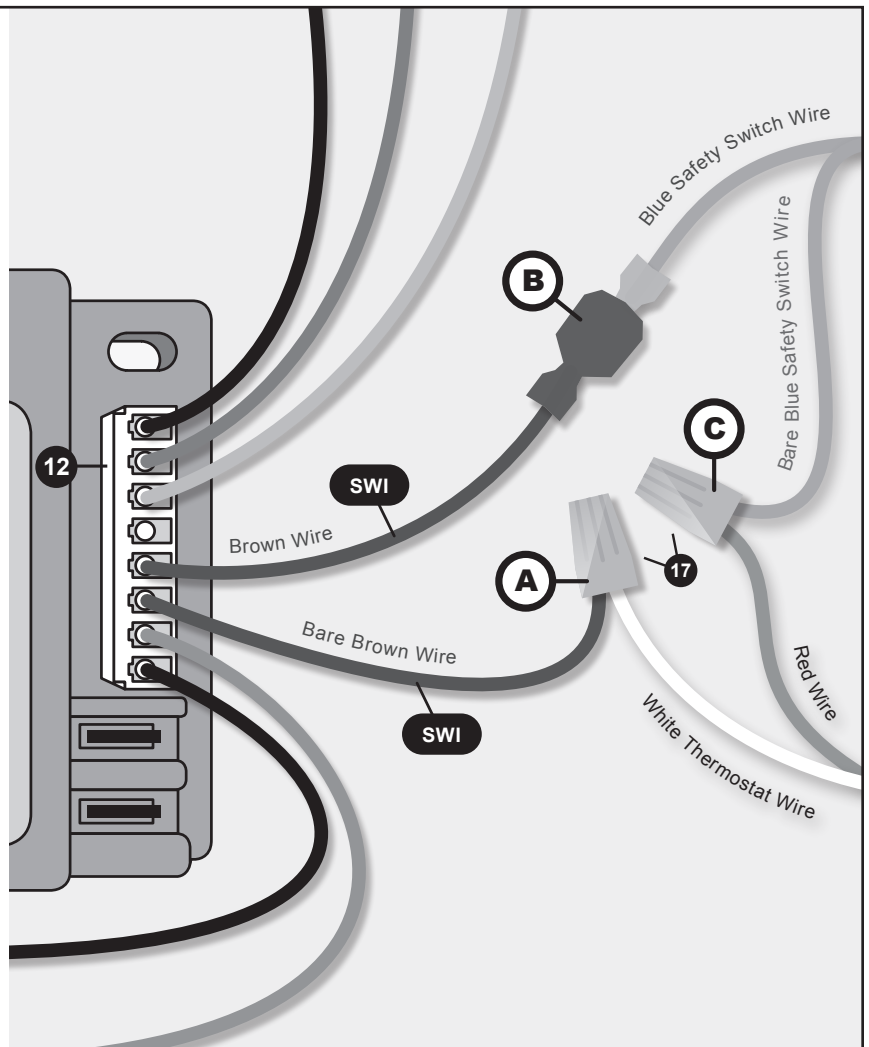

PILOT PRO ELECTRICAL CONNECTION

WARNING: PLEASE USE CAUTION WHILE INSTALLING THE ELECTRICAL CONNECTION



Step 6

Plug the orange wire from Ignitor (14) into the port labeled "I" on the control module (2). *Ensure it is firmly seated.*

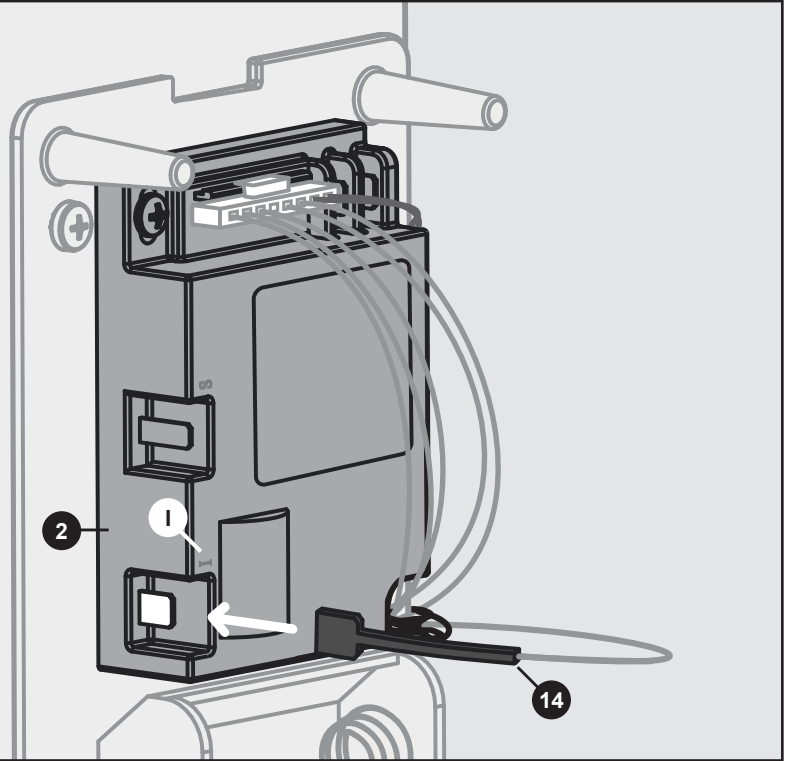

Step 7

Plug the black flame sensor wire (16) into the port labeled "S" on the control module (2). *Ensure it is firmly seated.*

NOTE: Base of the connector terminal may be slightly exposed.

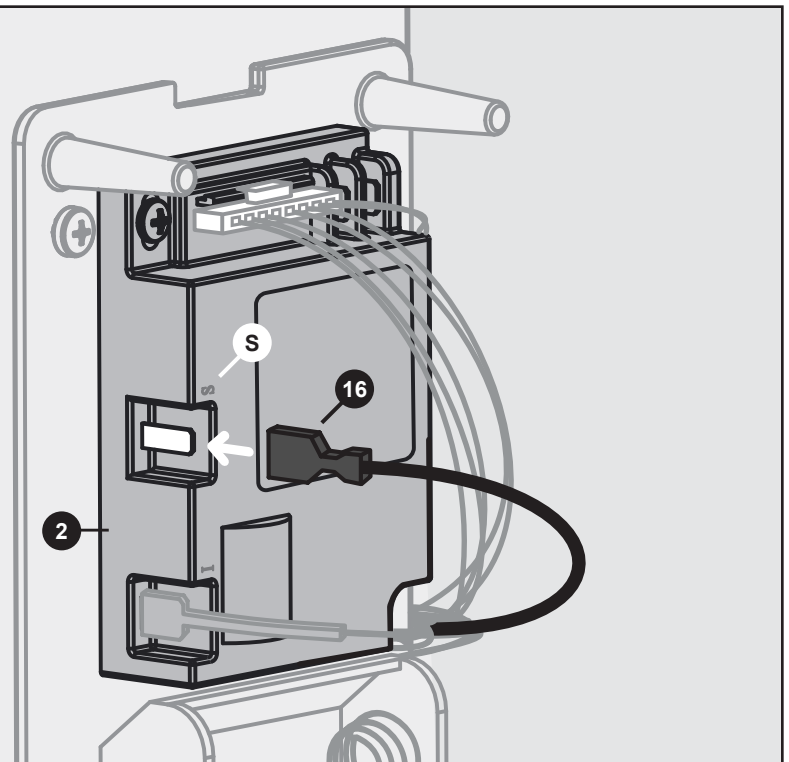
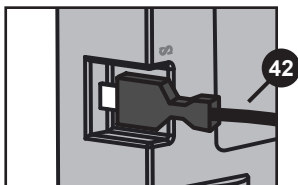

PILOT PRO ELECTRICAL CONNECTION

WARNING: PLEASE USE CAUTION WHILE INSTALLING THE ELECTRICAL CONNECTION

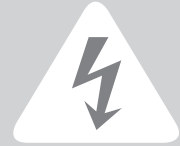

CAUTION: Label all wires prior to disconnection when servicing controls. Wiring errors can cause improper and dangerous operation. Verify proper operation after servicing and secure wires away from sharp edges, flames or hot surfaces inside and outside the unit.

Step 8: Ensure the wiring is done according to this diagram

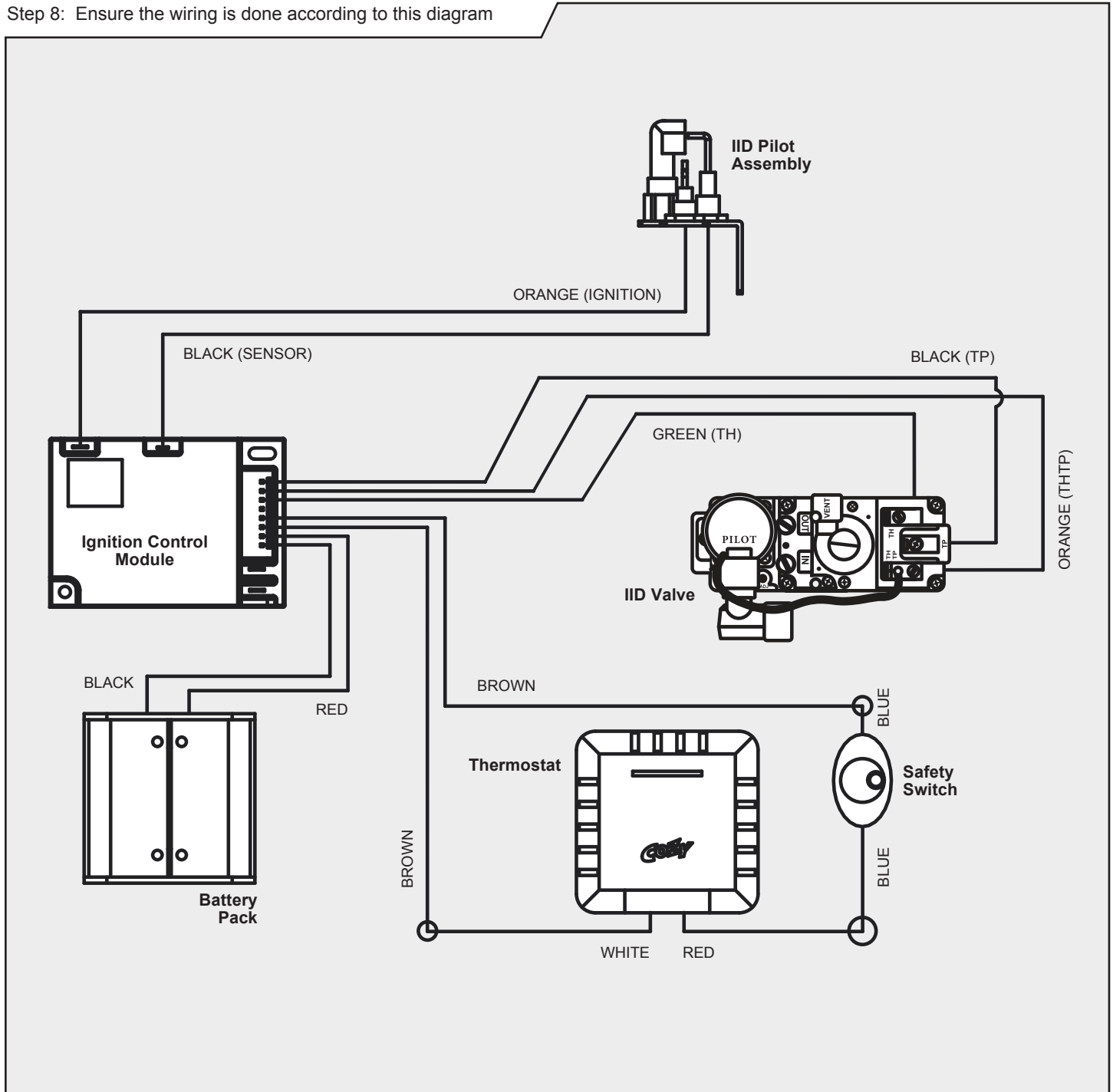

PILOT PRO ELECTRICAL CONNECTION

WARNING: PLEASE USE CAUTION WHILE INSTALLING THE ELECTRICAL CONNECTION



FOLLOW STEP 9 IF THE PILOT PRO IS ON THE **RIGHT** SIDE OF THE HOUSING.

(Proceed to step 10 if the Pilot Pro is on the left side of the housing).

Make certain wiring connections are tight before proceeding and secure so they will not be able to contact high temperature locations.

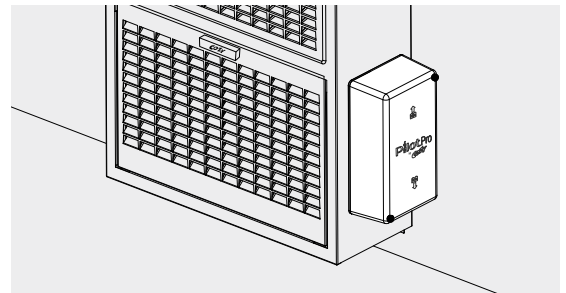

STEP 9.

- A.** Route the wires around the back edge & inside the heater housing. Bundle wires neatly with a cable tie (**25**) attached to the Z-shaped bracket inside the liner.
- B.** Bundle the wires against the valve bracket. Fix the wires in place neatly by attaching them with a cable tie (**25**) to the valve bracket (**27**).

Do not allow the bundled wires to hang beyond the edge of the valve bracket (**C**) and keep the bundled wires below the lower part of the burner (**D**).

NOTE: Keep all wires away from the burner.

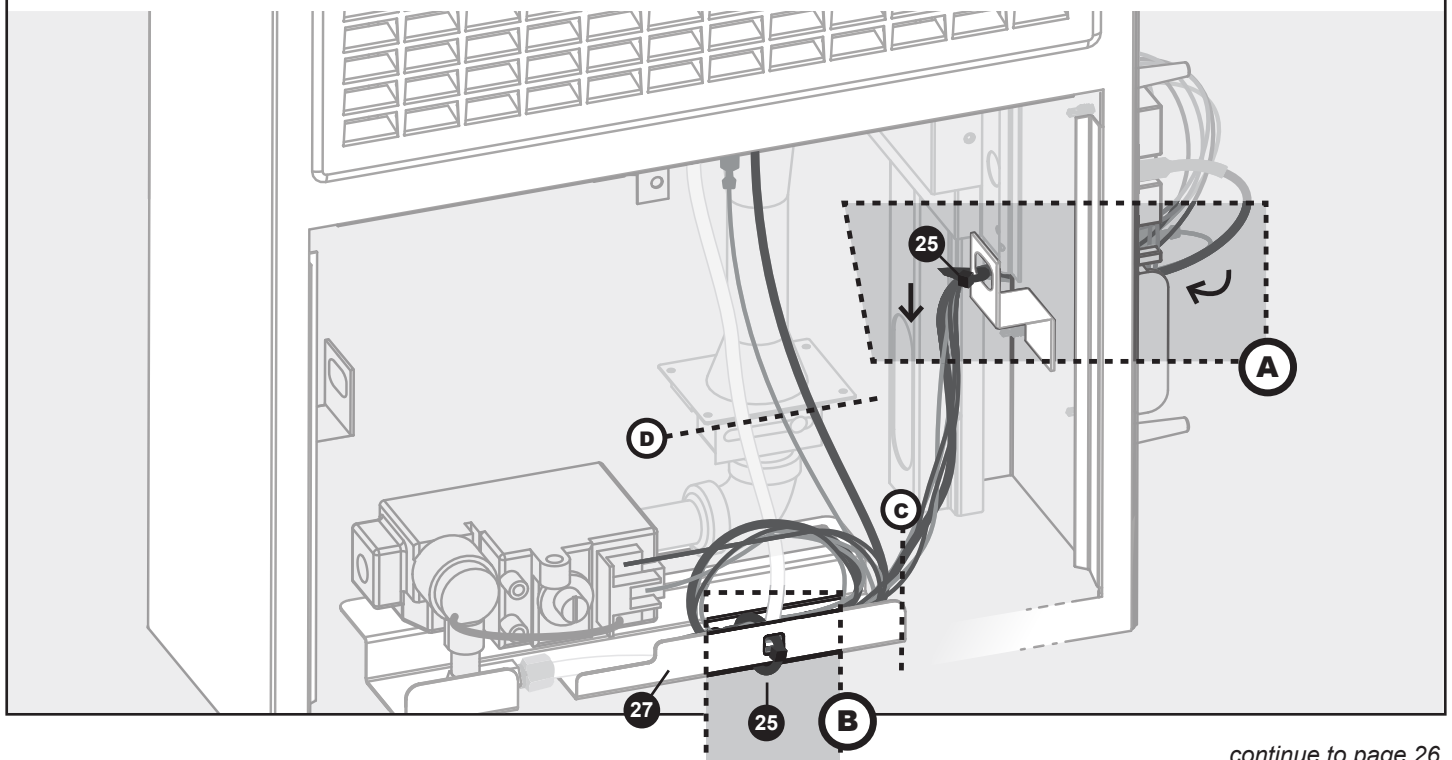
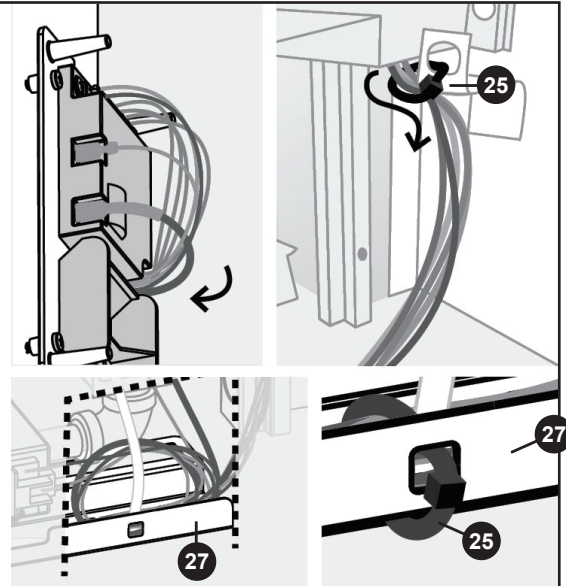

...continue to page 26.

PILOT PRO ELECTRICAL CONNECTION

WARNING: PLEASE USE CAUTION WHILE INSTALLING THE ELECTRICAL CONNECTION



FOLLOW STEP 10 IF THE PILOT PRO IS ON THE LEFT SIDE OF THE HOUSING.

(Go back to step 9 if the Pilot Pro is on the right side of the housing).

Make certain wiring connections are tight before proceeding and secured so they will not be able to contact high temperature locations.

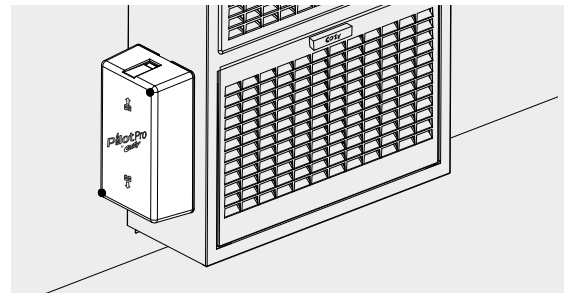

STEP 10.

- A. Route the wires around the back edge and inside the heater housing. Bundle wires neatly with a cable tie (25) attached to the Z-shaped bracket inside the liner.
- B. Lead the bundle of wires through the gap between the valve and valve bracket.

Do not allow the bundled wires to hang beyond the edge of the valve bracket (C) and keep the bundled wires below the lower part of the burner (D).

NOTE: Keep all wires away from the burner.

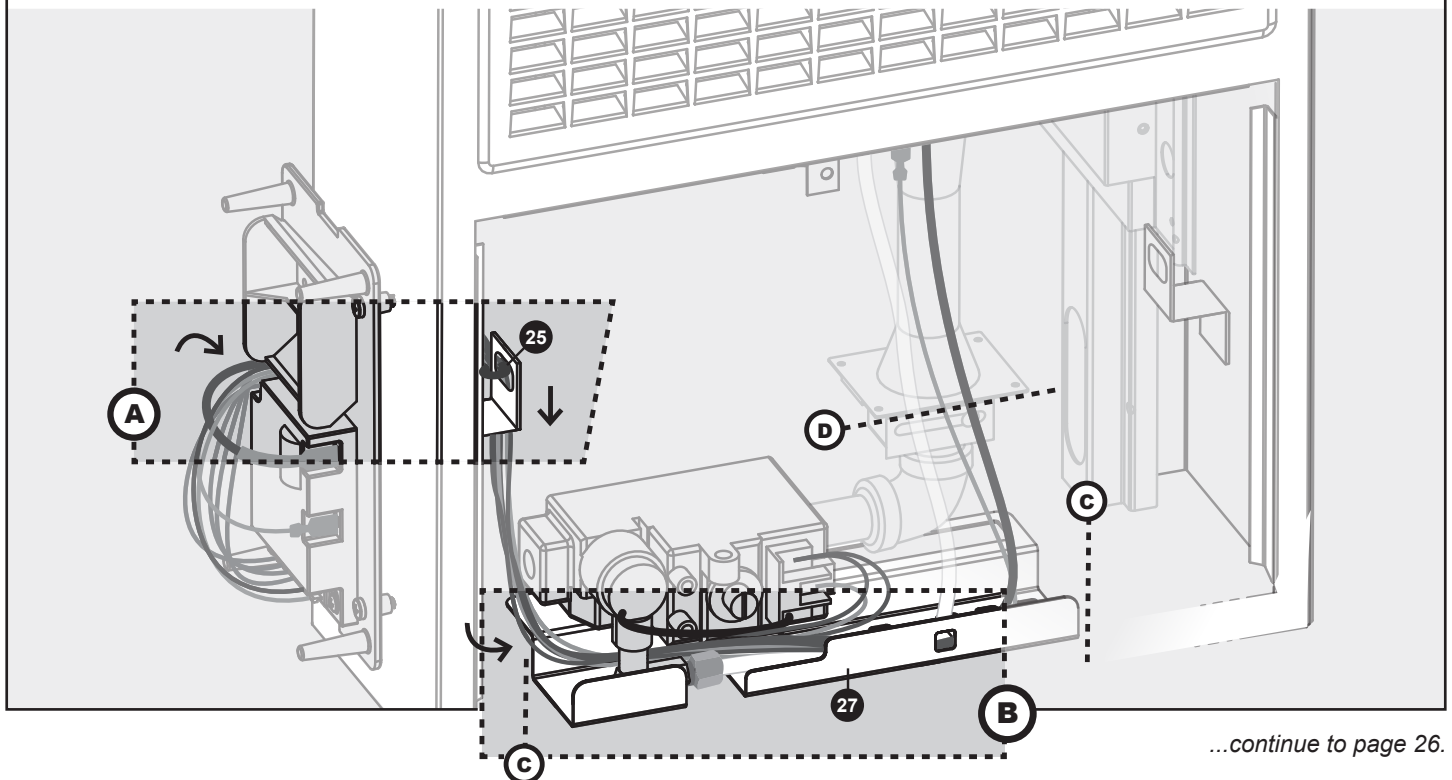
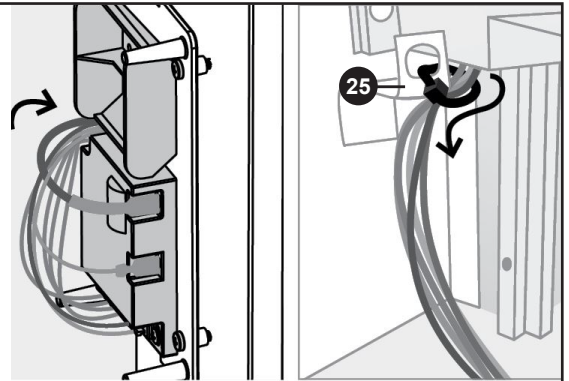

...continue to page 26.

STARTING PILOT PRO SYSTEM PER ANSI Z21.71

STEP 1

Turn on all gas and electricity to the appliance.

- Conduct a gas leakage test of the appliance piping and control system downstream of the shutoff valve in the supply line to the appliance.
- Check all furnace connections for gas leaks with leak detector solution, including plug installed into valve body.
Do not use open flame.

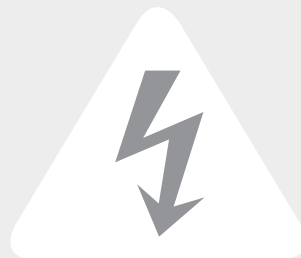

STEP 2

Adjust thermostat to lowest setting.

Place two D Batteries (22) in the Battery pack (1).

2a. Initial startup of the pilot pro system may take several minutes due to air in the PILOT gas line.

2b. After turning up thermostat, the ignitor will begin to spark. After 1 minute, it will stop.

2c. **IF PILOT DOES NOT LIGHT:**
Lower thermostat to **OFF**, then turn it back up.

2d. Ignitor will start to spark.

2e. Repeat steps 2b through 2d until the pilot lights.

2f. Visually determine that main burner is burning properly (i.e., Flame isn't too soft or too hard).

To adjust the primary air shutter(s) as required, see flame adjustments on page 31.

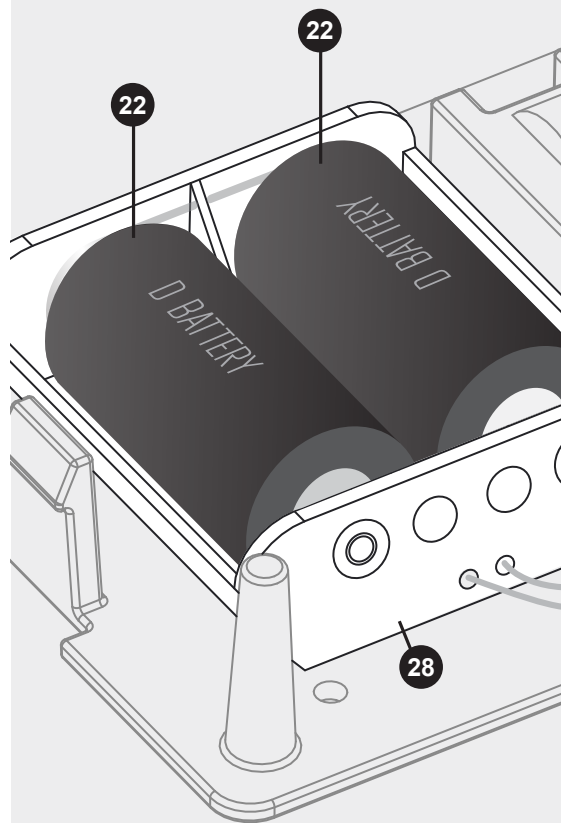

STARTING PILOT PRO SYSTEM PER ANSI Z21.71

STEP 3



Ensure Ignitor sparks only against the hood of the pilot.

Ignitor should not spark against the flame sensor, brackets, heating chamber, burner, etc. Adjust ignitor probe location if required.

- **DO NOT** twist ignitor wire or break from ceramic base.
- **DO NOT** use a broken ignitor.

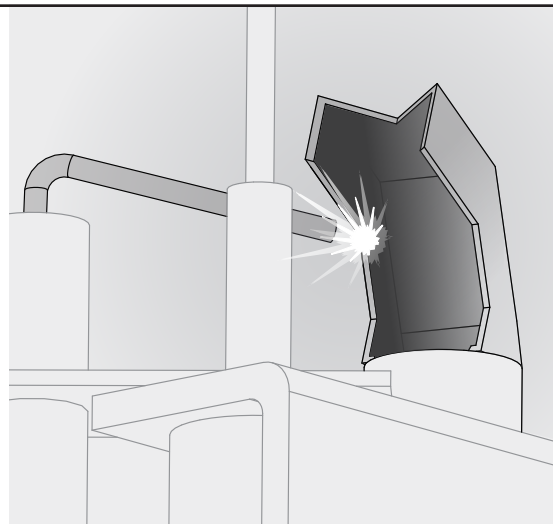

STEP 4

Determine that the pilot is igniting and burning properly and that main burner ignition is satisfactory by turning the thermostat off and back on. Make this determination with the appliance burner both cold and hot. Perform this step as many times as is necessary to satisfy yourself that the automatic intermittent pilot system is operating properly.

Sequence the appliance through at least three (3) operating cycles.



STEP 5

Remove existing lighting instructions, and replace with PilotPro lighting instructions (21).

Re-install the heater door on the front of the housing, at the base.

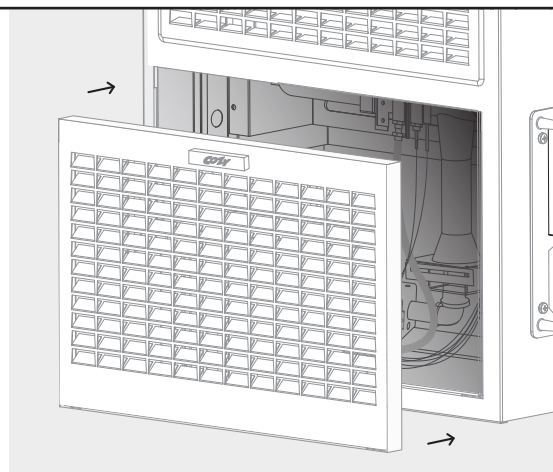

STARTING PILOT PRO SYSTEM PER ANSI Z21.71

Step 8

Slide the Pilot Pro cover (4) over the controls.

Secure in place with:

- x2 Screw with knob (6)

NOTE:

Hand-tighten only.

Do not over tighten.

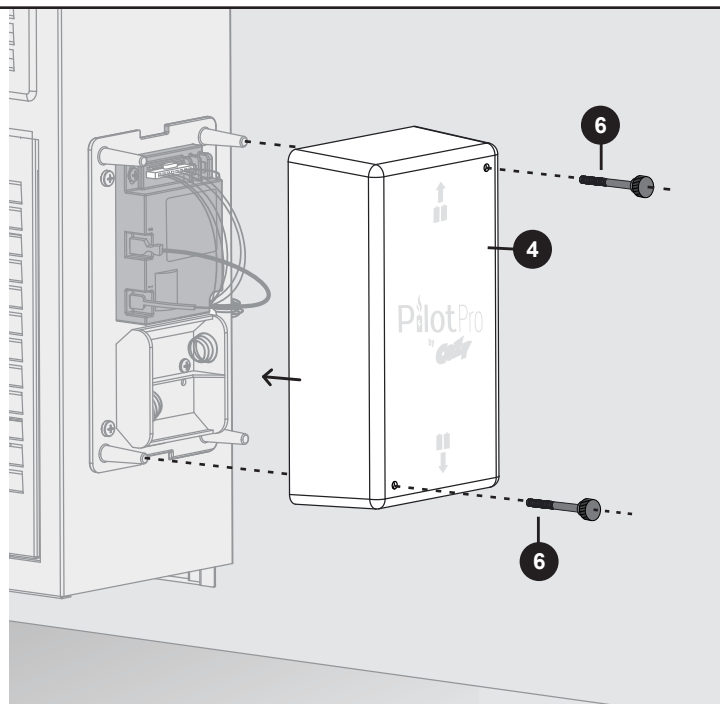

Step 9

⚠ WARNING: CARBON MONOXIDE POISONING HAZARD

Failure to follow the steps outlined below for each appliance connected to the venting system being placed into operation could result in carbon monoxide poisoning or death.

The following steps shall be followed for each appliance connected to the venting system being placed into operation, while all other appliances connected to the venting system are not in operation:

1. Seal any unused openings in the venting system.
2. Inspect the venting system for proper size and horizontal pitch, as required in the National Fuel Gas Code, ANSI Z223.1/NFPA 54 or the Natural Gas and Propane Installation Code, CSA B149.1 and these instructions. Determine that there is no blockage or restriction, leakage, corrosion and other deficiencies which could cause an unsafe condition.
3. As far as practical, close all building doors and windows and all doors between the space in which the appliance(s) connected to the venting system are located and other spaces of the building.
4. Close fireplace dampers.
5. Turn on clothes dryers and any appliance not connected to the venting system. Turn on any exhaust fans, such as range hoods and bathroom exhausts, so they are operating at maximum speed. Do not operate a summer exhaust fan.
6. Follow the lighting instructions. Place the appliance being inspected into operation. Adjust the thermostat so appliance is operating continuously.
7. Test for spillage from draft hood equipped appliances at the draft hood relief opening after 5 minutes of main burner operation. Use the flame of a match or candle.
8. If improper venting is observed during any of the above tests, the venting system must be corrected in accordance with the National Fuel Gas Code, ANSI Z223.1/NFPA 54 and/or Natural Gas and Propane Installation Code, CSA B149.1.
9. After it has been determined that each appliance connected to the venting system properly vents when tested as outlined above, return doors, windows, exhaust fans, fireplace dampers and any other gas-fired burning appliance to their previous conditions of use.

LIGHTING INSTRUCTIONS - (PILOT PRO)

FOR YOUR SAFETY READ BEFORE LIGHTING

WARNING: IF YOU DO NOT FOLLOW THESE INSTRUCTIONS EXACTLY, A FIRE OR EXPLOSION MAY RESULT CAUSING PROPERTY DAMAGE, PERSONAL INJURY OR LOSS OF LIFE.

- A. This appliance is equipped with an ignition device which automatically lights the pilot. Do not try to light the pilot by hand.
- B. BEFORE OPERATING smell all around the appliance area for gas. Be sure to smell next to the floor because some gas is heavier than air and will settle on the floor.

WHAT TO DO IF YOU SMELL GAS:

- **DO NOT** try to light any appliance.
- **DO NOT** touch any electric switch.
- **DO NOT** use any phone in your building.
- Immediately call your gas supplier from a neighbor's

- phone. Follow the gas supplier's instructions.
- If you cannot reach your gas supplier, call the fire department.

- C. Do not force any component of the ignition system. Attempted repair may result in a fire or explosion. Call a qualified service technician.
- D. Do not use this appliance if any part has been under water. Immediately call a qualified service technician to inspect the appliance and to replace any part of the control system and any gas control which has been under water.

1018052-B 05/19

TURNING OFF GAS TO THE APPLIANCE

1. Set the thermostat to lowest setting.
2. Remove battery cover, located on side of heater.

3. Remove batteries.
4. Replace battery cover.

1018052-B 05/19

OPERATING INSTRUCTIONS

1. **STOP!** Read the safety information above on this label.
2. Set the thermostat to lowest setting.
3. This appliance is equipped with an ignition device which automatically lights the pilot. Do not try to light the pilot by hand.
4. Remove battery cover, located on side of heater.
5. Remove batteries.
6. Wait five (5) minutes to clear out any gas. If you smell gas, **STOP!** Follow "B" in the safety information above on this label. If you do not smell gas, go to next step.
7. Install batteries.
8. Replace the battery cover.
9. Set thermostat to desired setting.
10. If the appliance will not operate, follow the instructions "TURNING OFF GAS TO THE APPLIANCE" and call your service technician or gas supplier.

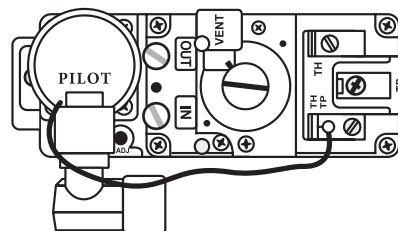

1018052-B 05/19

TROUBLESHOOTING CHART (FOR QUALIFIED SERVICE TECHNICIAN) - MAIN BURNER

Please follow the corrective actions in order.

SYMPTOM	POSSIBLE CAUSES	CORRECTIVE ACTION
Delayed Ignition	<ol style="list-style-type: none">1. Defective pilot assembly.2. Battery is low.	<ol style="list-style-type: none">1. Inspect pilot assembly for loose or broken components or wires. Replace. <i>Refer to parts list.</i>2. Replace batteries.
Failure to Ignite	<ol style="list-style-type: none">1. Defective pilot assembly.2. Battery is low.3. Optional "AC" adapter not connected or defective.4. Control module is defective.5. Manual reset blocked flue switch tripped.6. Tubing hasn't filled with enough gas to light the pilot. <i>(This issue can occur if the furnace has not been used recently).</i>7. Ignitor sparks + pilot light is on but burner will not come on.	<ol style="list-style-type: none">1. Inspect pilot assembly for loose or broken components or wires. Replace. <i>Refer to parts list.</i>2. Replace batteries.3. Check that the "AC" adapter is plug into the wall outlet and the control module. Replace if defective. <i>Refer to the parts list.</i>4. Replace the control module. <i>Refer to the parts list.</i>5. Reset switch. <i>(Please reference the owner's manual for your heater).</i>6. Refill the line with gas. <i>Initial startup of the IID system may take several minutes due to air in the gas line. The ignition control module will time out after 1 minute of sparking.</i> See step 2 on page 26.7. Ensure flame sensor (15) + flame sensor wire (16) are not contacting metal surface, such as heat shield.
Burner Won't Turn Off	<ol style="list-style-type: none">1. Control module is defective	<ol style="list-style-type: none">1. Replace the control module. <i>Refer to the parts list.</i>



**FOR ANY ADDITIONAL ASSISTANCE, PLEASE CONTACT OUR
CUSTOMER SERVICE DEPARTMENT: 855-589-5380**

BURNER FLAME ADJUSTMENT

(Stainless Steel Burner)

NOTES

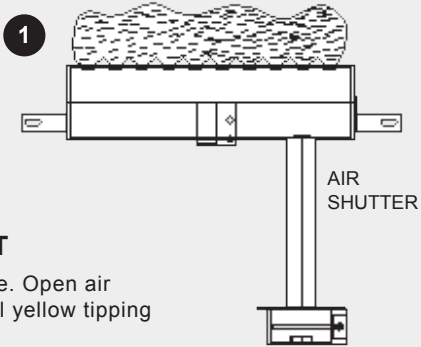

1. FLAME TOO SOFT

Yellow Flame. Open air shutters until yellow tipping disappears.

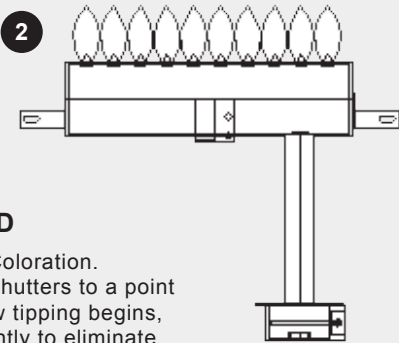

2. FLAME TOO HARD

Deep Blue Coloration. Closing air shutters to a point where yellow tipping begins, re-open slightly to eliminate yellow tipping. Air shutter adjustment is now correct.

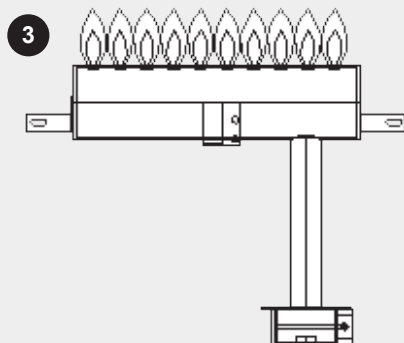

3. NORMAL FLAMES

NOTE: It is advised that the burner flames be checked at least twice during the heating season for any changes in burner characteristics. Vacuum burner compartment at start of heating season or as often as needed.

LIMITED WARRANTY

Cozy Heating Systems LLC warrants to the original user the accompanying product for the period specified herein, provided said product is installed, operated, maintained, serviced, and used according to the instructions and specifications accompanying the product. **AS OUTLINED IN OUR INSTRUCTIONS, ANY WARRANTY CONSIDERATIONS ARE CONTINGENT ON INSTALLATION BY A QUALIFIED INSTALLER (CONTRACTOR). SELF-INSTALLATION IS PROHIBITED AND WILL INVALIDATE YOUR WARRANTY.**

If within a period of one year from the date of installation of the product, any part supplied by the manufacturer proves to be defective due to workmanship or material, it will replace such part, provided parts have not been subjected to misuse, alteration, neglect, or accidents. The term of the warranty for the heat exchanger and burners is covered in Table A below. Any claim not made within ten (10) days after the expiration of the warranty period shall be deemed waived by the user.

The manufacturer shall have no liability or be required to perform any obligation under this warranty unless, when requested, the user returns, at the user's expense, the component or product claimed defective, to the manufacturer for inspection, to enable the manufacturer to determine if the claimed defect is covered by this warranty.

No charges for freight, labor or other expenses incurred in the repair, removal, or replacement of any product or component claimed to be defective, will be paid by the manufacturer to the user, and the manufacturer will not be liable for any expenses incurred, by the user, in remedying any defect in the product.

Service under this warranty is the responsibility of the installer. In the event service under this warranty is needed, the user of the product shall request such service directly from the installer. If the user is unable to locate the

installer, the user should write directly to the manufacturer, and the name of an alternative service source will be supplied.

The product safety registration card (packed inside the appliance) must be completed and returned to the factory.

THIS WARRANTY IS EXPRESSLY IN LIEU OF ANY OTHER WARRANTIES, EXPRESS OR IMPLIED (WHETHER WRITTEN OR ORAL). ANY IMPLIED WARRANTY OF MERCHANTABILITY OR OF FITNESS FOR A PARTICULAR PURPOSE IS EXPRESSLY LIMITED TO THE DURATION OF THE MANUFACTURER'S EXPRESS, WRITTEN WARRANTY.

UNDER NO CIRCUMSTANCES SHALL THE MANUFACTURER BE LIABLE FOR ANY SPECIAL, INDIRECT OR CONSEQUENTIAL DAMAGES OR EXPENSES ARISING DIRECTLY OR INDIRECTLY FROM ANY COMPONENT OR FROM THE USE THEREOF. THE REMEDIES SET FORTH HEREIN SHALL BE THE EXCLUSIVE REMEDIES AVAILABLE TO THE USER AND ARE IN LIEU OF ALL OTHER REMEDIES.

SOME STATES DO NOT ALLOW LIMITATIONS ON HOW LONG AN IMPLIED WARRANTY LASTS, SO THE ABOVE LIMITATIONS MAY NOT APPLY TO YOU.

SOME STATES DO NOT ALLOW THE EXCLUSION OR LIMITATION OF INCIDENTAL OR CONSEQUENTIAL DAMAGES, SO THE ABOVE LIMITATIONS OR EXCLUSIONS MAY NOT APPLY TO YOU.

THIS WARRANTY GIVES YOU SPECIFIC LEGAL RIGHTS, AND YOU MAY ALSO HAVE OTHER RIGHTS, WHICH VARY, FROM STATE TO STATE.

TABLE - A

WARRANTY PERIOD

PRODUCT	TUBES / HEAT EXCHANGER	BURNERS
Cozy Gas Fired Floor Furnace	10 Years	10 Years
Cozy Gas Fired Wall Furnace	10 Years	10 Years
Cozy Gas Fired Vented Console Heater	10 Years	10 Years
Cozy Gas Fired Direct Vent Heater	10 Years	10 Years
Cozy Gas Fired Counterflow Furnace	10 Years	10 Years
Cozy Gas Fired Counterflow Direct Vent Furnace	10 Years	10 Years
Cozy Gas Fired Hi-Efficient Direct Vent Wall Furnace	10 Years	10 Years
Cozy Fan-Type, Direct Vent Through-The-Wall Gas Heater	10 Years	10 Years

COZY HEATING SYSTEMS, LLC
3230 INDUSTRIAL PARKWAY. – JEFFERSONVILLE, IN 47130