



Mini Cooper Push Car



Owner's Manual and Assembly Instructions

Model #: ZW455AC-R-F

Read and understand the entire manual before assembly and operation. The vehicle must be assembled by an adult who has read and understands the instructions.

Made in China.

Styles and colours may vary. Do not return to store. Visit us online at www.ariachild.com for assistance and replacement parts.

Save this manual with your sales receipt.



MINI Cooper S Push Car is manufactured by Paragon Child Products Co. Ltd, (Goodbaby Group). The MINI trademarks are used under license from BMW AG. MINI name and associated logos are trademarks of BMW AG.

Introduction

Thank you for purchasing the MINI Cooper S Push Car. We hope the rider enjoys it for miles to come. Please read this instruction guide carefully before assembling and operating the vehicle.

Please contact Aria Child Customer Service with any questions.

Hours: 9 AM - 5 PM (CST), Monday - Friday

Web: www.ariachild.com

Email: customerservice@ariachild.com

Phone: 1-888-982-9309

Specifications:

AGE	18 - 48 months
MAX WEIGHT	20 kg (44 lb)
PRODUCT SIZE	108 x 45.5 x 95 cm 42.5 x 17.9 x 34.7 in.

IMPORTANT!

DO NOT RETURN THIS ITEM
TO THE STORE!

Email or call Customer Service if you need assistance or replacement parts.

customerservice@ariachild.com
1-888-982-9309

Read this entire manual to ensure proper assembly and safe operation of the vehicle.

This page is intentionally left blank.

Safety.....	6
Parts List	8
Assemble the Wheels.....	9
Steering Wheel/Windshield Assembly...10	
Mirror/ Seat/Push Bar Assembly	11
Batteries and Operating Instructions	12
General Care	13
Service and Repairs	14
Warranty	15
Product Registration	16



WARNING: SAFETY RIDING RULES

The user must follow all safety rules and guidelines, or serious injury or death may occur to the user.

- Always use common sense and safe practices when using the vehicle. The user must be at least 18 months old and weigh no more than 20 kg. This product is not suitable for children 4 years and older due to insufficient strength and size of the product.
- This product contains small parts that are for adult assembly only. Keep small children away when assembling. Remove and dispose of all protective material and plastic bags before assembly.
- US Only: Riders must always wear a fitted helmet that complies with U.S. Consumer Product Safety Commission (CPSC) Standard CFR 1203.
- Only sit on the seat in the vehicle.
- Do not allow more than one rider.
- Do not overload the vehicle. Do not remove the weight restriction decals.
- Do not pull the vehicle with another vehicle or similar device.
- Keep body parts such as hands, legs, hair and clothing away from moving parts. Moving parts can cause serious injury.
- Always wear shoes in the vehicle.
- Make sure that the child's feet rest in the footrests before pushing the car.
- Fasten seat belt properly before use.
- Do not operate near streets or motor vehicles.
- Do not operate near drop-offs such as steps, steep inclines or hills. Operate on relatively level ground.
- Do not operate near water, swimming pools or other fluids.
- Do not operate in dangerous weather conditions such as rain or snow.
- Do not operate outside at night
- Do not operate near loose dirt, mud, sand or fine gravel.
- Do not operate near flammable vapours (gasoline, paint thinner, acetone, etc.).
- Always use the vehicle in a safe, secure environment with adult supervision.
- Periodically check hardware and tighten if necessary. Replace worn or broken parts immediately.
- **RISK OF FIRE.** Do not bypass.



WARNING: BATTERY SAFETY

- Tampering with or modifying the electric circuit system may cause shock, fire or explosion. It could permanently damage the system. Keep the charger housing closed to prevent exposed wiring, which may cause electric shock.

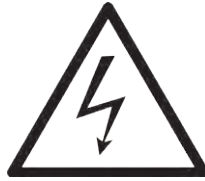

- When replacing AAA batteries, always replace both batteries at the same time. Do not mix old batteries with new batteries or batteries of different types.
- Do not mix alkaline, standard (carbon-zinc), or rechargeable (nickel-cadmium) batteries.
- Only use the batteries specified by the manufacturer.
- Non-rechargeable batteries are not to be recharged.
- Rechargeable batteries are only to be charged under adult supervision.
- Rechargeable batteries are to be removed from the toy before being charged.
- Be sure to insert the batteries correctly and always follow the toy and battery manufacturer's instruction.
- Weak or exhausted batteries are to be removed from the toy.
- Do not short-circuit the supply terminal.
- Remove batteries if product is to be left unused for a long time.



WARNING: ADULT SUPERVISION REQUIRED

- Before using the vehicle, the rider must understand the vehicle controls and safety issues.
- It is the responsibility of the adult to educate the child and to determine if the child is capable of understanding the vehicle controls.
- An adult must ALWAYS directly supervise the use of this vehicle.
- NEVER leave a child unsupervised in the vehicle.

8 Parts List

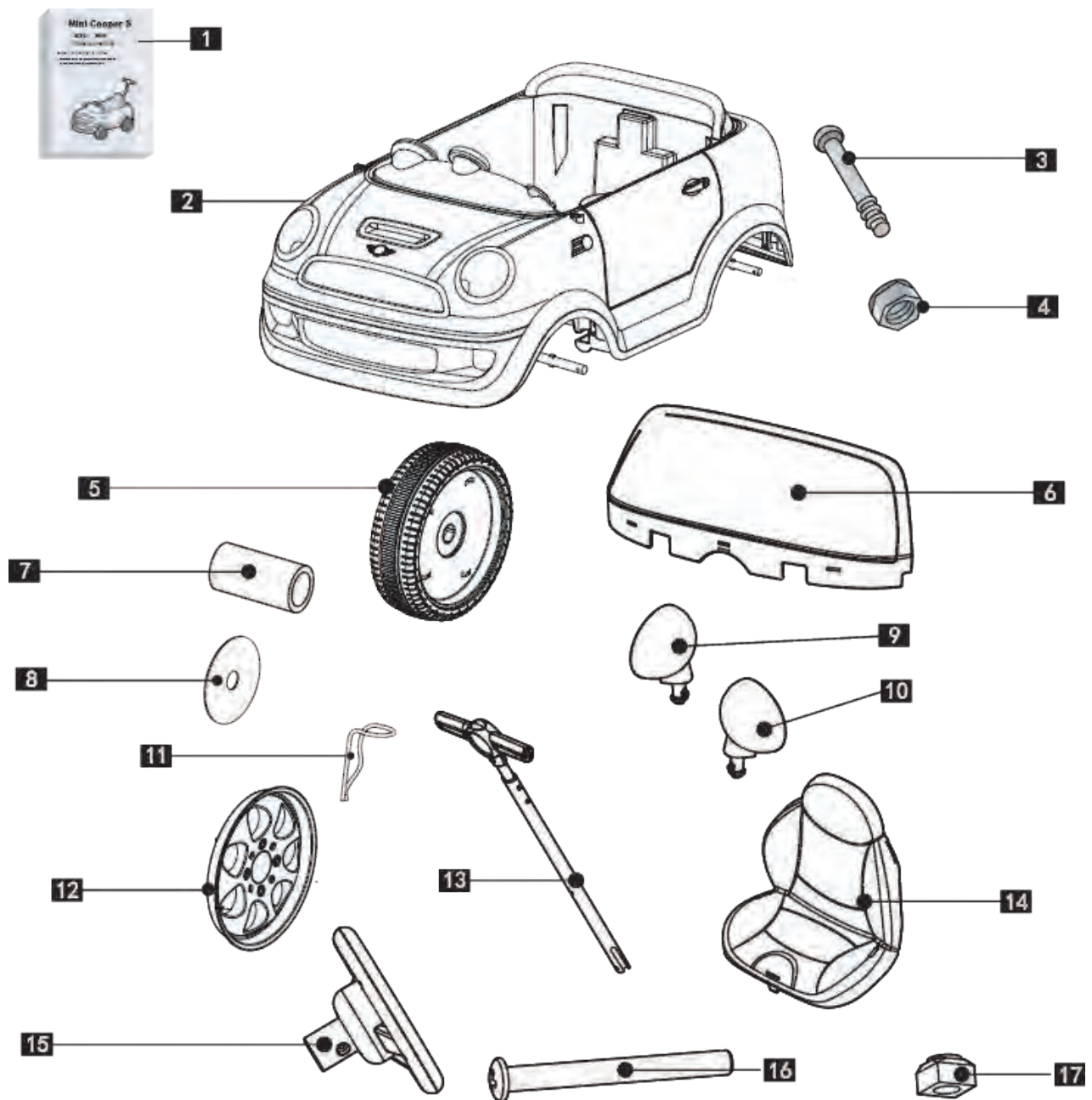

- | | |
|--------------------------------|-------------------------|
| 1. Manual | 10. Side Mirror (right) |
| 2. Car Body | 11. Snap Pin (4) |
| 3. Steering Wheel Screw | 12. Rim (4) |
| 4. Steering Wheel Nut | 13. Push Bar |
| 5. Wheel (4) | 14. Seat |
| 6. Windshield | 15. Steering Wheel |
| 7. Rear Orientation Sleeve (2) | 16. Push Bar Screw |
| 8. Washer | 17. Push Bar Square Nut |
| 9. Side Mirror (left) | |

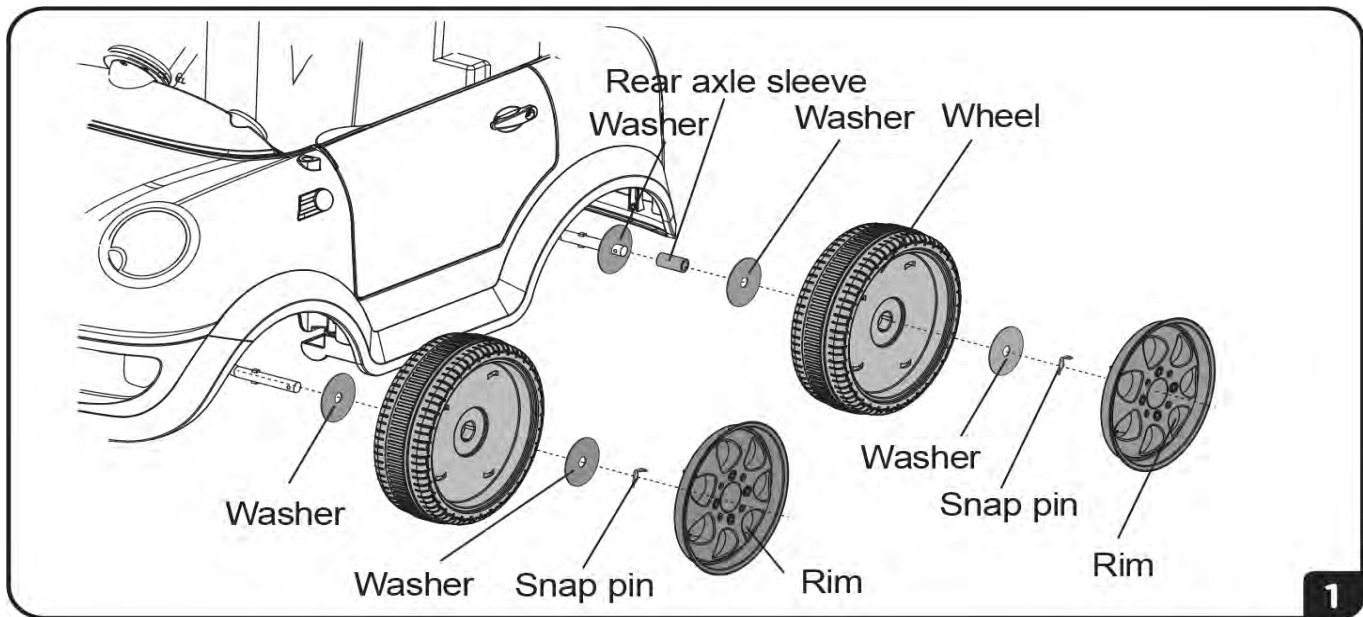

Front Wheels

1. To assemble the front wheels, place a washer on the front axle.
2. Slide the wheel onto the axle, ensuring that the holes for the rim are facing out.
3. Slide another washer onto the axle, then insert the snap-pin into the hole on the axle to secure the wheel in place.
4. Snap the rim onto the wheel. Repeat the above steps for the opposite wheel.

Rear Wheels

1. To assemble the rear wheels, place a washer on the rear axle.
2. Slide the rear wheel orientation sleeve onto the rear axle.
3. Slide a washer onto the axle.
4. Slide the rear wheel into the axle, ensuring that the holes for the rim are facing out.
5. Slide on another washer, then insert the snap-pin into the hole on the axle to secure the wheel in place. Repeat for the opposite wheel.

10 Steering Wheel/Windshield Assembly

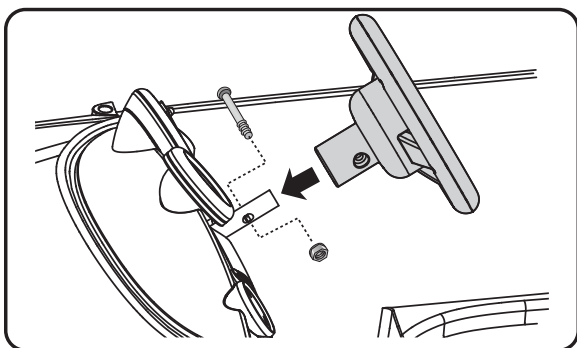

Assemble the Steering Wheel

1. Remove the steering wheel screw and steering wheel nut from the steering wheel.
2. Slide the steering wheel onto the steering rod.
3. Align the holes of the steering wheel with the holes on the rod.
4. Insert the screw into the holes on the steering wheel and steering rod. Then insert the nut on the other side to attach the steering wheel and the steering rod.
5. Tighten with a Phillips screwdriver (not included) .

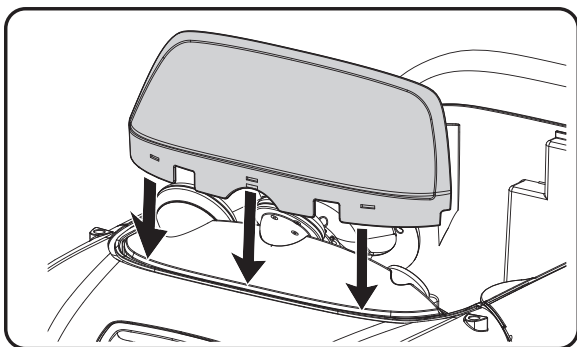

Assemble the Windshield

1. Align the slots of the windshield and the dash board.
2. Push the top of the windshield until it clicks into place to complete the assembly.

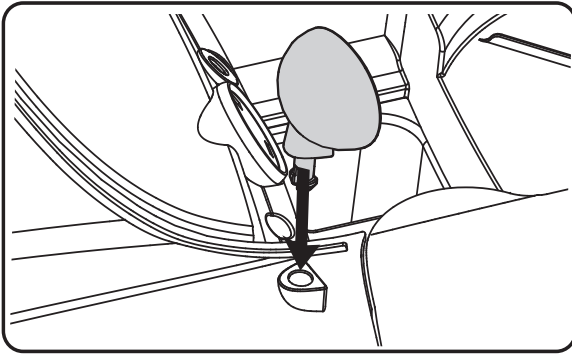

Side Mirror Assembly

1. Insert the mirror into the slot on the side of the body.
2. Push it into the slot until you hear a click to complete the assembly. Repeat on the other side.

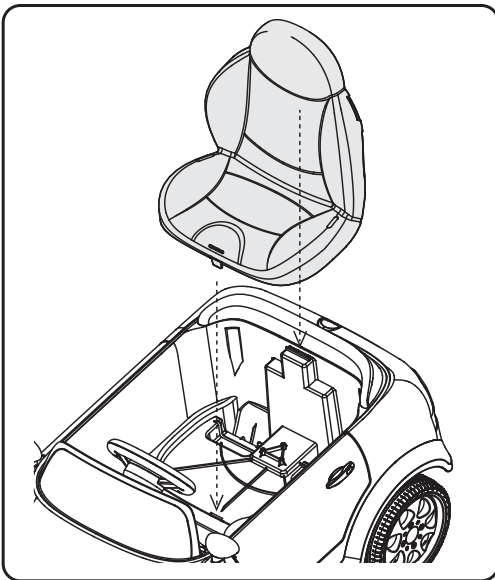

Assemble the Seat

1. Align the buckles of the seat with the slots on the car body.
2. Press the seat until you hear the click to complete the assembly.

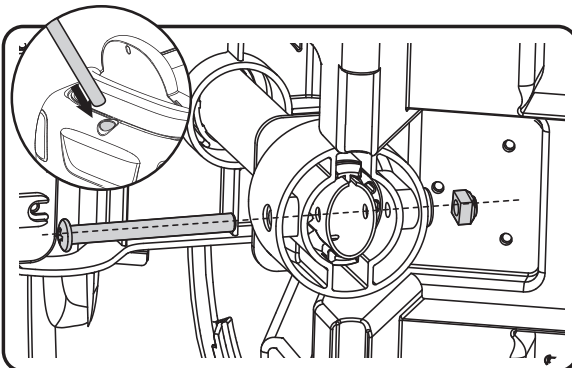

Assemble the Push Bar

1. Press the push bar into the slot at the rear end of the body.
2. Make sure that the round hole of the fixed part faces toward the back, and the square hole toward the front.
3. Align the hole of the fixed part with the hole of the end of the push bar. Fit it with the screw and tighten with a screwdriver to secure.

12 Batteries and Operating Instructions

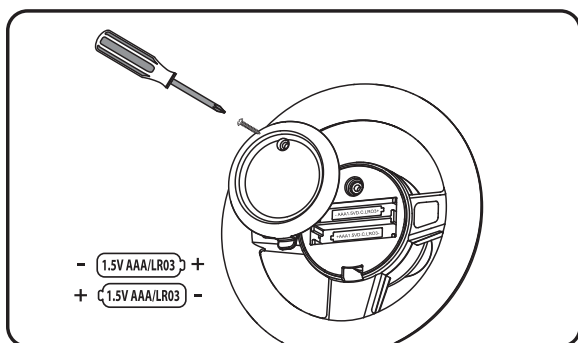

Insert Batteries

1. Open the battery cover using a Phillips screwdriver (not included). Insert 2 AAA batteries with the correct polarity, then resecure the cover using a screwdriver.

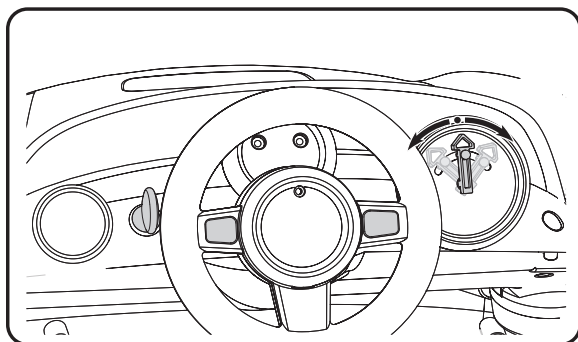

To Operate:

1. Press buttons on steering wheel to hear horn and engine sounds.
2. Turn wheels right or left with the steering wheel.
3. Rotate the key to hear a play clicking sound.
4. Speed pointer can be moved.

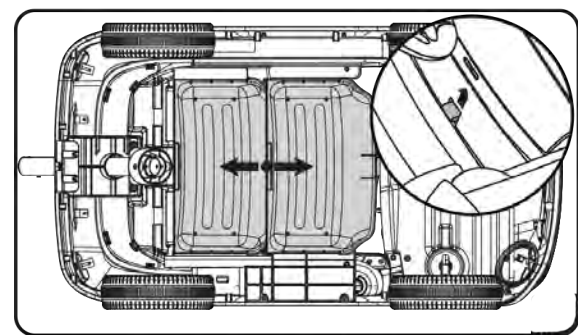

Storable footrest

1. Pull up the release clip inside the push car
2. Then slide the footrest backward to allow child to use his/her feet to move the car.

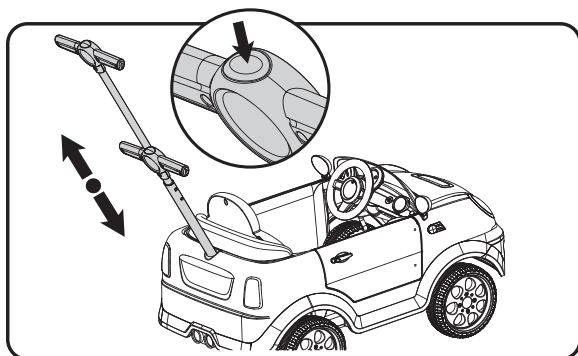

Adjustable handle bar

1. Push the button on top of the handlebar to adjust the height of the bar.

- Regularly inspect all vehicle parts to ensure they are in good working condition.
- Remove any damaged parts and immediately contact Customer Service for replacement parts. See Service and Repairs on Page 24 for more information.
- DO NOT operate the vehicle if there are any damaged parts.
- Carefully clean the vehicle with a damp cloth and mild soap. Do not get water in or near any electrical parts. Do not wash the vehicle with a hose.
- Store the vehicle indoors or use a tarp to cover it. Keep away from stoves, heaters, or other sources of heat.

Do not return this vehicle to the store.

If your product requires service, repairs or replacement parts, please visit us online at www.ariachild.com

Or contact us at:

Phone: 1-888-982-9309

Email: customerservice@ariachild.com

Web: www.ariachild.com

Hours: 9 AM - 5 PM (CST), Monday - Friday

For a list of available replacement parts, please visit www.ariachild.com.

- One-year limited warranty from the date of purchase with proof of purchase from an Aria Child certified retailer.
- This one-year limited warranty covers the push car vehicle against defects in materials and workmanship to the original purchaser. Proof of purchase receipt from an Aria Child certified reseller is required.
- This warranty covers normal use and does not cover the Aria Child vehicle if deemed damaged by unreasonable use, modification, neglect, accident, abuse, misuse, improper service or other causes not arising out of defects in materials or workmanship. Evidence of any attempt at consumer repair will void this warranty.
- This warranty does not cover, and is not intended to exclude any liability on the part of Aria Child, whether under this warranty or implied by law for any indirect or consequential damages for breach of warranty. Some states or provinces may not allow the exclusion or limitation so this limitation may not apply to you.

Should you need service or assistance with your vehicle during the warranty period:

- Please do not return vehicle to the store.
- Visit us online at www.ariachild.com

or

- Call Aria Child Customer Service at 1-888-982-9309

Note: This warranty gives you specific legal rights. You may also have other rights that may vary from state to state or province to province.

Please save your original sales receipt.

16 Product Registration

Fill out the form below and mail it to:

Aria Child, Inc.
1131 W Blackhawk St.
Second Floor
Chicago, IL 60642

OR fill out the form online at **www.ariachild.com**

We will use the information provided only for your warranty. We will not sell, rent or share your personal information.



Product Registration

First Name: _____ Last Name: _____ Title: _____

Address: _____

City: _____ State/Province: _____ Postal Code: _____

Email: _____ Phone: _____

Date of Purchase: _____

The following product information is on the cover of the owner's manual.

Product Name: _____ Model Number: _____

Serial Number: _____ Place of Purchase: _____

Questions or comments? Contact us at **www.ariachild.com** or **1-888-982-9309**