

88 5053 30 Table

IMPORTANT NOTE

Carefully remove all the parts from the carton and put them individually on a soft cloth to prevent scratches or other damage occurring to the parts.

We have taken great care in the design of this product and request that you carefully and strictly follow our assembly instructions to ensure a completed product as it was designed.

Home
Styles



Part List



**A.
Top**
1 pc.



**B.
Shelf**
1 pc.

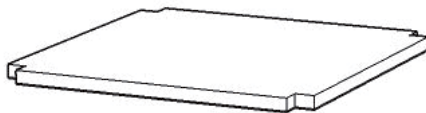

**C.
Base**
1 pc.



**D.
Stretcher**
2 pcs.



**E.
Stretcher**
2 pcs.

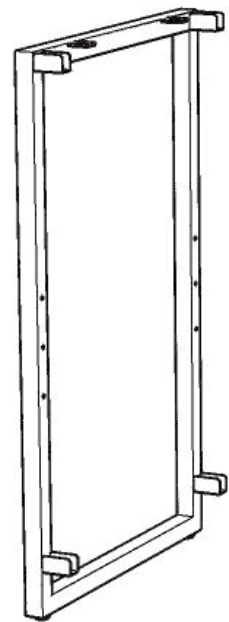

**F.
Side Frame**
2 pcs.

Hardware List



Hex Wrench
1 pc.



Small Hex Wrench
1 pc.



**M6x16
Head Cap Bolt**
24 pcs. (+1 extra)



Spring Washer
24 pcs. (+1 extra)

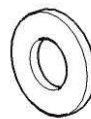

Flat Washer
24 pcs. (+1 extra)



**M4x38
Wood Screw**
4 pcs. (+1 extra)



Adjustable Pin
4 pcs. (+1 extra)

Tools required for assembly : Phillips screwdriver, Level

Home Styles Consumer Assistance : www.homestyles-furniture.com,
servicedesk@homestyles-furniture.com, 888-680-7460, 877-831-0319

IMPORTANT

- * Please keep Hex Wrench in a safe place as you may need to tighten up the Head Cap Bolts in the future.
- * Do not tighten all the Head Cap Bolts until each part is properly assembled.
- * Use a soft cloth between these parts and the floor.
- * Please make sure unit is level before tightening these screws.
- * After assembly, item must be level to work properly. Use the included adjustable levelers to level.

STEP 1

Attach Stretchers (D) and (E) to Side Frame (F) with Flat Washers, Spring Washers and Head Cap Bolts, tightening the bolts only half way. (See Figure 1)

Attach Side Frame (F) to unit with Flat Washers, Spring Washers and Head Cap Bolts, tightening the bolts only half way.

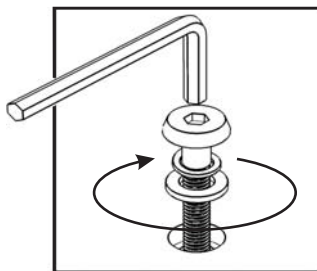
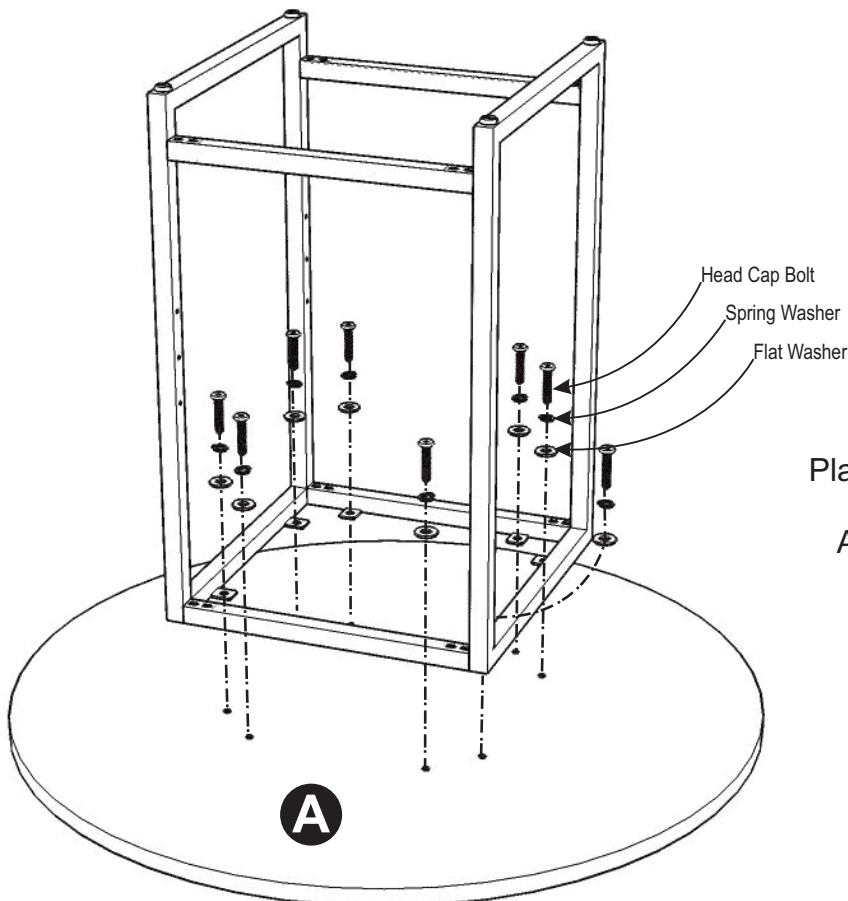
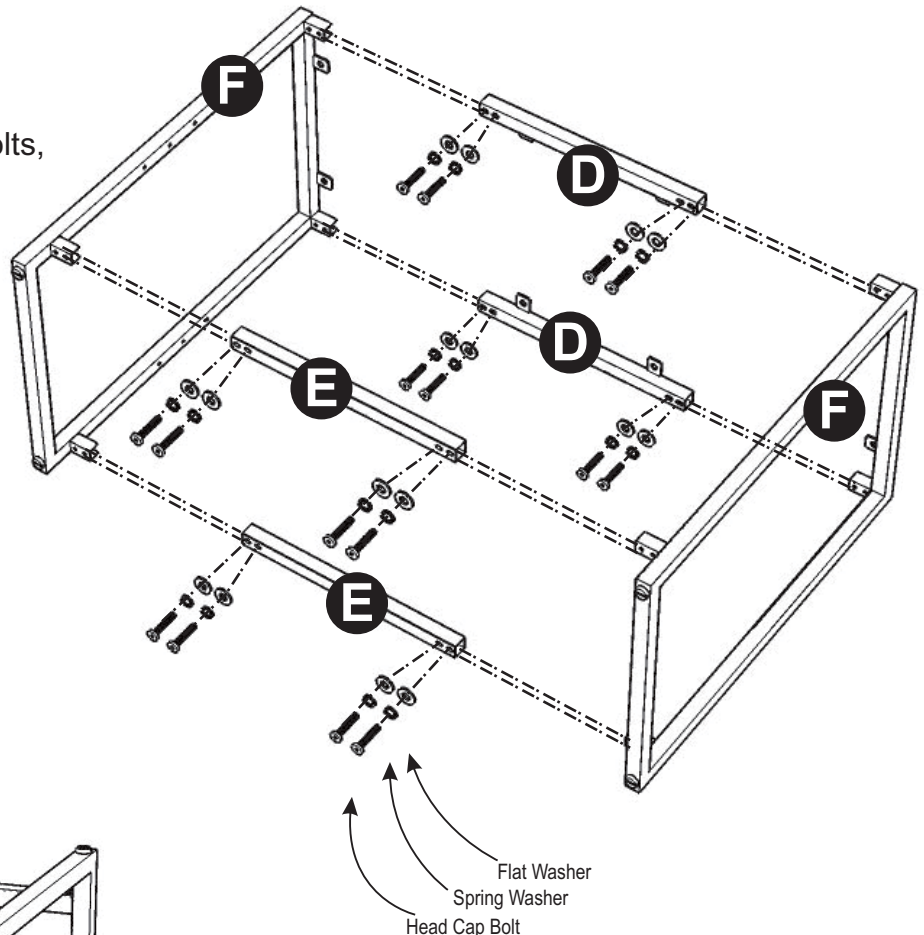

Figure 1



STEP 2

Place Top (A) upside down on a soft cloth.

Attach unit to Top (A) with Flat Washers, Spring Washers and Head Cap Bolts, tightening the bolts only half way.

Tighten all Head Cap Bolts.

STEP 3

Attach Shelf (C) to unit with Wood Screws.
(See Figure 2)

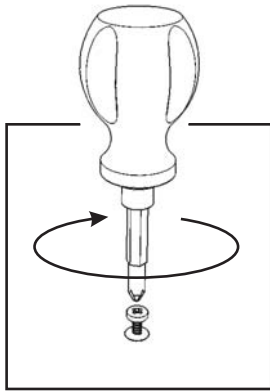

Figure 2

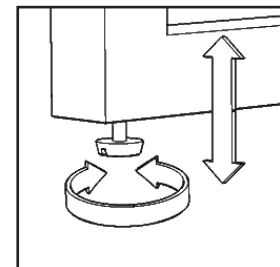
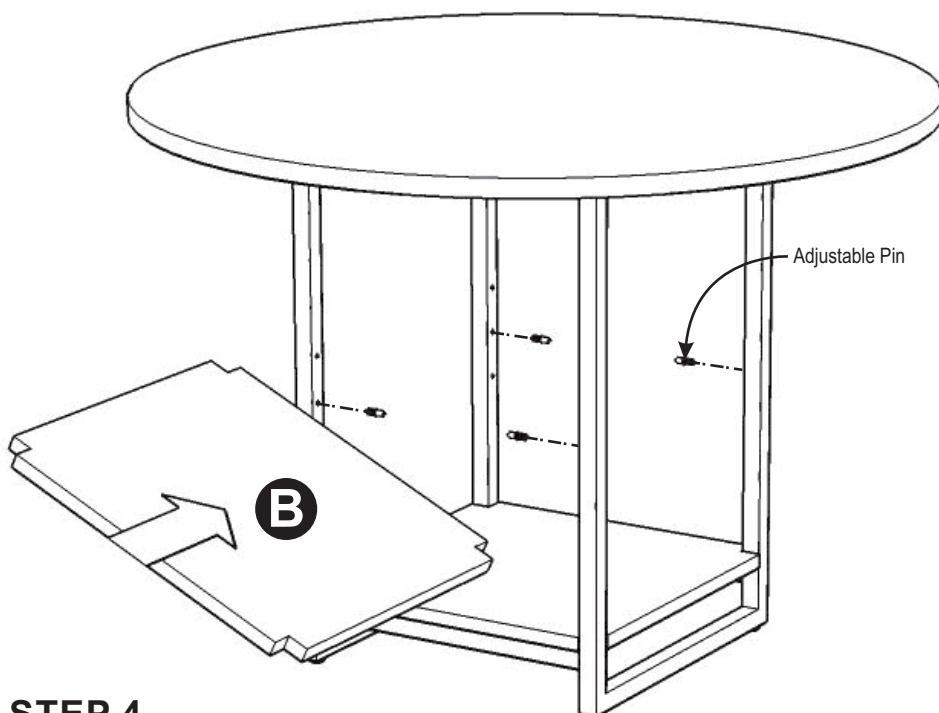
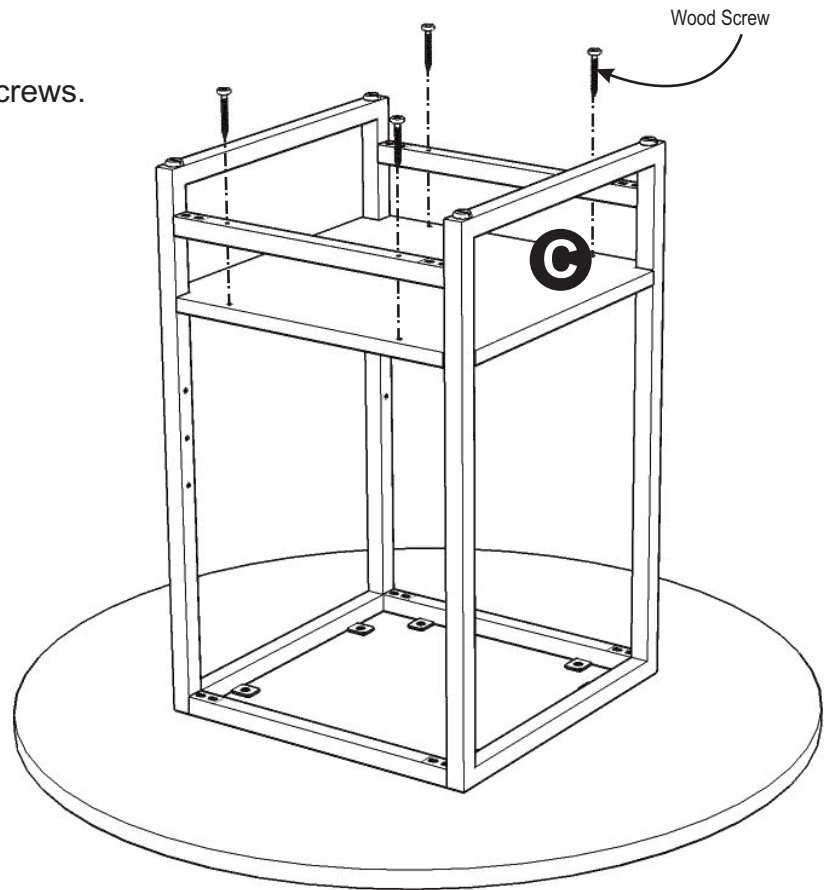

Figure 3

STEP 4

Turn the unit over to its' upright position.

Insert Adjustable Pins into unit at the desired level.

Place Shelf (B) into position.

To level the unit, adjust the adjustable levelers on the bottom of unit.
(See Figure 3)