

INSTRUCTIONS

1. Please count and make sure all pieces are present before assembly.
2. The pole pieces are delicate. To prevent damage, do not use excessive force.
3. Assemble crystal puzzle by putting the puzzle pieces together in the order shown below.
4. Missing a piece? Email [info@ugames.com](mailto:info@ugames.com) or call (415) 503-1600 with missing piece number.

Plane

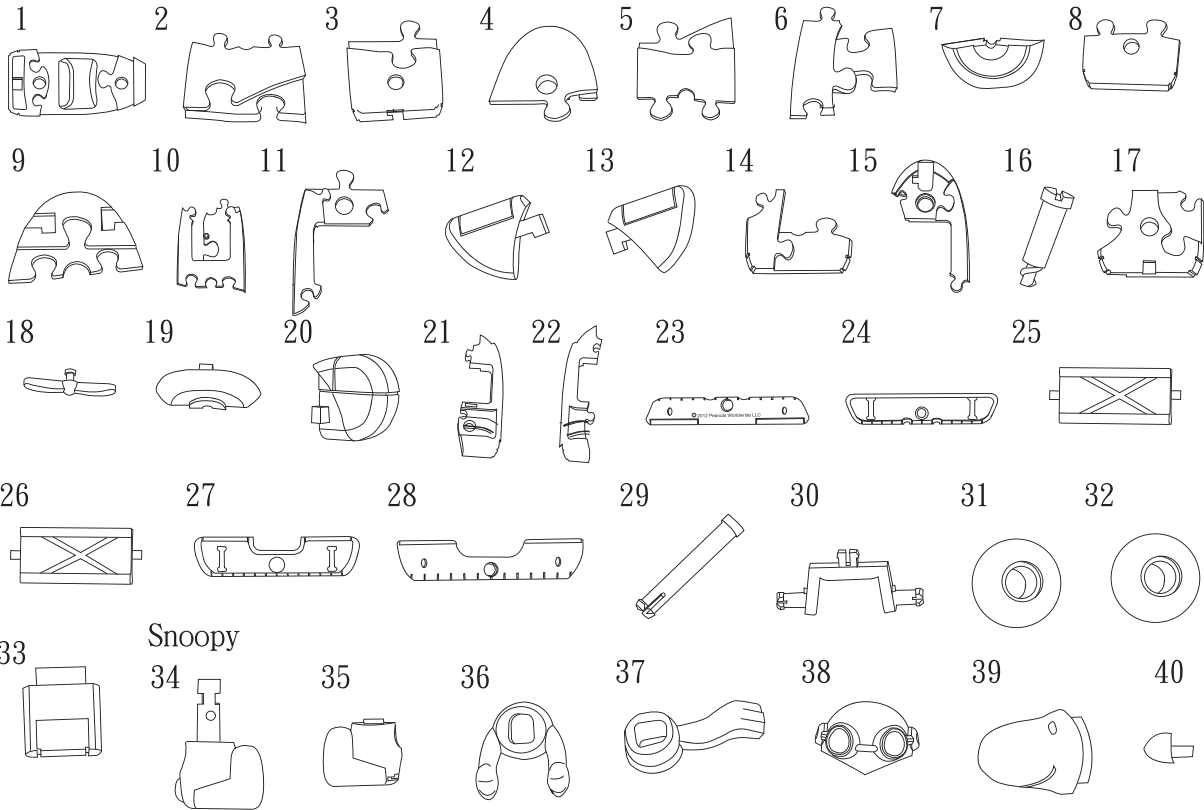

HINTS

**1**

The 4 wing shapes are a little different. Each one has a specific position.

**2**

One side of piece #30 has curved parts to match pieces #23 and #24. Please note when inserting in the plane.

**3**

Lock the tail by screwing the small pole piece #16 with the key enclosed. Lock the front by pressing piece #29 through the bottom of the wing piece #23.

**4**

Insert nose piece #40 to match the pin and hole shape.

