



ITEM: SP-AZ081\*\*

## ANZZI CICI SHOWER PANEL INSTALLATION & OPERATION MANUAL

V1.0

09/07/2024

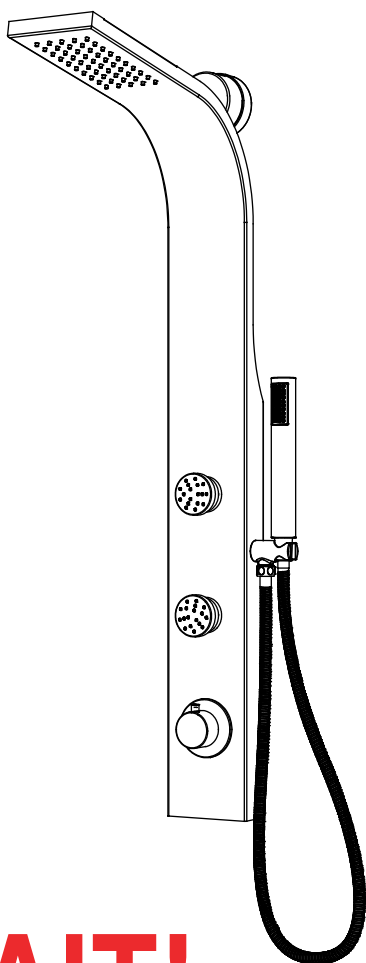

# DON'T WAIT! REGISTER NOW!

Register your product within 90 days to ensure your product is recognized as an official purchase and is eligible for warranty coverage.

Register online at <https://anzzi.com/pages/register> or scan the QR code at PG. 2.



## PRODUCT REGISTRATION\*

**IMPORTANT:** Warranty will not be recognized unless product is registered.

Register online at <https://anzzi.com/pages/register> or Scan the QR code below.

Registering online is fast, secure, and ensures we receive your information.

1

USE YOUR PHONE CAMERA  
TO SCAN THE QR CODE

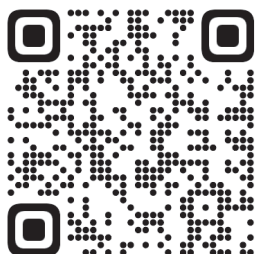

2

FILL IN A QUICK  
REGISTRATION FORM

Thank you for your purchase!

Registering your products ensures you maximize your warranty benefits and receive prompt service and support.

Name\*

Email\*

City\*

Order #\*

Installer Name

Model Purchased\*

Installer Phone Number

Customer Age Range

Submit

3

CLICK SUBMIT AND  
ENJOY PEACE OF MIND

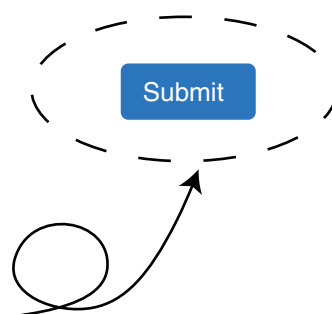

Need help? For technical support call **305-614-4070** or visit us at **[www.ANZZI.com](http://www.ANZZI.com)**

# PARTS LIST



IAPMO IGC 154  
ASME A112.18.1/  
CSA B125.1

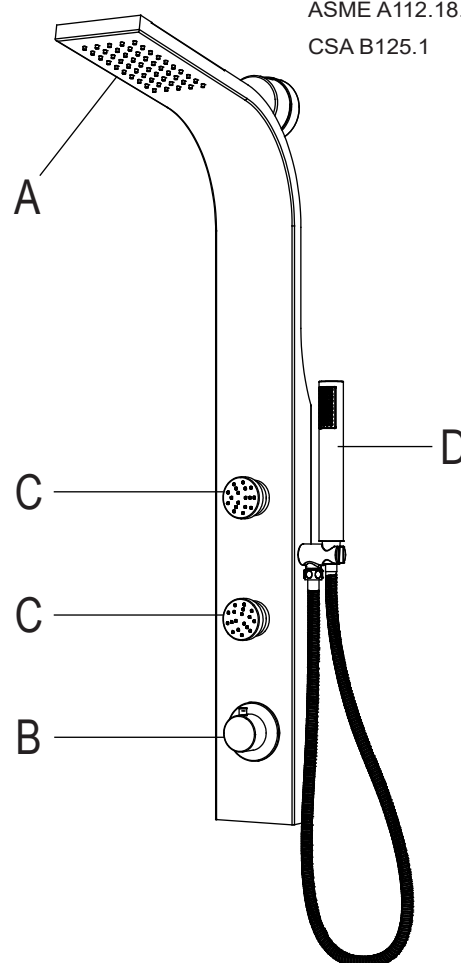
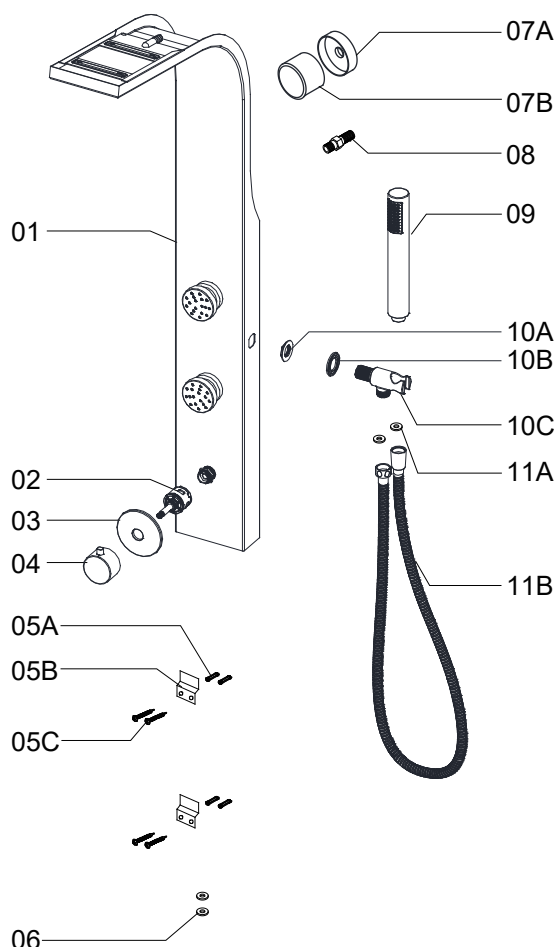

Part	Description	Qty	Part	Description	Qty
[01]	Shower panel	1	[07B]	Cap	1
[02]	Diverter Cartridge	1	[08]	Nipple	1
[03]	Diverter Flange	1	[09]	Hand shower	1
[04]	Diverter Handle	1	[10A]	Nut	1
[05A]	Plug	4	[10B]	Washer	1
[05B]	Bracket	2	[10C]	Holder	1
[05C]	Screw	4	[11A]	Washer	2
[06]	Washer	2	[11B]	Shower hose	1
[07A]	Base	1			

A. Shower Head  
B. Diverter  
C. Body Jets  
D. Hand Shower

## PRODUCT FEATURES

- Adjustable Body Jets
- Integrated showerhead design
- Single diverter controls water flowing between Rain Shower/ Body Jets/ Hand Shower
- Rust-free materials

# BEFORE YOU START

## Recommended Items

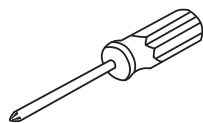

Screwdriver

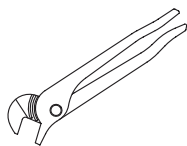

Channel Locks



Goggles

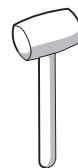

Rubber hammer

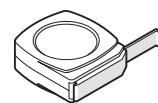

Tape

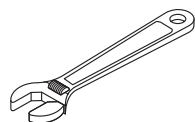

Adjustable Wrench



Teflon tape

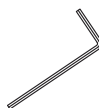

Allen key



Pencil

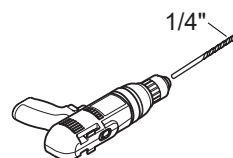

Electric drill

## Read Before Using Your New Shower Panel

Congratulations on purchasing our Shower Panel. Your new shower panel will be a great addition to your bathroom for years to come. Our luxury Shower Panel brings a spa experience into your life in the comfort of your personal bathroom. Adding the shower panel as a modification to your present shower will allow you to enjoy the pleasures of massaging body spray jets. Furthermore, the shower panel will operate with your existing plumbing supply lines with standard line pressure and flow rates. Before using our Shower Panel, please read this document carefully and thoroughly.

The instructions and safety information in this document are essential to the safe operation of your new unit. Additionally, neglect or improper or incorrectly performed installation, maintenance or repair, including failure to follow the applicable care and cleaning instructions may affect your new product's warranty.

## IMPORTANT

1. Prior to installation, please make sure your package is intact. Look over the product and contact your dealer or ANZZI if you find damaged sections.
2. In order to install this shower panel, simple understanding of plumbing techniques will be necessary. Please contact your dealer or a professional plumber if you are unfamiliar with plumbing techniques or have questions.
3. This shower panel is designed for indoor use only. It is not intended for outdoor or other uses.
4. Product could function between 20-125 psi supply pressure. Install a pressure reducing valve at the inlets if your water pressure is too high.
5. Check all connections for leaks. Retighten if necessary, but do not overtighten.



## Mounting the Brackets of the Shower Panel

-It is recommended that the shower panel be mounted at a height that will make the unit accessible to people with varying heights. Establish the precise height and position of the unit on the wall. We recommend to leave a 6" (15cm) space between the shower head and the average height of the people in the house as well as a minimum distance of 1" (2.5cm) from the ceiling. (Figure A)

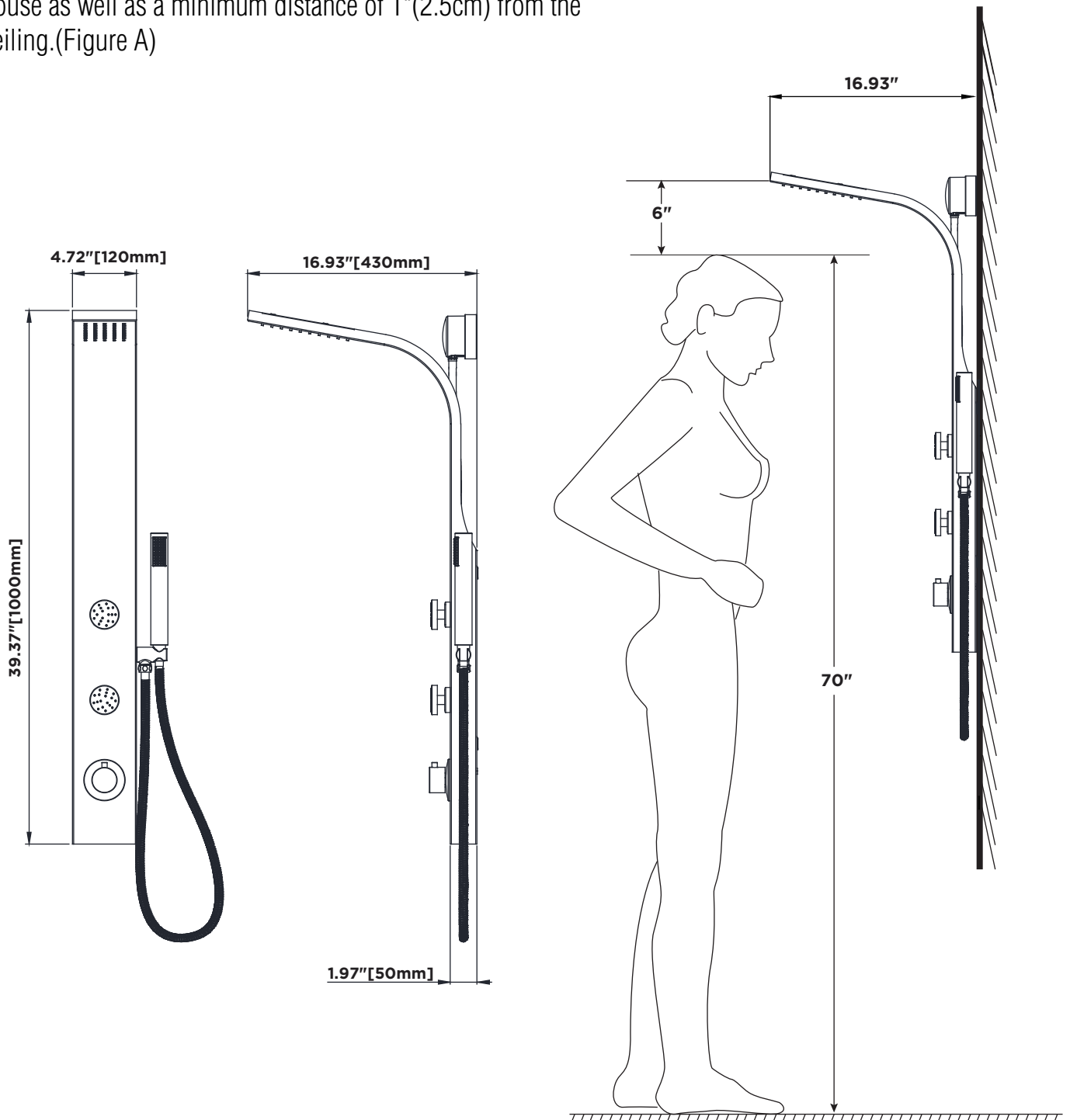

**Figure A**

# STEP 1

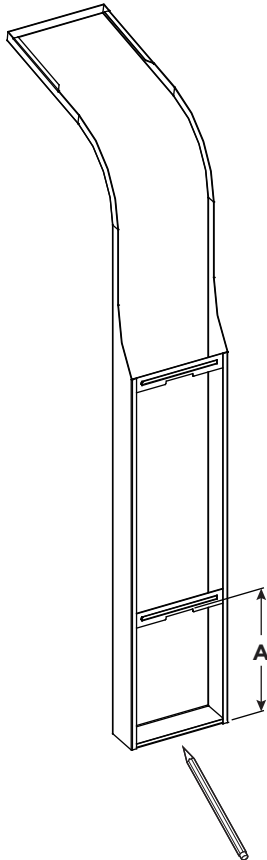

Fig 1.1

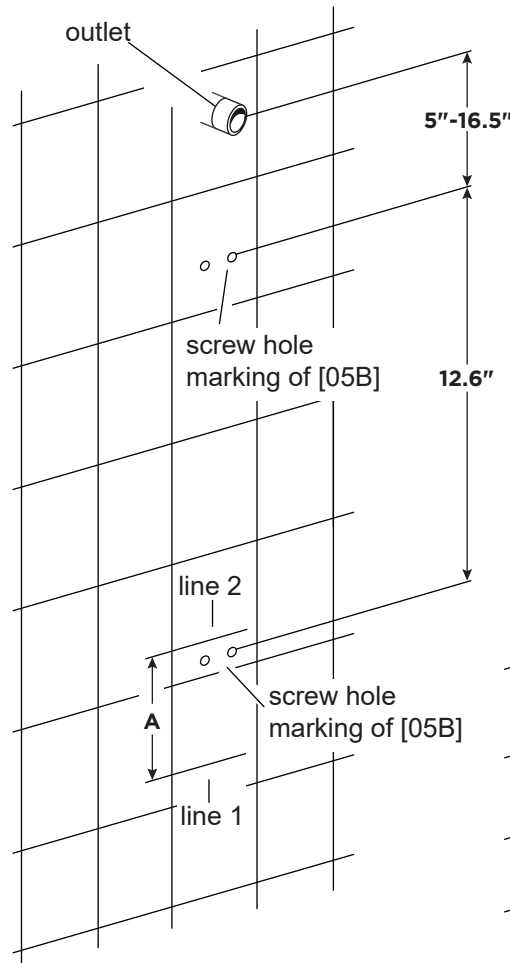

Fig 1.2

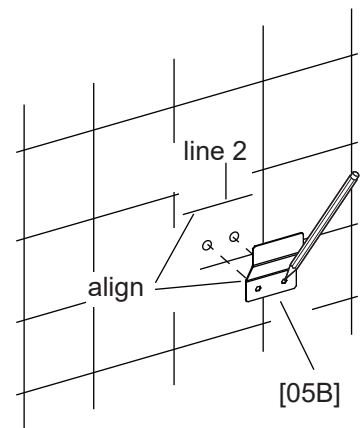

Fig 1.3

- 1-1** Position the shower panel on the wall according to figure A at page 5. Draw line 1 on the wall along the bottom of shower panel. (Fig 1.1)
- 1-2** Measure the distance A between the bottom of the shower panel and the lower back bracket. Then draw line 2 above the line 1 at the distance A. (Fig 1.2)
- 1-3** Position the **Bracket [05B]** on the wall with its lower corner align with line 2 and center with the outlet. Then mark the wall through the screw holes of the **Bracket [05B]**. (Fig 1.3)
- 1-4** Position another **Bracket [05B]** above the previous one on the wall where the distance between screw holes of it to the marked place is 12.6" and center with the outlet. Then mark the wall through the screw holes of the **Bracket [05B]**. (Fig 1.2)

## STEP 2

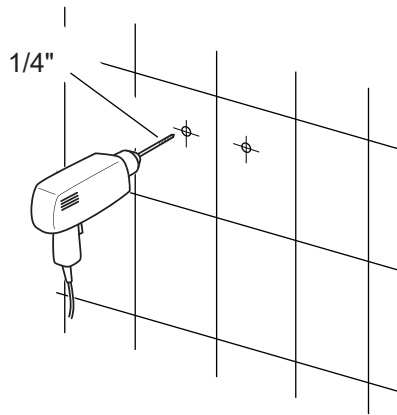

Fig 2.1

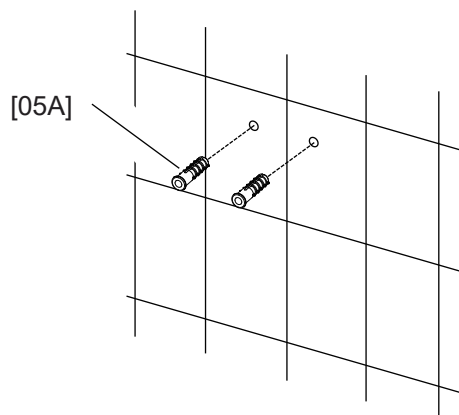

Fig 2.2

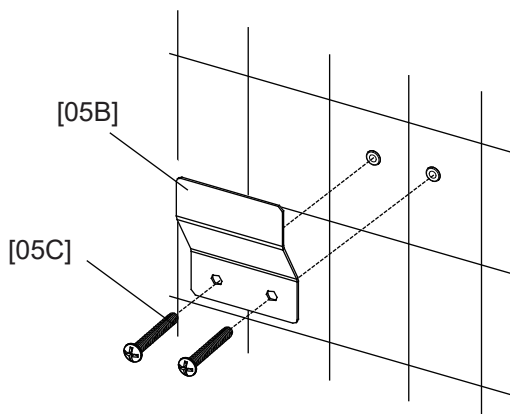

Fig 2.3

**IMPORTANT** Before drilling any holes for the shower panel brackets, be sure there are no hidden cables or pipelines aligned with the desired drilling position.

**2-1** Drill 1/4" holes at the marked positions. (Fig 2.1)

**2-2** Install the **Anchors [05A]** . (Fig 2.2)

**2-3** Secure the **Brackets [05B]** with **Screws [05C]**. (Fig 2.3)

## STEP 3

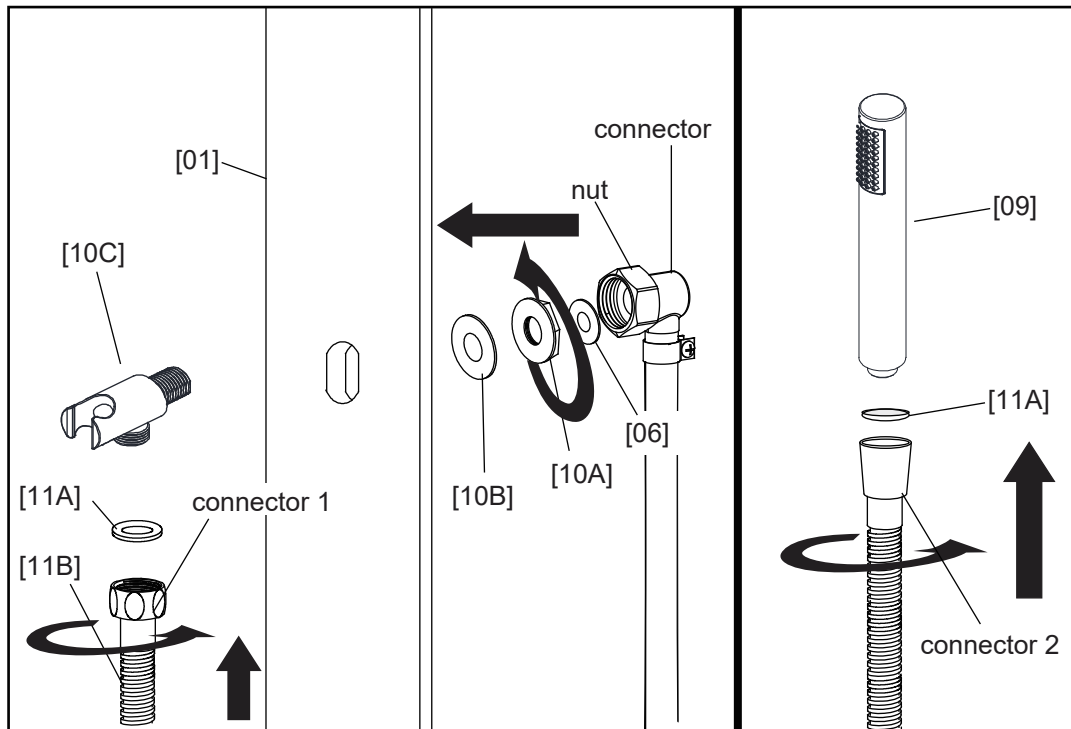

Fig 3.1

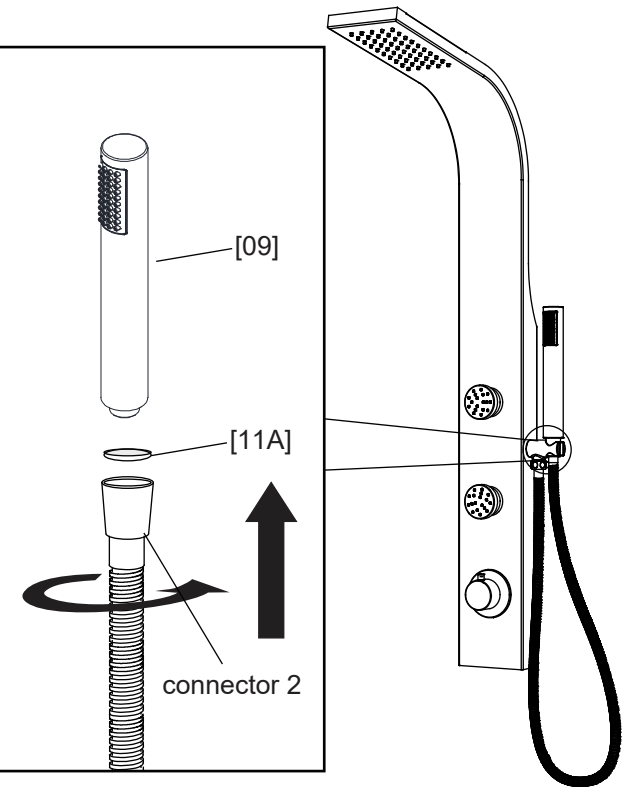

Fig 3.2

- 3-1** Install the **Shower Holder [10C]** through the hole from the right of **Shower Panel [01]**. Make sure the shower hose connector faces downward. (Fig 3.1)
- 3-2** Slide the **Washer [10B]** to the **Shower Holder [10C]** from the inside of **Shower Panel [01]** and secure it by tightening the **Nut [10A]**. Do not over tighten. (Fig 3.1)
- 3-3** Install the **connector** with **washer [06]** in it to the **Shower Holder [10C]**. Then tighten the **nut** of the **connector** to secure. (Fig 3.1)
- 3-4** Connect the **connector 1** of **Shower Hose [11B]** to **Shower Holder [10C]** and **connector 2** to **Hand shower [09]**. Tighten the connectors to secure. Make sure there are washers inside the connectors. (Fig 3.1, Fig 3.2)

## STEP 4

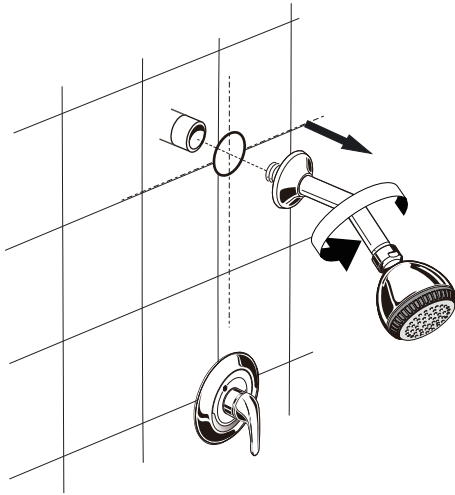

Fig 4.1

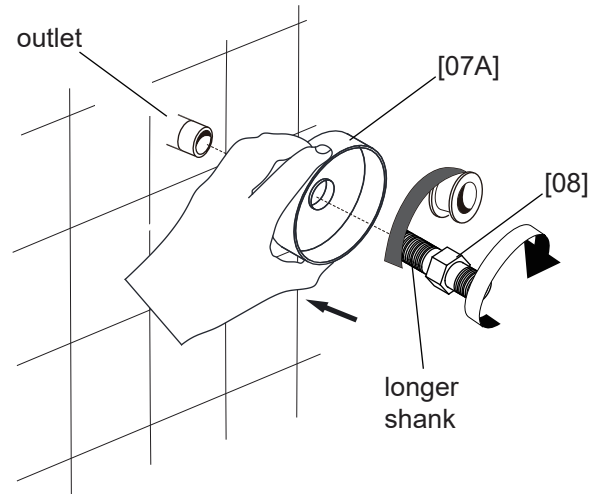

Fig 4.2

- 4-1** Turn off the faucet. Remove the existing shower head and shower arm assembly. (Fig 4.1)
- 4-2** Slide the **Base [07B]** to the **outlet**. The deeper side of the **Base [07B]** face outside. Install the longer shank of **Nipple [08]** to the outlet and tighten it. Use plumbing tape to ensure good sealing performance. (Fig 4.2)

## STEP 5

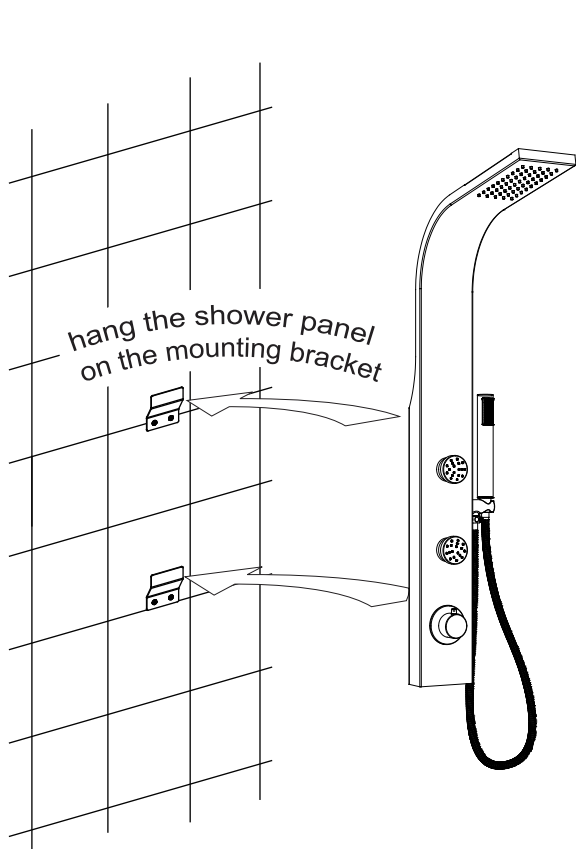

Fig 5.1

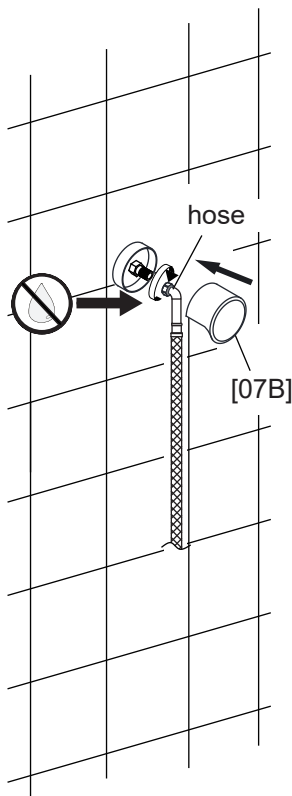

Fig 5.2

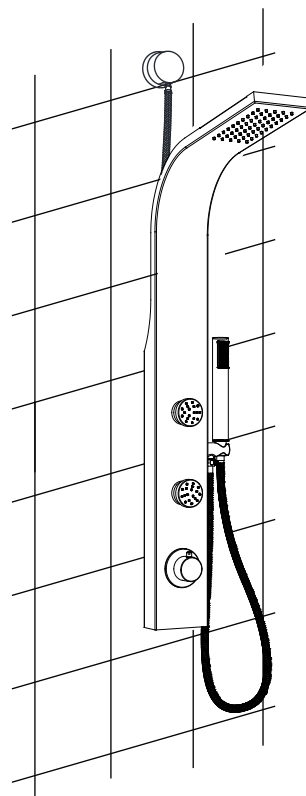

Fig 5.3

- 5-1** Connect the **hose** to the **Nipple [08]** and tighten it to secure. (Fig 5.2)
- 5-2** Before hanging the shower panel onto the wall, turn on the faucet and test all water functions of the shower panel and check all connections for leaks. Install the **Cap [07B]** to the **Base [07A]**. (Fig 5.2)
- 5-3** Slide the shower panel down until it rests on the mounting brackets. Slightly pull down the shower panel to secure. (Fig 5.1, Fig 5.3)

**Note:** Check all connections at arrows for leaks. Retighten if necessary, but do not overtighten.

# CARE AND MAINTENANCE

ANZZI® products are crafted with superior quality standards and workmanship and engineered to stand the test of time. However, that does not mean the product can be neglected - it will need some care and cleaning.

It is recommended to use regular soap and hot water along with a non-abrasive cloth or sponge to regularly clean the product. This avoids any build up or deposits which would be tougher to remove.

If you feel the use of stronger cleaning solutions or chemicals is necessary, always test the cleaning solution or chemical on an inconspicuous area before applying to the entire surface.

Wipe all surfaces clean and rinse completely with water immediately after applying cleaner. Rinse and dry any overspray that lands on nearby surfaces.

DO NOT ALLOW THE CLEANER TO SOAK.

Following these simple procedures will ensure your ANZZI® product remains as lustrous and stunning as the day it was first received. ENJOY!

Sincerely,

La Familia ANZZI®

