

INSTRUCTIONS

1. Please count and make sure all pieces are present before assembly.
2. The pole pieces are delicate. To prevent damage, do not use excessive force.
3. Assemble crystal puzzle by putting the puzzle pieces together in the order shown below.
4. Missing a piece? Email info@ugames.com or call (415) 503-1600 with missing piece number.

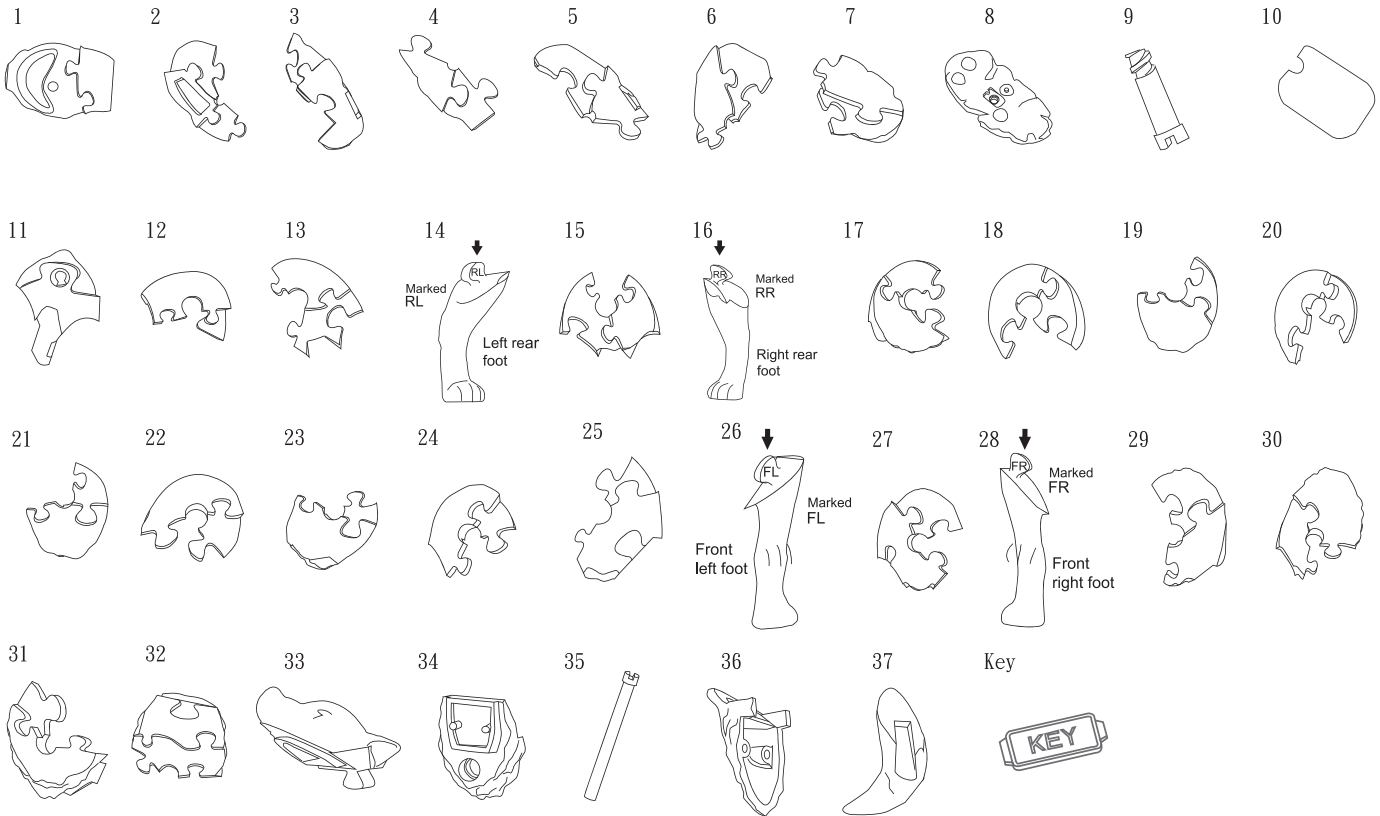

HINTS

1

Don't lose any pieces

2

After assembling piece #8, insert the short pole piece #9 from the bottom and screw down with the key enclosed.

3

After completing piece #34, insert the long center pole piece #35 and screw down with the key enclosed. Complete puzzle by inserting piece #36 and #37.

