

## Ideas and techniques!

- Try drawing with your oil pastels on paper then adding watercolor over it. The oil pastel will “resist” or repel the watercolor!
- Color with chalk over the chalkboard in large areas, then use your finger to draw through the chalk revealing the black chalkboard underneath. This is called subtractive art!
- Create new colors by following the color blending suggestions below to blend your gel crayons or oil pastels.

Red + Yellow = Orange  
Yellow + Blue = Green  
Red + Blue = Purple  
Blue + Green = Teal  
Green + Yellow = Lime  
Purple + Blue = Blue Violet  
Red + Purple = Red Violet  
Orange + Yellow = Gold  
Red + Orange = Red Orange

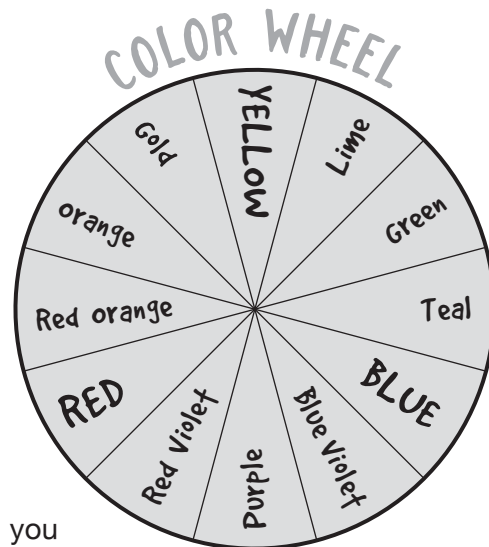

## Games for two!

Since this easel is double-sided, you and a friend can create at the same time.

**Funny Faces** - you and your partner give each other suggestions as to what to place on a face you draw. Don't peek at each others drawing until you're finished. For example, draw a mustache, add a hat, make the nose an oval, use the color blue....

**Draw & Guess** - Draw something fun on your side of the easel, like a rainbow, a bubble gum machine, a race car or whatever your imagination dreams up. Take turns giving each other clues and guessing what you've each created. Show your drawings after you've each guessed correctly.

  
**FABER-CASTELL®**  
since 1761

# Tabletop ART Studio

## Important Information about the Art Materials

- The non-toxic art materials included use real artist pigments that may stain fabrics and furniture, so be careful!
- Cover your work surface and wear a smock or old clothes.
- May rub off onto skin. Wash with soap and water.
- Clean up any paint spills immediately while still wet.
- Have water and paper towels handy for cleaning and drying your brushes.
- Be sure to use the watercolor paints on the art paper only.

## About the easel:

When not in use, store all of the art materials inside. The tabletop easel closes securely with magnets.

Always open the easel with the deeper side down. This will ensure all of your art materials stay inside while opening.

Be sure to open and close the tabletop easel by using the finger tab to prevent pinching.

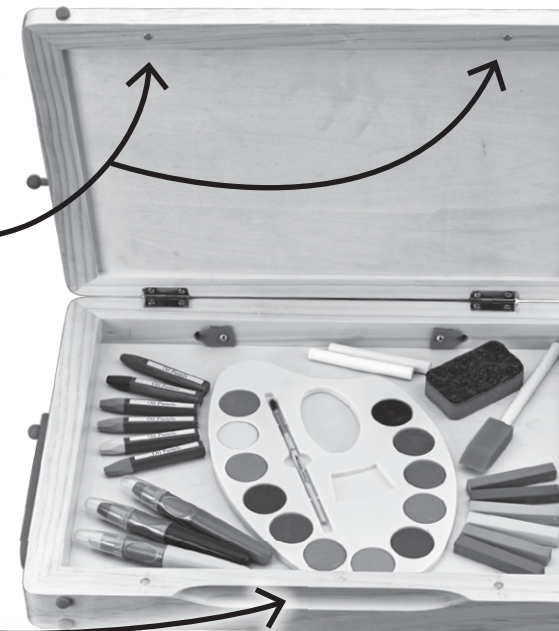

Visit us at:

[www.GreatArtStartsHere.com](http://www.GreatArtStartsHere.com)



Tabletop Art Studio #14316

© Faber-Castell USA, Inc.  
Cleveland, Ohio 44125

Conforms to ASTM D-4236 • Non-toxic Safe for Children

## Let's set it up!

Remove all of the art materials and set them aside.

1. Swing the arms around to meet the wooden pegs on both sides of the easel.
2. Insert the arms onto the side pegs by sliding them into the grooves of the arms.
3. Set your easel on a table and position it for use.



To put your easel away, unlatch the arms from the side pegs. Rotate the arms until they meet the magnets so they'll stay in place until you're ready for more creating.

## What's inside?

### Art Materials for the Chalkboard

**Soft Pastels** - vibrant colors of chalk that can be used on the chalkboard or the art paper. Try blending, using the tip or the side of the stick for different effects.

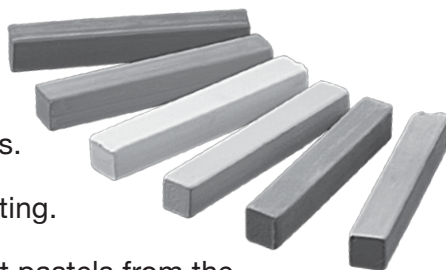

**White Chalk** - for drawing and writing.

**Felt Eraser** - erases chalk and soft pastels from the chalkboard. *Do not use to remove the Gel Crayons.*

### Art Materials for the White Board

**Round Red Magnets** - hold your paper in place on the white board

**Gel Crayons** - buttery feel will glide over the white board surface and on the art paper. Wipe off with a clean paper towel. Add a little water for stubborn colors.

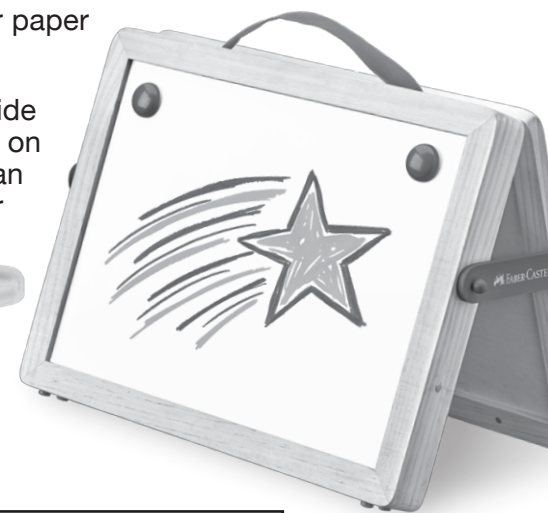

Do not use Gel Crayons on the chalkboard surface.

### Art Materials for the Art Paper

**Watercolor Palette** - just dip your brush in water and gather some paint from one of the cakes and apply your color to the art paper provided. Rinse brush in water before switching colors.

**Foam Brush** - fun to use with the watercolor palette. Wet the end of the brush and gather color to apply on paper. Try gathering two colors on each side of the brush!

**Oil Pastels** - high pigment, soft, and easy to blend.

