

model AMP 500/1  
subwoofer amplifier

# ELURA

## Specifications.

**Output Power:** Line & LFE 500W @ 4Ω  
Line & LFE 330W @ 6Ω  
Line & LFE 250W @ 8Ω

**THD+N:** Line & LFE @4Ω=0.04%

**Input Sensitivity:** Line 124mV / LFE 162mV

**Frequency Response:** Line 15Hz - 260Hz / LFE 15Hz - 550Hz

**Low Pass Crossover:** 1W/4Ω 90Hz = 0-3dB, 90Hz - 260Hz

**Low Pass Filter:** 1W/4Ω, 260Hz=0dB, test point @ 525Hz, 13dB/Octave

**Signal to Noise Ratio:** 500W @4Ω / 90Hz, 90dB, 1W @4Ω / 90Hz, 65dB

**Auto Turn Off Time:** 16 min

**Supply Voltage:** AC230V / 50Hz, AC115V / 60Hz

[www.elura.audio](http://www.elura.audio)

**MSTR**  
BRAND  
PRODUCTS

# ELURA

model AMP 500/1  
subwoofer amplifier

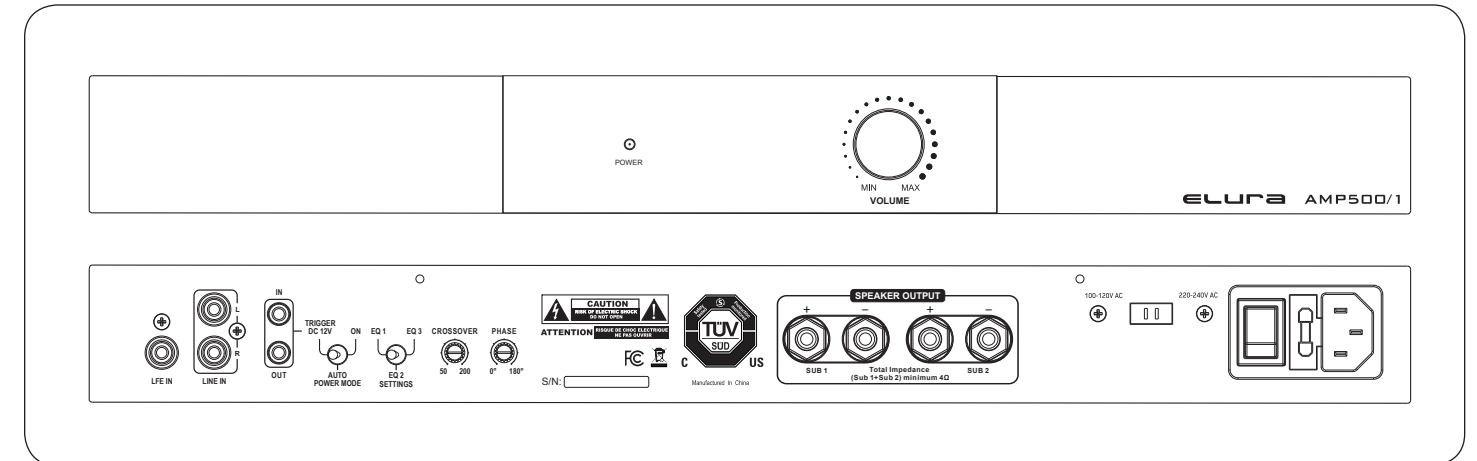

## Overview.

Thank you for purchasing Elura Amplifier products. Elura is a high performance custom installed product engineered for movie and music enthusiasts. Each Elura product is manufactured to the highest quality standard using state of the art components and built for years of enjoyment.

## Features.

- Digital high power amplification
- 4 Ohm Impedance Capable
- Thermal & Short Circuit Protection
- Low Noise
- Small chassis
- Less Heat
- Efficient Class D design
- Rack mountable
- Automation circuit
- Detachable Power Cord

## Contents.

- Amplifier
- Rack Mounting Hardware
- Power cord
- Manual



## Warning.

To reduce the risk of electric shock, do not expose this product to rain or moisture. This product should not be exposed to dripping or splashing and avoid placing near any object filled with water, such as a vase or an aquarium.

## Important Symbols.

The lighting flash arrowhead triangular symbol is to alert the user to the presence of uninsulated 'dangerous voltage' within the product sufficient enough to constitute a risk of electric shock.

The arrowhead symbol with an exclamation point is to alert the user to the presence of an important operational or maintenance instruction.

## Safety Instructions.

1. Read the instructions.
2. Keep the instructions.
3. Heed all warnings.
4. Follow the instructions.
5. Do not use near water.
6. Clean with a dry cloth.
7. Do not block ventilation slots.
8. Install in accordance to the instructions.
9. Do not install near a heat source or combustible source.
10. Do not defeat the polarized or grounding plug.
11. Protect the power cord from being crimped, cut or pinched.
12. Only attached accessories specified within the instructions.
13. Use only on lower shelves with a stand, cart or rack product capable of holding the weight to avoid injury from furniture tipping over.

### Speaker Connections.

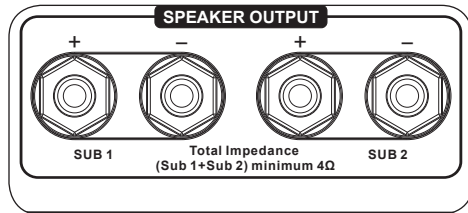

The AMP500/1 has 5 way binding post connections for two subwoofers. The connector can be used to screw down on bare wire, banana plugs, spades or pins. Position and polarity are color coded and marked to avoid phase issues. Be sure to follow proper polarity for each sub and position.

### AV Receiver / Preamp Connections.

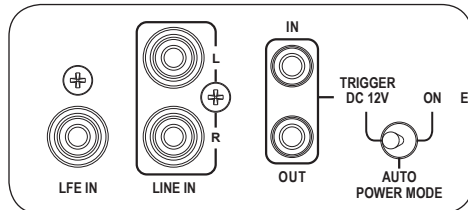

Preamplified connections are made using Stereo RCA patch cables or a single digital RCA LFE patch cord. A LFE connection, is a direct path to the amplifier from the processor or the AV receiver. The low frequency effects are crucial for movies.

### EQ Settings.

There are 3 EQ placement settings, manual crossover frequency, and phase settings on the rear panel. The EQ toggle offers three different curves pending the placement location and applications. Using the LFE input bypasses these functions and uses the cross over settings in the AV receiver.

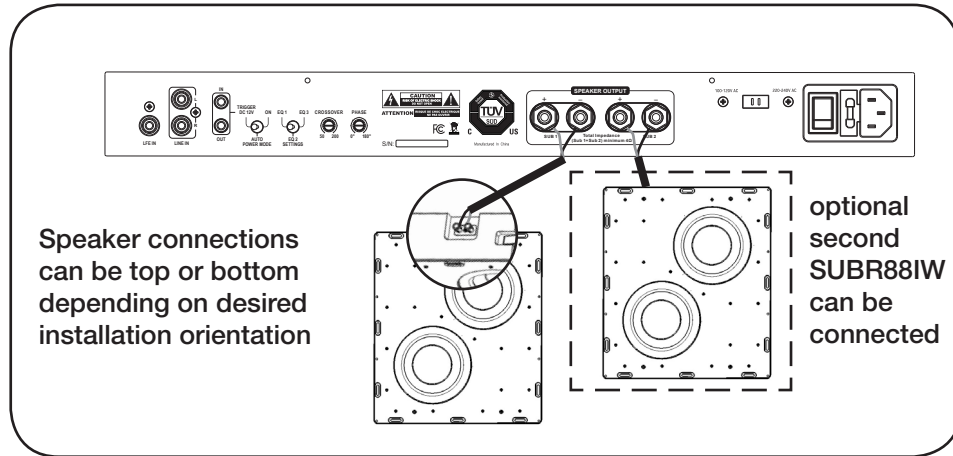

**EQ 1**, toggle left position, is set for a normal bass response. Use this EQ position if you are installing a SUB-R88IW under normal conditions.

**EQ2**, center toggle position, is a reduced bass boost output. You can use this setting if connecting 2 SUB-R88IW or if the bass seems boomy or excessive.

**EQ3**, toggle right position, is used to further reduce the bass output from the EQ2 setting and commonly suggested for non-home theater stereo based systems.

Every room is different and can offer unique challenges based on size, listener position, and the construction of the room. The EQ settings can help tailor the bass levels to the desired level. Use a sound level meter and fixed frequency tones to measure the output of each channel.

### Crossover Setting.

The crossover point can be adjusted using a small screwdriver. Adjustments are from 50 to 200Hz. Pending

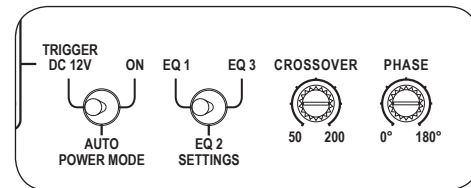

ing the size and type of your left and right speakers, the cutoff point offers higher performance and less distortion at higher volumes from the main speakers.

### Phase Setting.

Speaker phase can be adjusted pending the speakers location in the room and the prime listening position. Changing phase can benefit the listener by repositioning the low frequency wave in association to front speaker sound waves. The area where both the subwoofer and the front speakers are located can interfere with each other. Phase adjustments can change the negative interactions based on the speaker locations, the distances between them, the listeners position, and the room boundaries.

### AMP500/1 Rear Panel

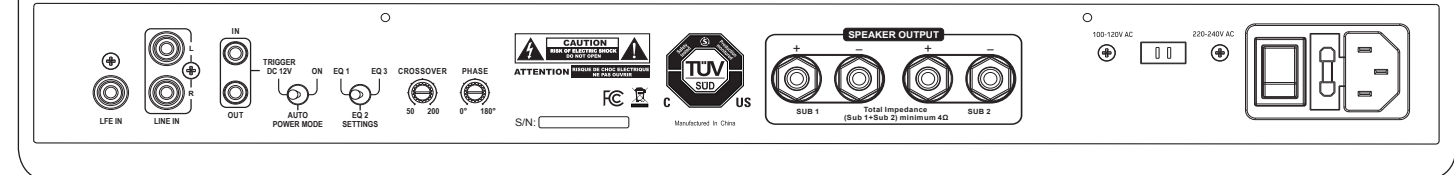

### Auto Power Modes.

The AMP500/1 has three power modes, ON / AUTO / TRIGGERED.

ON = Always ON  
 AUTO = Signal sensing via audio  
 TRIGGERED = 12VDC tip positive

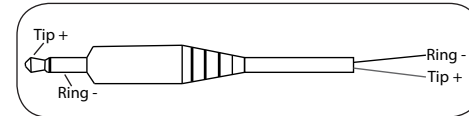

Amplifiers can produce noise when left on. The noise is a buzz and is heard when music isn't playing in a very quiet room. If you are using a master switch to turn off power to your audio equipment, always on is acceptable. In loud environments, always ON may be acceptable. In quiet rooms, it is suggested to use AUTO or TRIGGERED options.

### Troubleshooting.

To avoid a popping noise when turning off your subwoofer, turn the subwoofer amplifier off before the preamp signal from the receiver is powered off. To avoid the popping noise when powering you system up, have the preamp signal from the receiver on before the subwoofer powers up. Power sequencing and triggers can be used to avoid the issue. Many of today's sophisticated AV receivers offer power sequencing and triggered outputs. See the manufacturers manuals for the AV receiver to take advantage of this sequencing option.

### Warranty.

All Elura products come with a 2 year limited liability warranty. This warranty includes parts and labor repairs on all components found to be defective in material or workmanship under normal conditions of use. This warranty shall not apply to products which have been abused, modified or disassembled. A product that fails under conditions other than those covered will be repaired at the current price of parts and labor in effect at the time of repair. Such repairs are warranted for 90 days from the day of reshipment to the BUYER. If the unit is delivered by mail, customers agree to insure the unit or assume the risk of loss or damage in transit. Under no circumstances will a unit be accepted without a return authorization number. The warranty is in lieu of all other warranties expressed or implied, including without limitations, any other implied warranty or fitness or merchantability for any particular purpose, all of which are expressly disclaimed. Proof of sale may be required in order to claim warranty.

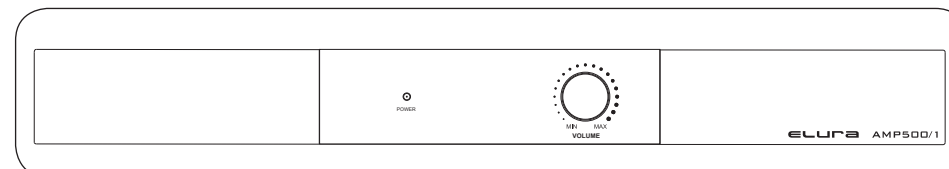

### Front Panel LEDs.

The Elura Subwoofer amplifier has a LED on the front panel to indicate the amplifier's power state. The Power LED indicates the amplifier is ON.  
 Power ON = Blue  
 Power OFF = Red

### Amp Volume Settings.

The volume for the amplifier is on the front panel. It is a set an forget gain control of the subwoofer output. If there are 2 subwoofers connected, the volume will control the output of both products connected.