

DS-2CD7133-E VGA Network Mini Dome Camera

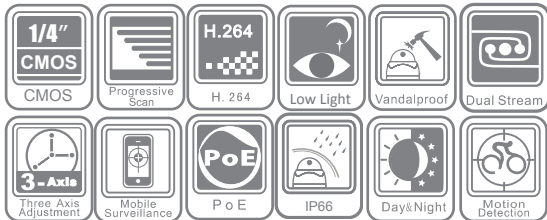

Key features

- 1/4" progressive scan CMOS
- H.264 / MPEG4 / MJPEG video compression
- Super low illumination
- Day / night auto switch
- PoE
- IP66 rating
- 3-axis adjustment

Dimensions

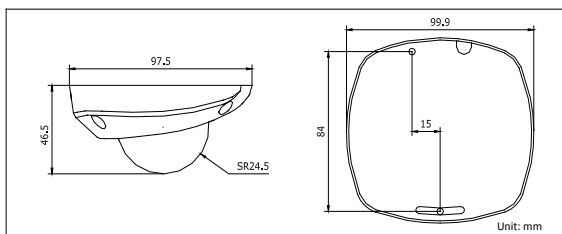

Specifications

DS-2CD7133-E	
Camera	
Image sensor	1/4" progressive scan CMOS
Min. illumination	0.01 lux@F1.2, AGC on 0.02 lux@F1.8, AGC on
Shutter time	1/25s ~ 1/100,000s
Lens	4 mm @F1.8 (2.8, 6, 8mm optional) Angle of view: 54.9°
Lens mount	M12
Angle adjustment	Pan: ± 15°, tilt: 0 ~ 90°, rotation: ± 15°
Day & night	Electronic
Compression Standard	
Video compression	H.264 / MPEG4 / MJPEG
Bit rate	32 Kbps ~ 8 Mbps
Dual stream	Yes
Image	
Max. image resolution	640 × 480
Frame rate	50 Hz: 25 fps (640 × 480) 60 Hz: 30 fps (640 × 480)
Image settings	Saturation, brightness, contrast adjustable through client software or web browser
Network	
Network storage	NAS (iSCSI optional)
Alarm trigger	Motion detection
Protocols	TCP/IP, HTTP, DHCP, DNS, DDNS, RTP/RTSP, PPPoE, SMTP, NTP (SNMP, HTTPS, SIP, FTP, SRTP, 802.1x, IPv6 optional)
Security	Password protection, watermark
System compatibility	ONVIF, PSIA, CGI
Interface	
Communication interface	1 RJ45 10M / 100M ethernet port
Reset button	Yes
General	
Operating conditions	-10°C ~ 60°C (14°F ~ 140°F) Humidity 90% or less (non-condensing)
Power supply	12 VDC ± 10%, PoE (802.3af)
Power consumption	4W max.
Impact protection	IEC60068-275Eh, 50J; EN50102, up to IK10
Weather-proof rating	IP66
Dimensions	99.9 × 97.5 × 46.5 mm (3.93" × 3.84" × 1.83")
Weight	250g (0.55 lbs)

Available Models

DS-2CD7133-E