

FEATURES & SPECIFICATIONS

INTENDED USE — These specifications are for USA standards only. Square Straight Aluminum is a general purpose light pole for up to 35-foot mounting heights. This pole provides a lighter and naturally corrosion-resistant option for mounting area light fixtures and floodlights.

CONSTRUCTION —

Pole Shaft: The pole shaft is of uniform wall thickness and is made of extruded 6000 series aluminum alloy tubing that is heat treated to a T6 temper to provide maximum strength. The shaft is uniformly square in cross-section with flat sides, small corner radii and excellent torsional qualities. Available shaft widths are 4", 5", 6" and 6.75".

Pole Top: Options include tenon top, drilled for side mount fixture, tenon with drilling (includes extra handhole) and open top. A removable cast aluminum top cap with set screws is provided for all poles that will receive drilling patterns for side-mount luminaire arm assemblies or when ordered with open top (PT) option. The top cap resists intrusion of moisture and environmental contaminants.

Handhole: A handhole opening with grounding provision is provided near the base. Standard positioning varies with shaft width as follows: 4" shaft, handhole at 12"; 5" shaft, handhole at 14"; 6" and 6.75" shaft, handhole at 18". Positioning the handhole lower than standard may not be possible and requires engineering review; consult Tech Support-Outdoor for further information. Standard and extra handholes come with cover and attachment hardware. The handhole for a pole specified with a 4" or 5" shaft width has a nominal dimension of 2" x 4"; the handhole for a pole specified with a 6" or 6.75" width has a nominal dimension of 2.63" x 5". Standard and extra handholes come with cover and attachment hardware.

Bolt Caps/Base Cover: Pole base plate utilizes cast aluminum A365 nut cover discs to cover anchor bolt and nut assembly. 2 piece, spun aluminum base cover available as an option.

Anchor Base/Bolts: Anchor base is cast from A356 alloy aluminum. Anchor bolts are manufactured to ASTM F1554 Standards Grade 55, (55 KSI minimum yield strength and tensile strength of 75-95 KSI). Upper portion of anchor bolt is galvanized per ASTM A-153; bolts have an "L" bend on bottom end and are galvanized a minimum of 12" on the threaded end.

HARDWARE — All structural and non-structural fasteners are stainless-steel.

FINISH — Extra durable painted finish is coated with TGIC (Triglycidyl Isocyanurate) Polyester powder that meets 5A and 5B classifications of ASTM D3359. Standard powder-coat finishes include Dark Bronze, White, Black, and Natural Aluminum colors. Other finishes include Brushed Aluminum, and Anodized Dark Bronze, Anodized Natural Aluminum and Anodized Black. Architectural Colors and Special Finishes are available by quote and include, but are not limited to RAL Colors, Custom Colors and Extended Warranty Finishes.

GROUNDING: Grounding provision is located in handhole near the base. Grounding hardware is not included (provided by others).

INSTALLATION — **Do not** erect poles without having fixtures installed. Factory-supplied templates must be used when setting anchor bolts. Lithonia Lighting will not accept claim for incorrect anchorage placement due to failure to use Lithonia Lighting factory templates. If poles are stored outside, all protective wrapping must be removed immediately upon delivery to prevent finish damage. Lithonia Lighting is not responsible for the foundation design.

WARRANTY — 1-year limited warranty. This is the only warranty provided and no other statements in this specification sheet create any warranty of any kind. All other express and implied warranties are disclaimed. Complete warranty terms located at: www.acuitybrands.com/support/warranty/terms-and-conditions

NOTE: Actual performance may differ as a result of end-user environment and application. Specifications subject to change without notice.

Catalog Number
Notes
Type



Anchor Base Poles

SSA

SQUARE STRAIGHT ALUMINUM

SSA Square Straight Aluminum Poles

ORDERING INFORMATION Lead times will vary depending on options selected. Consult with your sales representative. Example: SSA 20 4C DM19 BA

SSA					
Series	Nominal fixture mounting height	Nominal shaft base size/wall thickness ¹	Mounting ²		
SSA	8'-35' (for 1/2 ft increments, add -6 to the pole height. Ex: 20-6 equals 20ft 6in.) (See technical information table for complete ordering information.)	4C 4" (0.125")	<u>Tenon mounting</u>		<u>RAD drill mounting⁴</u>
		4G 4" (0.188")	PT Open top	DM19RAD 1 at 90°	<u>AERIS™ Suspend drill mounting^{4,5}</u>
		5G 5" (0.188")	T20 2-3/8" O.D. (2" NPS)	DM28RAD 2 at 180°	DM19AST__ 1 at 90°
		6G 6" (0.188")	T25 2-7/8" O.D. (2-1/2" NPS)	DM29RAD 2 at 90°	DM28AST__ 2 at 180°
		6J 6" (0.250")	T30 3-1/2" O.D. (3" NPS) ³	DM39RAD 3 at 90°	DM29AST__ 2 at 90°
		7J 7" (0.250")	T35 4" O.D. (3-1/2" NPS) ³	DM49RAD 4 at 90°	DM39AST__ 3 at 90°
		(See technical information table for complete ordering information.)	<u>KAC/KAD/KSE/KSF/KVR/KVF Drill mounting⁴</u>		DM49AST__ 4 at 90°
			DM19 1 at 90°	<u>ESX Drill mounting³</u>	<u>OMERO™ Suspend drill mounting^{4,5}</u>
			DM28 2 at 180°	DM19ESX 1 at 90°	DM19MRT__ 1 at 90°
			DM28PL 2 at 180° with one side plugged	DM28ESX 2 at 180°	DM28MRT__ 2 at 180°
			DM29 2 at 90°	DM29ESX 2 at 90°	DM29MRT__ 2 at 90°
			DM39 3 at 90°	DM39ESX 3 at 90°	DM39MRT__ 3 at 90°
			DM49 4 at 90°	DM49ESX 4 at 90°	DM49MRT__ 4 at 90°
			<u>CSX/DSX/RSX/AERIS™/OMERO™/HLA/KAX Drill mounting⁴</u>		
			DM19AS 1 at 90°		
			DM28AS 2 at 180°		
			DM29AS 2 at 90°		
			DM39AS 3 at 90°		
			DM49AS 4 at 90°		

Options	Finish ¹¹
L/AB Less anchor bolts (Include when anchor bolts are not needed)	<u>Super durable paint colors</u>
VD Vibration damper	DDBXD Dark bronze
TP Tamper proof	DBLXD Black
HAxy Horizontal arm bracket (1 fixture) ^{6,7}	DNAXD Natural aluminum
FDLxy Festoon outlet less electrical ^{6,8}	DWHXD White
CPL12/xy 1/2" I.D. coupling ⁶	DDBTXD Textured dark bronze
CPL34/xy 3/4" I.D. coupling ⁶	DBLBXD Textured black
CPL1/xy 1" I.D. coupling ⁶	DNATXD Textured natural aluminum
NPL12/xy 1/2" O.D. threaded nipple ⁶	DWHGXD Textured white
NPL34/xy 3/4" O.D. threaded nipple ⁶	<u>Brushed finish</u>
NPL1/xy 1" O.D. threaded nipple ⁶	BA Brushed aluminum
EHHxy Extra handhole ^{6,9}	<u>Class 1 architectural anodized</u>
BAA Buy America(n) Act Compliant ¹⁰	ABL Black
UL UL listed with label (Includes NEC compliant cover)	ADB Dark bronze
NEC NEC 410.30 compliant gasketed handhole (Not UL Labeled)	ANA Natural
FBC Full base cover (spun aluminum)	<u>Architectural colors</u>
	<u>(powder finish)</u>
	Duranodic Anodize, Paint over Duranodic Anodize, RAL Colors, Custom Colors and Extended Warranty Finishes available.

Accessories: Order as separate catalog number.	
PL DT20	Plugs for ESX drillings
PL DT8	Plugs for DMxxAS drillings

- NOTES:**
1. Wall thickness will be signified with a "C", "G" or a "J" in nomenclature. "C" - 0.125 | "G" - 0.188 | "J" - 0.250.
 2. PT open top poles include top cap. When ordering tenon mounting and drill mounting for the same pole, follow this example: DM28/T20. The combination includes a required extra handhole.
 3. 3-1/2" and 4" O.D. tenons available on 5" and 6" shafts only.
 4. Refer to the fixture spec sheet for the correct drilling template pattern and orientation compatibility.
 5. Insert "1" or "2" to designate fixture size; e.g. DM19AST2.
 6. Specify location and orientation when ordering option.
For "x": Specify the height in feet above base of pole.
Example: 5ft = 5 and 20ft, 3in = 20-3
For "y": Specify orientation from handhole (A,B,C,D) Refer to the Hand-hole Orientation diagram below.
Example: 1/2" coupling at 5'8", orientation C = CPL12/5-8C
 7. Horizontal arm is 18" x 2-3/8" O.D. tenon standard, with radius curve providing 12" rise and 2-3/8" O.D. If ordering two horizontal arm at the same height, specify with HAxyy. Example: HA20BD
 8. FDL does not come with additional covering. Festoons must be a minimum of 3ft (36in) from the base in any orientation. Distance between any festoon and/or handhole must be at least 1ft and 6in (18in) apart in any orientation.
 9. Combination of tenon-top and drill mount includes extra handhole. Extra Handholes must be a minimum of 3ft (36in) from the base in any orientation. Distance between any festoon and/or handhole must be at least 1ft and 6in (18in) apart in any orientation.
 10. Use when mill certifications are required. Some configurations may be excluded, consult factory.
 11. Finish must be specified. Additional colors available; see Architectural Colors brochure linked [here](#) (Form No. 794.3).



POLE-SSA

SSA Square Straight Aluminum Poles

TECHNICAL INFORMATION — EPA (FT²) WITH 1.3 GUST

Catalog number	Nominal mount ht. (ft) *	Pole shaft size (in x ft)	Wall thick (in)	80 mph	90 mph	100 mph	Max. weight (lbs)	Bolt size (in. x in. x in.)	Approximate ship (lbs.)
SSA 8 4C	8	4.0 x 8.0	0.125	16.5	12.6	9.9	300	3/4 x 18 x 3	32
SSA 10 4C	10	4.0 x 10.0	0.125	11.5	8.6	6.5	230	3/4 x 18 x 3	37
SSA 12 4C	12	4.0 x 12.0	0.125	12.4	9.2	6.9	160	3/4 x 18 x 3	40
SSA 14 4C	14	4.0 x 14.0	0.125	9.3	6.7	4.8	120	3/4 x 18 x 3	50
SSA 15 4C	15	4.0 x 15.0	0.125	8	5.6	3.9	100	3/4 x 18 x 3	52
SSA 16 4C	16	4.0 x 16.0	0.125	6.9	4.7	3.1	90	3/4 x 18 x 3	54
SSA 16 4G	16	4.0 x 16.0	0.188	11.8	8.5	6.2	130	3/4 x 30 x 3	74
SSA 16 5G	16	5.0 x 16.0	0.188	15	11.1	7.5	280	3/4 x 30 x 3	83
SSA 18 4C	18	4.0 x 18.0	0.125	4.9	3	1.7	70	3/4 x 18 x 3	57
SSA 18 4G	18	4.0 x 18.0	0.188	9.2	6.4	4.4	100	3/4 x 30 x 3	80
SSA 18 5G	18	5.0 x 18.0	0.188	16.8	12.2	8.9	230	3/4 x 30 x 3	91
SSA 20 4C	20	4.0 x 20.0	0.125	3.3	1.7	0.5	40	3/4 x 18 x 3	62
SSA 20 4G	20	4.0 x 20.0	0.188	7	4.6	2.9	80	3/4 x 30 x 3	85
SSA 20 5G	20	5.0 x 20.0	0.188	13.6	9.5	6.6	180	3/4 x 30 x 3	107
SSA 20 6G	20	6.0 x 20.0	0.188	22	15.9	11.6	230	1 x 36 x 4	155
SSA 20 6J	20	6.0 x 20.0	0.25	30.4	22.6	17	300	1 x 36 x 4	202
SSA 25 5G	25	5.0 x 25.0	0.188	7.2	4.2	2	110	3/4 x 30 x 3	130
SSA 25 6G	25	6.0 x 25.0	0.188	13.2	8.6	5.4	180	1 x 36 x 4	180
SSA 25 6J	25	6.0 x 25.0	0.25	19.7	13.8	9.5	250	1 x 36 x 4	224
SSA 30 6G	30	6.0 x 30.0	0.188	7	3.4	0.8	130	1 x 36 x 4	210
SSA 30 6J	30	6.0 x 30.0	0.25	12.2	7.5	4.1	170	1 x 36 x 4	258
SSA 32 6J	32	6.0 x 32.0	0.25	9.7	5.4	2.3	160	1 x 36 x 4	272
SSA 35 6J	35	6.0 x 35.0	0.25	6.4	2.6	--	200	1 x 36 x 4	294
SSA 35 7J	35	6.75 x 35.0	0.25	7.6	3.1	--	150	1 x 36 x 4	290

NOTE: EPA values are based ASCE 7-93 wind map.

*For 1/2 ft increments, add -6 to the pole height. Ex: 20-6 equals 20ft 6in.

TECHNICAL INFORMATION – EPA (ft²) WITH 3-SECOND GUST PER AASHTO 2013

Series	Mounting Height (ft)*	Shaft Size	90 MPH	Max. weight (lbs)	100 MPH	Max. weight (lbs)	110 MPH	Max. weight (lbs)	120 MPH	Max. weight (lbs)	130 MPH	Max. weight (lbs)	140 MPH	Max. weight (lbs)	150 MPH	Max. weight (lbs)
SSA	8	4C	9.4	350	7.2	350	5.5	350	4.3	350	3.3	350	2.6	350	2	350
SSA	10	4C	7	260	5.1	260	3.7	260	2.7	260	1.8	260	1.2	260	0.6	260
SSA	12	4C	4.8	260	3.2	260	2	260	1.1	260	-	260	-	-	-	-
SSA	14	4C	3.1	200	1.7	200	0.7	200	-	-	-	-	-	-	-	-
SSA	15	4C	2.3	200	1	200	-	-	-	-	-	-	-	-	-	-
SSA	16	4C	1.5	200	-	-	-	200	-	-	-	-	-	-	-	-
SSA	16	4G	9.1	200	6.5	200	4.5	200	3	200	1.8	200	0.9	200	-	-
SSA	18	4C	-	100	-	-	-	-	-	-	-	-	-	-	-	-
SSA	18	4G	6.9	150	4.6	150	2.8	150	1.5	150	-	150	-	-	-	-
SSA	18	5G	7.6	260	4.8	260	2.7	260	1.2	260	-	-	-	-	-	-
SSA	20	4C	-	-	-	-	-	-	-	-	-	-	-	-	-	-
SSA	20	4G	4.9	150	2.8	150	1.2	150	-	-	-	-	-	-	-	-
SSA	20	5G	5.4	150	2.9	150	1.1	150	-	-	-	-	-	-	-	-
SSA	20	6G	8.5	150	4.9	150	2.2	150	-	-	-	-	-	-	-	-
SSA	25	5G	0.6	100	-	-	-	-	-	-	-	-	-	-	-	-
SSA	25	6G	1.2	260	-	-	-	-	-	-	-	-	-	-	-	-
SSA	25	6J	6.6	260	2.8	260	-	-	-	-	-	-	-	-	-	-
SSA	30	6G	-	-	-	-	-	-	-	-	-	-	-	-	-	-
SSA	30	6J	-	-	-	-	-	-	-	-	-	-	-	-	-	-
SSA	32	6J	-	-	-	-	-	-	-	-	-	-	-	-	-	-
SSA	35	6J	-	-	-	-	-	-	-	-	-	-	-	-	-	-
SSA	35	7J	-	-	-	-	-	-	-	-	-	-	-	-	-	-

NOTES: AASHTO 2013 criteria is the most conservative existing EPA calculation. For poles not showing EPA values under AASHTO 2013, EPA values may exist under commercial criteria (see table above).

*For 1/2 ft increments, add -6 to the pole height. Ex: 20-6 equals 20ft 6in.

SSA Square Straight Aluminum Poles

BASE DETAIL

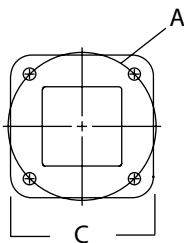
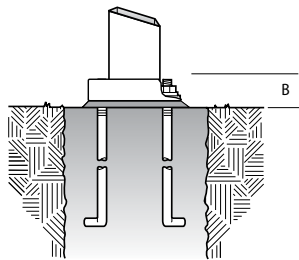

POLE DATA						
Shaft base size	Bolt circle A	Bolt projection B	Base square C	Bolt size	Template description	Anchor bolt description
4"C	8.5" – 9.625"	3.125"	9.938"	3/4" x 18" x 3"	ABTEMPLATE PJ50045	AB18-0
4"G	8.5" – 9.625"	3.125"	9.938"	3/4" x 30" x 3"	ABTEMPLATE PJ50045	AB30-0
5"	10.5" – 11.5"	3.25"	11.563"	3/4" x 30" x 3"	ABTEMPLATE PJ50046	AB30-0
6"	12" – 13"	4"	12.25"	1" x 36" x 4"	ABTEMPLATE PJ50044	AB36-0
7"	14.625"	4.125"	15"	1" x 36" x 4"	ABTEMPLATE PJ50130	AB36-0

HANDHOLE ORIENTATION

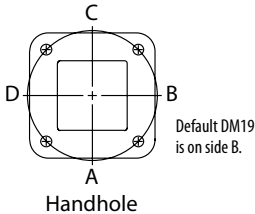

IMPORTANT INSTALLATION NOTES:

- **Do not** erect poles without having fixtures installed.
- Factory-supplied templates must be used when setting anchor bolts. Lithonia Lighting will not accept claim for incorrect anchorage placement due to failure to use factory template.
- If poles are stored outside, all protective wrapping must be removed immediately upon delivery to prevent finish damage.
- Lithonia Lighting is not responsible for the foundation design.

CAUTION: These specifications are intended for general purposes only. Lithonia Lighting reserves the right to change material or design, without prior notice, in a continuing effort to upgrade its products.



POLE-SSA