

# Janitorial Cabinet

## FEATURES

- 90 lb. shelf capacity (per shelf)
- 3 adjustable half-width shelves
- Full height storage compartment for taller items
- Adjustable shelves (1" increments)
- Recessed handle with core-removable lock
- Durable, fully-welded construction
- Durable steel construction with non-porous surface is easy to clean and disinfect

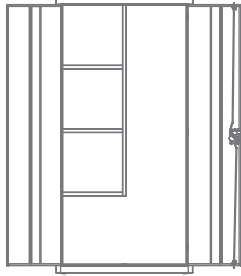

72" H x 36" W x 18" D

### JANITORIAL CABINET

COLOR	ITEM NO.	LIST
Putty	24096	\$1,238
Black	24097	\$1,238
Light Gray	24098	\$1,238

### SHIPPING

Dimensions	74.5H x 38W x 20.5D in.
Weight	103 lbs.
Cube	33.6

### SHIPPING DETAILS

- FOB Calexico, CA
- Country of Origin: Mexico

### STANDARDS & CERTIFICATIONS

- **ANSI/BIFMA** – Product meets or exceeds ANSI/BIFMA performance standards for storage units



# Hirsh®

Visit us at [hirshoffice.com](http://hirshoffice.com) • 800.383.7414 • Please contact us with questions and representative locations

© 2022 Hirsh Industries, LLC  
9.1.22