



## IMPORTANT

Carefully remove all the parts from the carton and place them individually on a soft cloth to prevent scratches or other damage.

Carefully and strictly follow these assembly instructions to ensure a completed product as designed.

Do not use power tools above 8 volts to assemble.

## Part List

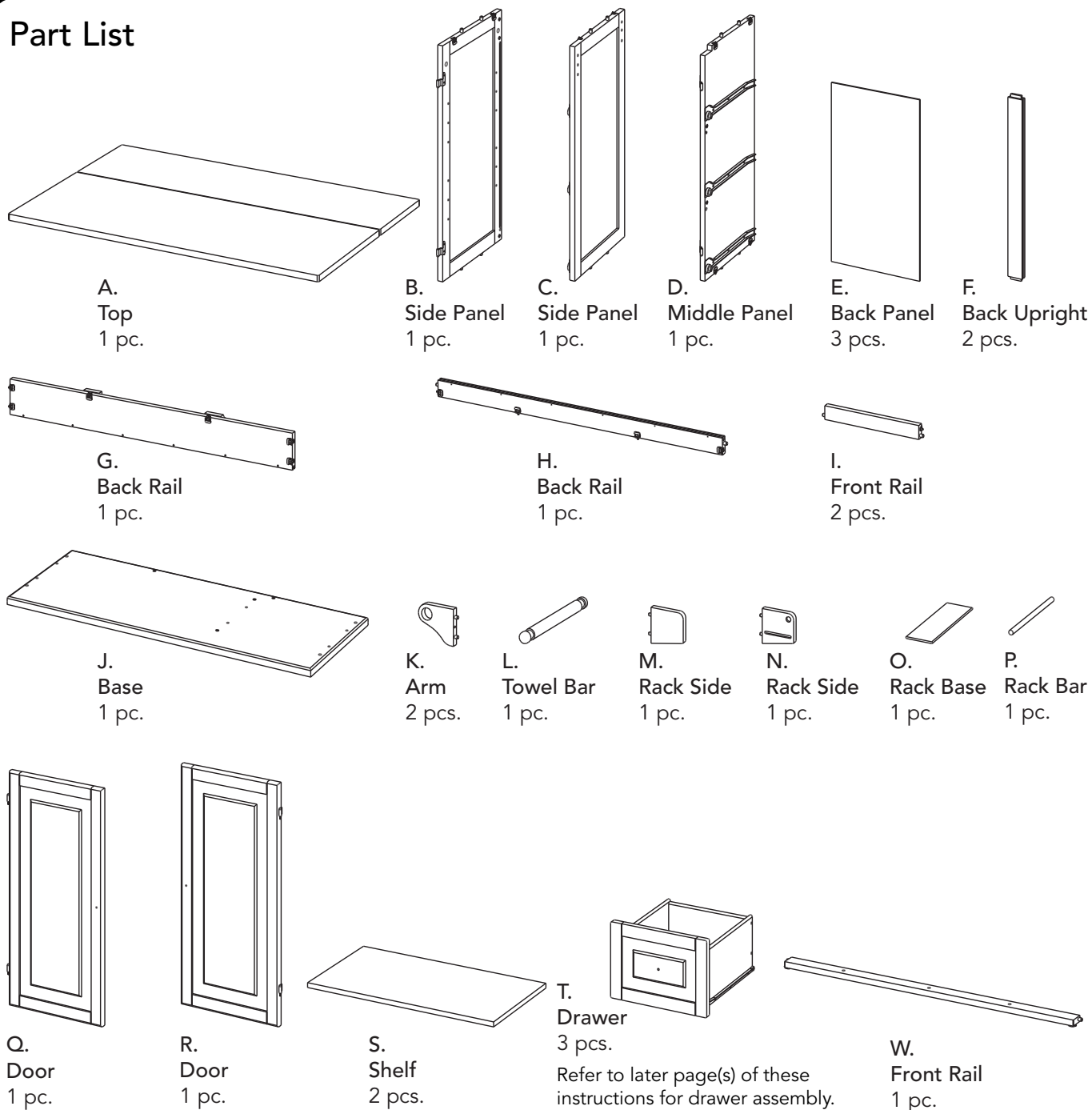

Tool(s) required for assembly: Phillips screwdriver

## Assembly Instructions 2/9

### Hardware List

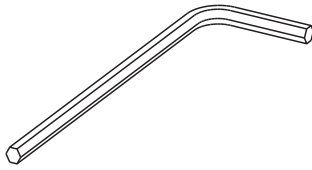

Hex Wrench  
1 pc.

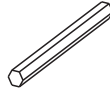

Small  
Hex Wrench  
1 pc.



**1**  
M6x25  
Head Cap Bolt  
4 pcs. (+1 extra)

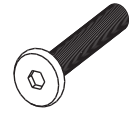

**2**  
M6x38  
Head Cap Bolt (long)  
4 pcs. (+1 extra)

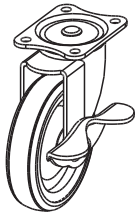

**3**  
3" Locking Caster  
2 pcs.

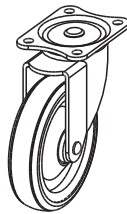

**4**  
3" Non-Locking Caster  
2 pcs.



**5**  
M6x12  
Head Cap Bolt for Caster  
16 pcs. (+1 extra)

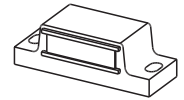

**6**  
Magnet  
2 pcs.



**7**  
#6x3/4"  
Wood Screw for Magnet  
4 pcs. (+1 extra)

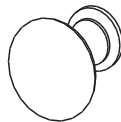

**8**  
Knob  
5 pcs.



**9**  
#8x1"  
Machine Screw  
5 pcs.



**10**  
#8x1"  
Wood Screw (long)  
24 pcs. (+1 extra)



**11**  
#4x1/2"  
Wood Screw (short)  
24 pcs. (+1 extra)



**12**  
#8x1"  
Wood Screw  
3 pcs. (+1 extra)

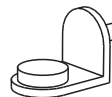

**13**  
Adjustable Pin  
8 pcs. (+1 extra)



**14**  
#8x1 1/4"  
Wood Screw for  
Base  
4 pcs. (+1 extra)

## Assembly Instructions 3/9

### IMPORTANT

- Use a soft cloth between these parts and the floor.
- Do not use power tools above 8 volts to assemble.
- Do not tighten all the bolts until each part is properly assembled.
- Keep Hex Wrench as the bolts may need to be tightened in the future.

### STEP 1

Assemble Rack Sides (M), (N), Rack Base (O) and Rack Bar (P).

**Note: Spice Rack and Towel Bar are interchangeable and may be installed on either side of the unit.**

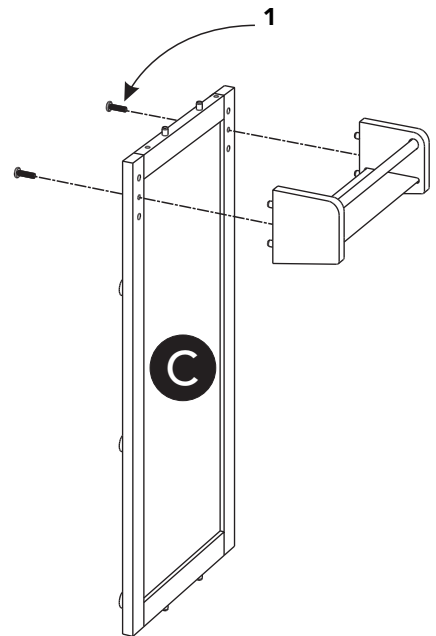
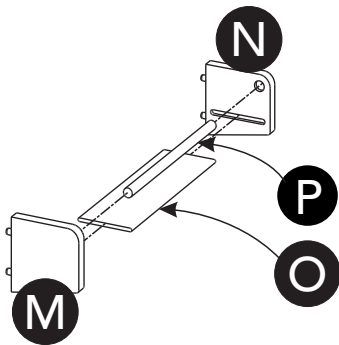

### STEP 2

Attach unit to Side Panel (C) with Head Cap Bolts (1).

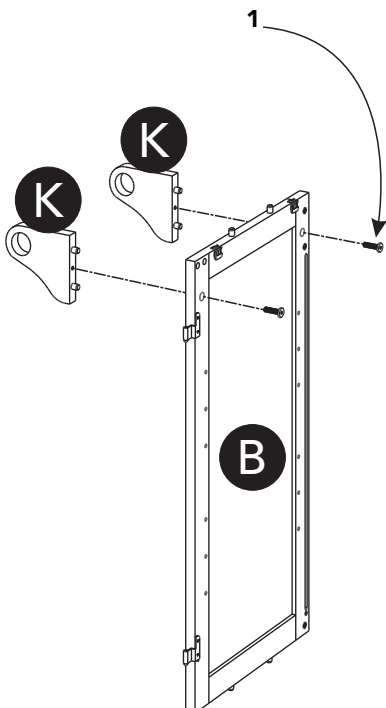

### STEP 3

Attach Arms (K) to Side Panel (B) with Head Cap Bolts (1).

## Assembly Instructions 4/9

### STEP 4

Turn all flip locks in both side panels, Back Rails (H) and (G) to unlock position. (See Figure 1)

Attach Back Rail (G) to Side Panel (C), then flip Locks. (See Figures 2 and 3)

Attach Back Uprights (F) to unit.

Slide Back Panels (E) into position.

Attach Back Rail (H) to unit, then flip Lock.

Attach Side Panel (B) to unit, then flip Locks.

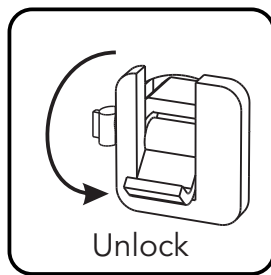
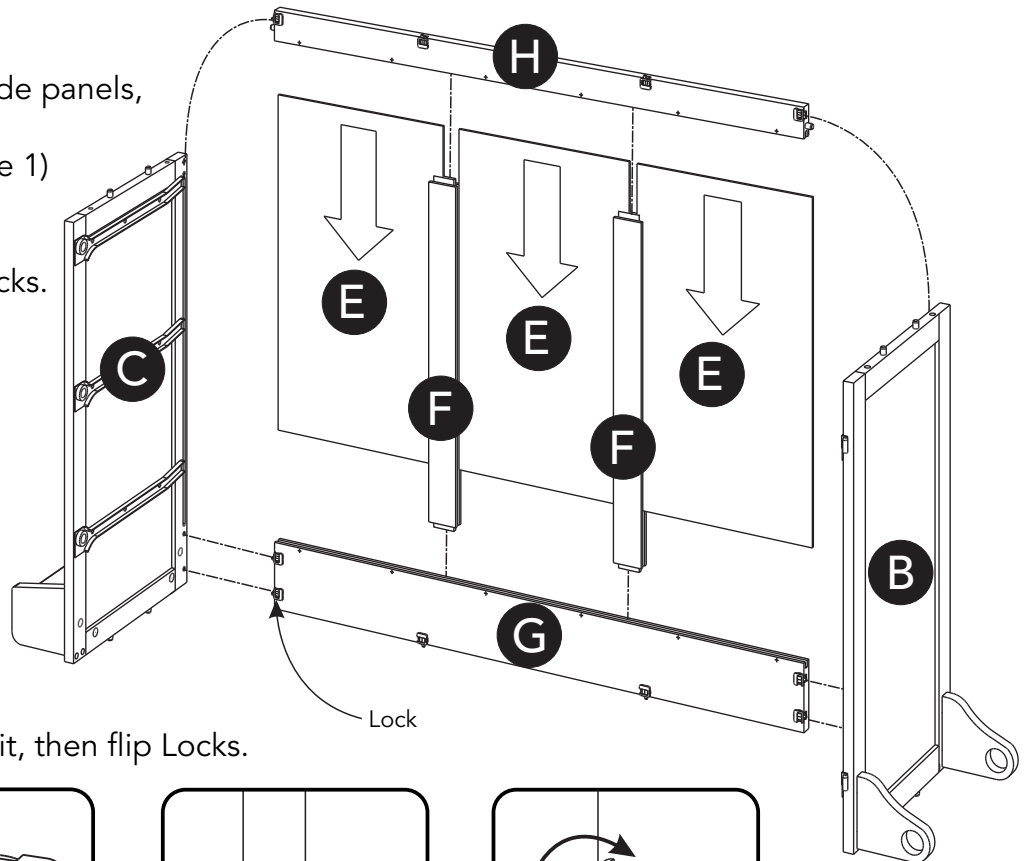

Figure 1

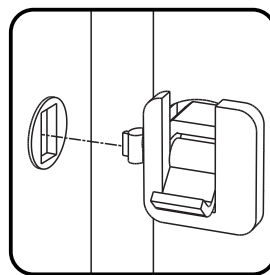

Figure 2

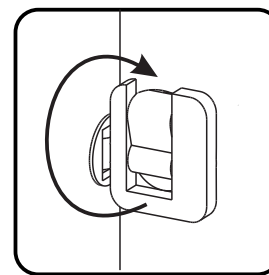

Figure 3

### STEP 5

Attach Base (J) to unit with Head Cap Bolts (long) (2) and Wood Screw for Base (14). (See Figures 4 and 5)

Then flip Locks.

Note: Arrow label indicates front of Base (J).

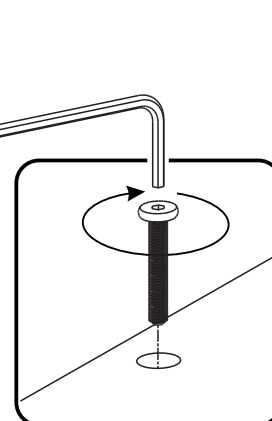
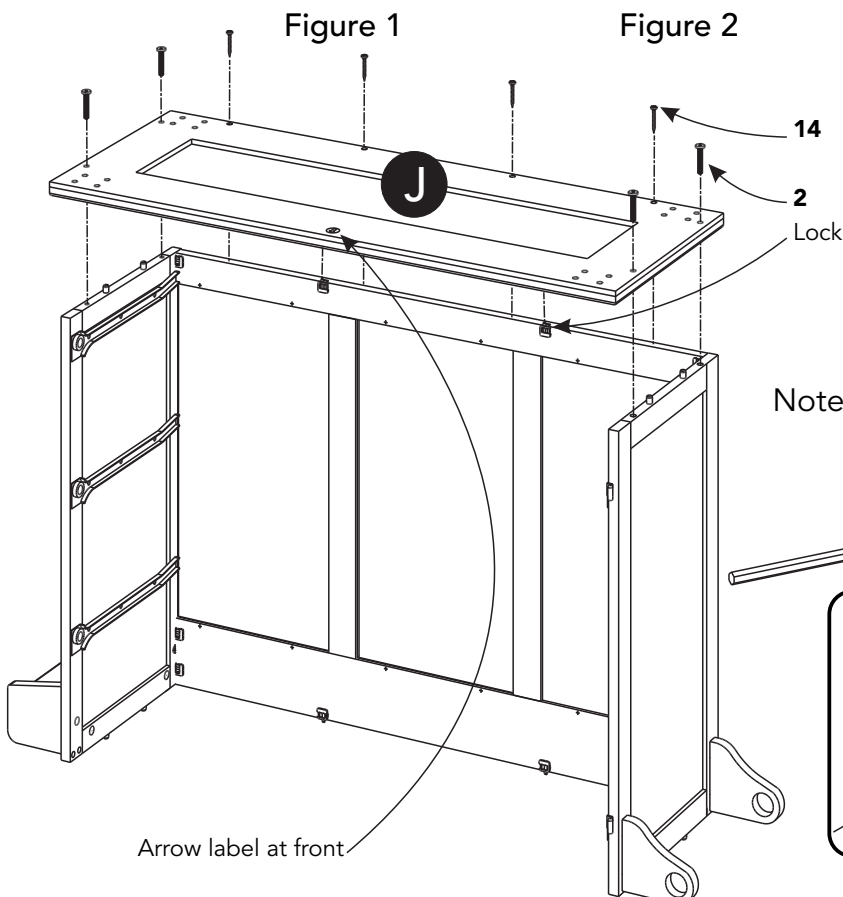

Figure 4

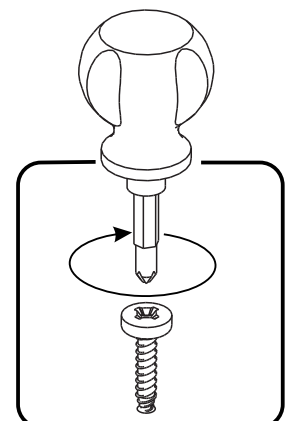

Figure 5

## STEP 6

Attach Casters (3) and (4) to unit with Head Cap Bolts for Caster (5).

Attach Locking Casters (3) at front.  
(See Figure 6)

Note: Arrow label indicates front of unit.

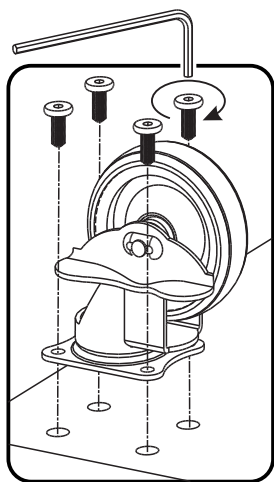
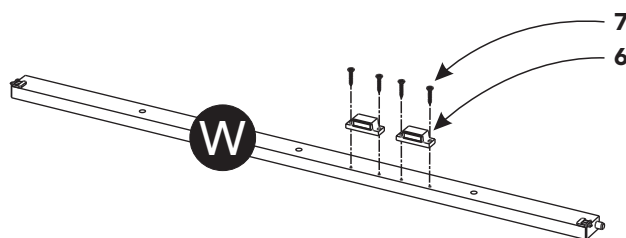
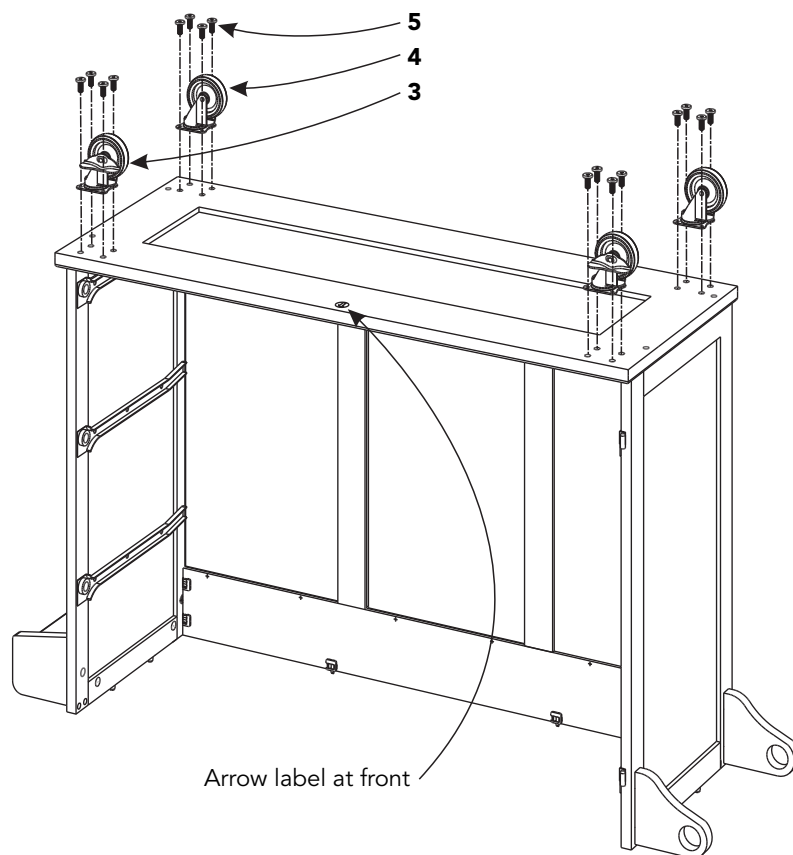

Figure 6



## STEP 7

Attach Magnets (6) to Front Rail (W) by inserting Wood Screw for Magnet (7) into pre-drilled holes, then tighten. (See Figure 7)

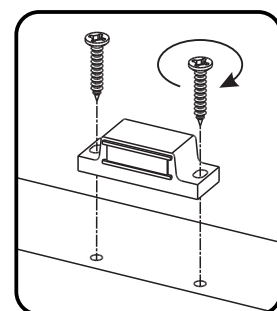

Figure 7

## STEP 8

Turn unit over to its upright position.

Turn all flip locks in Middle Panel (D), both side of Front Rails (I) and (W) to unlock position.

Attach Middle Panel (D) to unit, then flip Locks.

Attach Front Rails (I), (W) to unit, then flip Locks.

Slide Towel Bar (L) into position.

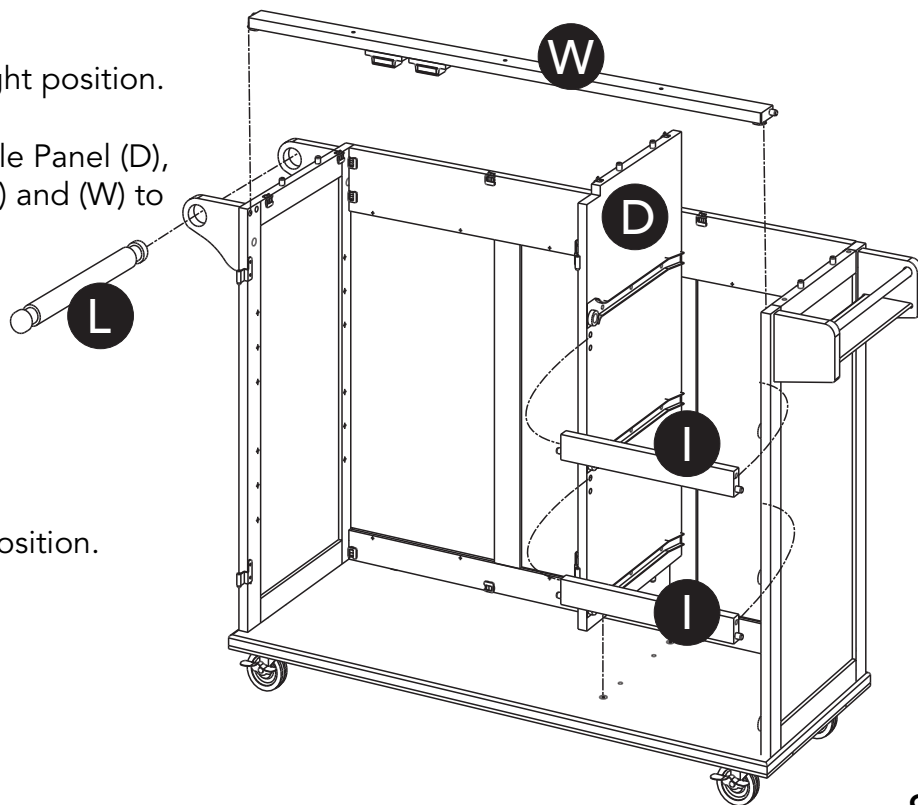

## STEP 9

Attach Doors (Q) and (R) by sliding door hinges into side panel and middle panel hinges. (See Figure 8)

Attach Knobs (8) to Doors (Q) and (R) with Machine Screws (9). (See Figure 9)

Attach Top (A) to unit, then flip Locks.

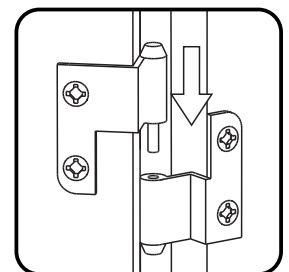
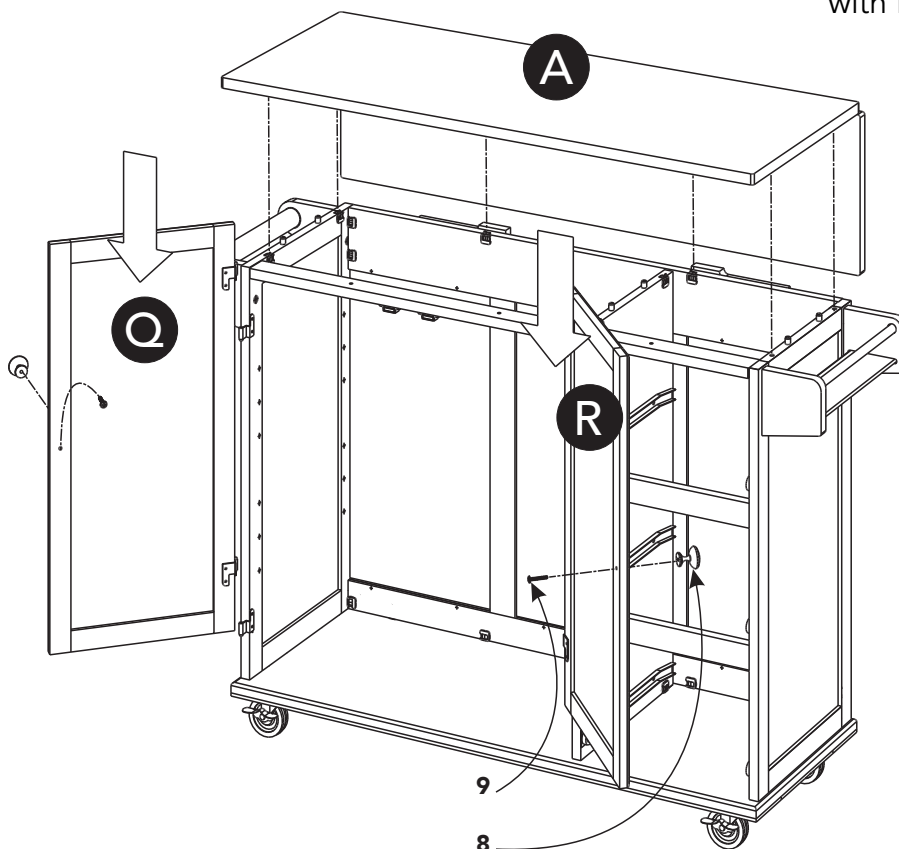

Figure 8

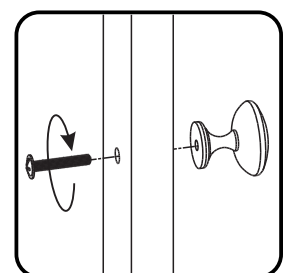
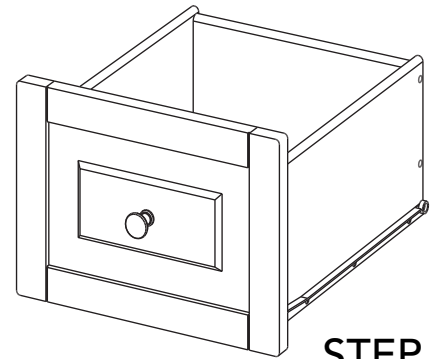
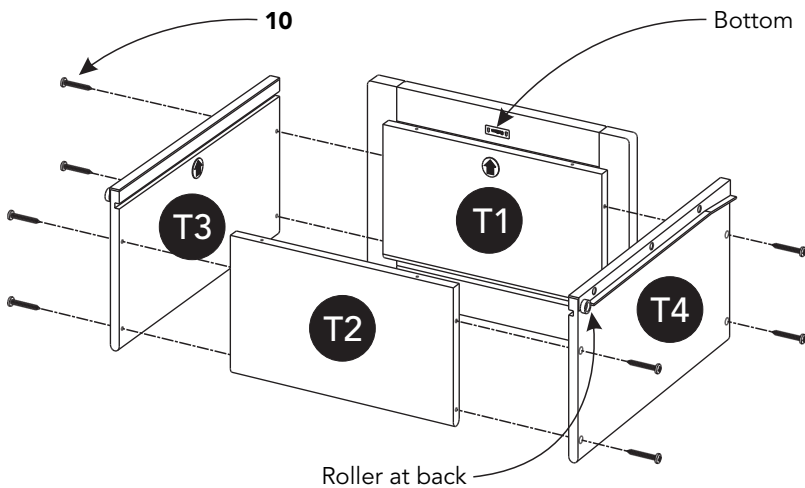

Figure 9

## Assembly Instructions 7/9

### Drawer (T)



#### STEP 10

Attach Drawer Front (T1) and Drawer Back (T2) to Drawer Side (T3) with Wood Screws (long) (10).

Attach Drawer Side (T4) to unit with Wood Screws (long) (10).

#### STEP 11

Slide Drawer Bottom (T5) into groove.  
Make sure holes on Bottom (T5) align with pre-drilled holes of unit.

Attach Drawer Bottom (T5) to unit with Wood Screws (short) (11).

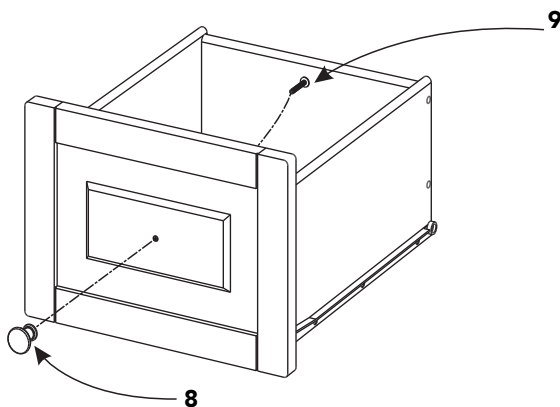
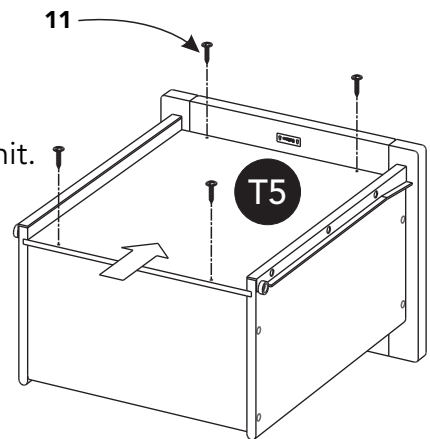

#### STEP 12

Attach Knob (8) to unit with Machine Screws (9).

### Part List

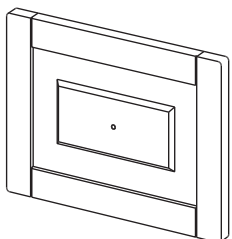

T1.  
Drawer Front  
3 pcs.

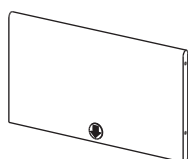

T2.  
Drawer Back  
3 pcs.

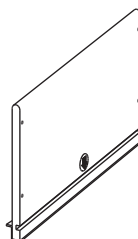

T3.  
Drawer Side  
3 pcs.

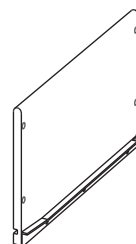

T4.  
Drawer Side  
3 pcs.

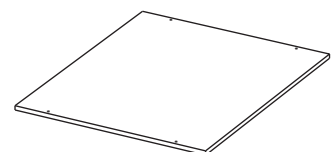

T5.  
Drawer Bottom  
3 pcs.

### STEP 13

Close the doors, then adjust doors gaps look proportional by move the unit  
(See Figure 10)

Open the doors slowly.

Insert Wood Screws (Short) (11) into pre-drilled holes in unit, then tighten.

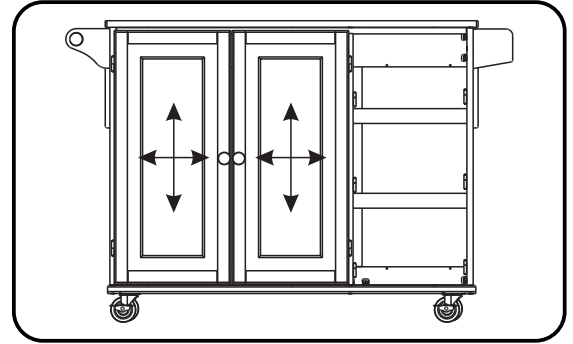
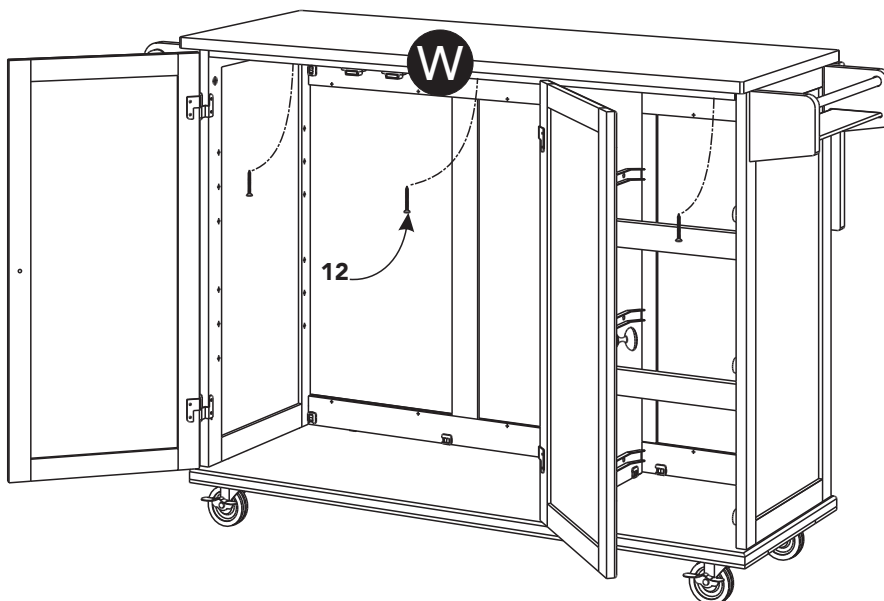
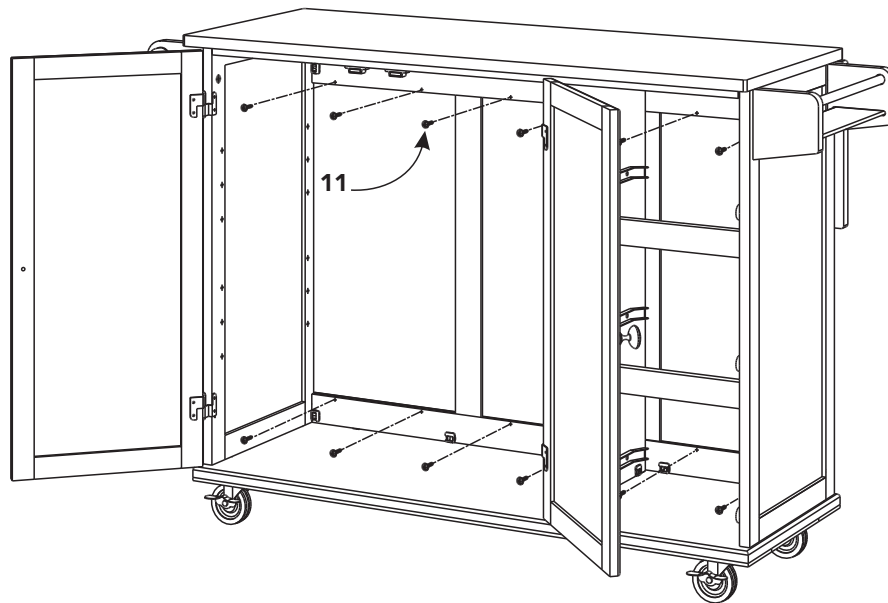

Figure 10



### STEP 14

Insert Wood Screws (12) into pre-drilled holes of Front Rail (W), then tighten.



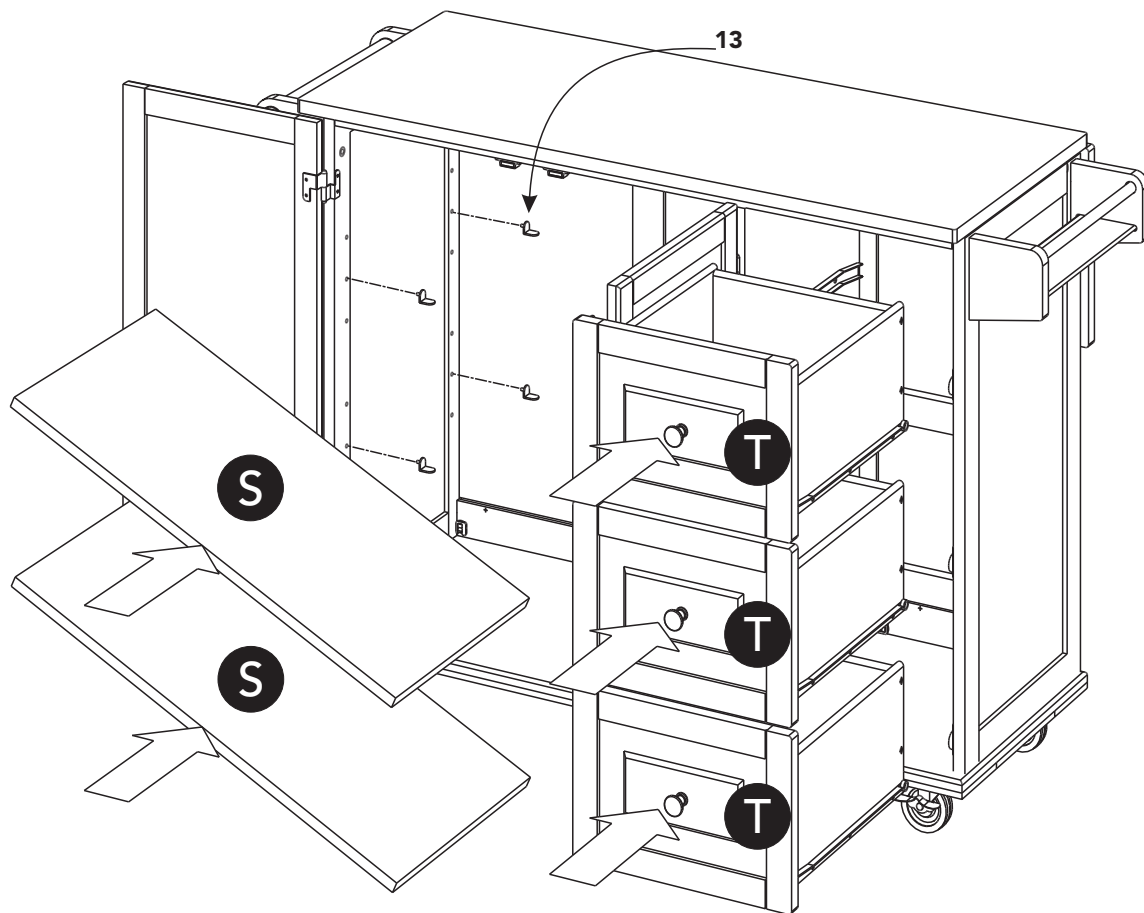

### STEP 15

Insert Adjustable Pins (13) into side panel and middle panel at desired level.  
(See Figure 11)

Place Shelves (S) into position.

Slide Drawers (T) into position.

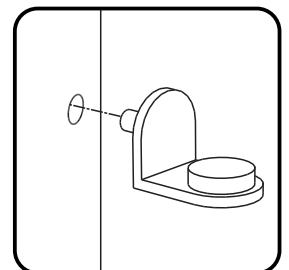

Figure 11

### IMPORTANT

- Avoid exceeding 12 kg load on the shelf and base.
- Should distribute weight evenly on the shelf and base.

# CARE INSTRUCTIONS

## NEVER

allow liquids to remain on furniture.  
Absorption causes parts to warp  
and split and finishes to delaminate.

## NEVER

use glass cleaners on  
finished furniture. Ammonia  
chemically attacks the finish.



Do not use power tools  
above 8 volts to assemble.

**PREVENT  
CRACKING**

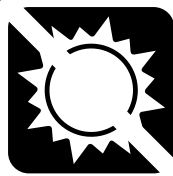

Do not place  
in direct sunlight.

**PREVENT  
FADING**



Do not write  
directly on surface.

**PREVENT  
MARKING**



Do not place hot  
objects on surface.

**PREVENT  
FINISH DAMAGE**

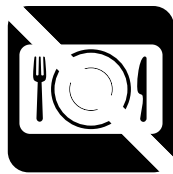

Do not use rubber  
based placemats.

**PREVENT  
DISCOLORING**



Do not use commercial  
waxes and polishes.

**PREVENT  
YELLOWING**

## CLEAN

with a soft cloth moistened  
in lukewarm soap and water.  
Buff with a dry clean cloth.



**homestyles** will provide replacements free of charge for missing or damaged parts within 30 days of purchase. Digital images of the defective parts may be required. If the product was not purchased from an authorized retailer, **homestyles** is under no obligation to provide replacement parts. Parts are not available for fully assembled items nor are parts available for sale. Replacements for missing or damaged parts may be requested via contact info below.

**homestyles** Customer Service: [www.homestylesfurniture.com](http://www.homestylesfurniture.com),  
[servicedesk@homestylesfurniture.com](mailto:servicedesk@homestylesfurniture.com), 888-680-7460