

Instructions

PRODUCT NUMBER 05724:WH 05725:BK

Do not fill with hot water.

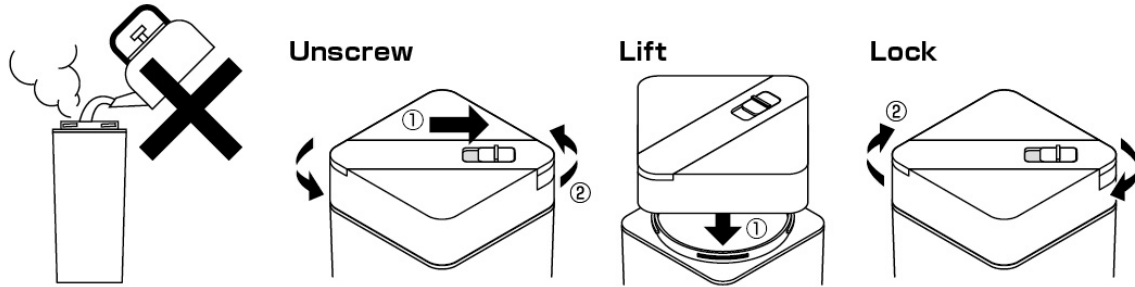

Lock, Unlock, and Open

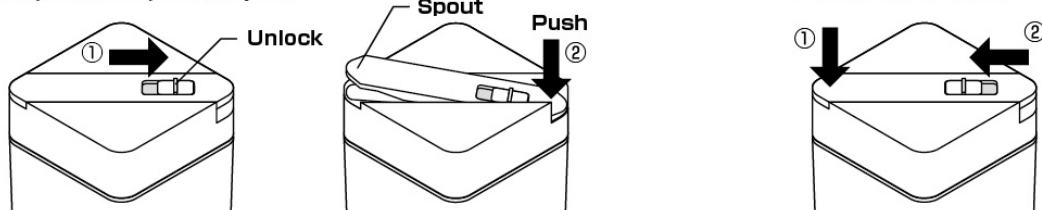

Lid Disassembly

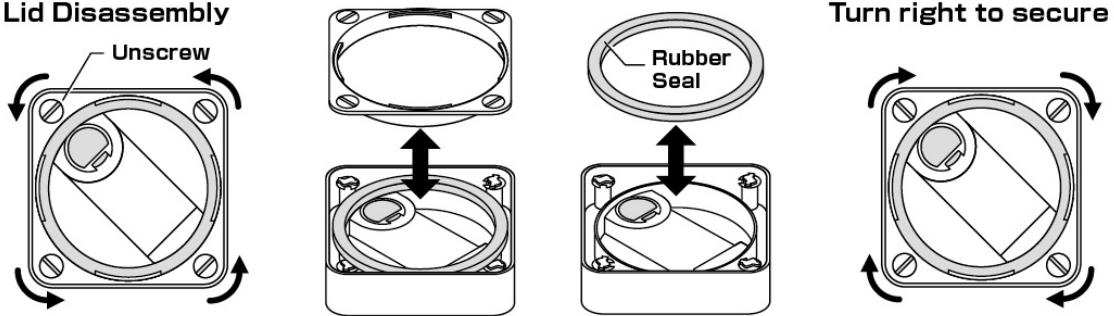

Spout Disassembly

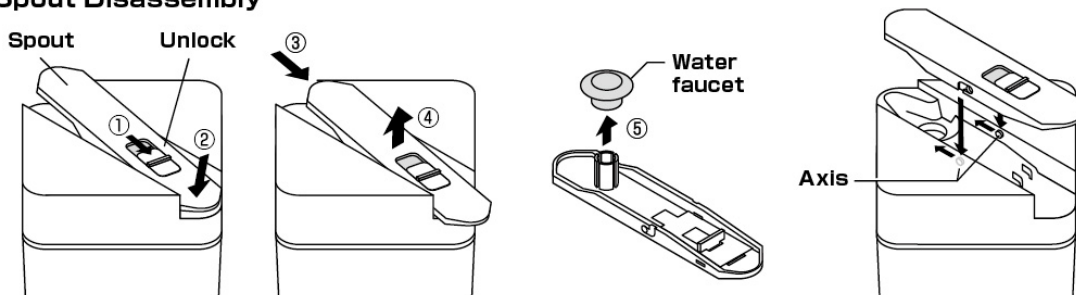

EN/
Tower Horizontal Laying
Water Container

SIZE
3.3" w x 3.3" d x 10.8" h
8.5w x 8.5d x 27.5h cm

MATERIAL
MS Resin , ABS Resin ,
PP Resin , Silicone
Made in China.
Designed in Japan.

FR/
Tower Conteneur D'eau
Horizontal

TAILLE
8.5w x 8.5d x 27.5h cm

MATÉRIEL
Résine MS , Résine ABS ,
Résine PP , Silicone
Fabriqué en Chine.
Conçu au Japon.

DE/
Tower Horizontal Liegender
Wasserbehälter

GRÖSSE
8.5w x 8.5d x 27.5h cm

MATERIAL
MS Kunststoff,
ABS Kunststoff,
PP Kunststoff, Silikon
In China hergestellt.
Entworfen in Japan.

ES/
Tower Contenedor De Agua
De Tendido Horizontal

TAMAÑO
8.5w x 8.5d x 27.5h cm

MATERIAL
Resina MS , Resina ABS ,
Resina PP , Silicona
Hecho en China.
Diseñado en Japón.

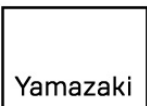

www.theyamazakihome.com

Imported by:
YAMAZAKI EUROPE GmbH / Immermannstr. 33, 40210 Düsseldorf, Germany
YAMAZAKI USA Inc. / 67 West St, Brooklyn, NY 11222 United States
YAMAZAKI Co., Ltd. / 奈良県生駒郡安堵町窪田851-1