

Executive Desk

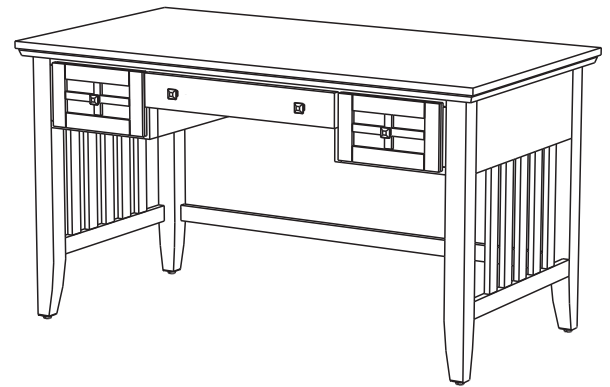

IMPORTANT

Carefully remove all the parts from the carton and place them individually on a soft cloth to prevent scratches or other damage.

Carefully and strictly follow these assembly instructions to ensure a completed product as designed.

Do not use power tools above 8 volts to assemble.

Part List



A.
Top
1 pc.

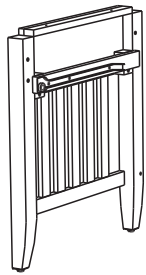

B.
Side Frame
1 pc.

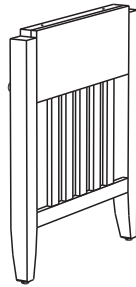

C.
Side Frame
1 pc.

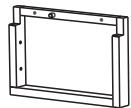

D.
Front Frame
1 pc.

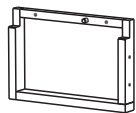

E.
Front Frame
1 pc.



F.
Front Rail
1 pc.

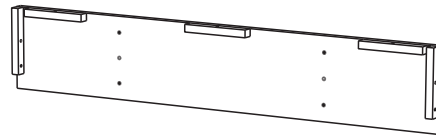

G.
Back Panel
1 pc.

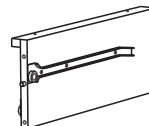

H.
Divider
1 pc.

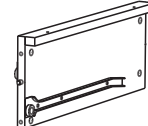

I.
Divider
1 pc.



J.
Stretcher
1 pc.

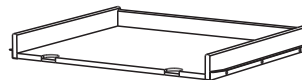

K.
Keyboard
1 pc.



L.
Keyboard
1 pc.

M.
Drawer
2 pcs.

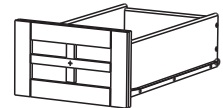

Refer to later page(s) of these instructions for drawer assembly.

Hardware List



Hex Wrench
1 pc.

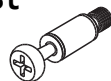

Cam Lock Screw
8 pcs. (+1 extra)



M3x32
Wood Screw (long)
6 pcs. (+1 extra)



M3x25
Wood Screw
16 pcs. (+1 extra)

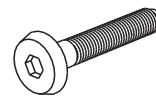

M6x32
Head Cap Bolt
21 pcs. (+1 extra)



Spring Washer
21 pcs. (+1 extra)



Small Hex Wrench
1 pc.



Cam Lock
8 pcs. (+4 extra)



M3x16
Wood Screw (short)
8 pcs. (+1 extra)



M3x10
Wood Screw for Hinge
6 pcs. (+1 extra)



Flat Washer
21 pcs. (+1 extra)



M4x38
Machine Screw
4 pcs.

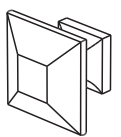

Knob
4 pcs.

Tool(s) required for assembly: Phillips screwdriver, Level

Assembly Instructions 2/6

IMPORTANT

- Use a soft cloth between these parts and the floor.
- Do not use power tools above 8 volts to assemble.
- The unit must be level to work properly. Use the included adjustable levelers to level.
- Keep Hex Wrench as bolts may need to be tightened in the future.

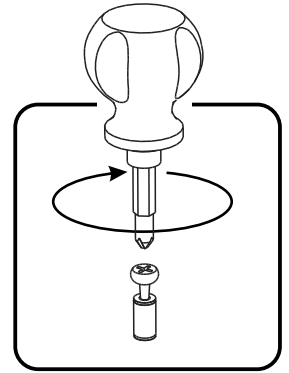
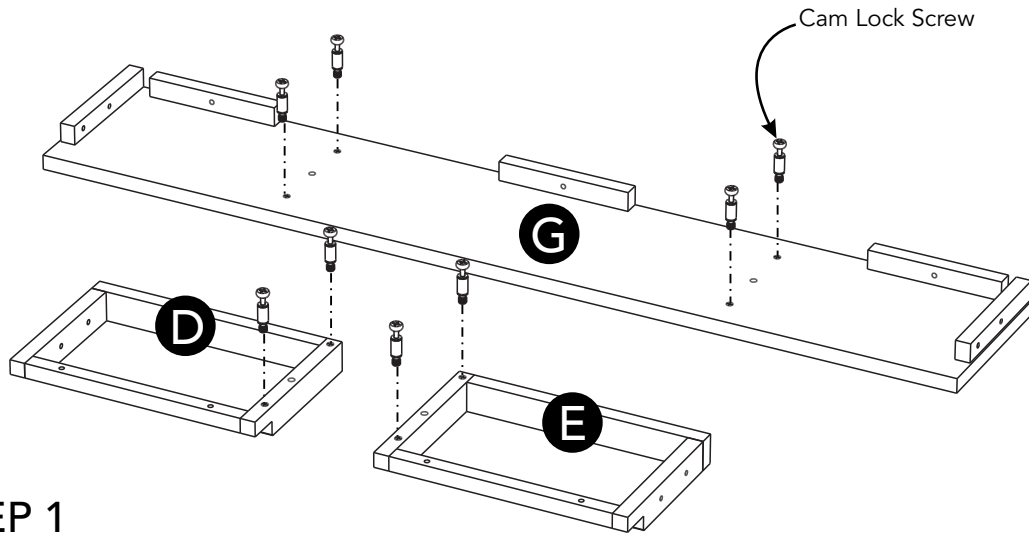

Figure 1

STEP 1

Insert Cam Lock Screws into pre-drilled holes in Front Frames (D), (E) and Back Panel (G), then tighten. (See Figure 1)

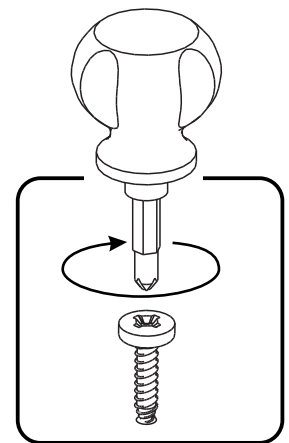
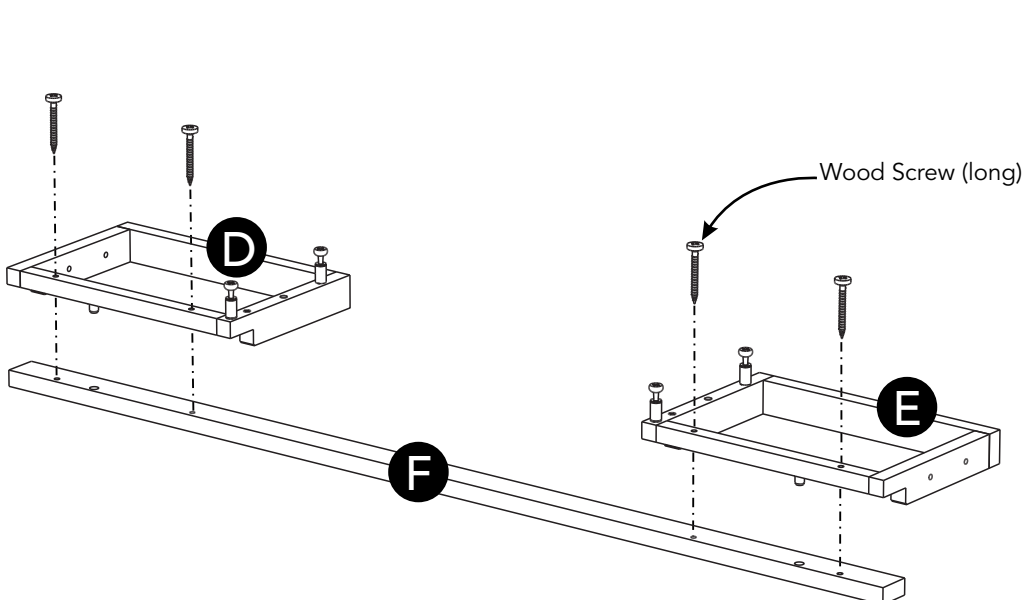

Figure 2

STEP 2

Attach Front Frames (D) and (E) to Front Rail (F) with Wood Screws (long).
(See Figure 2)

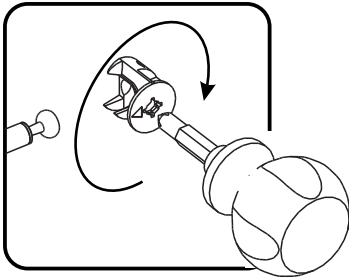
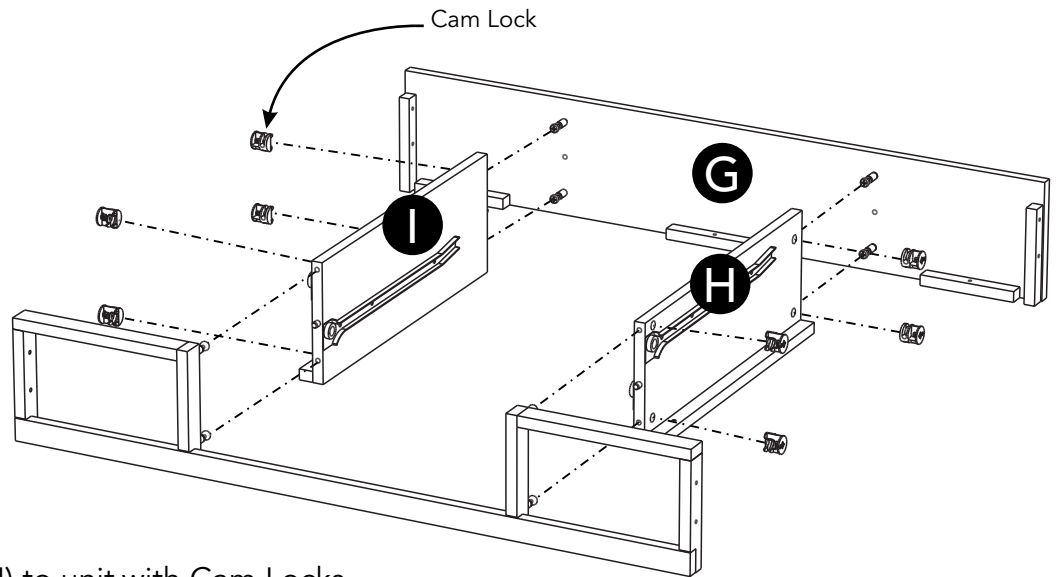

Figure 3



STEP 3

Attach Dividers (H) and (I) to unit with Cam Locks.
(See Figure 3)

Attach Back Panel (G) to unit with Cam Locks.

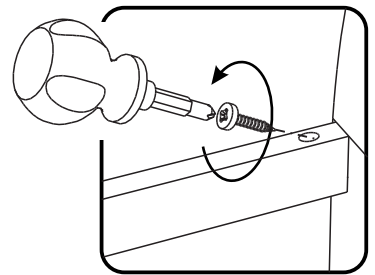
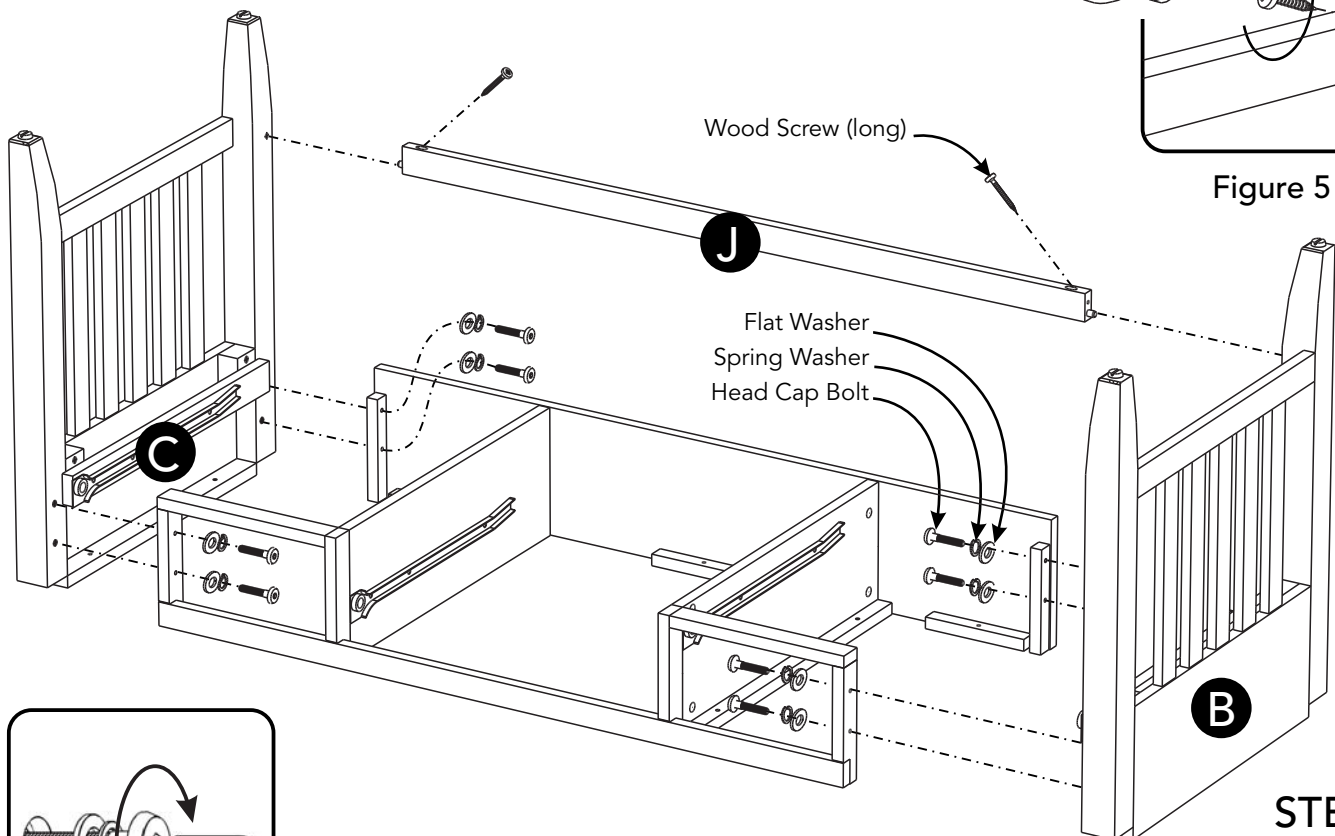

Figure 5



STEP 4

Attach Side Frame (B) to unit with
Flat Washers, Spring Washers and Head Cap Bolts. (See Figure 4)

Attach Stretcher (J) to unit with Wood Screw (long). (See Figure 5)

Attach Side Frame (C) to unit with Flat Washers, Spring Washers, Head Cap Bolts
and Wood Screw (long).

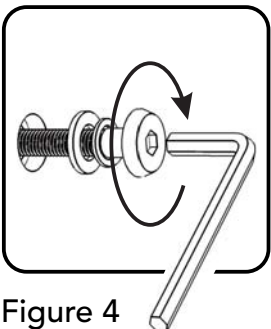
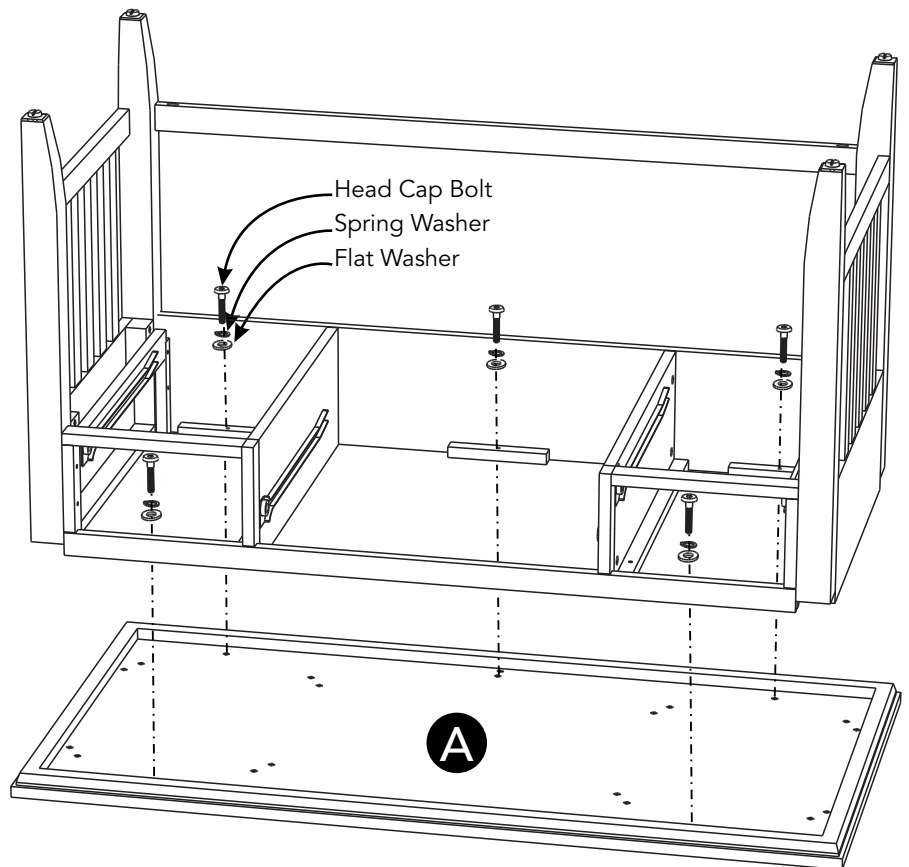

Figure 4

Assembly Instructions 4/6



STEP 5

Place Top (A) upside down on a soft cloth.

Attach unit to Top (A) with Flat Washers, Spring Washers and Head Cap Bolts.

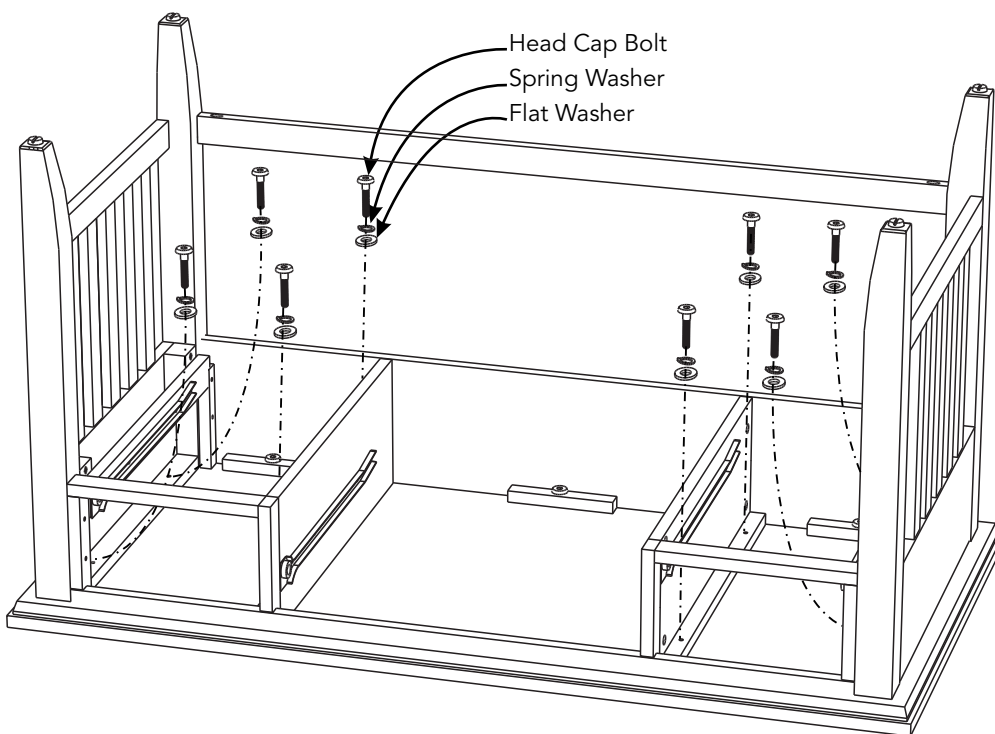

STEP 6

Insert Flat Washers, Spring Washers and Head Cap Bolts into pre-drilled holes, then tighten.

Assembly Instructions 5/6

Drawer (M)

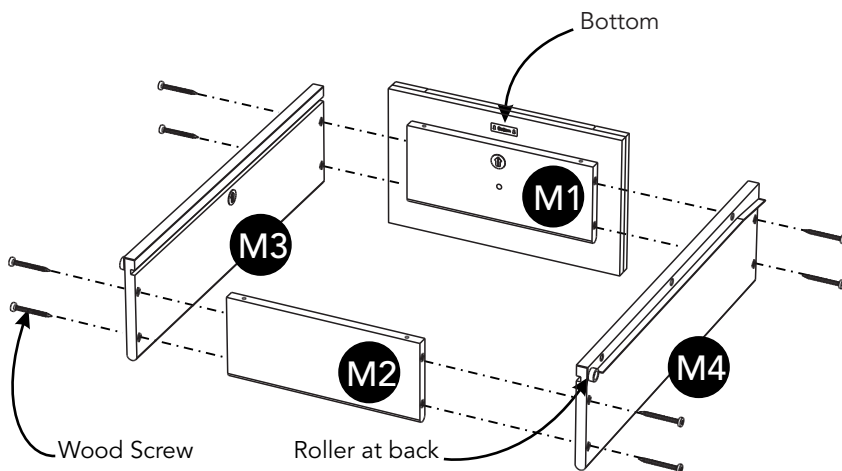

STEP 7

Attach Drawer Front (M1) and Drawer Back (M2) to Drawer Side (M3) with Wood Screws.

Attach Drawer Side (M4) to unit with Wood Screws.

STEP 8

Slide Drawer Bottom (M5) into groove.

Attach Drawer Bottom (M5) to unit with Wood Screws (short).

Wood Screw (short)

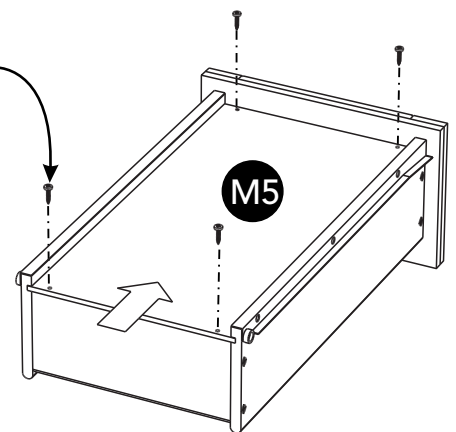

STEP 9

Attach Knob with Machine Screw.

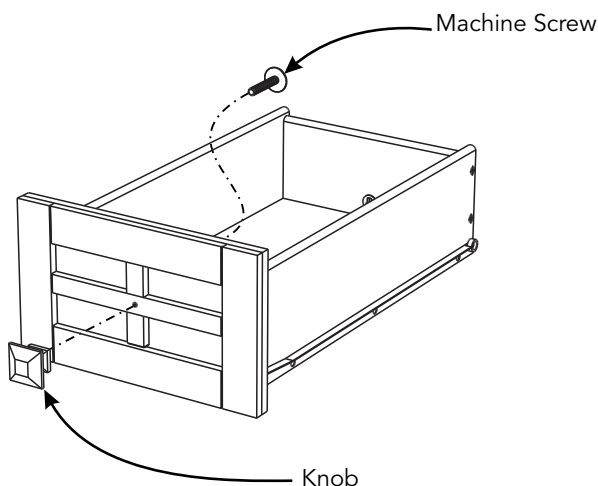

Part List

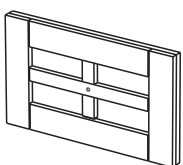

M1.
Drawer Front
2 pcs.

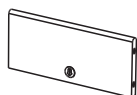

M2.
Drawer Back
2 pcs.

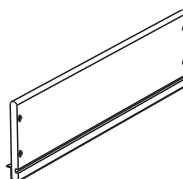

M3.
Drawer Side
2 pcs.

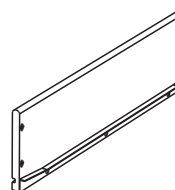

M4.
Drawer Side
2 pcs.

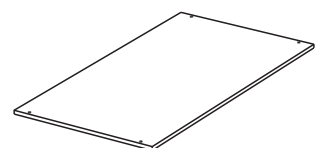

M5.
Drawer Bottom
2 pcs.

STEP 10

Attach Keyboard (L) to Keyboard (K) with Wood Screws for Hinge.

Attach Knobs to keyboard with Machine Screws.
(See Figure 6)

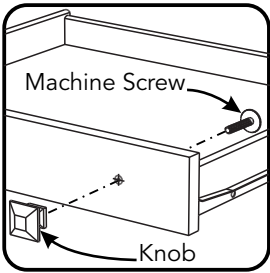
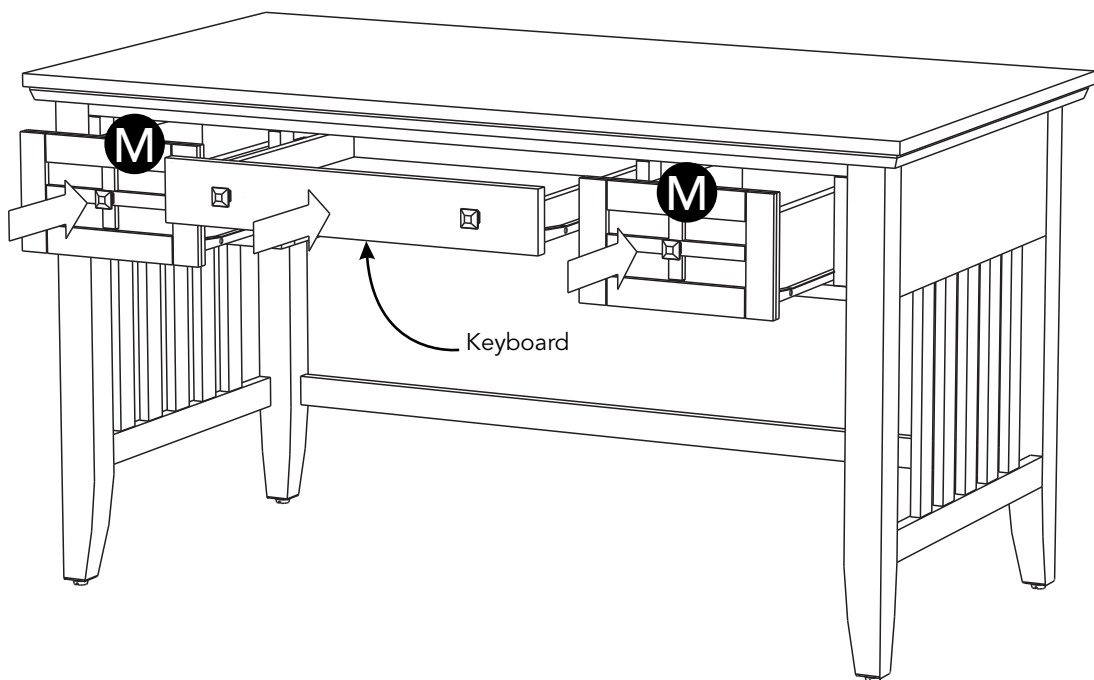
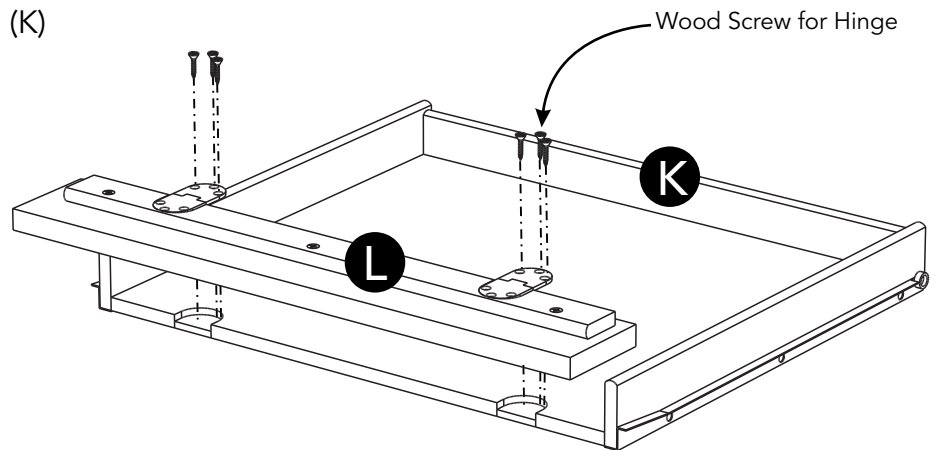

Figure 6



STEP 11

Turn unit over to its upright position.

Slide keyboard and Drawers (M) into position.

Level unit by adjusting the adjustable levelers on bottom of unit.
(See Figure 7)

Note: Unit must be level to work properly.

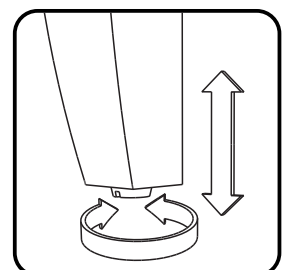

Figure 7

CARE INSTRUCTIONS

NEVER

allow liquids to remain on furniture.
Absorption causes parts to warp
and split and finishes to delaminate.

NEVER

use glass cleaners on
finished furniture. Ammonia
chemically attacks the finish.



Do not use power tools
above 8 volts to assemble.
**PREVENT
CRACKING**

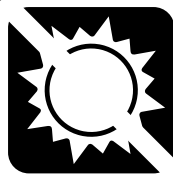

Do not place
in direct sunlight.
**PREVENT
FADING**



Do not write
directly on surface.
**PREVENT
MARKING**



Do not place hot
objects on surface.
**PREVENT
FINISH DAMAGE**

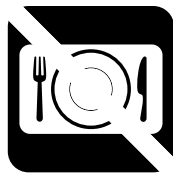

Do not use rubber
based placemats.
**PREVENT
DISCOLORING**



Do not use commercial
waxes and polishes.
**PREVENT
YELLOWING**

CLEAN

with a soft cloth moistened
in lukewarm soap and water.
Buff with a dry clean cloth.



homestyles will provide replacements free of charge for missing or damaged parts within 30 days of purchase. Digital images of the defective parts may be required. If the product was not purchased from an authorized retailer, **homestyles** is under no obligation to provide replacement parts. Parts are not available for fully assembled items nor are parts available for sale. Replacements for missing or damaged parts may be requested via contact info below.

homestyles Customer Service: www.homestylesfurniture.com,
servicedesk@homestylesfurniture.com, 888-680-7460