

Brookings Fully Assembled, 2-Door 2-Drawer Vanity, 36x21x31.5 in.
Gray Base

**FULLY
ASSEMBLED
VANITY**

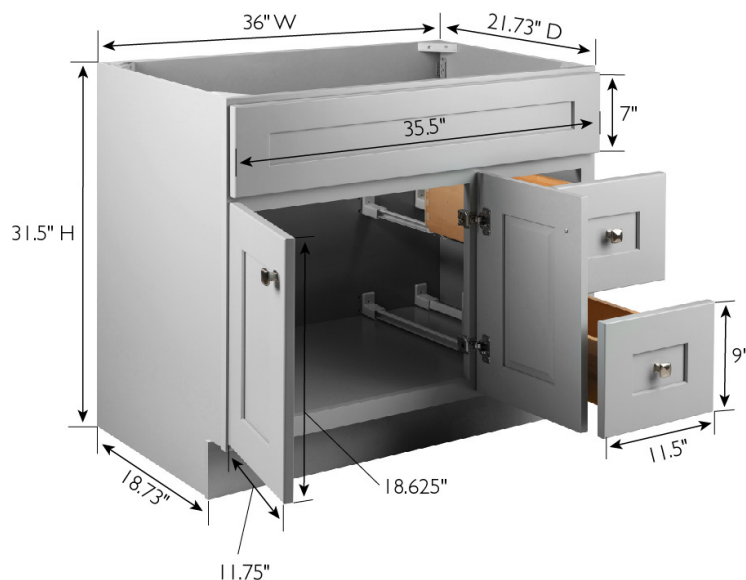

SPECIFICATIONS

MATERIAL CONSTRUCTION:	Wood
ASSEMBLY REQUIRED:	No
TOOLS NEEDED FOR ASSEMBLY:	100% Silicone
ASSEMBLED DIMENSIONS:	31.5" H x 36" L x 21.73" D
ASSEMBLED WEIGHT:	85.36 lbs.
HINGE STYLE:	Soft Close
DOOR STYLE:	2 Raised Panel Doors
DRAWER STYLE:	2 Drawers
GLIDE STYLE:	STD Easy Glide
DWR DIMENSIONS:	4.25" H x 7.125" L x 16.75" D
DWR CONSTRUCTION:	Dove Tail

CONSTRUCTION TYPE:	Face Frame
FACE FRAME MATERIAL:	Solid Wood
SIDES MATERIAL:	Plywood
BOTTOM MATERIAL:	Plywood
TOE KICK INSET WIDTH:	3"
BACK PANEL MATERIAL:	Plywood
BACK BRACE MATERIAL:	Solid Wood
FAKE DWR FACE MATERIAL:	MDF
DRAWER FACE MATERIAL:	Solid Wood

WARRANTY: 1-Year limited warranty
TITLE IV COMPLIANT: Yes
PROP 65 HARMFUL MATERIAL: Formaldehyde



TYPE:
JOB:
ORDER CODE:
APPROVALS: