

DWG. NO.		SDRP11W1S-1000	
REV	DESCRIPTION	BY DATE	APPD
D	ECR 7795	JEN 07/18/03	JED

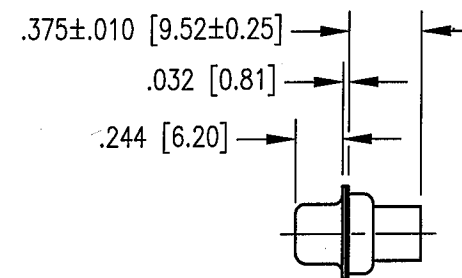
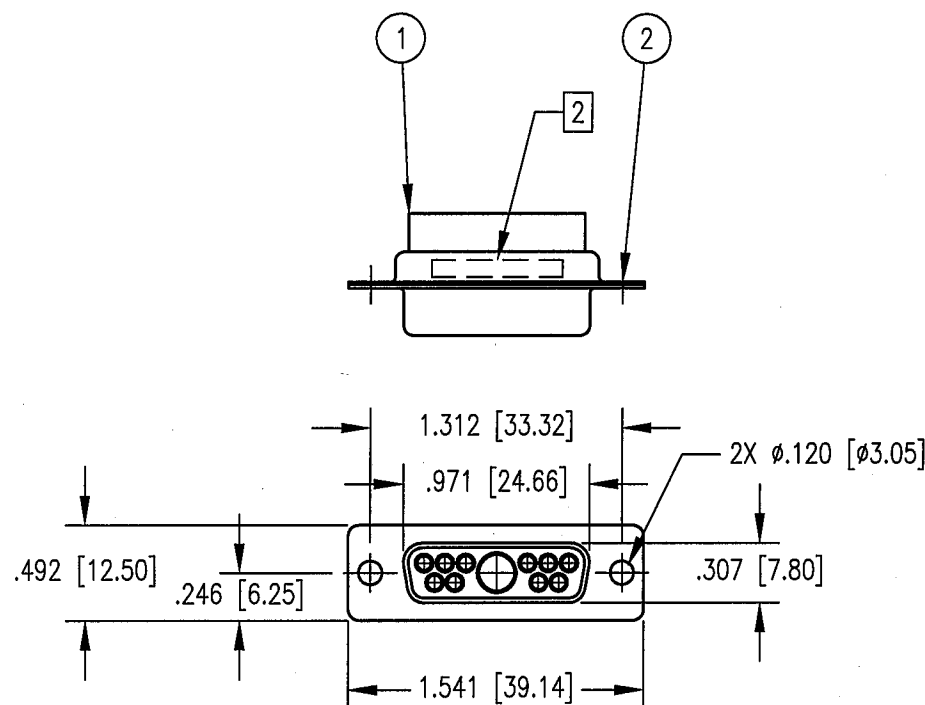

NOTES:

- THIS CONNECTOR IS DESIGNED TO MEET THE APPLICABLE PERFORMANCE REQUIREMENTS OF MIL-DTL-24308, MS18271, DSCC 85039 AND DCSS 85041.
- LOCATION OF MARKING: JSC11W1S 07418.
APPROXIMATELY AS SHOWN ON INDICATED SURFACE.

SPECIFICATIONS: MATERIALS & FINISHES

- INSULATOR: THERMOPLASTIC POLYESTER, GLASS FILLED
RATED 50 KV/MM. COLOR: GREEN
- SHELL: STEEL
FINISH: YELLOW CHROMATE OVER ZINC

CUSTOMER REQUIREMENTS

DESCRIPTION	CONTACT	INSERTION TOOL	REMOVAL TOOL	SEALING PLUG
SIZE 20	10-4010G03	M81969/39-01 M81969/1-02	T-2002	10-308
SIZE 8	CONSULT FACTORY	N/A	T-1000	10-309

PER ASME Y14.5M-1994 UNLESS OTHERWISE SPECIFIED: DIMENSIONS ARE IN INCHES (MM)		NORTHROP GRUMMAN	
TOLERANCES: DECIMALS .XX ± .01 [0.254] .XXX ± .005 [0.127] ANGLES ± 2°		Winchester Electronics 62 Barnes Industrial Road North Wallingford, CT 06482	
CUSTOMER DRAWING		TITLE 11W1S MONO BLOCK FOR JOSLYN SUNBANK	
DRAWN JEM	DATE 9/18/02	CHECKED JWH	DATE 9/23/02
APPROVED KJT	DATE 9/23/02	APPROVED JED	DATE 9/23/02
A		SDRP11W1S-1000	SHT. 1 OF 1 REV. D