

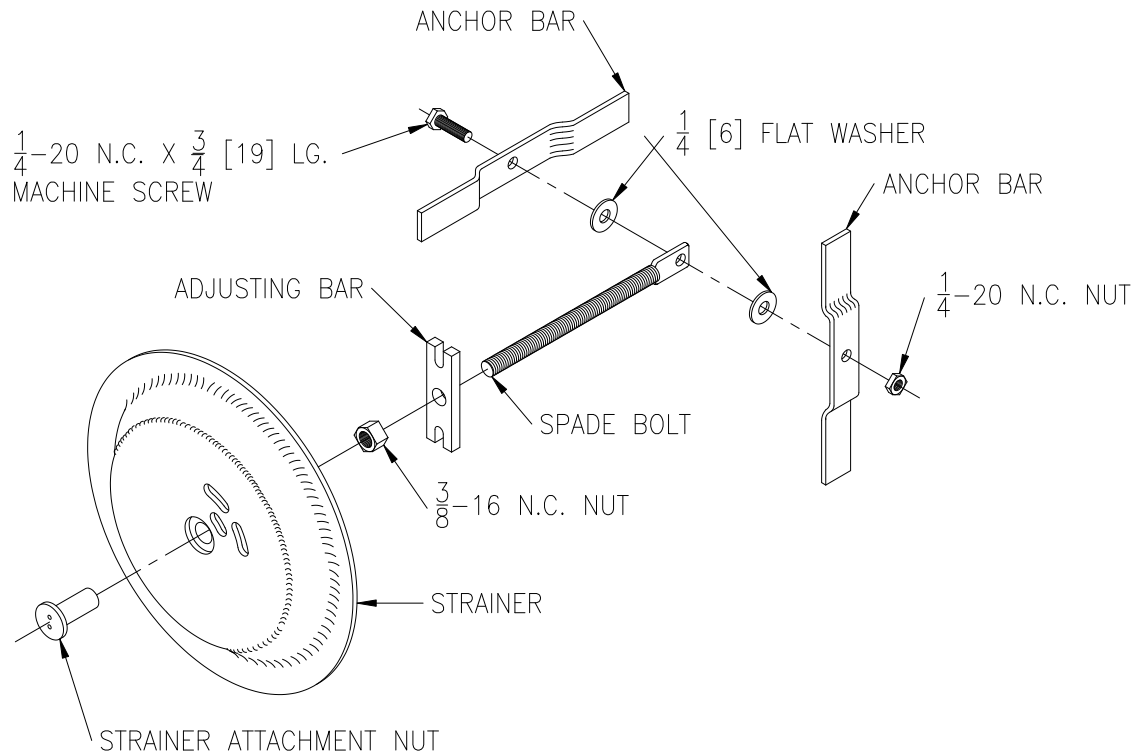

Z1471

ASSEMBLY INSTRUCTIONS FOR PIPE CLAMP HARDWARE

Dimensional data (inches and [mm]) are subject to manufacturing tolerances and change without notice.



Z1471 PIPE CLAMP HARDWARE

1. Assemble the two anchor bars (with formed offsets towards spade bolt) to spade bolt using:
 - (1) 1/4-20 NC x 3/4 [19] Long Machine Screw
 - (1) 1/4-20 NC Nut
 - (2) 1/4 [6] Flat Washers

Place a 1/4 [6] flat washer on each side of spade bolt, then place an anchor bar on each side of the 1/4 [6] flat washer (A 1/4 [6] flat washer goes between the spade bolt and anchor bar on each side). Place the 1/4-20 NC x 3/4 [19] long machine screw through the entire assembly and thread on the 1/4-20 NC nut.

Note that the 1/4-20 NC machine screw and nut holding the anchor bars (in an "x" configuration) to the spade bolt should not be tightened. The nut should be run onto the machine screw until 4 or 5 threads of the machine screw are past the nut.

2. Slide the adjusting bar onto the threaded end of the spade bolt.
3. Thread the 3/8-16 NC nut onto the threaded end of the spade bolt in front of the adjusting bar.
4. DO NOT attach the strainer and strainer attachment nut, these will be used at final installation (see page 2). The assembly is ready to be installed in pipe.

⚠ WARNING: Cancer and Reproductive Harm - www.P65Warnings.ca.gov

⚠ ADVERTENCIA: Cáncer y daño reproductivo - www.P65Warnings.ca.gov

⚠ AVERTISSEMENT: Cancer et effets néfastes sur la reproduction - www.P65Warnings.ca.gov

Zurn Industries, LLC | Specification Drainage Operation
1801 Pittsburgh Avenue, Erie, PA U.S.A. 16502 · Ph. 855-663-9876, Fax 814-454-7929
In Canada | Zurn Industries Limited
3544 Nashua Drive, Mississauga, Ontario L4V 1L2 · Ph. 905-405-8272, Fax 905-405-1292
www.zurn.com

Rev. C
Date: 5/21/2018
C.N. No. 140053
Form No. CO1