

FEATURES & SPECIFICATIONS

INTENDED USE — The MS Series LED is a linear solution ideal for open-ceiling or suspended applications with mounting heights from 14 to 20 feet. Available as a complete luminaire, based on the time-tested MS housing, the traditional fixture design offers time-saving installation options making it a favorite for contractors. It can be mounted in a continuous row or as a stand-alone unit. Its full-body construction and multiple mounting options adapt to a wide variety of suspended and open-ceiling applications.

Certain chemicals that may exist in end-user locations release airborne contaminants that can impact the integrity and safety of key fixture components. Please refer to the environmental compatibility chart located in the Product Selection Guide and/or the company website to ensure that these chemical interactions are considered when selecting fixtures. For additional information please consult an authorized factory representative. Certain airborne contaminants can diminish integrity of acrylic. [Click here for Acrylic Environmental Compatibility table for suitable uses.](#)

CONSTRUCTION — The full-body housing and optical assembly is precision-formed using 20-gauge steel. The optical assembly ships factory-installed into the housing and utilizes aircraft cable tethers to support the optical assembly during wiring. The lensing integrates seamlessly into the optical housing to provide a sealed chamber to mitigate dust and insect collection. A convenient access plate is located on the back of the channel for access to the wiring compartment.

Finish: High-gloss, baked white enamel finish. Five-stage iron phosphate pretreatment ensures superior paint adhesion and rust resistance.

OPTICS — Optical design distributes the light in the 0-60 deg. zone, which provides better utilization of light on task. Each linear bar is outfitted with premium, anodized MIRO 5° aluminum to ensure the highest lumens per watt can be achieved. A diffuse acrylic lens eliminates the pixels to minimize glare and improve uniformity.

ELECTRICAL — The MSL luminaire has 83% lumen maintenance at 60,000 hours with an expected life of greater than 100,000 hours. The MSL ships standard with a thermally protected dimming driver that dims down to 5% using 0-10V controls. Please refer to <http://www.synergylightingcontrols.com/ProductBrochures.aspx> for dimming solutions. You may also contact the Synergy Support at 800-533-2719 or Support@SynergyLightingControls.com. LEDs are driven to provide optimal lumens per watt and less heat to extend component life. The driver and optical housing are connected with mating plug for easy removal or future upgrade. Optional 12AWG through-wire harnesses is available for continuous-row installations.

INSTALLATION — A variety of mounting arrangements are available including tong hangers, aircraft cables and stems. Suitable for mounting in continuous-row or individual mounting. End caps include knockouts for through wiring and fixture attachment in row-mounting applications.

LISTINGS — UL and cUL listed to US and Canadian standards. For use in damp and dry locations with ambient temperatures ranging from -20°C (-4°F) to 30°C (86°F).

WARRANTY — Five-year limited warranty. Full warranty terms located at: www.acuitybrands.com/CustomerResources/Terms_and_conditions.aspx

Note: Specifications subject to change without notice.

Actual performance may differ as a result of end-user environment and application.

Catalog Number
Notes
Type

MSL

LED Low Bay
Complete Luminaire
4' or 8' Lengths



Dimensions				
All dimensions are shown in inches (centimeters) unless otherwise noted.				
SERIES	LENGTH	WIDTH	DEPTH	WEIGHT
TMLS	96 (243.8)	10 (25.4)	3-1/4 (8.26)	26 lbs. (11.8 kg)
MSL	48 (121.9)	10 (25.4)	3-1/4 (8.26)	13 lbs. (5.9 kg)

ORDERING INFORMATION

Lead times will vary depending on the options selected. Consult with your sales representative.

Example: MSL 4L LP835 PLR22G

Series	Lumens	Voltage	Color temperature	Options
MSL	4L 4,100 lumens ¹	(blank) MVOLT ³	LP835 3500K, 83 CRI	(blank) End caps have flattened knockouts made for individual mounting
MSL	3L CLO 3,300 lumens ²	120 120V	LP840 4000K, 83 CRI	PLR1G Single-circuit, plug-in wiring
TMSL	8L 8,200 lumens	277 277V	LP850 5000K, 83 CRI	PLR22G Two-circuit alternating plug-in wiring
TMSL	6L CLO 6,600 lumens ²			PLR1LVG Single-circuit plug-in wiring with low-voltage leads
				GLR Internal fast-blow fuse ⁴
				CS93W 600 SO white cord, no plug
				CS11W 6' white cord-set, twist-lock NEMA L7-15P, 277V ⁴
				CS1W 6' white cord-set, straight blade NEMA 5-15P, 120V ⁴
				MSI Aisle motion sensor, pre-wired ⁴
				MSID Occupancy sensor, prewired, HI/LO dimming control ⁴
				CRE Continuous row end; one hole for wiring to row, one flattened knockout to terminate the row
				CRM Continuous row middle; both end plates have holes for row wiring

Accessories: Order as separate catalog number.	
MSHBAC_	Adjustable aircraft cable system (specify 36, 72 or 120 inches) ⁵
MSHBACF_	Adjustable aircraft cable system with power feed (specify length as 36, 72 or 120 inches) (three-wire cable) ⁵
MSHBAC2F_	Adjustable aircraft cable system with power feed (specify length as 36, 72 or 120 inches) (four-wire cable) ⁵
SQ_	Swivel-stem hanger (specify lengths in 2" increments)
THMS5HB	Tong hangers
WGM58Z	4' wire guard, zinc coated

Notes

- 1 DesignLights Consortium® (DLC) qualified for MSL only.
- 2 Refer to Constant Lumen Output (CLO) chart on page 2.
- 3 MVOLT 120-277 only.
- 4 Specify voltage.
- 5 One cable per package.

Operational Data

Lumen Package	Ambient Rating (120V - 277V)	Delivered Lumens 3500K CCT @ 25°C Ambient Temperature	Delivered Lumens 4000K CCT @ 25°C Ambient Temperature	Delivered Lumens 5000K CCT @ 25°C Ambient Temperature	Wattage @ 120V, 277V	Comparable Light Source
4L	-4°F(-20°C) to 86°F(30°C)	4083	4064	4139	44.4	1-lamp 54T5HO, 2-lamp 32T8, 70-100W HID
3L CLO	-4°F(-20°C) to 86°F(30°C)	3266	3251	3311	35.5	1-lamp 54T5HO, 2-lamp 32T8, 70-100W HID
8L	-4°F(-20°C) to 86°F(30°C)	8140	8102	8252	85.2	2-lamp 54T5HO, 4-lamp 32T8, 150-175W HID
6L CLO	-4°F(-20°C) to 86°F(30°C)	6512	6482	6601	68.2	2-lamp 54T5HO, 4-lamp 32T8, 150-175W HID

Projected Lumen Maintenance

Operating Hours	0	10,000	20,000	30,000	40,000	50,000	60,000	100,000
Projected Relative Lumen Output	1	0.94	0.92	0.90	0.87	0.85	0.85	0.76

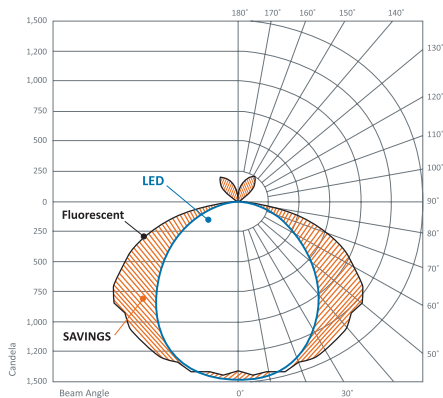

The illustration shows a traditional source superimposed over the MS Series LED, and the wasted light that is eliminated to drive the lumens-per-watt to greater than 93.

Lighting precision

Use the MS Series LED in open indoor spaces or for aisle lighting. Light-shaping reflectors and diffusers provide precise, custom optics while minimizing wasted light and hot spots. Color-temperature options give you three choices to best suit your application.

Energy efficiency

The MS Series LED cuts operational lighting costs by more than 40% over traditional T8 fluorescent lighting. The long life of the LED technology also means reduced maintenance-cycle costs, while the ability to dim the MS Series LED brings even greater energy savings.

Constant Lumen Output

Constant Lumen Output (CLO) is a technology that programs the luminaire to emit a constant lumen output over the life of the product. The input power is reduced from day one, and during the lifecycle, power is slowly increased to maintain the light output of a new luminaire.

Controls integration

For extra energy efficiency, pair the MS Series LED with occupancy sensors and photocontrols from Sensor Switch® or Lighting Control & Design. In addition, daylighting products from Sunoptics® provide tremendous cost savings by harvesting the light of the sun.

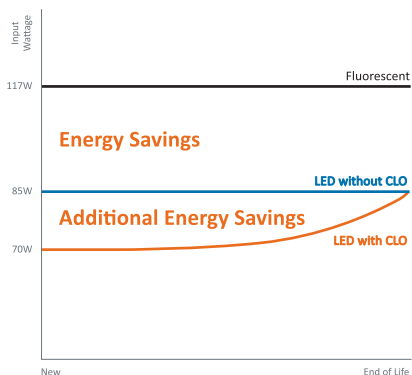

MSL LED Low Bay

Mounting Data

For unit or row installation, surface or stem mounting.

Unit installation — Minimum of two hangers required.

Row installation — One hanger per channel plus one per row required.

Hanging devices illustrated below.

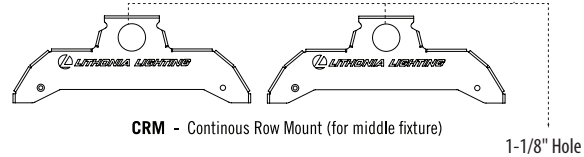
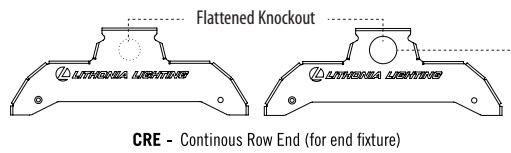
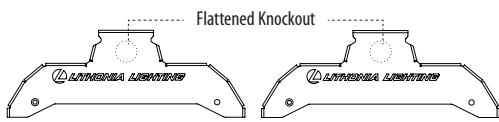
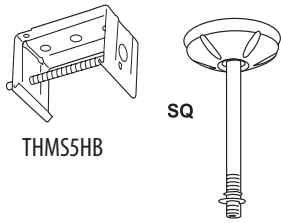

Dimensions

All dimensions are inches (centimeters).

3-Lamp

- A = 7/8 (2.2) KO
- B = 3/4 (1.9) KO
- C = 2-3/8 (6.0)
- D = 1-1/4 (3.2)
- E = 2-3/8 (6.0)
- F = 1-3/8 (3.5)

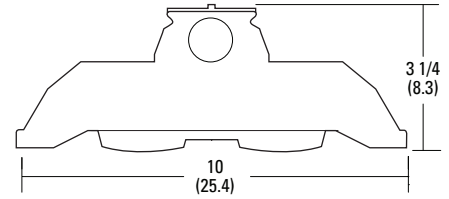

4-Lamp

- B = 3/4 (1.9) KO
- C = 2-3/8 (6.0)
- D = 1-1/4 (3.2)
- E = 2-3/8 (6.0)
- F = 1-3/8 (3.5)

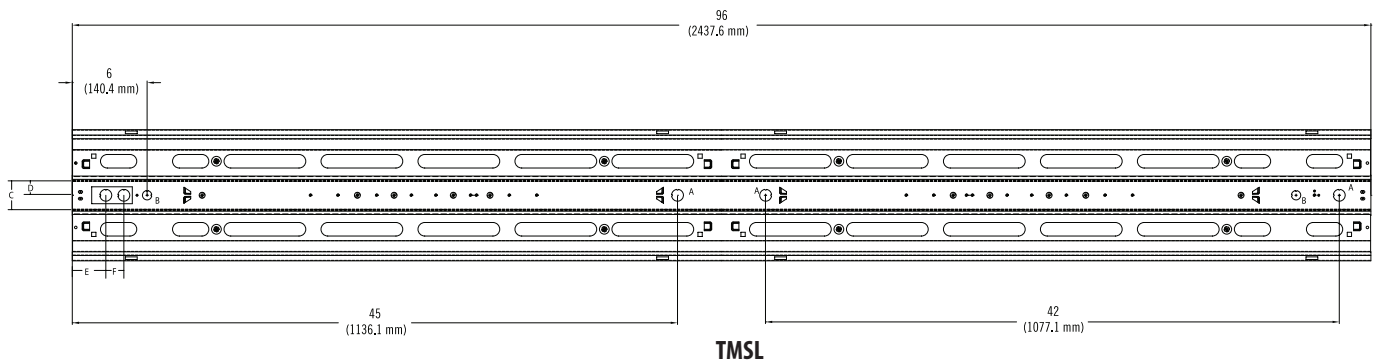
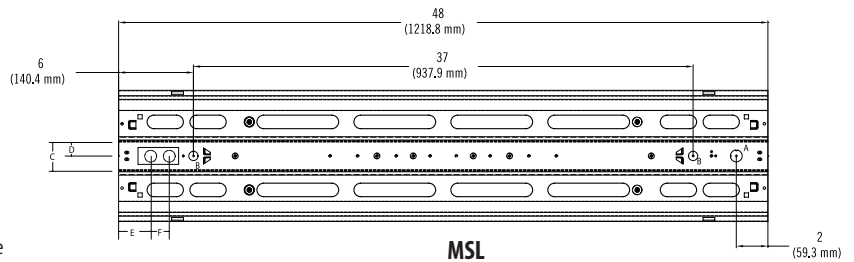
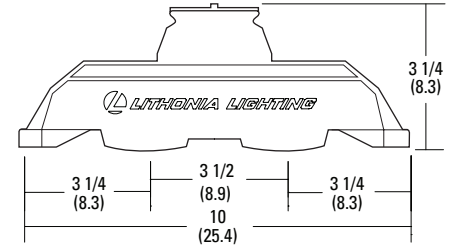

Photometrics

See www.lithonia.com