

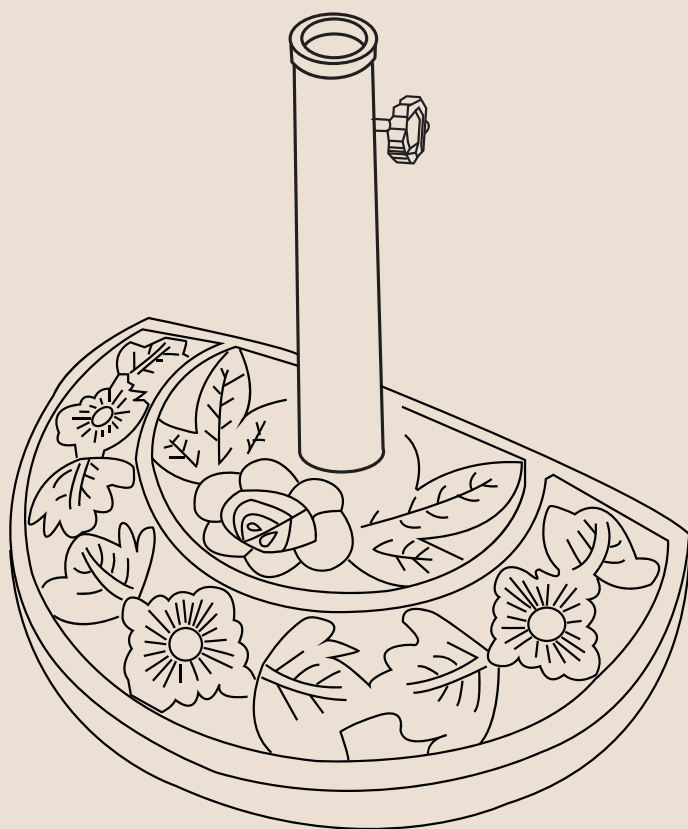

DESIGNED IN CALIFORNIA



— PERU STURDY FREESTANDING RESIN —  
UMBRELLA HALF BASE

# THANK YOU!

We appreciate you for choosing WestinTrends!

Thank you for letting WestinTrends continue to offer accessible luxury trends, inspired by everyone!

---

## JOIN THE WESTINTRENDS COMMUNITY

Sign up here:

***<https://westintrends.com/welcome>***



---

## QUESTIONS OR COMMENTS?

If you have questions reach out to  
[cs@westintrends.com](mailto:cs@westintrends.com)

---

FOLLOW, SHARE, & LEARN



---

## PRODUCT REGISTRATION

***<https://westintrends.com/apps/product-registration>***



ACCESSIBILITY - COMMUNITY - VALUE - SUSTAINABILITY

## ! CARE & MAINTENANCE

- Keep it stored when not in use.
- Do not allow umbrella to flap in the wind as it may cause damage.
- When adjusting the umbrella, make sure no person or item is close to the umbrella to avoid injury or damage.

## TOOLS REQUIRED



ALLEN WRENCH  
(PROVIDED)



1 PERSON  
ASSEMBLY



UP TO 20 MIN.  
ASSEMBLY

## HARDWARE

1

PLASTIC HEAD  
BOLT



1 PC

2

LOCKING BOLT



1 PC

3

SPACER



1 PC

4

WASHER



1 PC

## PARTS

A

PLASTIC BASE



1 PC

B

EXTEND POLE

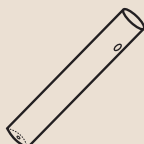

1 PC

C

CONNECT POLE



1 PC

D

SUPPORTING RING



1 PC

Part D is already inside the bottom of part B. No need to take out.

## PRODUCT ASSEMBLY

1

Put **Part B Extend Pole** into **Part A Plastic Base**. Attach **Hardware #2 Locking Bolt**, **Hardware #3 Spacer** and **Hardware #4 Washer** to **Part B Extend Pole** as below.

Please note that **Part C Connect Pole** is already assembled onto the head of **Part B Extend Pole**.

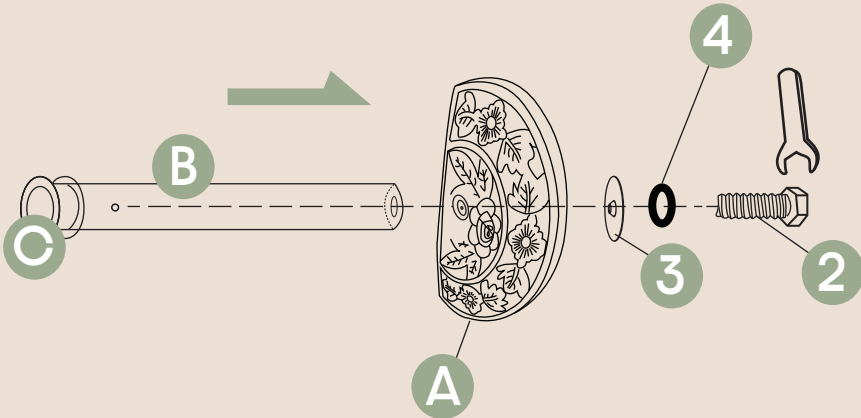

## PRODUCT ASSEMBLY

2

Check the diameter of your umbrella pole and choose part C1/C2 in suitable size.

- Take out part C1 and leave part C2 when the diameter is 48mm;
- Keep both C1 and C2 when the diameter is 38mm.

Insert your umbrella pole into **Part B Extend Pole**. Attach **Hardware #1 Plastic Head Bolt** onto **Part B Extend Pole**, then tighten it to keep your umbrella stable.

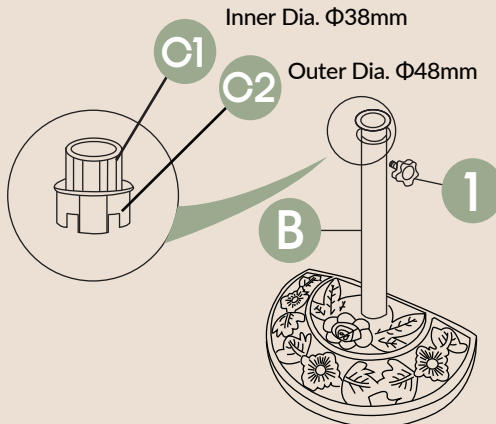

## REGISTRATION & REFUND POLICY

<https://westintrends.com/apps/product-registration>



<https://westintrends.com/policies/refund-policy>



### HAVING TROUBLE

- **Not sure how to assemble or missing pieces?**

Please contact our Customer Service Team for assistance at [cs@westintrends.com](mailto:cs@westintrends.com)

**Have Order #, Part # or SKU ready to speed up customer service!**

### CLEANING TIPS

**REGULAR CLEAN:** Use a mixture of warm water and mild soap. Gently scrub the surface with a soft bristle brush to remove any dirt or stains.

**QUICK CLEAN:** You can simply wipe down the HDPE furniture with a damp cloth. The material's resilience makes it resistant to most spills and stains, ensuring a hassle-free maintenance routine.

*Regular cleaning not only preserves the aesthetic appeal of your furniture but also helps extend its lifespan.*

Pressure washer can be used for seriously deep-cleaning - **DO NOT exceed 1500 PSI** - this will remove any debris and dirt.