

Electrical Metallic Tubing (EMT) 45° Elbows

Features:

- Hot galvanized steel using patented in-line Flo-Coat® process for long lasting exterior protection
- E-Z Pull® interior coating provides a smooth raceway for fast, easier wire-pulling
- Excellent mechanical protection for conductors
- Optimal EMI shielding characteristics
- Listed to Safety Standard UL 797
- Manufactured in accordance with ANSI C80.3
- Available in trade sizes 1/2" (16 mm) - 4" (103 mm)

Standards:



- UL 797 Listed
- Manufactured in accordance with ANSI C80.3
- EMT is recognized as an equipment grounding conductor by NEC section 250.118
- Calconduit EMT is listed in category FJMX
- Master bundles conform to NEMA Standard RN2

EMT 45° Elbows

Listed to Safety Standard UL 797

Manufactured in accordance with ANSI C80.3



Trade Size	Metric Designator	Radius (A) ¹		Offset (B) ²		Offset (C) ²		Straight (D) ¹		Approximate Weight Per 100 Pieces		Standard Package
		(in)	(mm)	(in)	(mm)	(in)	(mm)	(in)	(mm)	(lb)	(kg)	
1/2	16	4	102	6 1/8	156	2 1/2	64	1 1/2	38	18	8.2	25
3/4	21	4 1/2	114	7 3/8	187	3 1/8	79	1 1/2	38	33	15.0	50
1	27	5 3/4	146	8 3/4	222	3 5/8	92	1 7/8	48	56	25.4	25
1 1/4	35	7 1/4	184	10 1/8	257	4 1/8	105	2	51	97	44.0	20
1 1/2	41	8 1/4	210	13 1/8	333	5 3/8	137	2	51	145	65.8	15
2	53	9 1/2	241	13 1/8	333	5 1/2	140	2	51	185	83.9	10
2 1/2	63	10 1/2	267	17 1/2	445	7 1/4	184	3	76	360	163.3	1
3	78	13	330	17 1/2	445	7 1/4	184	3 1/8	79	438	198.7	1
3 1/2	91	15	381	26 1/8	664	10 7/8	276	3 1/4	83	873	396.0	1
4	103	16	406	26 1/4	667	10 7/8	276	3 3/8	86	983	445.9	1

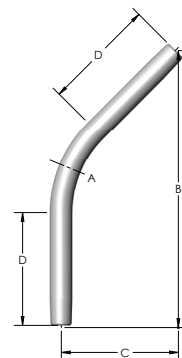

¹Minimum requirement as per UL Standard

²Dimensions and weights are approximate

Sizes 2 1/2" (63 mm) and larger shipped in palletized cartons or bulk

Also available in the following Degrees (90°, 60°, 30°, 22 1/2°, 15° & 11 1/4°)

