



nPODMA Installation Instructions

nLight wall switches are powered using Class 2 CAT-5e cables composed using the T568B wiring pattern.

OUT-OF-THE-BOX DECORA WALL PLATE

- Ensure CAT-5e cable(s) are effectively fed through the gang box.
 - Push the CAT-5e cables through the back of the gang box.
- Remove the wall plate from the device by pulling the sides out to expand the wall plate and release it from the mounting flanges.
- Access RJ-45 port(s) on the WallPod by sliding the plastic guard up.
- Insert the CAT-5e cable(s) to the RJ-45 port(s).
- Slide the guard back onto metal strap.
- Connect the unit to the gang box.
 - The unit will connect to the gang box by screws, one at the top and one at the bottom.
 - To ensure correct wall plate installation, drive the screws until the mounting flanges contact the wall surface. If the screws are overdriven, the mounting flanges will disengage, preventing wall plate installation. If this happens, reattach the mounting flange(s) and install to correct position. (The flanges may be reattached by inserting the two tabs in the side of the unit and pushing the part inward to engage the three snaps.)
- Reattach the wall plate.
 - Expand the wall plate horizontally.
 - Place the wall plate onto the unit.
 - Contract the horizontally expanded wall plate onto the unit such that the side flange features seat inside the wall plate.

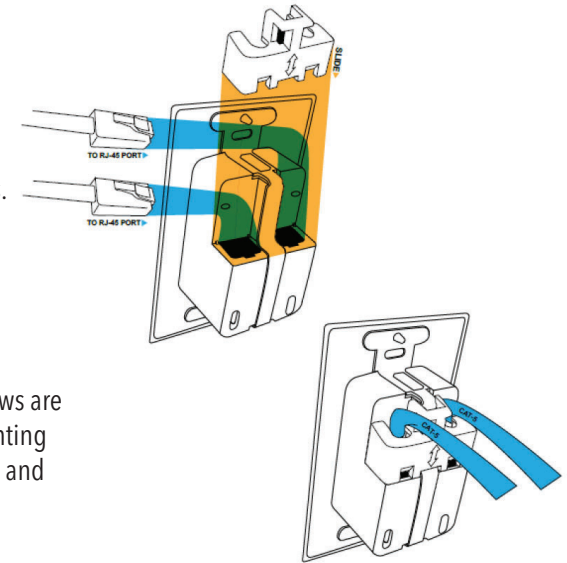

OFF-THE-SHELF DECORA WALL PLATE

When installing the unit with standard off-the-shelf decora wall plates, the following steps should be followed.

- Remove the Acuity wall plate from the device by pulling the sides out to expand the wall plate and releasing it from the mounting flanges.
- Unhook and remove the side flanges from the device
- Access RJ-45 port(s) on the device by sliding the plastic guard up
- Insert the CAT-5e cable(s) to the RJ-45 port(s)
- Slide the guard back onto metal strap
- Connect the unit to the gang box
- The unit will connect to the gang box by screws, one at the top and one at the bottom
- Attach the wall plate

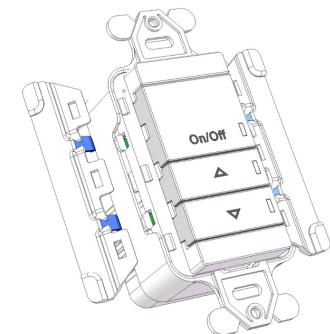
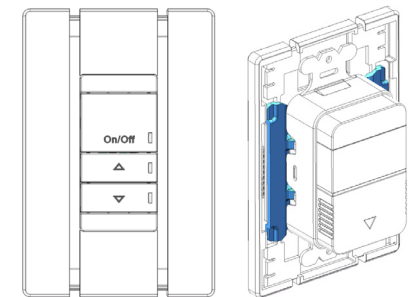

PROGRAMMING

Refer to included instruction card for default settings and directions on programming the sensor via the push-button.

nPODMA Installation Instructions

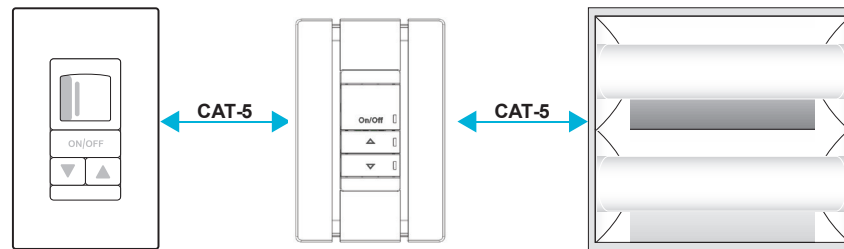
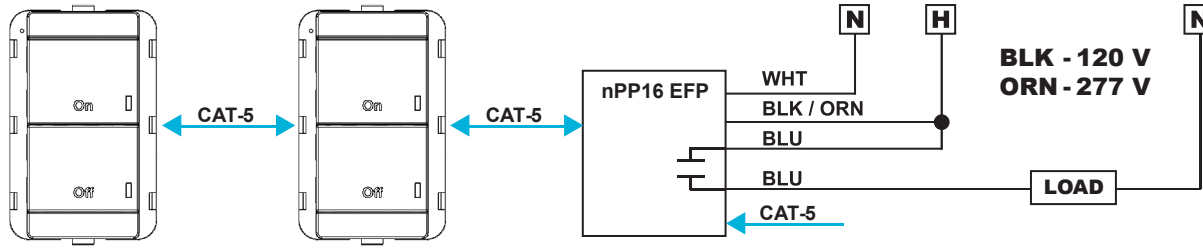
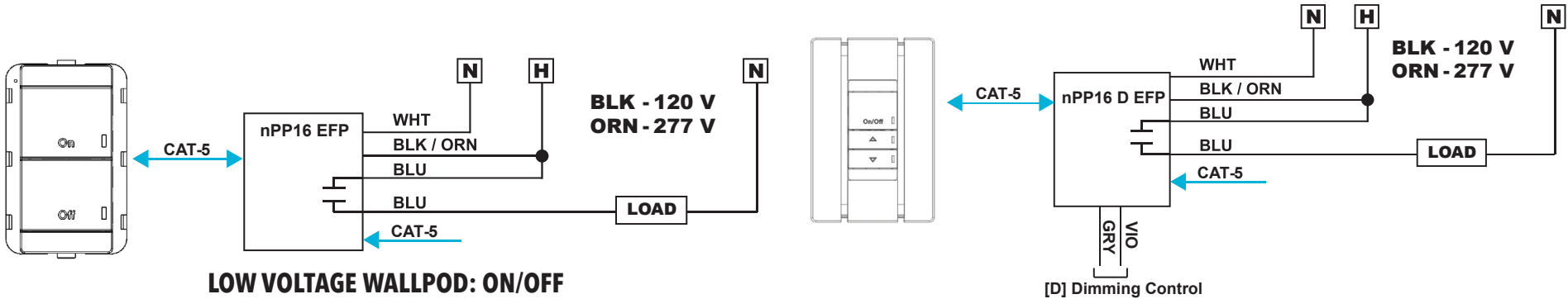

LOW VOLTAGE 3-WAY SWITCHING + DIMMING
Combination Low Voltage WallPods and/or Wall Switch Sensors