

INSTRUCTIONS FOR ACR ResQLink (View, View RLS, 400 & 410 RLS)

How to Fit an ACR ResQLink (View, View RLS, 400 & 410 RLS) to the Atlas 190 UML Life Jacket

These instructions will guide you through fitting your device into an Atlas lifejacket. Follow each step carefully to ensure it functions safely and correctly. Handle the lifejacket and all device components with care to avoid damage during installation.

Before You Begin

Make sure you're familiar with how your Personal Locator Beacon (PLB) works. If unsure, please refer to your Original Equipment Manufacturer's (OEM) manual.

You will need a flat surface to work on.

Step 1: Open the Lifejacket

Open your Atlas lifejacket via the burst point and peel the cover apart to expose the inflatable bladder. Spread the bladder out flat, being careful not to catch or snag the manual inflation cord.

For more details on unpacking, refer to your owner's manual.

(See Fig. 1)

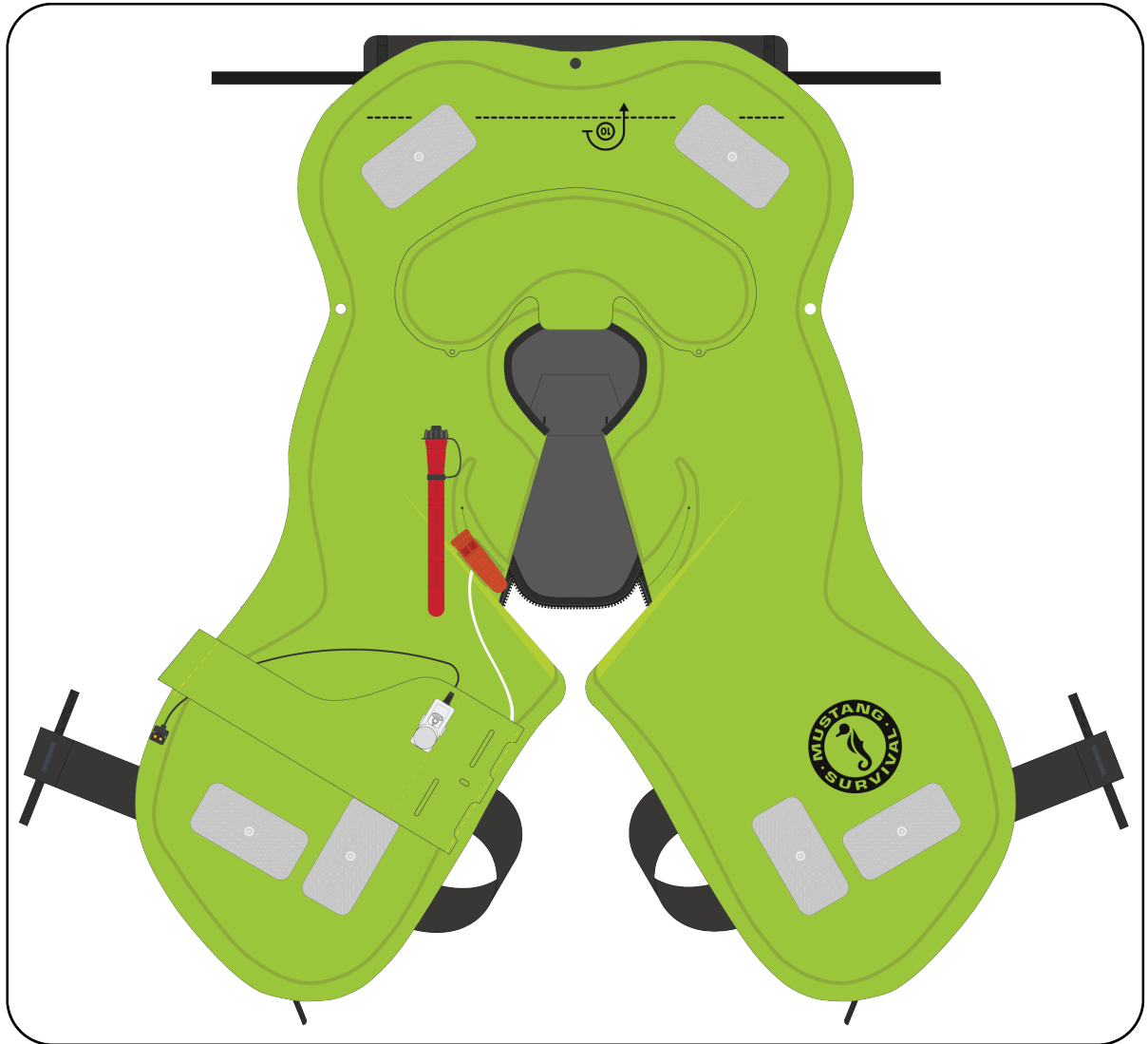

Fig 1.

Step 2: Install the Cradle Mounting System

Locate the two upper parallel slits on the right bladder lobe. Slide the cradle mounting system (included with your device) underneath the fabric, aligning its fixing points with the slits (*Fig. 2a*).

Place the device on top of the cradle and secure it firmly, following the OEM instructions (*Fig. 2b*).

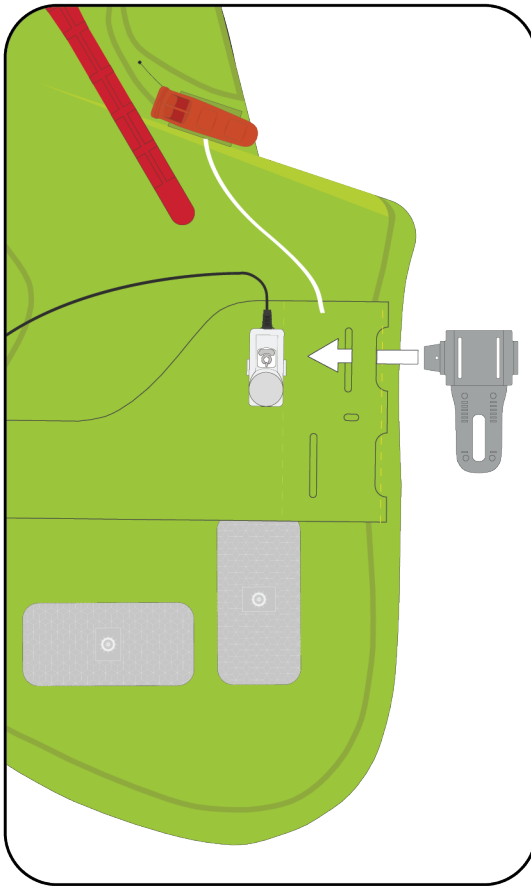

Fig 2a.



Fig 2b.

Step 3: Attach the Security Lanyard

Use a bowline knot to attach the security lanyard through the back tether slot of the device.

(*See Fig. 3a and Fig. 3b*)

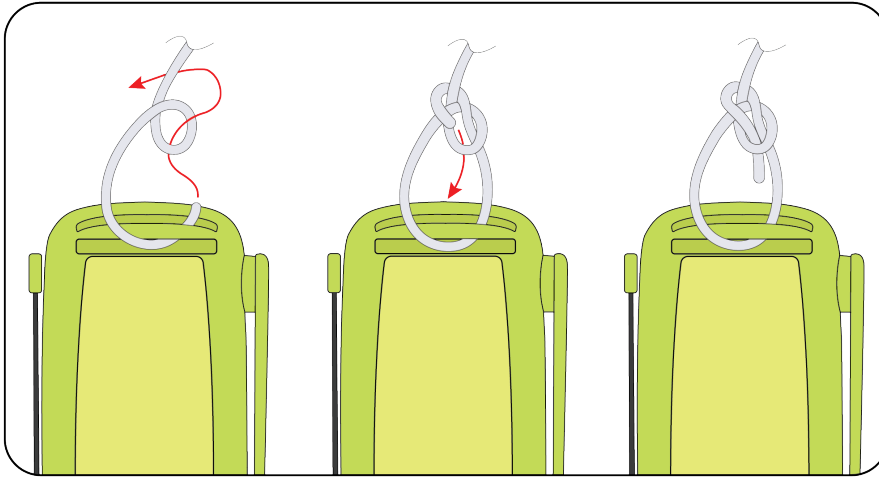

Fig 3a.

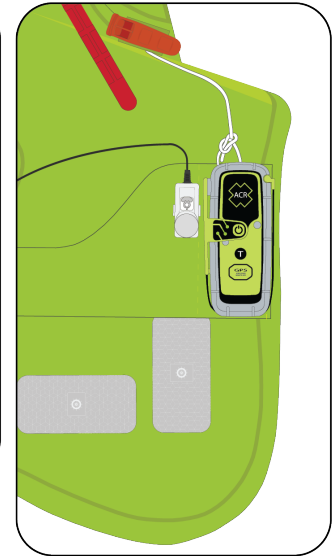

Fig 3b.

Step 4: Repack the Lifejacket

Repack the lifejacket as outlined in the Atlas manual—except make sure the device is folded on top, facing outward, and positioned as the uppermost layer above the bladder.

(See Fig. 4)

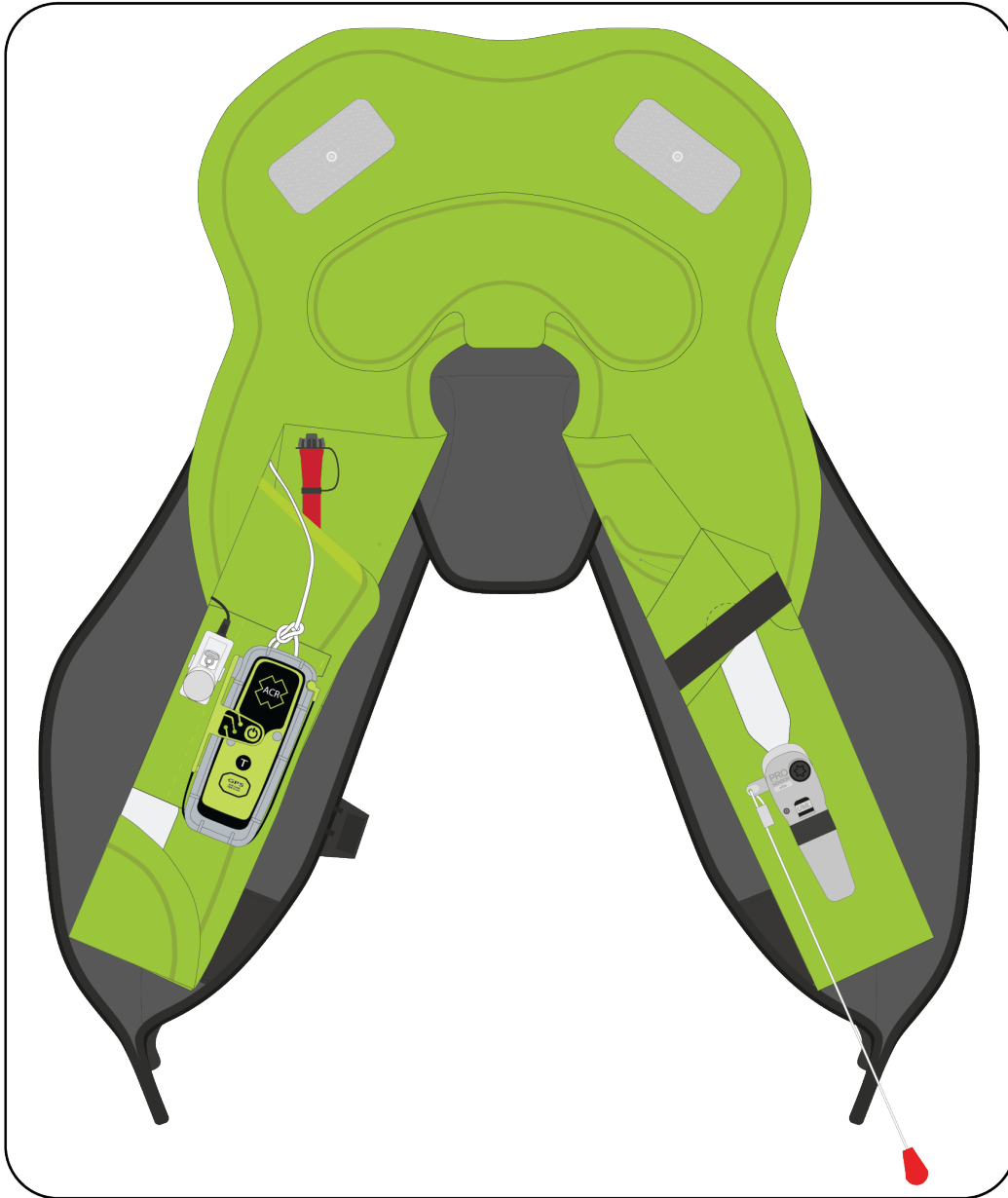

Fig 4.

Step 5: Mark the Label

As a final step, locate the label tucked into the centre back panel of the lifejacket and mark it to indicate "PLB fitted."

(See Fig. 5)

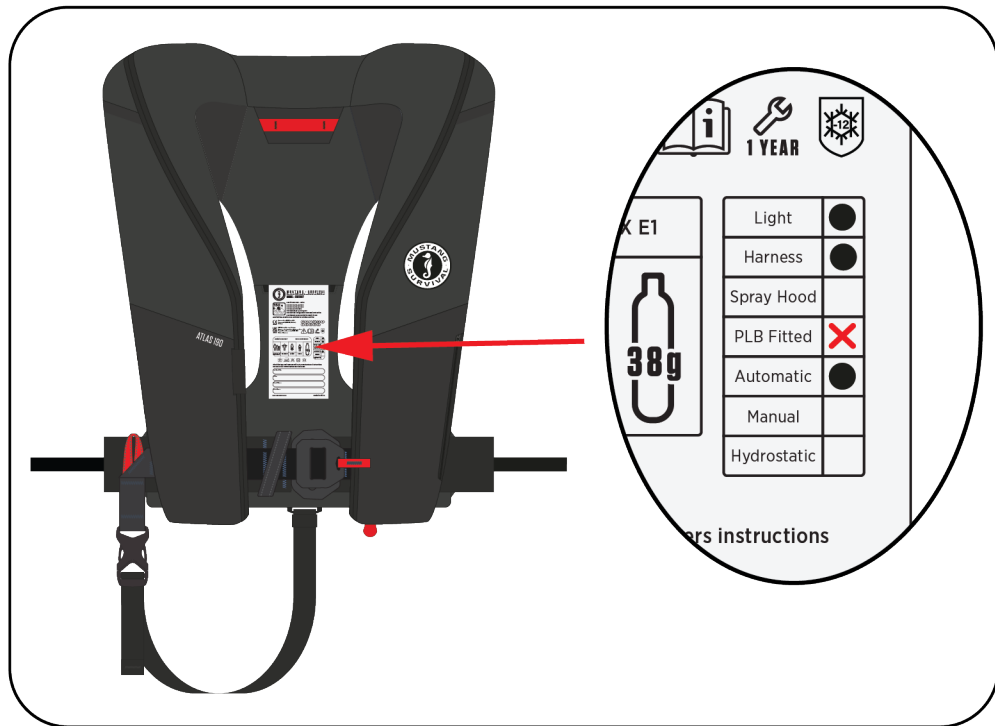

Fig 5.