

ORDER BY PART NUMBER

ILLUSTRATED PARTS

553

20" Reach Wall Mount Shower Arm

ID	Kit Number	Finish
A*	2415	See below
B	225-200	N/A

***Finish Determined by Suffix**

Finish	Description
C	Chrome
BK	Black
BG	Brushed Gold
BN	Brushed Nickel
PN	Polished Nickel

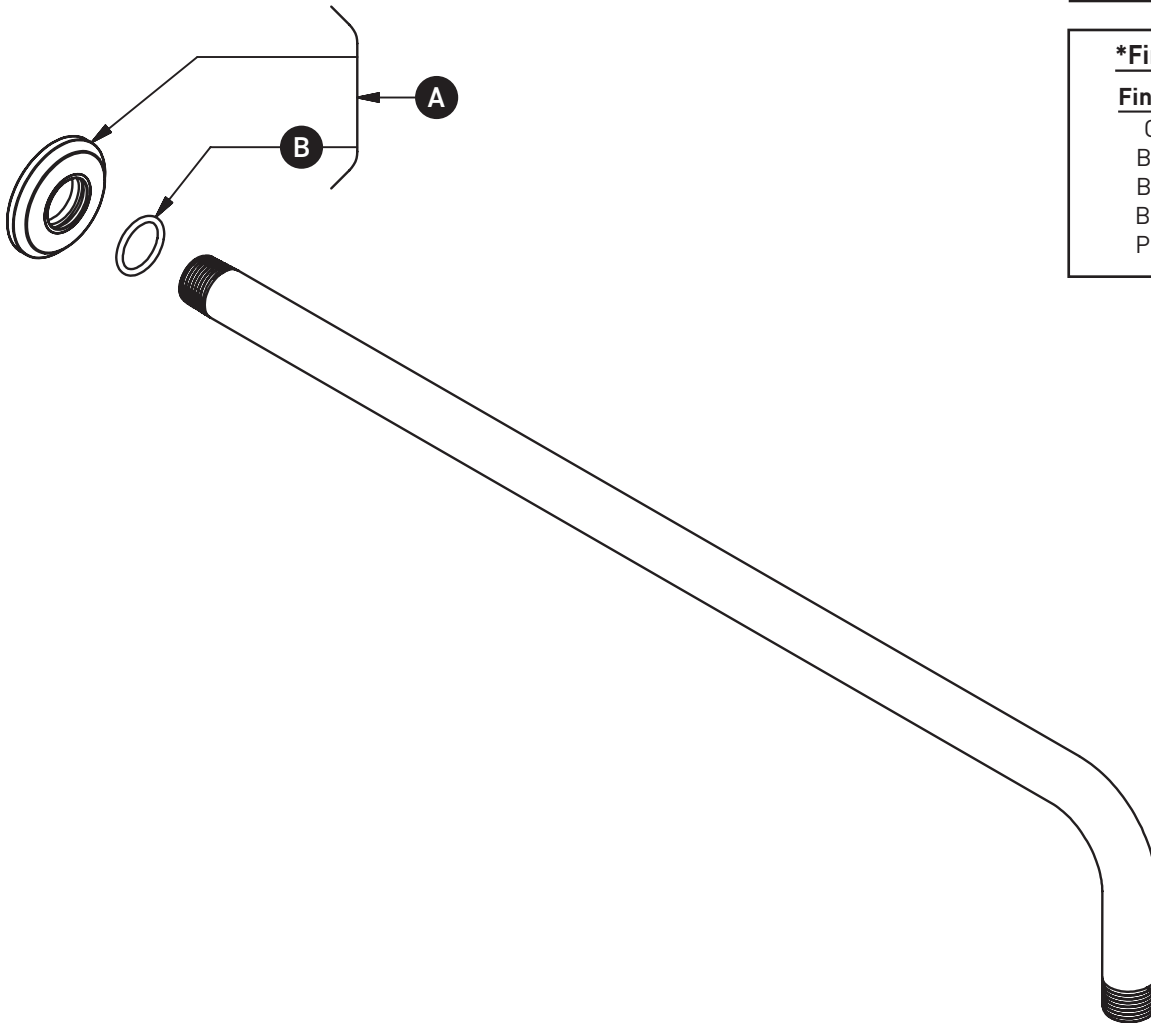

For warranty or additional information, contact:

U.S.A.
houseofrohl.com/support
1-800-777-9762

QUEBEC / MARITIMES / WESTERN CANADA
QUÉBEC / MARITIMES / OUEST CANADIEN
QUEBEC / MARITIMOS / CANADA OCCIDENTAL
houseofrohl.ca/support
1-866-473-8442

ONTARIO
houseofrohl.ca/support
1-800-287-5354

VEUILLEZ EFFECTUER VOTRE COMMANDE
PAR NO DE RÉFÉRENCE

ILLUSTRATIONS DES PIÈCES

553

Bras de douche 50 cm (20")

ID	Référence du kit	Finition
A*	2415	Voir ci-dessous
B	225-200	N/A

***Finition déterminée par le Suffixe**

Finition	Description
C	Chrome
BK	Noir
BG	Or brossé
BN	Nickel brossé
PN	Nickel poli

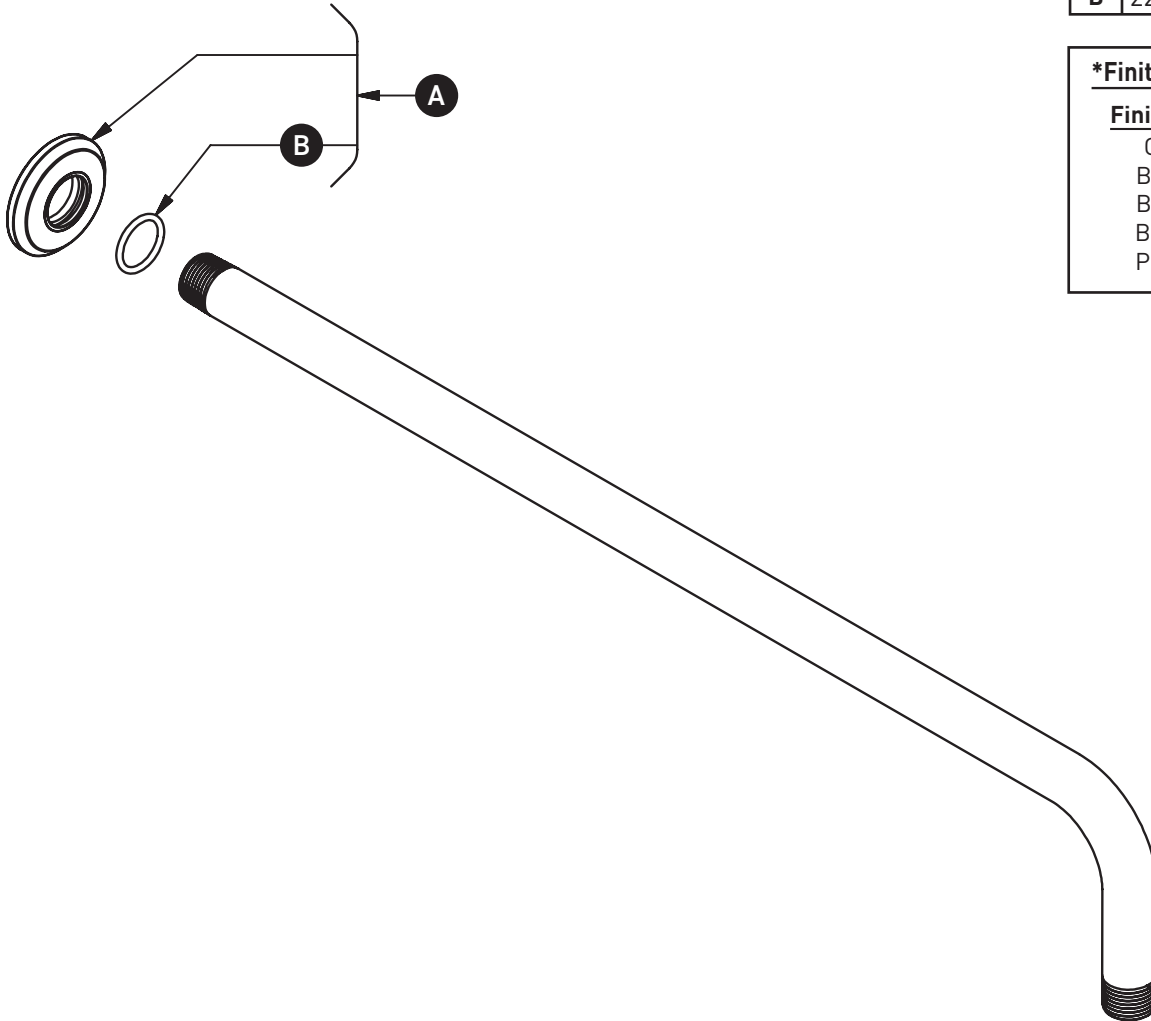

For warranty or additional information, contact:

U.S.A.
houseofrohl.com/support
1-800-777-9762

QUEBEC / MARITIMES / WESTERN CANADA
QUÉBEC / MARITIMES / OUEST CANADIEN
QUEBEC / MARITIMOS / CANADA OCCIDENTAL
houseofrohl.ca/support
1-866-473-8442

ONTARIO
houseofrohl.ca/support
1-800-287-5354

PEDIR POR NÚMERO DE REFERENCIA

PIEZAS ILUSTRADAS

553

Brazo de ducha de montaje en pared de 20" de alcance

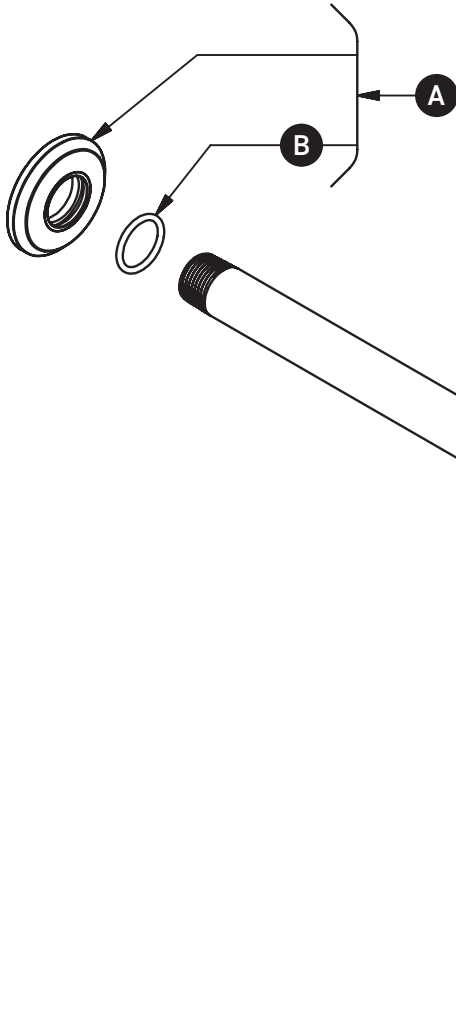

ID	Referencia del kit	Acabado
A*	2415	Ver más abajo
B	225-200	N/A

***Acabado determinado por el sufijo**

Acabado	Descripción
C	Cromo
BK	Negro
BG	Oro cepillado
BN	Níquel pulido
PN	Níquel pulido

For warranty or additional information, contact:

U.S.A.
houseofrohl.com/support
1-800-777-9762

QUEBEC / MARITIMES / WESTERN CANADA
QUÉBEC / MARITIMES / OUEST CANADIEN
QUEBEC / MARITIMOS / CANADA OCCIDENTAL
houseofrohl.ca/support
1-866-473-8442

ONTARIO
houseofrohl.ca/support
1-800-287-5354