

FLEXSTEEL®

W1027-831

RECTANGULAR DINING TABLE

IMPORTANT

Carefully remove all parts from the carton, and put them individually on a soft cloth to prevent damage to the parts.

We have taken great care in the design of this product and request that you carefully and accurately follow our assembly instructions to ensure proper set-up.

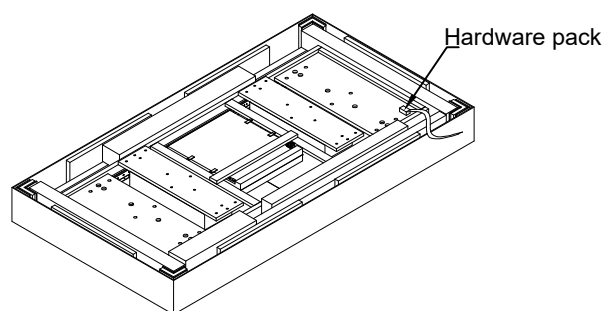
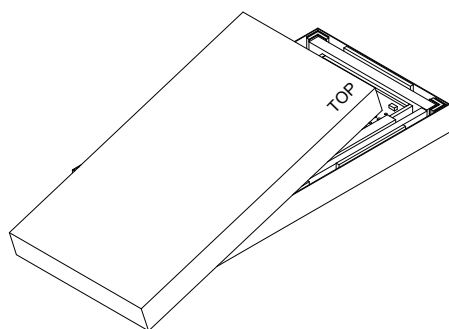
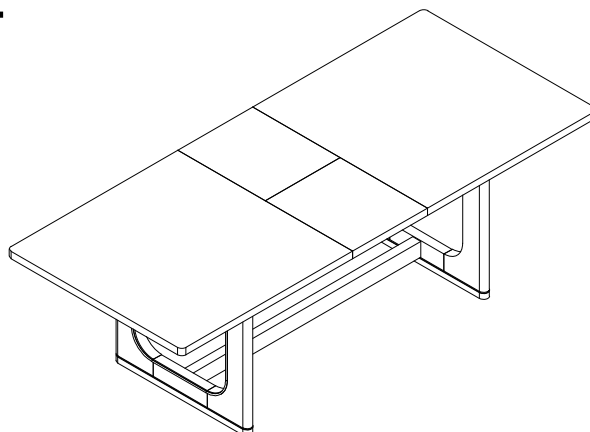

Part List

Assembly Instructions 1/5

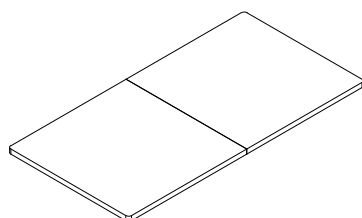

A. Table Top
1 piece

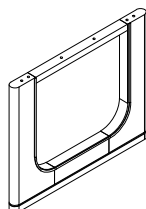

B. Leg
2 pieces

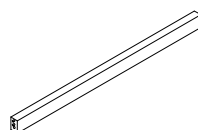

C. Stretcher
1 piece

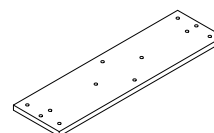

D. Connecting Panel
2 pieces

Hardware List

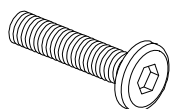

Bolt
Ø5/16"-18 UNC x 1-1/2"
26 pieces



Spring Washer
Ø5/16" x 1.5mm
26 pieces



Flat Washer
Ø5/16" x Ø19mm x 1.5mm
26 pieces

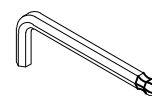

Hex Key
5/32"
1 piece

IMPORTANT NOTES

- Do not tighten up all the bolts until each part is properly assembled.
- Keep the Hex Key in a safe place as you may need to tighten up the bolts in the future.
- Use a soft cloth between these parts and the floor.
- We recommend this product be assembled by at least two adults.

STEP 1

Connect Legs (B) and Connecting Panels (D).
(See Figure 1)

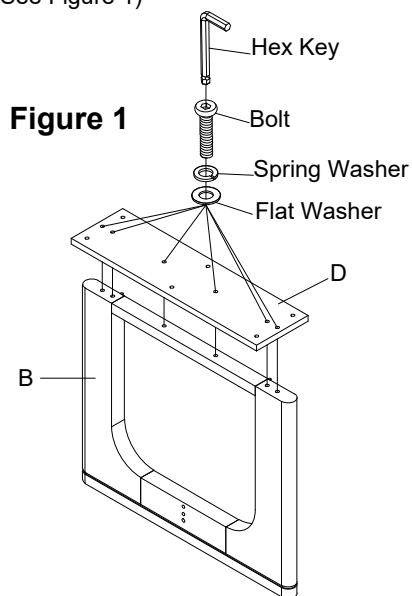

STEP 2

Connect the Leg (B) and Stretcher (C) by inserting Bolt, Spring Washer, Flat Washer and fully tighten with Hex Key.
(See Figure 2)

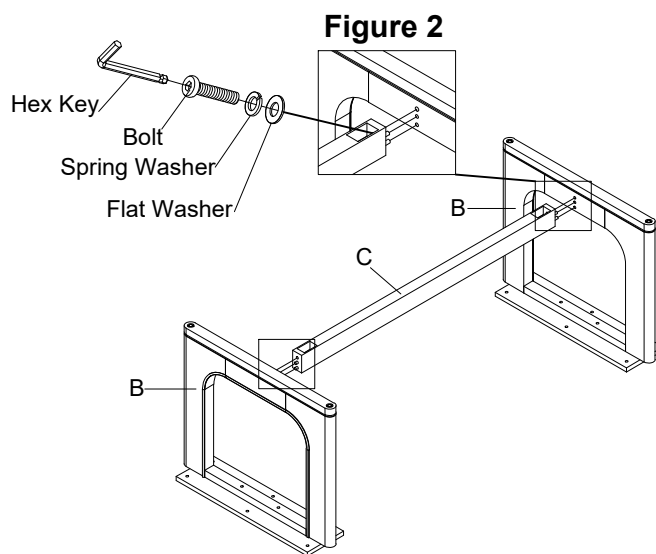

STEP 3

Connect the Connecting Panels (D) and Table top (A) by inserting Bolt, Spring Washer, Flat Washer and fully tighten with Hex Key. (See Figure 3)

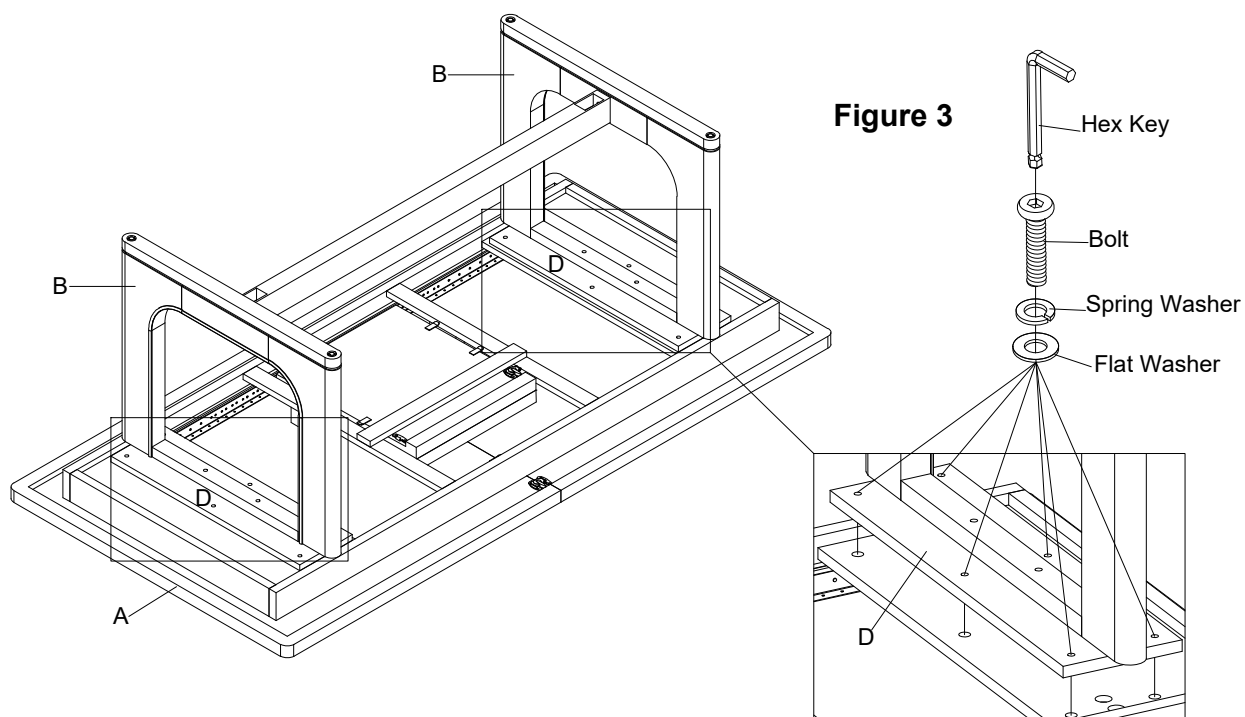

FLEXSTEEL®

Assembly Instructions 3/5

STEP 4

Ask for assistance to lift the unit upright and position it at the desired location.
Adjust the levelers on the legs until the furniture is leveled. (See Figure 4).

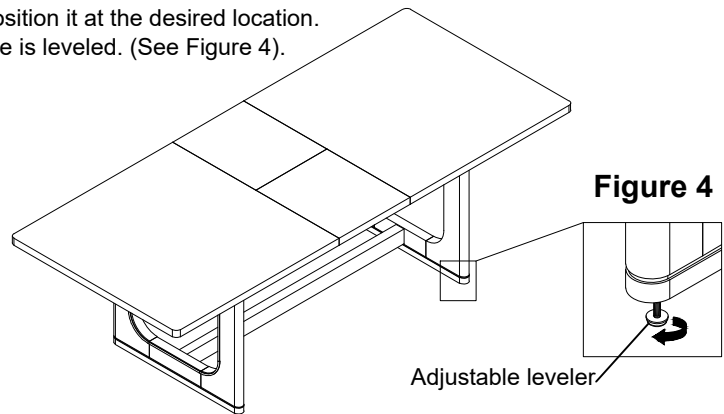

To Retrieve Leaf

1. Unlock the sash locks underneath the Table Top (A) and release the slide locks on both slide mechanisms to allow the slide to operate, then pull the Table Top wide open equally from both ends
2. Lift the Butterfly Leaf from the compartment of the Table Top (A) and flip up the Leaf. then pull the rest the leaf onto the top surface carefully.
3. Push the Table Top (A) from both ends to close and lock the sash locks underneath the Table Top. (See Figure 5).

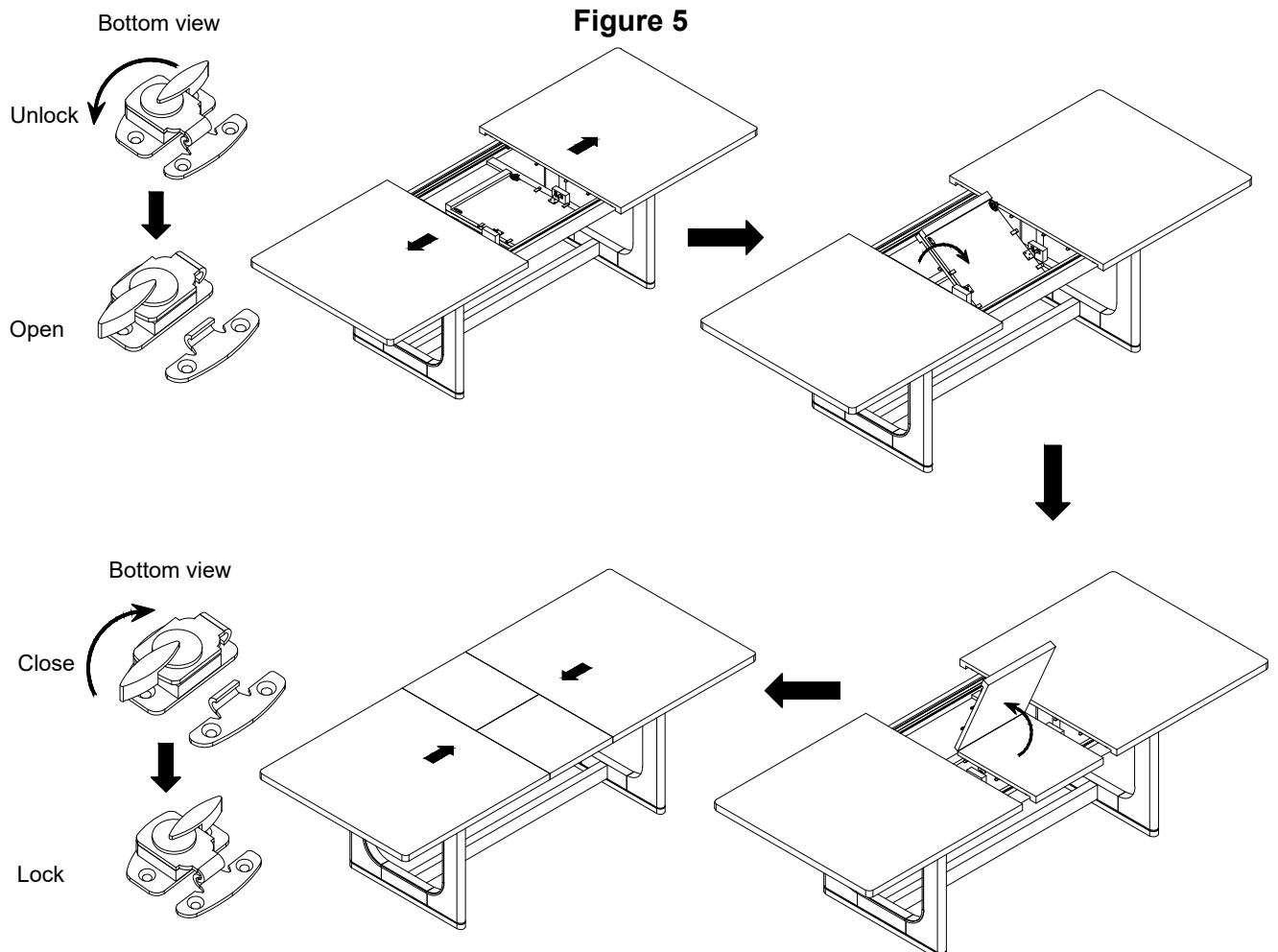

To Store Leaf

1. Unlock the sash locks underneath the Table Top (A) and release the slide locks on both slide mechanisms to allow the slide to operate, then pull the Table Top wide open equally from both ends
2. Fold the butterfly leaf to store within the compartment, as shown.
3. Push the Table Top (A) from both ends to close and lock the sash locks underneath the Table Top. (See Figure 6).

Figure 6

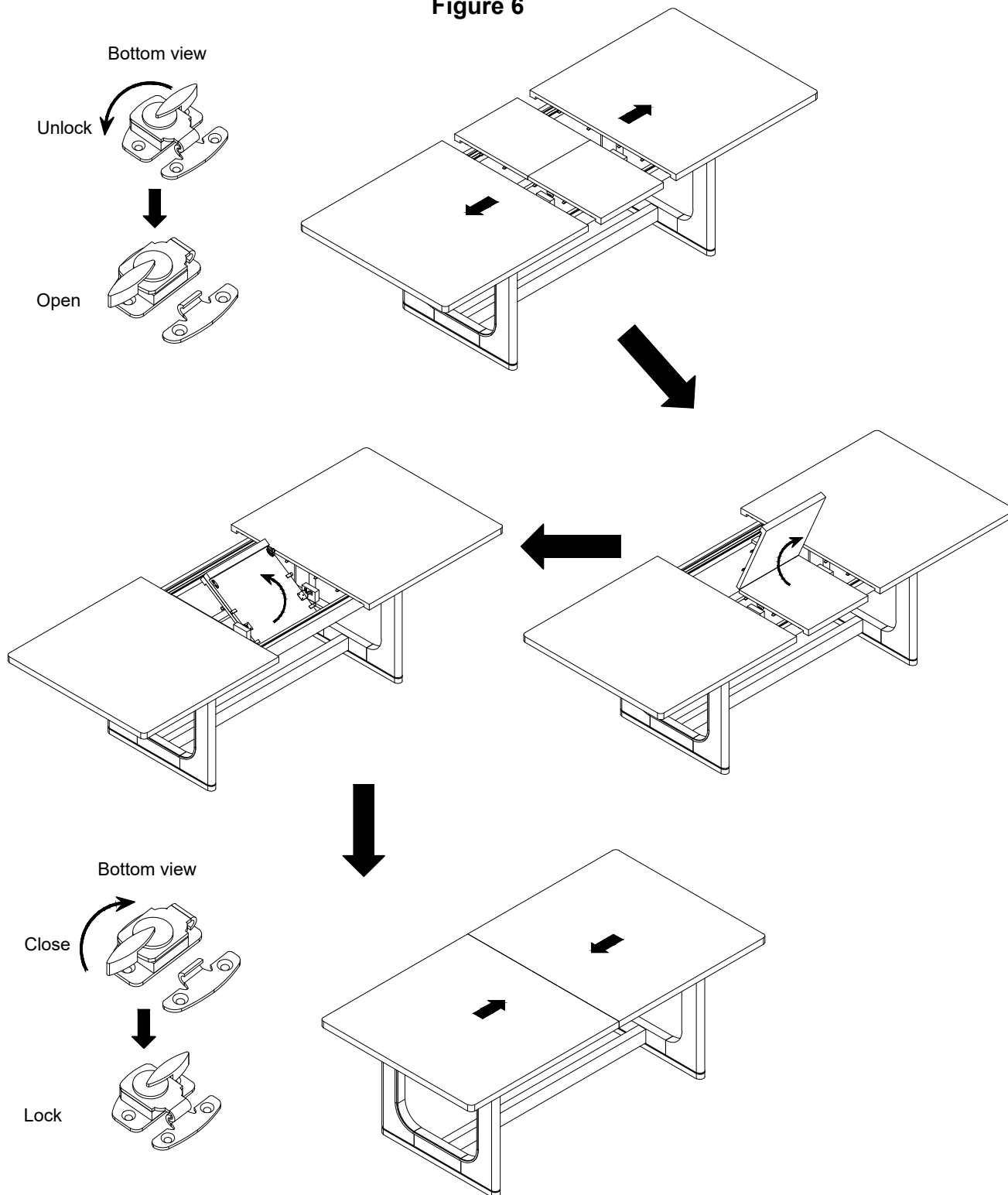

FLEXSTEEL®

Assembly Instructions 5/5

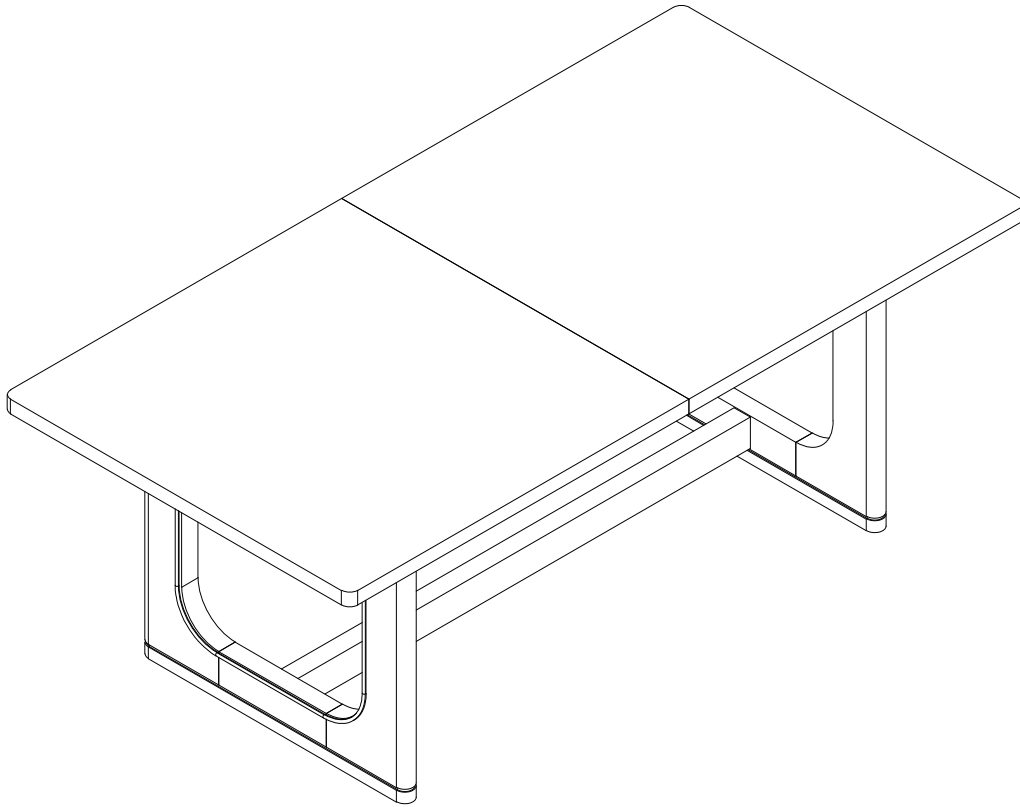

CARE INSTRUCTIONS

- To avoid scratches, do not place sharp or jagged objects directly on the table top.
- Do not place hot items directly on the table top.
- Use placemats or trivets under hot items and coasters under beverages to prevent marks and stains.
- Avoid the use of harsh chemicals or abrasive cleaning materials.
- Wipe the table clean with a soft, dry cloth after each use.
- Wipe up spills quickly with a soft, dry cloth.

Flexsteel Industries, Inc.

For Parts or Customer Service call

toll-free:

1-888-415-3979

Monday-Friday

8:00 a.m. -5:00 p.m.

(Central Time)

Email:

customersolutions@flexsteel.com

www.flexsteel.com