

## Brookings Unassembled 4-Door, 3-Drawer Vanity 60x31.5x21 Modern Birch

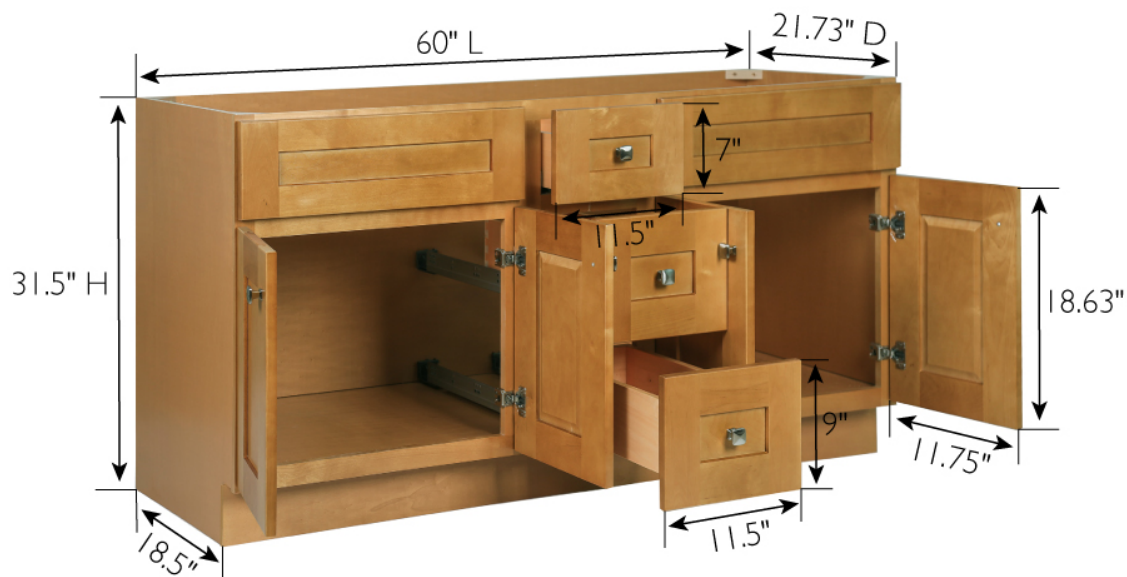

### SPECIFICATIONS

<b>MATERIAL CONSTRUCTION:</b>	Wood
<b>ASSEMBLY REQUIRED:</b>	Yes
<b>TOOLS NEEDED FOR ASSEMBLY:</b>	Phillips Screwdriver, Rubber Mallet, Wood Glue
<b>ASSEMBLED DIMENSIONS:</b>	31.5" H x 60" L x 21" D
<b>ASSEMBLED WEIGHT:</b>	95.48 lbs.
<b>HINGE STYLE:</b>	Soft Close
<b>DOOR STYLE:</b>	4 Shaker Doors
<b>DRAWER STYLE:</b>	3 Drawers
<b>GLIDE STYLE:</b>	Soft Close
<b>FAKE DWR STYLE:</b>	N/A
<b>DWR 1 DIMENSIONS:</b>	7" H x 11.5" L x 20.98" D
<b>DWR 2-3 DIMENSIONS:</b>	9" H x 11.5" L x 20.98" D
<b>DWR CONSTRUCTION:</b>	Dove Tail
<b>SHELF STYLE:</b>	N/A
<b>SHELF ADJUSTABILITY INCREMENTS:</b>	N/A
<b>SHELF MAX WEIGHT CAPACITY:</b>	N/A
<b>SHELF DIMENSIONS:</b>	N/A
<b>SHELF THICKNESS:</b>	N/A
<b>SHELF MATERIAL:</b>	N/A

<b>FRAME STYLE:</b>	Face Frame
<b>FACE FRAME MATERIAL:</b>	Solid Wood
<b>SIDES MATERIAL:</b>	Plywood
<b>BOTTOM MATERIAL:</b>	Plywood
<b>TOE KICK INSET WIDTH:</b>	4.5"
<b>BACK PANEL MATERIAL:</b>	Plywood
<b>BACK BRACE MATERIAL:</b>	Solid Wood



<b>WARRANTY:</b>	1-Year limited warranty
<b>TITLE VI COMPLIANT:</b>	Yes
<b>PROP 65 HARMFUL MATERIAL:</b>	Formaldehyde



TYPE:  
JOB:  
ORDER CODE:  
APPROVALS: