

# WOODPLAY<sup>®</sup>

## Playsets

### 5' & 6' SUPER SPIRAL SLIDE

### Assembly Instructions

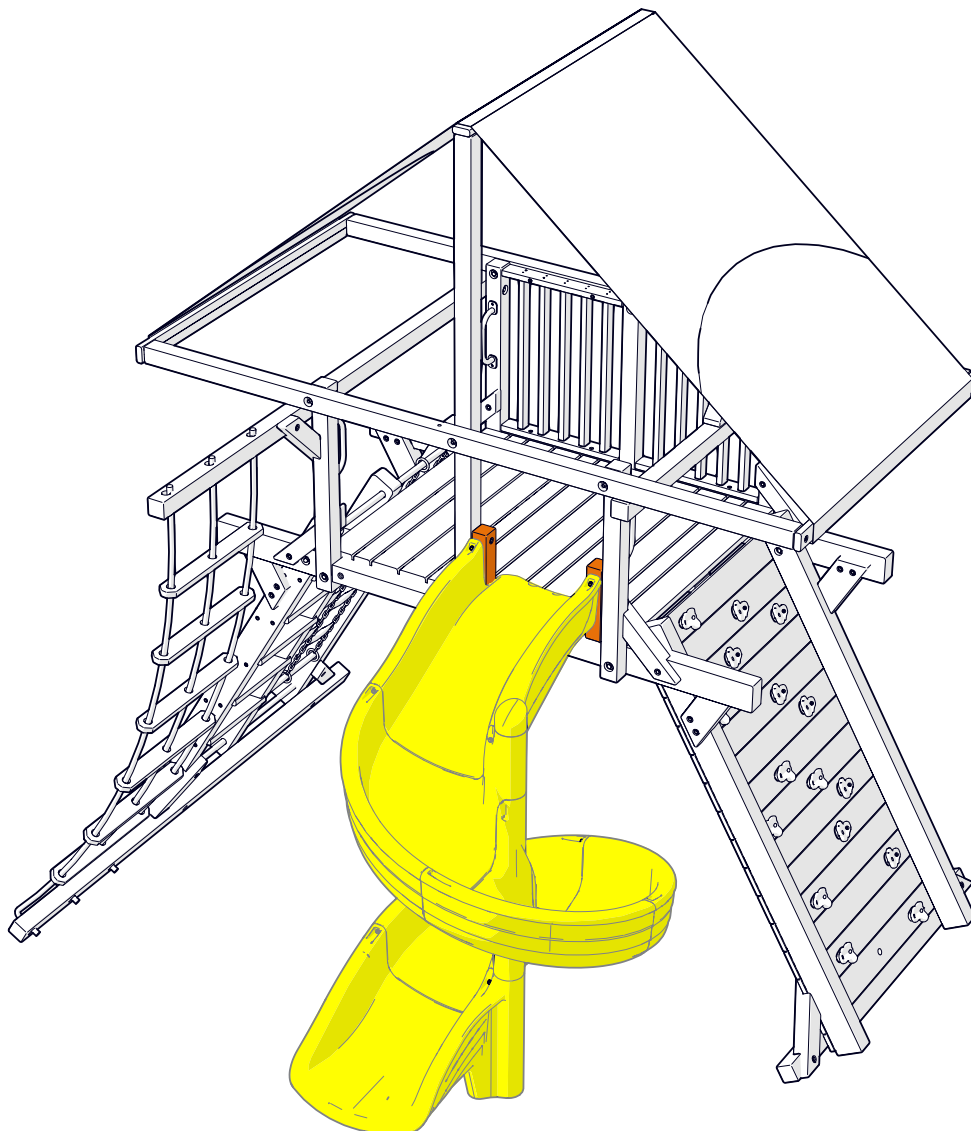

PA-MAN-SSS-01



If you have a **5 foot** slide continue on this page (**pages 2-5**).

If you have a **6 foot** slide skip to **pages 6-9**.

**IMPORTANT!**

READ THIS PAGE  
BEFORE STARTING THE  
ASSEMBLY PROCESS.

## INSTRUCTIONS FOR 5 FOOT SLIDE

### Entry Section



**Qty. 1**

### Exit Section



**Qty. 1**

### Curved Sections



**Qty. 3**

PART #	DESCRIPTION	QTY.
PG-HW-W004	3/8" FLAT WASHER	4
PG-HW-L011	3/8 X 3" HEX LAG SCREW	4

TOOLS NEEDED (required)
9/16" Socket
Socket Wench

TOOLS (optional)
Cordless impact driver
Socket extension and adapter

### SLIDE ASSEMBLY



1. Start by placing the exit section of the slide on the ground.



2. Slide the next curved section into place and fasten it to the exit section using 3/8" x 3" stainless steel lags. Start with bottom outside hole. (DO NOT OVERTIGHTEN!).

PART #	DESCRIPTION	QTY.
PG-HW-W004	3/8" FLAT WASHER	12
PG-HW-L011	3/8 X 3" HEX LAG SCREW	12



3. Attach the next curved section using 3/8"x3" stainless steel lags. Start with the bottom outside hole. (DO NOT OVERTIGHTEN! ) Repeat this step until all curved sections are in place.

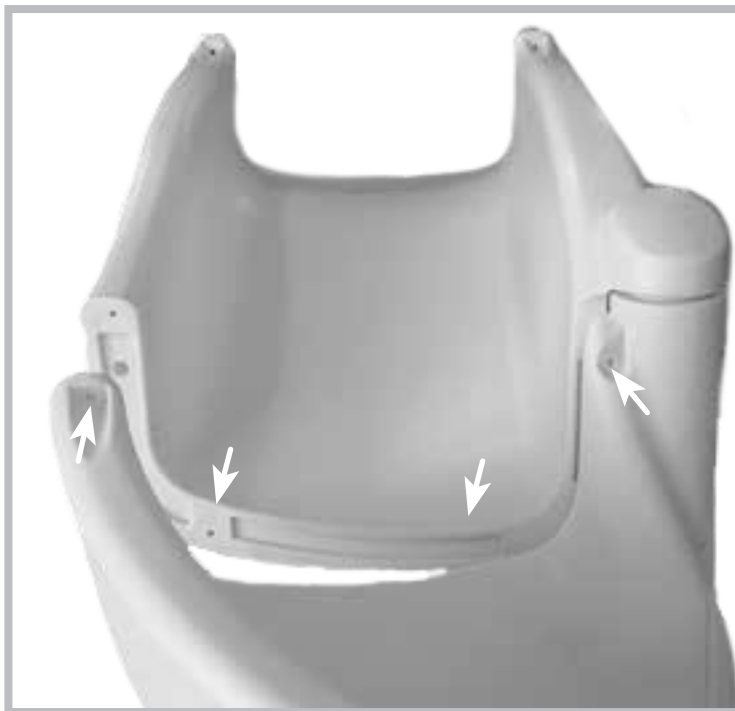

4. Attach entry section to last curved section using 3/8" x 3" stainless steel lags (DO NOT OVERTIGHTEN!).

## Assembly Overview for 5 foot slide

5. Once slide is assembled skip to **page 10** to attach it to the playset.



# INSTRUCTIONS FOR 6 FOOT SLIDE

## Entry Section

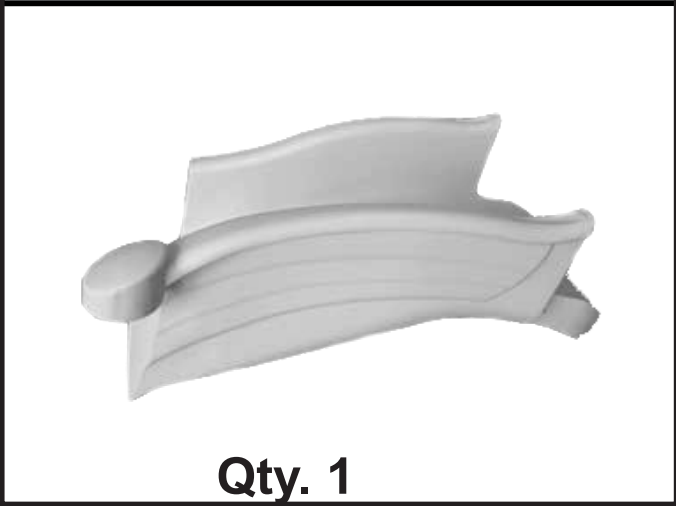

## Exit Section



## Curved Sections



## Steel Posts

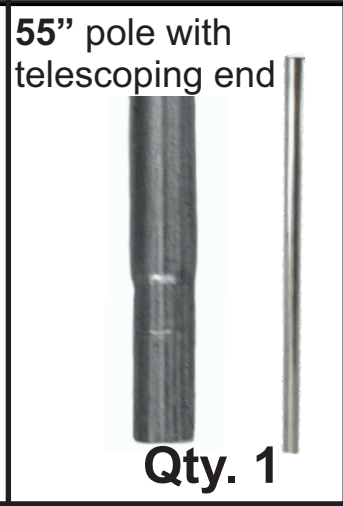

PART #	DESCRIPTION	QTY.
PG-HW-W004	3/8" FLAT WASHER	4
PG-HW-L011	3/8 X 3" HEX LAG SCREW	4

TOOLS NEEDED (required)
9/16" Socket
Socket Wench

TOOLS (optional)
Cordless impact driver
Socket extension and adapter



1. Start by placing the exit section of the slide on the ground and insert the 55" steel post into it. Make sure the inside of the post slides firmly over the molded column

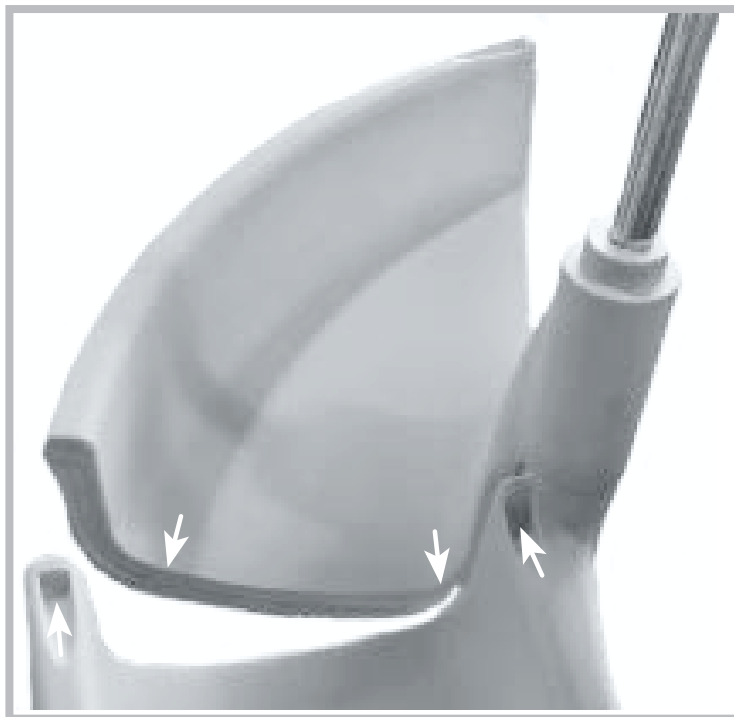

2. Slide the next curved section into place and fasten it to the exit section using 3/8" x 3" stainless steel lags. Start with bottom outside hole. (DO NOT OVERTIGHTEN!).

PART #	DESCRIPTION	QTY.
PG-HW-W004	3/8" FLAT WASHER	16
PG-HW-L011	3/8 X 3" HEX LAG SCREW	16

**23" Steel post**



- 3.** Insert 23" steel post over top of the telescoping end of the 50" post. No fasteners are needed. Attach the next curved section using 3/8"x3" stainless steel lags. Start with the bottom outside hole but **DO NOT OVERTIGHTEN!** Repeat this step 2 until all curved sections are in place.



- 4.** Attach entry section to last curved section using 3/8" x 3" stainless steel lags (**DO NOT OVERTIGHTEN!**).



## Assembly Overview for 6 foot slide

5. Once slide is assembled continue to the next page to attach it to the playset.

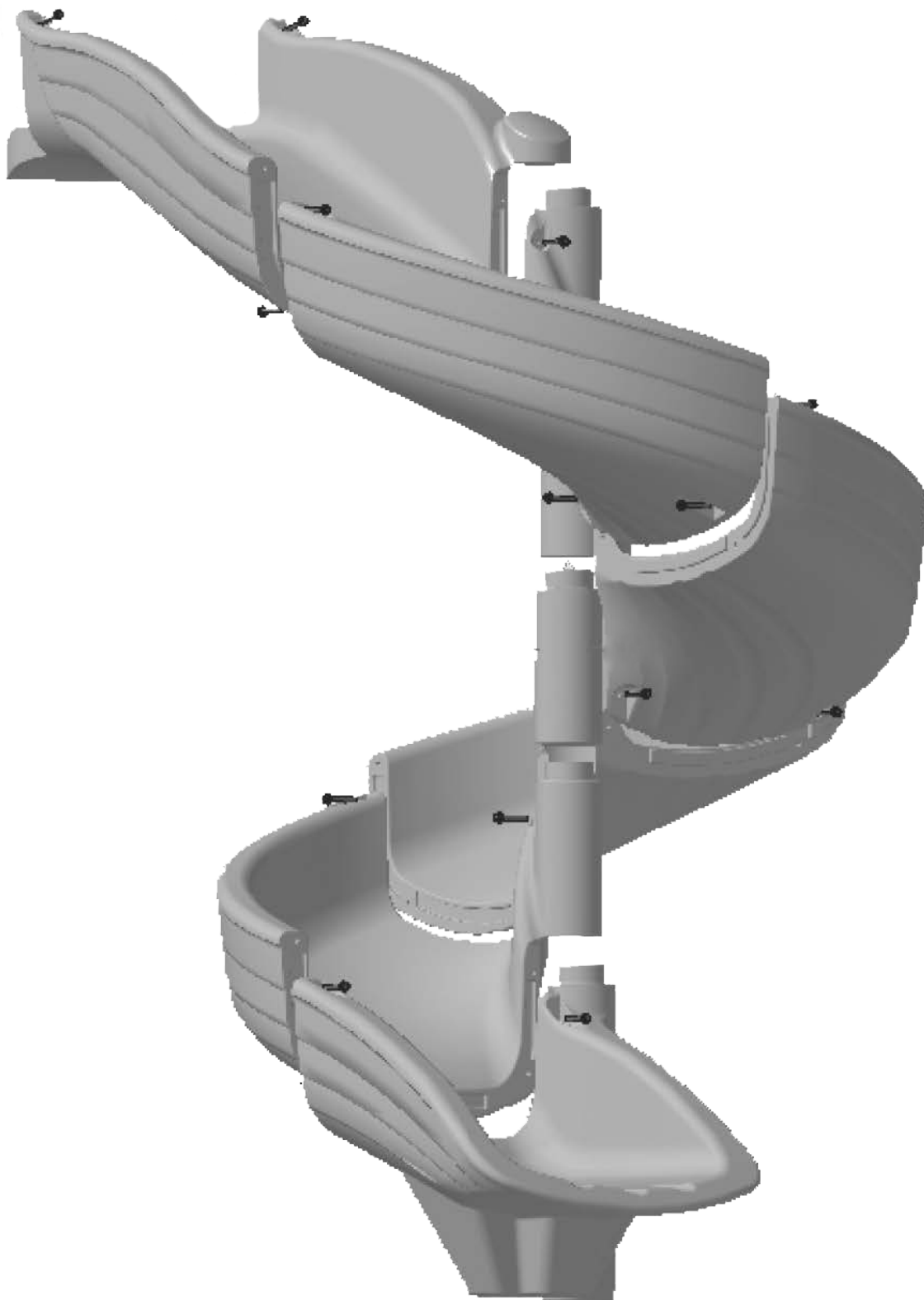

PART #	DESCRIPTION	QTY.
PGR-4X4-014-FIL	14" Slide Filler	2
PG-HW-L015	3/8" X 5.5" HEX LAG SCREW	4
PG-HW-L011	3/8 X 3" HEX LAG SCREW	2
PG-HW-L016	3/8 X 2.5" HEX LAG SCREW	3
PG-HW-W004	3/8" FLAT WASHER	9

## Attaching Slide to Playset

1. Attach Filler Boards to playset as shown in **Detail A**. Make sure Filler boards are flush/ level with the deck.
2. Attach Slide to Fillerboards as shown in **Detail B**.
3. Secure Slide to Deck as shown **Detail C**.

