

CARLISLE DRESSER MIRROR

ASSEMBLY INSTRUCTIONS



PARTS PACKING CONFIGURATIONS

BOX #1:

- A. MIRROR
B. MIRROR SUPPORT
*MIRROR HARDWARE PACK

1 PC
2 PCS

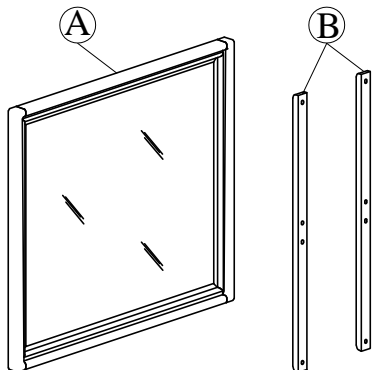

BOX #2:

- C. DRESSER
(SOLD SEPARATELY)

1 PC

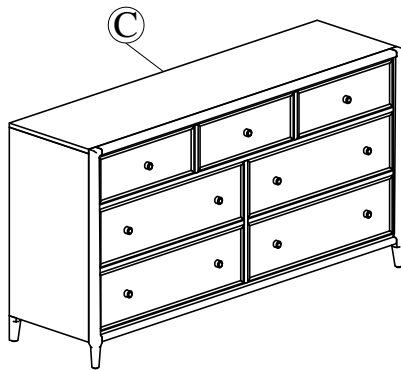

HARDWARE KIT PACKED IN BOX #1

No.	Description	Image	Quantity
1	ALLEN BOLT (8x45mm)		8 PCS
2	SPRING WASHER (M9)		8 PCS
3	FLAT WASHER (M9)		8 PCS
4	ALLEN KEY (4mm)		1 PC

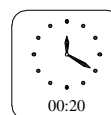

OPTION 1: DRESSER MOUNTING

STEP 1:

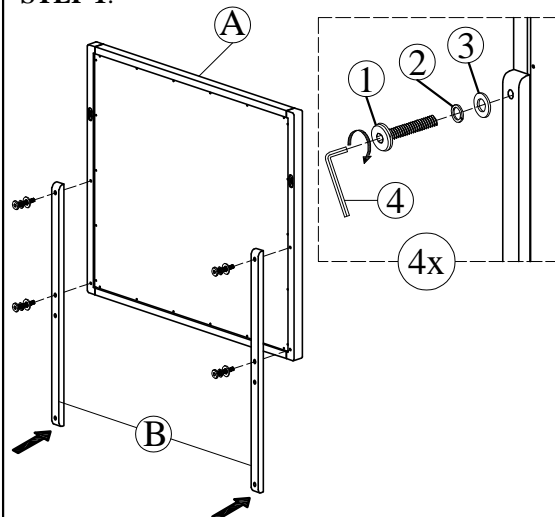

STEP 2:

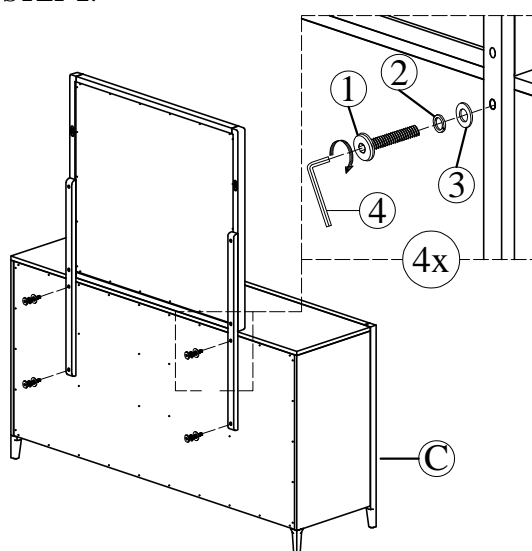

STEP 3:

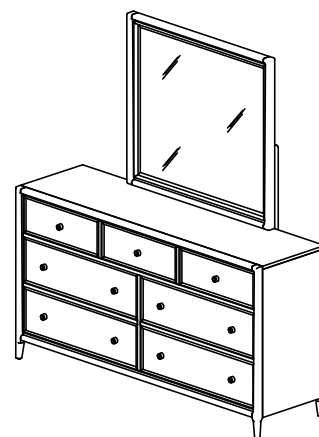

ASSEMBLY COMPLETE

OPTION 2: WALL MOUNTING

STEP 1:

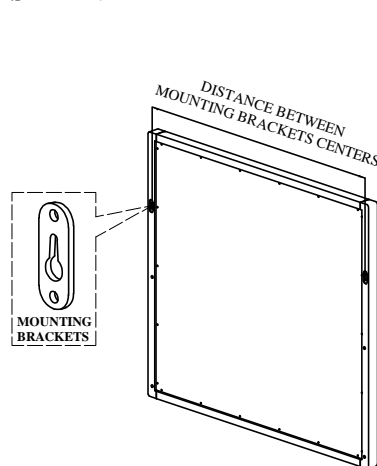

MIRROR BACK

STEP 2:

MOUNTING
HARDWARE

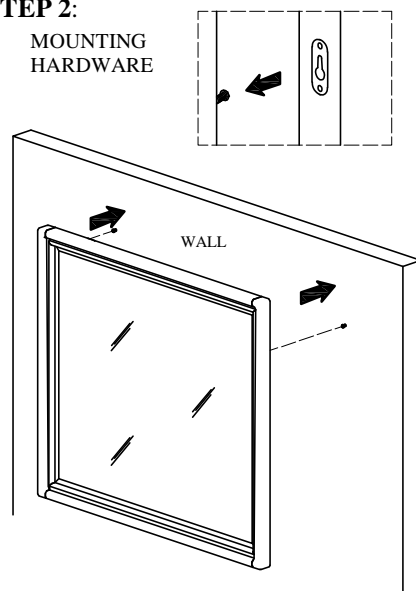

* WALL MOUNTING HARDWARE
NOT INCLUDED.

STEP 3:

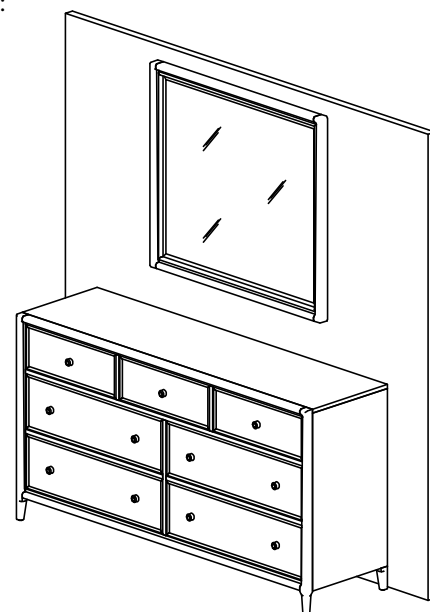

ASSEMBLY COMPLETE